

## Small Foot 11158

# Small Foot Wooden Toys Compact Play Kitchen Instruction Manual

Model: 11158

## 1. INTRODUCTION

This manual provides instructions for the assembly, operation, maintenance, and care of your Small Foot Wooden Toys Compact Play Kitchen, Model 11158. Please read this manual thoroughly before use and retain it for future reference.

### 1.1 Safety Information

**WARNING! Not suitable for children under the age of 3 years. Contains small parts which may present a choking hazard.**

- Adult supervision is recommended during play.
- Inspect all components regularly for wear or damage. Discontinue use if any part is broken or compromised.
- Keep packaging materials away from children.

## 2. PRODUCT OVERVIEW

The Small Foot Compact Play Kitchen is a wooden toy designed for imaginative role-play. It features a stove, oven, and sink area, along with various accessories to enhance the play experience. The design emphasizes compact storage and ease of assembly.



Image 2.1: Fully assembled Small Foot Compact Play Kitchen.

### 3. PACKAGE CONTENTS

Verify that all the following components are present in the package:

- 1x Compact Play Kitchen main unit (unassembled wooden panels)
- 1x Pot with lid
- 1x Frying pan
- 3x Utensils (e.g., spoon, spatula, fork)
- 1x Salt shaker
- 1x Pepper shaker



Image 3.1: All components of the Compact Play Kitchen, including the main unit and accessories.

## 4. ASSEMBLY INSTRUCTIONS

The Compact Play Kitchen is designed for tool-free assembly using interlocking wooden components. No screws or fasteners are required.

1. Carefully unpack all components and verify against the package contents list.
2. Identify the base, side panels, back panel, and top panel.
3. Interlock the side panels into the designated slots on the base. Ensure they are securely fitted.
4. Slide the back panel into the grooves of the side panels.
5. Place the top panel onto the assembled structure, aligning it with the slots on the side and back panels.
6. Attach any smaller decorative or functional pieces, such as the faucet, utensil hooks, and shelf, by fitting them into their respective slots.

7. Ensure all connections are firm and stable before allowing children to play.

**Note:** For enhanced stability, some users may choose to apply wood glue to the interlocking joints during assembly. This will make the structure more permanent and less suitable for frequent disassembly for storage.

## 5. OPERATING INSTRUCTIONS

The Compact Play Kitchen offers various interactive elements for imaginative play:

- **Stove Knobs:** The two knobs on the front panel produce a clicking sound when turned, simulating stove operation.
- **Oven Door:** The oven door can be opened and closed, allowing for pretend baking and cooking.
- **Sink:** The integrated sink area can be used for pretend washing of dishes or ingredients.
- **Utensil Hooks:** The included utensils can be hung on the designated hooks above the stove for organized storage and easy access during play.
- **Accessories:** Use the pot, frying pan, salt, and pepper shakers to enhance cooking scenarios.



Image 5.1: Close-up view of the stove knobs, which produce a clicking sound when turned.

## 6. MAINTENANCE AND CARE

### 6.1 Cleaning

- Wipe the wooden surfaces with a soft, damp cloth.
- Avoid using harsh chemicals or abrasive cleaners, as these can damage the wood finish and paint.
- Dry thoroughly after cleaning to prevent moisture damage.

### 6.2 Storage

- Store the play kitchen in a dry environment, away from direct sunlight or extreme temperatures, to prevent warping or fading.
- The interlocking design allows for disassembly for compact storage when not in use. Keep all components together to avoid loss.

## 7. TROUBLESHOOTING

### 7.1 Stability Issues

If the play kitchen feels unstable or parts frequently come apart:

- Ensure all interlocking components are fully seated in their respective slots. Apply gentle pressure to secure connections.
- Verify that the play kitchen is placed on a flat, stable surface.
- For a more permanent and sturdy structure, consider applying wood glue to the joints during assembly (refer to Section 4).

## 8. SPECIFICATIONS

Feature	Detail
Model Number	11158
Product Dimensions (L x W x H)	14.17 x 6.69 x 14.57 inches
Item Weight	2.93 pounds
Recommended Age	3 years and up
Materials	Wood (FSC Certified)
Certifications	TUV Certified, ICTI Ethical Toy Program, FSC Certified



Image 8.1: Size comparison of the play kitchen with a child silhouette, indicating a height of 37 cm.





## 9. WARRANTY AND SUPPORT

Small Foot Wooden Toys are manufactured to high-quality standards. For specific warranty details or support inquiries, please refer to the official Small Foot website or contact their customer service directly. Contact information can typically be found on the product packaging or the manufacturer's official website.

Manufacturer: small foot by Legler

Website: [www.smallfoot.de](http://www.smallfoot.de) (Please note: This link is for informational purposes and may be subject to change.)

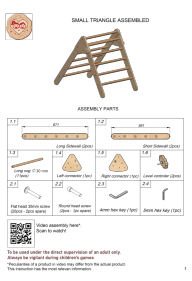

	<p><a href="#">small foot 12361 Feuerwehrucksack Produktsicherheitsrückruf wegen Blei</a></p> <p>Informationen zum Produktsicherheitsrückruf des small foot 12361 Feuerwehrucksacks aufgrund erhöhter Bleiwerte in den Schultergurten. Erfahren Sie, wie Sie das Produkt zurückgeben können.</p>
	<p><a href="#">App Cat Toy User Manual: Interactive Smart Cat Toy with App Control</a></p> <p>This user manual provides instructions for the PKNOVEL App Cat Toy, an interactive smart cat toy controlled via the Tuya mobile application. It details the toy's appearance, dimensions, app download and setup process, device pairing, and various usage modes including automatic, manual, in-situ rotation, and light control. The manual also includes important safety notes and usage guidelines for optimal pet interaction.</p>
	<p><a href="#">NORDIC PLAY Mercedes-Benz G350D Foot-to-Floor Ride-On Toy Manual</a></p> <p>Comprehensive guide for the NORDIC PLAY Mercedes-Benz G350D foot-to-floor ride-on toy, covering safety precautions, component identification, and assembly instructions for young children.</p>
	<p><a href="#">WoodandHearts Montessori Climbing Toys Assembly Guide: Triangle, Arch, Ramp</a></p> <p>Comprehensive assembly instructions for the WoodandHearts Montessori climbing set, including the small triangle, arch, and ramp. Learn how to build these durable wooden toys for children with step-by-step guidance.</p>
	<p><a href="#">Bright Starts Tiki Toy Bar™ Activity Gym: Care, Safety, and Assembly Guide</a></p> <p>Comprehensive guide for the Bright Starts Tiki Toy Bar™ Activity Gym, covering essential care and cleaning instructions, critical safety warnings, and step-by-step assembly guidance. Includes a parts list for easy identification.</p>
	<p><a href="#">Coco Village Triangle Climber - Small: Assembly Instructions &amp; Guide</a></p> <p>Assembly instructions for the Coco Village Triangle Climber - Small, a Montessori-inspired Pikler triangle designed for children's indoor play. This guide provides a parts list, step-by-step assembly, and important safety and care information.</p>

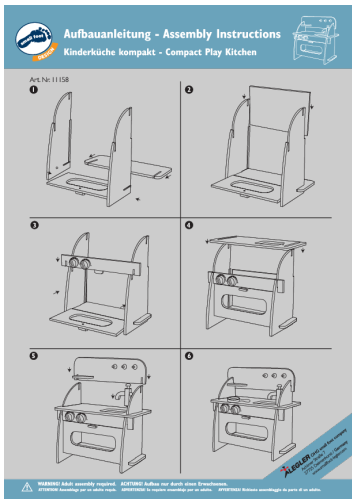

[\[pdf\]](#) Instructions

11158 Kinderküche kompakt indd Legler Small Foot Compact Play Kitchen assembly instructions

b261effd0b35555b40fee8dd11d95be771f1 gzhls at blob ldb 0 c 7 |||

1 2 3 4 5 6 ...

lang: **score:26** filesize: 743.76 K page\_count: 1 document date: 2018-12-04

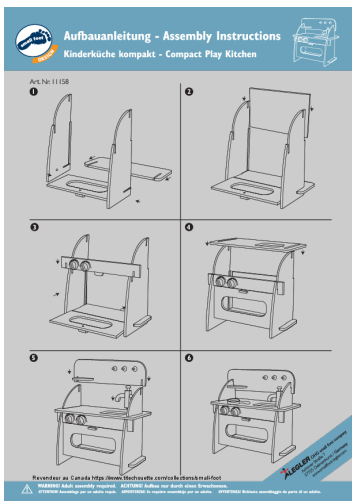

[\[pdf\]](#) Instructions

11158 Kinderküche kompakt indd Instructions English Compact Play Kitchen DE GB v 1635619056 cdn

shopify s files 1 0438 8467 5239 |||

1 2 3 4 5 6 Revendeur au Canada <https://www.titechouette.com/collections/small-foot>

...

lang: **score:23** filesize: 1.01 M page\_count: 1 document date: 2021-10-30