



[Manuals.plus](#) /

> [TPLTECH](#) /

> [UL Listed] Power Cord Compatible Electric Recliner or Liftchair 6Ft Power Cable Replacement Black

## TPLTECH E365821

# Instruction Manual: TPLTECH Power Cord

Model: E365821

## PRODUCT OVERVIEW

This TPLTECH power cord is a UL Listed, 2-slot non-polarization power cable designed as a replacement for electric recliners or lift chairs. It is manufactured with high-quality materials and tested to meet or exceed OEM product specifications, ensuring reliable performance and safety.

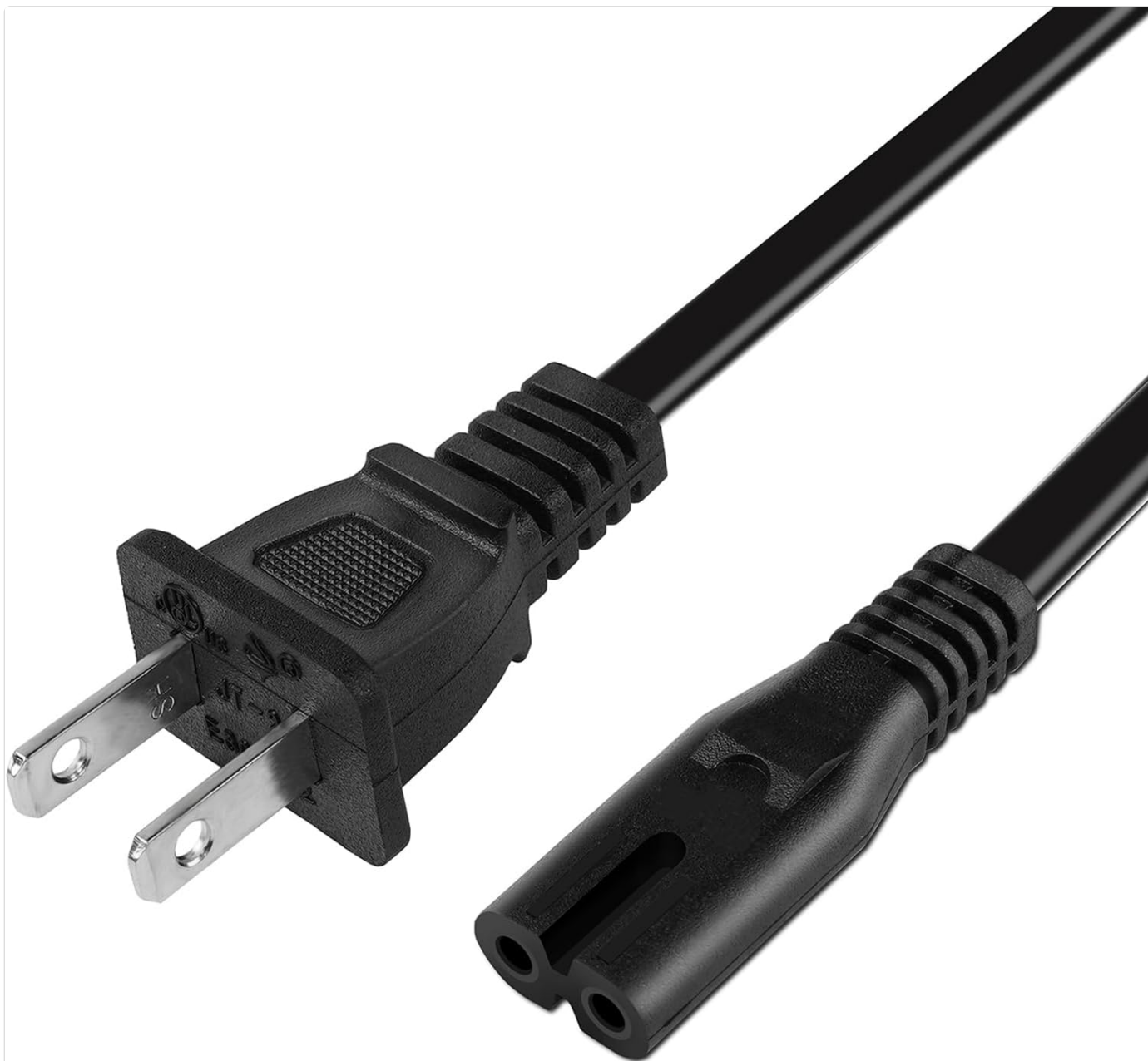

Image: The TPLTECH power cord, featuring its standard two-prong male plug and the two-slot female connector, designed for secure and reliable power delivery.

### Key Features:

- **UL Listed Safety:** Tested, approved, and certified by UL to ensure safety for you and your connected devices.
- **Compatibility:** Designed for electric recliners and lift chairs from various brands including Okin, Limoss, Pride, Golden, Lazboy, Berkline, Med, KD, and Bride.
- **Length:** 6 feet (approximately 1.83 meters) for flexible placement.
- **Quality:** Manufactured to match or exceed original equipment manufacturer (OEM) specifications.

# Universally Compatible



TV



Game Console



Power Supply



Printer



Speaker

Image: This diagram illustrates the broad compatibility of the power cord, suitable for use with a range of electronic devices beyond just recliners, such as televisions, game consoles, and printers.

## SETUP INSTRUCTIONS

- 1. Identify Connection Points:** Locate the power input port on your electric recliner, lift chair, or compatible device. This port is typically a two-slot receptacle.
- 2. Connect the Cord:** Insert the female (two-slot) end of the TPLTECH power cord firmly into the corresponding power input port on your device. Ensure a snug fit.
- 3. Connect to Power Outlet:** Insert the male (two-prong) end of the power cord into a standard 125V AC wall outlet. Ensure the outlet is functional and provides stable power.
- 4. Verify Connection:** Once both ends are connected, ensure all connections are secure. Your device should now be ready for operation.

*Note:* Always ensure the power cord is not pinched or placed under heavy objects to prevent damage.

## OPERATING THE POWER CORD

The TPLTECH power cord is a passive component designed to supply electrical power. Once properly connected to your device and a power source, it functions automatically. There are no user-operable controls on the cord itself.

- Ensure the power cord is fully inserted into both the device and the wall outlet.
- If your device has a power switch, turn it on after connecting the cord.

## MAINTENANCE AND CARE

Proper care of your power cord will extend its lifespan and ensure safe operation.

- **Regular Inspection:** Periodically inspect the entire length of the cord, including the plugs and connectors, for any signs of damage such as cuts, fraying, or exposed wires.
- **Cleaning:** If necessary, gently wipe the cord with a dry, soft cloth. Do not use liquid cleaners or immerse the cord in water.
- **Storage:** When not in use, coil the cord loosely. Avoid tight coiling or bending, which can damage the internal wires. Store in a cool, dry place away from direct sunlight and extreme temperatures.
- **Avoid Stress:** Do not pull the cord by the cable itself when unplugging; always grasp the plug firmly. Avoid placing heavy objects on the cord or running it under carpets where it could be walked on or damaged.



Image: A TPLTECH power cord neatly coiled, illustrating the recommended method for storage to prevent kinks and damage.

## TROUBLESHOOTING

If your device is not receiving power after connecting the TPLTECH power cord, consider the following:

- **Check Connections:** Ensure both ends of the power cord are fully and securely plugged into the device and the wall outlet.
- **Test Outlet:** Plug another known working appliance into the same wall outlet to confirm the outlet is functional. If the outlet is not working, check your circuit breaker.
- **Inspect Cord for Damage:** Visually inspect the entire power cord for any visible signs of damage (cuts, fraying, bent prongs). If damage is found, discontinue use and replace the cord.

- **Device Compatibility:** Confirm that your device is compatible with a 2-slot non-polarization power cord and that the voltage and current requirements of your device are within the cord's specifications (125 Volts, 7 Amps).
- **Device Issue:** If the cord and outlet are confirmed to be working, the issue may lie with the device itself. Consult your device's instruction manual or manufacturer for further troubleshooting.

## SPECIFICATIONS

### TPLTECH Power Cord Specifications

Attribute	Detail
Brand	TPLTECH
Model Number	E365821
Certification	UL Listed
Cord Length	6 Feet
Connector Type	2-slot Non-polarization (Male-to-Female)
Voltage Rating	125 Volts
Input Current	7 Amps
Color	Black
Item Weight	4.6 ounces
Package Dimensions	6.06 x 4.72 x 0.55 inches

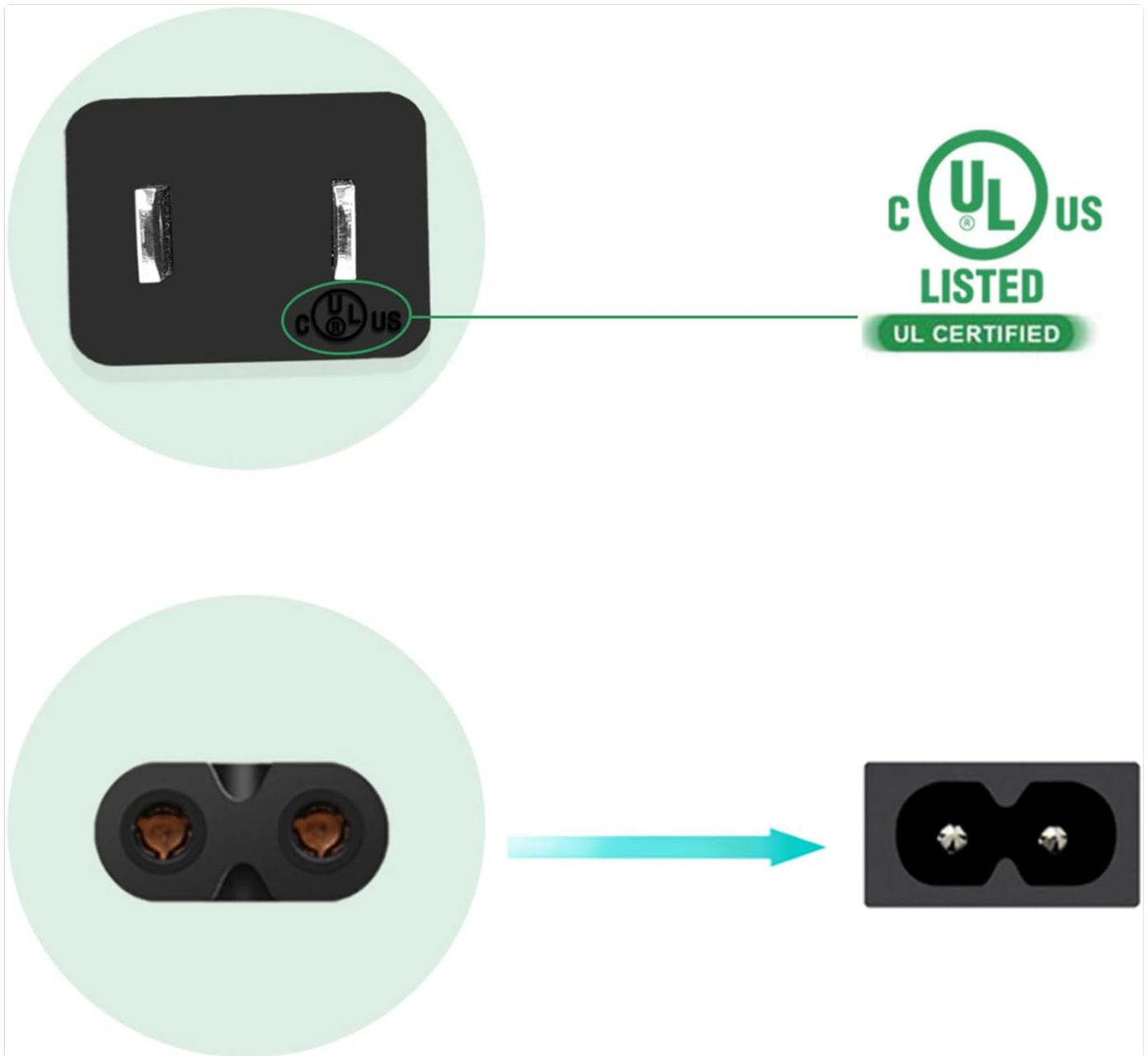

Image: Detail showing the UL Listed certification mark on the power cord, confirming its adherence to safety standards.

## WARRANTY AND CUSTOMER SUPPORT

TPLTECH stands behind the quality of its products.

- **Money Refund:** 30 Days Money Refund policy.
- **Free Replacement:** 12 Months Free Replacement warranty.
- **Customer Service:** For any problems or inquiries regarding the product, please contact TPLTECH customer service directly. They are committed to resolving any issues you may encounter.

For further assistance, please visit the official TPLTECH store or contact their support channels.