

Cybex 519001057

Cybex Gold Solution S-Fix Car Seat Instruction Manual

Model: 519001057

1. INTRODUCTION

This manual provides essential information for the correct installation, use, and maintenance of your Cybex Gold Solution S-Fix car seat. This car seat is designed for children approximately 3 to 12 years old, weighing between 15 and 36 kg (Group 2/3). Please read these instructions carefully before first use and keep them in a safe place for future reference. Proper use ensures maximum safety and comfort for your child.

2. SAFETY INFORMATION

The Cybex Gold Solution S-Fix car seat incorporates advanced safety features to protect your child. Always ensure the car seat is correctly installed and secured according to these instructions. Never leave a child unattended in the car seat. Ensure the vehicle's seat belt is properly routed and tightened across the child and the car seat.

- **Linear Side-impact Protection (L.S.P. System):** This system is designed to absorb impact forces early, protecting the child's head and upper body in a side-impact collision. Extend the L.S.P. protectors on the side closest to the vehicle door.
- **Headrest:** The adjustable headrest is crucial for optimal safety. Always adjust the headrest so that the child's shoulders are level with the bottom edge of the headrest.
- **Vehicle Compatibility:** This car seat is approved for use in vehicles with and without ISOFIX anchor points. Always check your vehicle's manual for compatible seating positions.

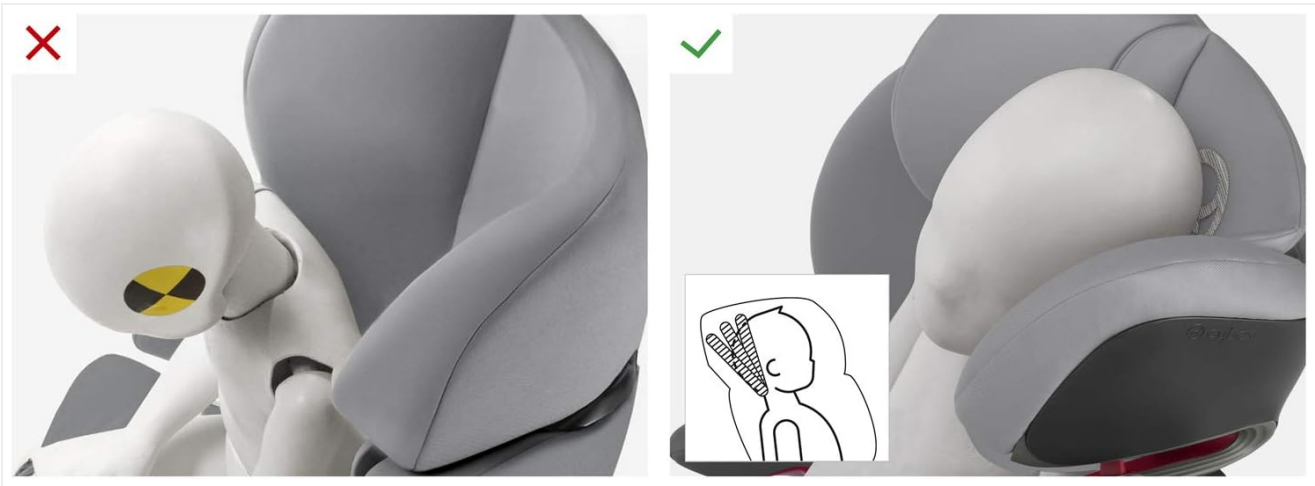

Image: The L.S.P. System in action, showing how the car seat protects the child's head and body during a side impact. The image on the left shows an incorrect position without proper head support, while the right image shows the correct, protected position.

3. PRODUCT OVERVIEW

The Cybex Gold Solution S-Fix car seat consists of a seat base and a backrest with an integrated headrest. It features adjustable elements for optimal fit and safety.



Image: Front view of the Cybex Solution S-Fix car seat, highlighting its ergonomic design and adjustable components.

Included Components:

- Cybex Solution S-Fix Car Seat
- Instruction Manual

4. SETUP AND INSTALLATION

The Cybex Solution S-Fix car seat can be installed using the vehicle's ISOFIX anchor points or the vehicle's 3-point seat belt. Always ensure the car seat is firmly secured before placing your child in it.

4.1. Installation with ISOFIX Connect System

1. Locate the ISOFIX anchor points in your vehicle.
2. Extend the ISOFIX connectors from the car seat base by pressing the release buttons.
3. Push the ISOFIX connectors firmly into the vehicle's ISOFIX anchor points until they click into place. Green indicators will confirm correct engagement.

4. Push the car seat firmly against the vehicle's backrest to ensure a tight fit.
5. Route the vehicle's 3-point seat belt through the designated guides on the car seat and buckle it. Ensure the lap belt is low across the child's hips and the shoulder belt rests centrally on the child's shoulder.



Image: Close-up view of the ISOFIX connectors extended from the car seat base, ready for installation into a vehicle's ISOFIX anchor points.

4.2. Installation without ISOFIX (using vehicle's 3-point seat belt)

1. Retract the ISOFIX connectors completely into the car seat base.
2. Place the car seat on the vehicle seat.
3. Route the vehicle's 3-point seat belt through the designated red belt guides on the car seat.
4. Buckle the seat belt. Ensure the lap belt is low across the child's hips and the shoulder belt rests centrally on the

child's shoulder, without twisting.



Image: A child properly secured in the Cybex Solution S-Fix car seat using the vehicle's 3-point seat belt, demonstrating correct belt routing.

5. OPERATING THE CAR SEAT

The Cybex Solution S-Fix offers several adjustments to ensure your child's comfort and safety as they grow.

5.1. Headrest Adjustment

The headrest can be adjusted to 12 different height positions to perfectly fit your child's height. To adjust, squeeze the adjustment handle at the back of the headrest and slide it up or down. Ensure the headrest is positioned so that the child's shoulders are level with the bottom edge of the headrest.



Image: Close-up of the headrest adjustment mechanism on the Cybex Solution S-Fix car seat, showing the handle used to raise or lower the headrest.

5.2. Reclining Backrest

The car seat features a reclining backrest that adapts to the angle of the vehicle seat, providing a comfortable and secure position for your child. This helps prevent the child's head from falling forward when sleeping.



Image: Side view of the Cybex Solution S-Fix car seat illustrating the reclining backrest feature, showing how it can be angled for comfort.

5.3. Optimized Ventilation System

The car seat is designed with an optimized ventilation system to maintain a comfortable temperature for your child, especially during warmer weather.



Image: A composite image showing the adjustable width of the seat, the height adjustment of the headrest, and the ventilation points within the car seat for enhanced comfort.



Image: A child sitting comfortably and securely in the Cybex Solution S-Fix car seat, demonstrating the spacious and ergonomic design.

6. MAINTENANCE

Regular maintenance helps prolong the life of your car seat and ensures continued hygiene for your child.

6.1. Cleaning the Fabric Covers

The fabric covers of the Cybex Solution S-Fix car seat are removable and machine washable. Wash at 30°C on a delicate cycle. Do not tumble dry, iron, or dry clean. Allow to air dry completely before reattaching to the car seat frame.

6.2. Cleaning the Hard Parts

The hard parts of the car seat can be cleaned with a damp cloth and mild soap. Do not use harsh cleaning agents or abrasives.

7. TROUBLESHOOTING

If you encounter any issues with your Cybex Solution S-Fix car seat, please refer to the following common solutions:

- **Car seat feels loose after installation:** Recheck all installation steps, ensuring ISOFIX connectors are fully engaged (green indicators visible) or the vehicle's seat belt is tightly secured through all guides. Push the seat firmly against the vehicle's backrest.
- **Headrest not adjusting:** Ensure the adjustment handle is fully squeezed. Check for any obstructions.
- **Child uncomfortable:** Verify the headrest is at the correct height for your child's shoulders. Ensure the vehicle's seat belt is not twisted and is routed correctly.

If problems persist, please contact Cybex customer support for assistance.

8. SPECIFICATIONS

Feature	Specification
Model Number	519001057
Dimensions (LxWxH)	40.5 x 50 x 61 cm
Product Weight	6.2 kg
Recommended Age Range	Approx. 3 to 12 years
Recommended Weight Range	15 - 36 kg (Group 2/3)
Installation Type	ISOFIX Connect or Vehicle's 3-point seat belt
Material	100% Polyester (cover)
Color	Manhattan Grey
Headrest Positions	12
Harness Type	3-point (vehicle belt)



Image: Diagram illustrating the approximate dimensions of the car seat, with a height of 69 cm (27 inches).

9. WARRANTY AND SUPPORT

Your Cybex Gold Solution S-Fix car seat comes with a **3-year warranty** from the date of purchase, covering manufacturing defects. Please retain your proof of purchase for warranty claims.

For technical support, spare parts, or warranty inquiries, please contact your local Cybex retailer or visit the official Cybex website for customer service contact information. Always provide your product model number (519001057) and date of purchase when contacting support.