

Paulmann 93439

Paulmann Nova Recessed LED Spot User Manual

Model: 93439

INTRODUCTION

This manual provides essential information for the safe and efficient installation, operation, and maintenance of your Paulmann Nova Recessed LED Spot. Please read these instructions carefully before installation and retain them for future reference.

The Paulmann Nova Recessed LED Spot is designed for use in bathrooms, featuring an IP44 rating for splash water protection and a durable stainless steel construction. It uses a GU10 LED bulb with 6.5W power consumption.

SAFETY INSTRUCTIONS

- Installation must be performed by a qualified electrician in accordance with local wiring regulations.
- Ensure the power supply is disconnected before installation, maintenance, or bulb replacement.
- Do not connect the luminaire to a dimmer as this model is not dimmable.
- This product is rated IP44, suitable for bathroom zones 2 and 3. Do not install in zones where direct water jets are present.
- Do not cover the luminaire with insulating material.
- Avoid touching the bulb immediately after use as it may be hot.

PACKAGE CONTENTS

- 1 x Paulmann Nova Recessed LED Spot fixture
- 1 x GU10 LED Bulb (6.5W)
- Installation instructions (this manual)



Image: Exploded view showing the recessed fixture, GU10 LED bulb, and electrical connector.

SETUP AND INSTALLATION

1. **Preparation:** Ensure the power supply to the installation area is switched off at the main circuit breaker.
2. **Ceiling Cutout:** Create a circular cutout in the ceiling. Refer to the product specifications for the exact cutout diameter (typically around 68mm-75mm).
3. **Wiring:** Connect the luminaire's wiring to the mains supply. Ensure correct polarity (Live, Neutral, Earth) according to local electrical codes. Use appropriate terminal blocks if necessary.
4. **Insert Bulb:** Insert the GU10 LED bulb into the lamp holder by aligning the pins and twisting clockwise until secure.
5. **Secure Fixture:** Push the spring clips on the side of the recessed spot upwards and insert the fixture into the ceiling cutout. The spring clips will hold the fixture securely in place.
6. **Final Check:** Once installed, restore power and test the luminaire.



Image: The Paulmann Nova Recessed LED Spot, fully assembled and emitting light.

OPERATING INSTRUCTIONS

The Paulmann Nova Recessed LED Spot operates by connecting to your standard household electrical circuit. Once installed and wired correctly, it can be switched on and off via a wall switch connected to the circuit.

- **Power On/Off:** Use the wall switch to turn the light fixture on or off.
- **Non-Dimmable:** This specific model (93439) is *not dimmable*. Do not attempt to connect it to a dimmer switch, as this may damage the LED bulb or the fixture.

MAINTENANCE

- **Cleaning:** Disconnect power before cleaning. Wipe the fixture with a soft, damp cloth. Do not use abrasive cleaners or solvents.
- **Bulb Replacement:**
 - a. Ensure power is off and the bulb has cooled down.
 - b. Gently twist the GU10 bulb counter-clockwise to remove it from the lamp holder.
 - c. Insert a new GU10 LED bulb (max 6.5W) by aligning the pins and twisting clockwise until secure.
- **Inspection:** Periodically check the fixture for any signs of damage or loose connections. If any issues are found, disconnect power and consult a qualified electrician.

TROUBLESHOOTING

Problem	Possible Cause	Solution
Light does not turn on.	No power supply. Faulty bulb. Loose wiring connection.	Check circuit breaker. Replace bulb. Check wiring (ensure power is off).
Light flickers.	Loose bulb. Incompatible dimmer (if used). Faulty bulb.	Ensure bulb is securely twisted. This model is not dimmable; remove dimmer. Replace bulb.
Fixture gets excessively hot.	Incorrect bulb wattage. Insufficient ventilation.	Ensure bulb is 6.5W GU10 LED. Ensure fixture is not covered by insulation.

SPECIFICATIONS

Feature	Detail
Model Number	93439
Brand	Paulmann
Product Dimensions (L x W x H)	7.8 x 7.8 x 6 cm
Weight	6 Kilograms
Material	Iron
Color	Brushed Iron
Style	Modern

Feature	Detail
Ingress Protection (IP) Rating	IP44
Number of Bulbs	1
Included Components	Bulb
Voltage	230 Volts
Special Feature	Waterproof (IP44)
Shade Color	Warm White
Light Source Type	LED
Cap Type	GU10
Luminous Flux	460 lm
Wattage	6.5 Watts
Incandescent Equivalent	32 Watts
Dimmable	No (Nicht Dimmbar)
Average Life	15000 Hours

P Paulmann

934.39



Diese Leuchte ist
geeignet für
Leuchtmittel der
Energieklassen:

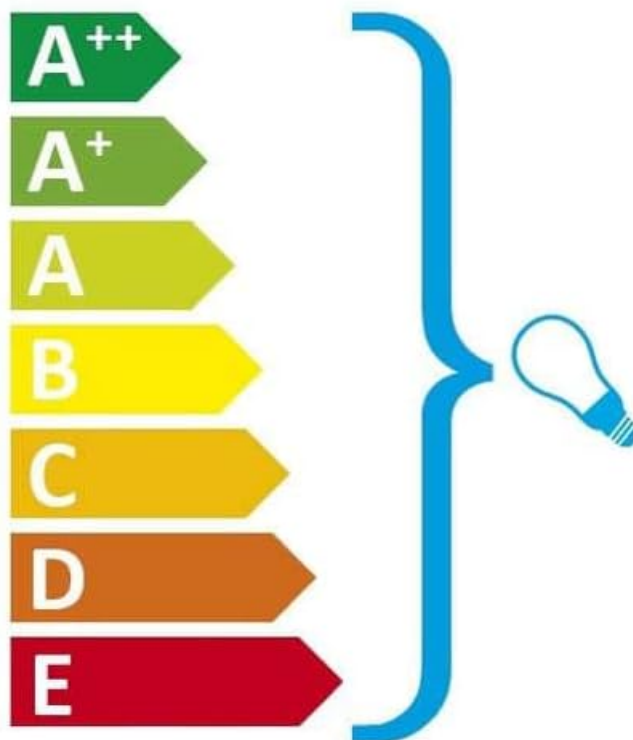

Diese Leuchte wird verkauft mit
einem Leuchtmittel der
Energieklasse: **A+**

874/2012



Image: Energy efficiency label indicating the product's energy class and suitability for various light sources.

Paulmann products are manufactured to high quality standards. For warranty information and customer support, please refer to the official Paulmann website or contact your local retailer.

Please note that the availability of spare parts is currently unavailable according to product information. Software updates are also not applicable for this product.

For further assistance, please visit: www.paulmann.com

© 2023 Paulmann. All rights reserved.
Information in this manual is subject to change without notice.

Related Documents - 93439

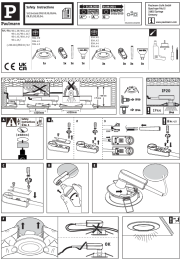
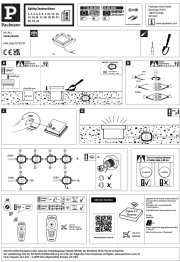
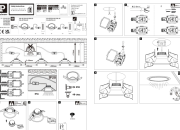
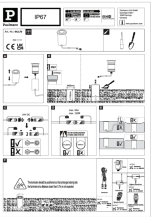
	<p>Paulmann LED Recessed Luminaire Installation and Safety Guide</p> <p>Comprehensive guide for Paulmann LED recessed luminaires, covering installation, safety instructions, component replaceability, and energy efficiency information. Includes product numbers 934.39 through 934.45.</p>
	<p>Paulmann 94504/94595 LED Ground Recessed Luminaire Smart Home Zigbee Installation Guide</p> <p>Detailed installation and safety instructions for the Paulmann 94504/94595 LED ground recessed luminaire. Features Smart Home Zigbee 3.0 connectivity, IP67 rating, and 230V power. Includes multilingual guidance on installation, replaceability, and disposal.</p>
	<p>Paulmann Cole LED Recessed Luminaire Installation Guide Safety & Specs</p> <p>Installation and safety guide for the Paulmann Cole LED recessed luminaire. Covers mounting, electrical connections, dimming features, component replaceability, and disposal instructions.</p>
	<p>Paulmann Plug & Shine Floor Individual Spot IP67 Installation Guide</p> <p>Comprehensive installation guide for the Paulmann Plug & Shine Floor Individual Spot IP67 LED luminaire, detailing mounting, electrical connections, component replaceability, and safety information.</p>

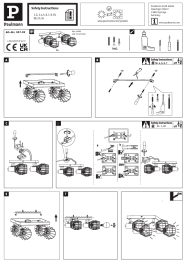

[Paulmann Lanka Spot Light Installation Guide](#)

Comprehensive installation instructions and safety guidelines for the Paulmann Lanka spot light fixture (Article No. 667.69). Covers electrical connections, component replaceability, and technical specifications for safe and proper use.

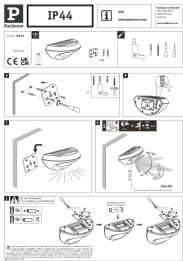

[Paulmann Sorova Solar LED Wall Luminaire with Motion Detector - Installation Guide](#)

Installation and operation guide for the Paulmann Sorova Solar LED Wall Luminaire (Model 948.56). Features IP44 rating, motion detection, solar power, and rechargeable battery. Includes mounting, battery replacement, and settings details.