

EGLO 97456

EGLO Faedo 3 LED Outdoor Projector User Manual

Model: 97456

1. IMPORTANT SAFETY INSTRUCTIONS

Please read these instructions carefully before installation and use. Keep this manual for future reference.

- **Electrical Safety:** Installation must be performed by a qualified electrician in accordance with all local and national electrical codes. Ensure power is disconnected at the circuit breaker before installation or maintenance.
- **Grounding:** This product must be properly grounded to prevent electric shock.
- **IP65 Rating:** This fixture is rated IP65 for protection against dust and water jets. It is suitable for outdoor use. Do not submerge in water.
- **Heat:** The LED fixture may become warm during operation. Do not touch the fixture directly after prolonged use.
- **Light Source:** The integrated LED light source is not replaceable. Do not attempt to open or modify the fixture.
- **Cleaning:** Use a soft, damp cloth for cleaning. Do not use abrasive cleaners or solvents.

2. PACKAGE CONTENTS

Verify that all components are present before beginning installation:

- EGLO Faedo 3 LED Outdoor Projector (1 unit)
- Mounting bracket
- Mounting screws and wall plugs
- Instruction Manual (this document)



Figure 2.1: EGLO Faedo 3 LED Outdoor Projector. This image shows the main product unit, a black rectangular LED floodlight with a white LED panel and an adjustable mounting bracket.

3. PRODUCT OVERVIEW AND DIMENSIONS

The EGLO Faedo 3 LED Outdoor Projector is a durable and energy-efficient lighting solution designed for outdoor environments. Its robust aluminum construction and IP65 rating ensure longevity and reliability.

mm / inch

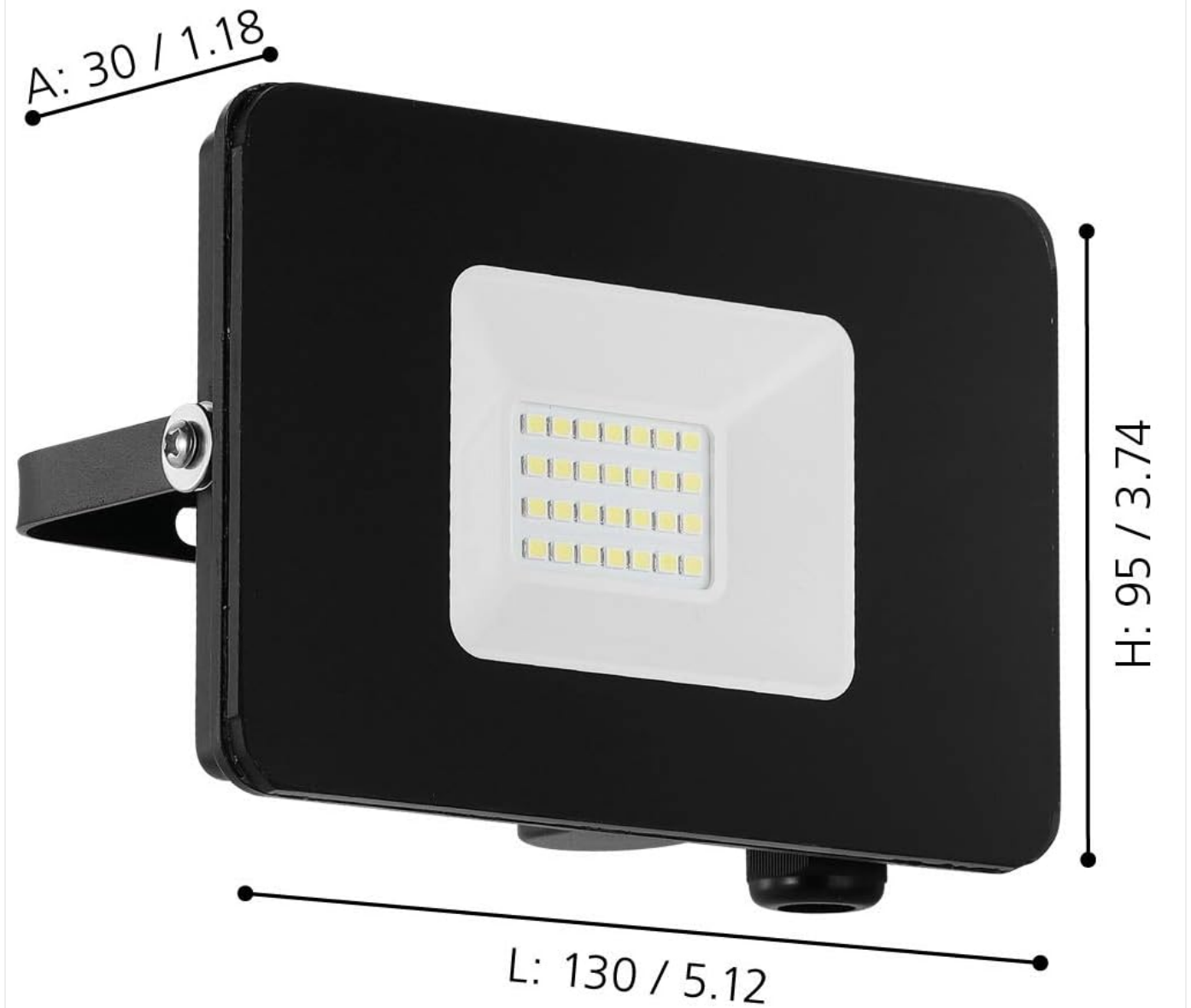

Figure 3.1: Product Dimensions. The image illustrates the dimensions of the projector: Length (L) 130 mm / 5.12 inches, Height (H) 95 mm / 3.74 inches, and Depth (A) 30 mm / 1.18 inches.



Figure 3.2: IP65 Protection Rating. This graphic highlights the IP65 rating, indicating the product's high resistance to dust ingress and protection against water jets from any direction, making it suitable for outdoor use.

4. INSTALLATION

Before You Begin: Ensure the power supply is turned OFF at the main circuit breaker. Use appropriate personal protective equipment (PPE) such as safety glasses and gloves.

1. **Choose Location:** Select a suitable outdoor location for mounting the projector, ensuring it is on a stable surface and provides the desired illumination area.
2. **Mark Drilling Points:** Use the mounting bracket as a template to mark the drilling points on the wall or mounting surface.
3. **Drill Holes:** Drill holes at the marked points using an appropriate drill bit for your wall material. Insert wall plugs if necessary.
4. **Attach Mounting Bracket:** Secure the mounting bracket to the wall using the provided screws. Ensure it is firmly attached.
5. **Wiring:**
 - Connect the live wire (usually brown or red) from your power supply to the 'L' terminal on the fixture.
 - Connect the neutral wire (usually blue or black) from your power supply to the 'N' terminal on the fixture.
 - Connect the ground wire (usually green/yellow) from your power supply to the ground terminal (⏏) on the fixture.

- Ensure all connections are secure and properly insulated.
6. **Mount Fixture:** Attach the LED projector to the mounting bracket. Secure it with the provided screws or fasteners.
 7. **Adjust Angle:** Adjust the angle of the projector to direct the light as desired. Tighten the adjustment screws to fix the position.
 8. **Restore Power:** Once installation is complete and all connections are secure, restore power at the main circuit breaker.

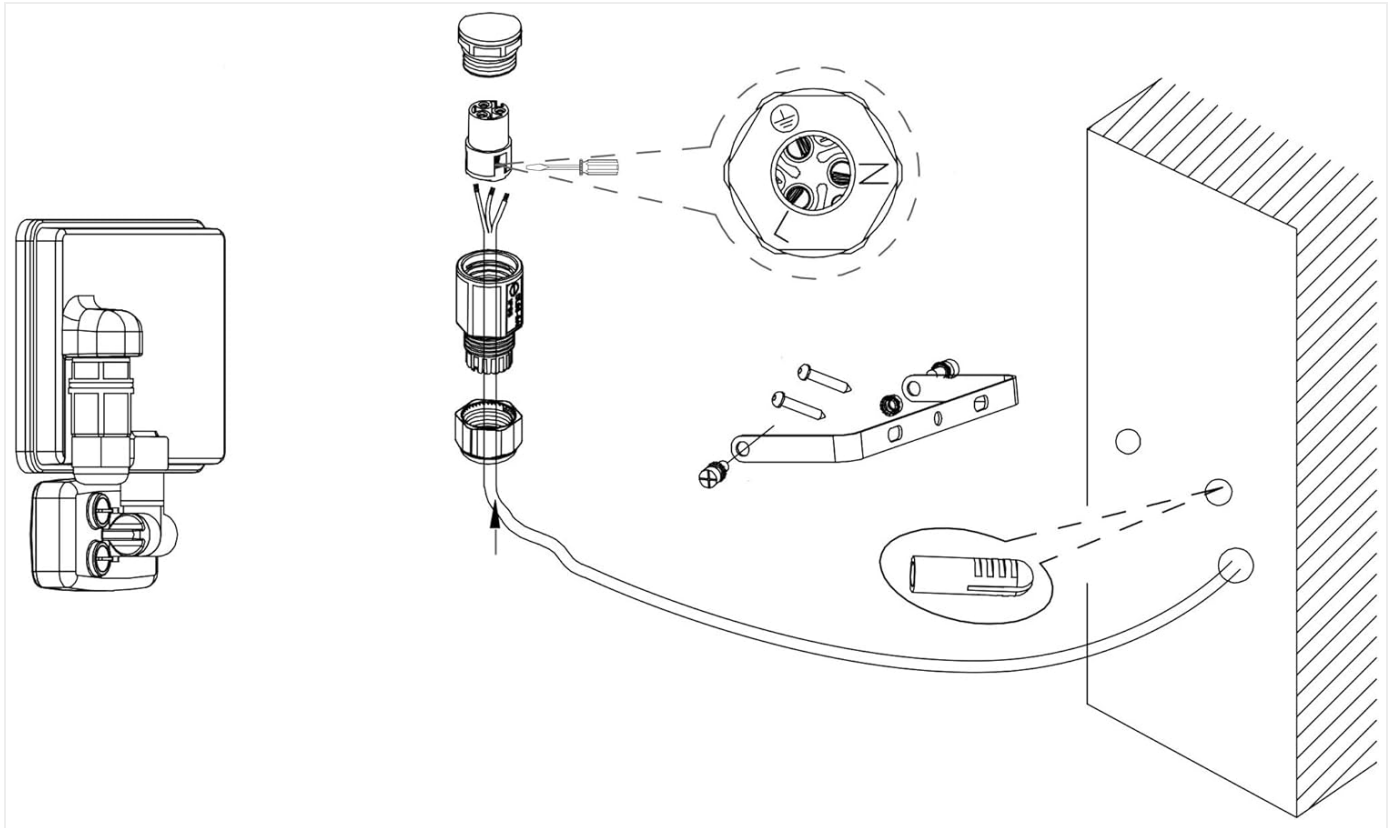

Figure 4.1: Installation Diagram. This diagram illustrates the steps for mounting the fixture, including detaching the mounting plate, marking drill holes, securing the plate, connecting electrical wires (Live, Neutral, Ground), and reattaching the fixture to the plate.

5. OPERATION

The EGLO Faedo 3 LED Outdoor Projector (Model 97456) is designed for straightforward operation.

- **Power On/Off:** This model does not include an integrated switch. Operation is controlled by the external power switch connected to the fixture's circuit.
- **Light Output:** The fixture provides a consistent 1800 lumens of light output at 20 Watts.
- **Non-Dimmable:** This LED projector is not dimmable. Do not connect it to a dimmer switch.

6. MAINTENANCE

Regular maintenance ensures optimal performance and longevity of your EGLO Faedo 3 LED Outdoor Projector.

- **Cleaning:**
 - Before cleaning, ensure the power supply to the fixture is turned OFF.
 - Wipe the exterior of the fixture with a soft, damp cloth.
 - Do not use harsh chemicals, abrasive cleaners, or solvents, as these can damage the finish or the glass.
- **Inspection:** Periodically inspect the fixture for any signs of damage, loose connections, or wear. If any damage is observed,

disconnect power and consult a qualified electrician.

- **LED Light Source:** The LED light source is integrated and not user-replaceable. If the LEDs fail, the entire fixture must be replaced.

7. TROUBLESHOOTING

If you encounter issues with your EGLO Faedo 3 LED Outdoor Projector, refer to the following common problems and solutions:

Problem	Possible Cause	Solution
Light does not turn on.	<ul style="list-style-type: none">• No power supply.• Loose wiring connection.• Faulty fixture.	<ul style="list-style-type: none">• Check circuit breaker and wall switch.• Verify all wire connections are secure (ensure power is OFF before checking).• If power is present and connections are good, the fixture may be faulty. Contact support.
Light flickers.	<ul style="list-style-type: none">• Unstable power supply.• Loose wiring.• Incompatible dimmer switch (this fixture is non-dimmable).	<ul style="list-style-type: none">• Ensure stable power.• Check wiring connections.• Remove any dimmer switch and connect to a standard ON/OFF switch.
Reduced light output.	<ul style="list-style-type: none">• Dirt or debris on the glass.• Aging LED components.	<ul style="list-style-type: none">• Clean the glass surface.• LEDs have a long lifespan, but gradual degradation can occur over many years.

If the problem persists after trying these solutions, please contact EGLO customer support.

8. SPECIFICATIONS

Feature	Detail
Brand	EGLO
Model Number	97456
Product Dimensions (L x W x H)	13 x 3 x 9.5 cm; 280 grams
Ingress Protection (IP) Rating	IP65
Number of Items	1
Style	Without sensor
Color	Black
Shape	Rectangular
Material	Aluminum, Glass
Number of Bulbs	1 (integrated LED)

Feature	Detail
Included Components	Wall light, mounting instructions
Voltage	240 Volts
Specific Uses	Glass
Shade Color	Transparent
Light Angle	LEDs
Plug Type	AC/DC
Switch Style	Without switch
Batteries Included/Required	No
Bulb Type	LED
Cap Type	LED-Platine
Luminous Flux	1800 lm
Wattage	20 Watts
Features	Non-Dimmable
Average Life	25000 Hours
Item Weight	280 g
Indoor/Outdoor Use	Outdoor
Installation Type	Wall Mount

9. WARRANTY AND SUPPORT

EGLO products are manufactured with high-quality materials and undergo strict quality control. For warranty information and customer support, please refer to the official EGLO website or contact your local retailer. For further assistance, you may visit the [EGLO Brand Store on Amazon](#) or contact the seller directly.

