

## Start-X EVO-CHRT5

# Start-X Remote Starter Kit for Jeep Wrangler Key Start (2007-2018)

Model: EVO-CHRT5

## 1. PRODUCT OVERVIEW

---

The Start-X Remote Starter Kit provides a convenient way to remotely start your Jeep Wrangler. This system integrates with your vehicle's existing key fob, allowing you to start the engine from a distance. It is designed for a straightforward installation process, utilizing a plug-and-play T-harness system.



Image 1.1: Start-X Remote Starter Kit packaging and components, featuring a Jeep Wrangler.

This kit is compatible with Jeep Wrangler Key Start models from 2007 to 2018. It enables you to pre-condition your vehicle's interior, warming it in winter or cooling it in summer, before you enter.



Image 1.2: Illustration of remote start functionality for both cold and warm weather conditions.

## 2. VEHICLE COMPATIBILITY AND REQUIREMENTS

---

- **Vehicle Model:** Jeep Wrangler Key Start
- **Model Years:** 2007, 2008, 2009, 2010, 2011, 2012, 2013, 2014, 2015, 2016, 2017, 2018
- **Transmission Type:** Automatic Transmission Only
- **Ignition Type:** Key Ignition Only
- **Fuel Type:** Gas Only



**Works only with  
Automatic  
Transmission**



**Key Ignition Only**



**Fuel type: Gas Only**

**Vehicle  
Requirements**

Image 2.1: Visual representation of the specific vehicle requirements for this remote starter kit.

### 3. PACKAGE CONTENTS

---

Before beginning installation, verify that all components are present in the package:

- Remote Start Module
- Vehicle Connection T-Harness
- Pry Tool
- Zip Ties
- Installation Guide / Welcome Card / Warning Sticker



Image 3.1: All items included in the Start-X Remote Starter Kit package.

## 4. INSTALLATION INSTRUCTIONS

---

The Start-X Remote Starter Kit is designed for a plug-and-play installation, requiring no wire cutting or splicing. Some disassembly of your vehicle's dashboard or steering column area is necessary to access the connection points.

### 4.1 Tools Required

- Small Torx screwdriver (T15 recommended for steering column cover)
- Pry tool (included)
- Scissors or wire cutters (for zip ties)

### 4.2 Step-by-Step Installation

1. **Prepare Vehicle:** Ensure the vehicle is turned off, the parking brake is engaged, and the keys are removed from the ignition.



2. **Access Steering Column:** Carefully remove the lower clamshell cover of the steering wheel column to expose the wiring. Refer to the included installation guide or online video resources for specific panel removal instructions for your Jeep Wrangler model year.
3. **Connect T-Harness:** Locate the necessary connection points within the steering column. Connect the Start-X T-Harness to the vehicle's wiring. This is a direct plug-in process.
4. **Program Module:** Follow the programming steps outlined in the included installation guide. This typically involves a sequence of key turns and button presses to synchronize the remote start module with your vehicle. Observe the LED indicators on the module for confirmation during programming.
5. **Secure Module and Wiring:** Once programmed, secure the remote start module and excess wiring using the provided zip ties. Ensure all connections are firm and that no wires interfere with moving parts (e.g., steering column, pedals).
6. **Reassemble:** Carefully reattach the steering column cover and any other panels removed during the installation process.

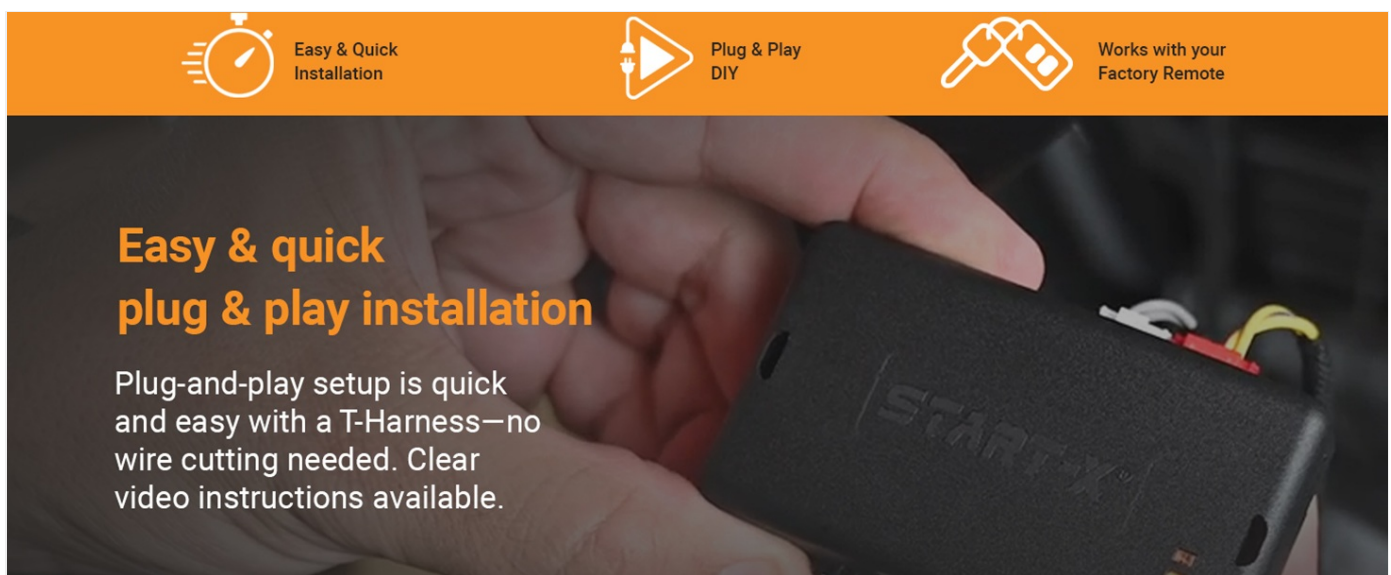

Image 4.1: The Start-X module and T-harness, illustrating the plug-and-play connection.

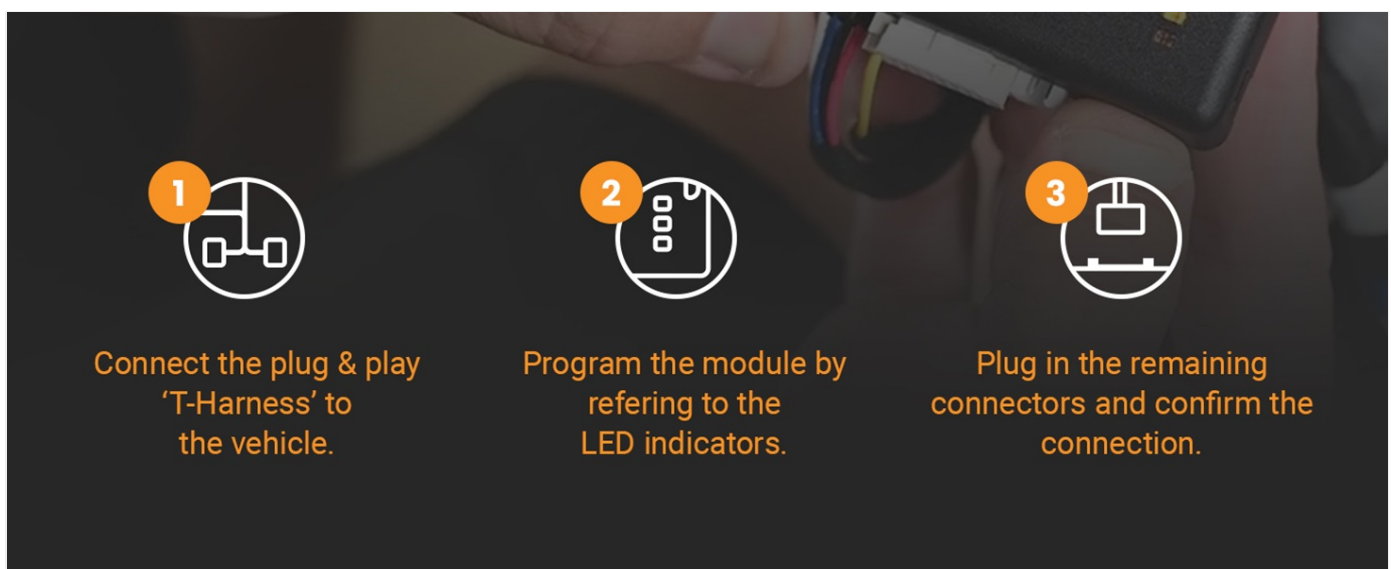

Image 4.2: Simplified visual guide for the three main installation steps.

## 5. OPERATING INSTRUCTIONS

The Start-X Remote Starter Kit utilizes your vehicle's factory key fob for remote start functionality. No additional remote is

required.

## 5.1 Starting the Vehicle Remotely

To start your Jeep Wrangler remotely:

1. Ensure the vehicle doors are closed and locked.
2. Press the **Lock** button on your factory key fob three (3) times consecutively.
3. The vehicle's parking lights will flash, and the engine will start.



Image 5.1: The remote start system works with your original factory key fob.

## 5.2 Turning Off the Vehicle Remotely

To turn off your Jeep Wrangler remotely after it has been started by the remote starter:

1. Press the **Lock** button on your factory key fob three (3) times consecutively.

2. The engine will shut down.

The remote start system will typically run for a preset duration (e.g., 10-15 minutes) before automatically shutting off if not entered. Consult your specific installation guide for the exact run time.

## 6. MAINTENANCE

---

The Start-X Remote Starter Kit is designed to be maintenance-free. Ensure all connections remain secure and free from moisture or physical damage. No user-serviceable parts are inside the module.

## 7. TROUBLESHOOTING

---

If you encounter issues with your remote starter, consider the following:

- **Vehicle Not Starting:**
  - Ensure all doors, hood, and trunk are fully closed.
  - Verify the vehicle is in Park (P).
  - Check if the vehicle's battery is sufficiently charged.
  - Confirm that the factory key fob battery is not low.
  - Re-attempt the 3X Lock sequence, ensuring presses are distinct and within a short timeframe.
- **Remote Start Shuts Off Prematurely:**
  - This can occur if a door is opened, the brake pedal is pressed, or the ignition key is inserted before the remote start sequence is properly disengaged.
  - Ensure the remote start run time has not expired.
- **No Response from Key Fob:**
  - Check the range between your key fob and the vehicle. Obstructions or distance can affect signal.
  - Replace the key fob battery if necessary.

For persistent issues, refer to the detailed troubleshooting section in your included installation guide or contact Start-X technical support.

## 8. SPECIFICATIONS

---

Feature	Detail
Manufacturer	Start-X
Brand	Start-X
Item Model Number	EVO-CHRT5
Item Weight	9.6 ounces
Package Dimensions	8.15 x 4.13 x 2.32 inches
Compatibility	Jeep Wrangler Key Start 2007-2018 (Automatic Transmission, Gas Only)

## 9. WARRANTY AND SUPPORT







Start-X products are designed and manufactured in North America. For technical assistance or warranty inquiries, please contact Start-X USA Tech Support. Contact information can typically be found on the Start-X website or on the included welcome card.

While this kit is designed for easy installation, professional installation is always an option if you are uncomfortable performing the steps yourself.

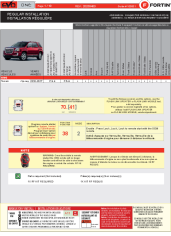

Related Documents - EVO-CHRT5

	<p><a href="#">Fortin EVO-ALL Installation Guide for Nissan Frontier</a></p> <p>Comprehensive installation guide for the Fortin EVO-ALL interface module in a Nissan Frontier (2005-2019), covering wiring, programming, and remote start functionality.</p>
	<p><a href="#">Compustar Installation Guide for 2012-2015 Scion IQ: Remote Start System</a></p> <p>This Compustar installation guide provides detailed instructions for the 2012-2015 Scion IQ, including wiring diagrams, component locators, and testing procedures for remote start system installation. Essential for certified technicians.</p>
	<p><a href="#">Fortin EVO ONE Remote Starter Installation Guide for GMC Terrain (2010-2017)</a></p> <p>This guide provides detailed installation instructions, wiring diagrams, and programming procedures for the Fortin EVO ONE remote starter, alarm, and immobilizer bypass module, specifically for GMC Terrain vehicles (2010-2017) with flip keys. It covers configuration options, mandatory installation steps, and troubleshooting.</p>
	<p><a href="#">Fortin EVO-ALL Stand Alone Installation Guide for Chevrolet Avalanche (2007-2013)</a></p> <p>Detailed installation and programming guide for the Fortin EVO-ALL remote starter and interface module for Chevrolet Avalanche vehicles (2007-2013) with automatic transmission. Includes wiring diagrams, configuration options, and programming procedures.</p>
	<p><a href="#">Fortin EVO ONE Installation Guide for Cadillac Escalade (2007-2014)</a></p> <p>This document provides a detailed installation and programming guide for the Fortin EVO ONE remote starter and immobilizer bypass module, specifically for Cadillac Escalade models manufactured between 2007 and 2014. It includes wiring configurations, programming procedures, and functionality descriptions.</p>



### [Fortin EVO-ALL Installation Guide for Volkswagen Passat \(2012-2019\) with Key](#)

Comprehensive installation guide for the Fortin EVO-ALL interface module in a Volkswagen Passat (2012-2019) requiring a standard key. Covers wiring diagrams, programming procedures, and remote starter functionality.

Documents - Start-X – EVO-CHRT5

no relevant documents