

CTEK CT5 Time To Go (40-255)

CTEK (40-255) CT5 Time to Go-12 Volt Battery Charger and Maintainer User Manual

Model: CT5 Time To Go (40-255)

1. INTRODUCTION

The CTEK CT5 Time To Go charger is an intelligent, fully automatic 12-volt battery charger and maintainer designed for various lead-acid batteries. It features a unique countdown timer indicating the remaining charging time and a start indicator for when the battery can safely start a vehicle. This compact and shock-proof unit helps prolong battery life and comes with a 5-year warranty.



Image 1.1: The CTEK CT5 Time to Go charger, displaying its intuitive interface with mode selection and time-to-go indicators.

2. SAFETY INFORMATION

Please read all safety instructions carefully before using the charger. Failure to follow these instructions may result in electric shock, fire, or serious injury.

- Always wear eye protection and protective clothing when working with batteries.
- Ensure adequate ventilation during charging to prevent gas accumulation.
- Do not smoke or allow sparks or flames near the battery or charger.
- Disconnect the AC power cord from the outlet before connecting or disconnecting the charging cables from the battery.
- Never charge a frozen or damaged battery.
- Keep the charger away from water and moisture.

- This charger is designed for 12V lead-acid batteries only. Do not use it for other battery types.

3. WHAT'S IN THE BOX

The CTEK CT5 Time to Go package includes the following items:

- CTEK CT5 Time to Go Battery Charger and Maintainer
- Alligator Clamps (for temporary connection)
- Ring Terminals (Eyelets) (for permanent connection)



Optional Protective Bumper



Optional Cig Plug Connector



Optional Comfort Indicator



Optional Extension Cable

Image 3.1: Examples of optional accessories compatible with the CT5 Time to Go charger.

4. PRODUCT OVERVIEW

The CT5 Time to Go charger is designed for ease of use and optimal battery care. Its intuitive display provides real-time feedback on charging status and estimated completion time.

Key Features:

- **Countdown Timer and Start Indicator:** Provides an accurate prediction of remaining charging time and indicates when the battery can safely start a vehicle.
- **Built-In Temperature Compensation:** Ensures efficient charging in varying temperature conditions.
- **Reconditioning Mode:** Restores stratified and deeply discharged batteries.
- **Dedicated AGM Mode:** Optimized charging for AGM batteries.
- **Patented Desulphation Function:** Recovers and extends the life of sulfated batteries.
- **Connect and Forget:** Fully automatic operation once a program is selected.
- **Safe and Easy to Use:** Splash and dustproof, non-sparking, reverse polarity protected, and short-circuit proof.

- **Protects Sensitive Equipment:** Designed to not damage vehicle electronics; no need to disconnect the battery.

Supported Battery Types:

The CT5 Time to Go supports all types of 12V lead-acid batteries, including:

- AGM (Absorbent Glass Mat)
- MF (Maintenance Free)
- EFB (Enhanced Flooded Battery)
- CA/CA (Calcium/Calcium)
- WET (Flooded)
- GEL

FOR ALL TYPES OF LEAD-ACID, 12V BATTERIES



SUPPORT FOR THE FOLLOWING BATTERY TYPES:

- | | | |
|-------|---------|-------|
| • AGM | • MF | • WET |
| • EFB | • CA/CA | • GEL |

Image 4.1: The CTEK CT5 Time to Go charger is compatible with a wide range of 12V lead-acid battery technologies.

5. SETUP AND CONNECTION

Follow these steps to safely connect your CTEK CT5 Time to Go charger to a battery:

1. **Prepare the Battery:** Ensure the battery terminals are clean and free from corrosion. If the battery is in a vehicle, ensure the ignition is off and all electrical consumers are switched off.

2. Connect to Battery:

- Connect the red (positive, +) clamp or ring terminal to the battery's positive terminal.
- Connect the black (negative, -) clamp or ring terminal to the battery's negative terminal. If connecting to a vehicle battery, connect the negative clamp to the vehicle chassis away from the battery and fuel line, if recommended by the vehicle manufacturer.

3. Connect to Power Outlet: Plug the charger's AC power cord into a wall socket. The charger will perform a self-test.

4. Select Charging Program: Press the 'MODE' button on the charger to select the appropriate charging program for your battery type (e.g., NORMAL, AGM, RECOND).

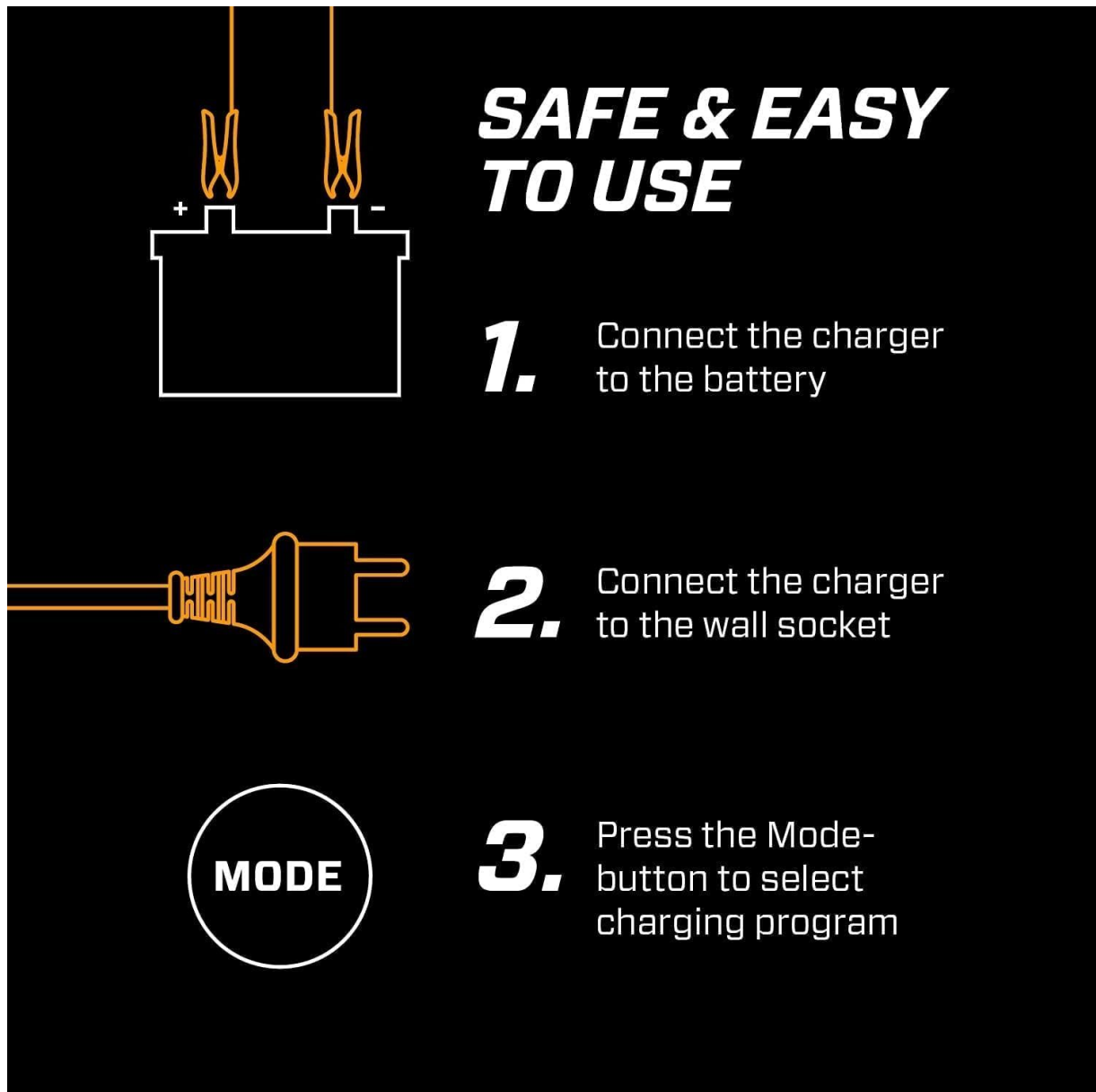

Image 5.1: Simple three-step process for connecting and initiating charging with the CTEK CT5 Time to Go.



Image 5.2: The CTEK CT5 Time to Go charger connected to a vehicle battery using the provided alligator clamps.

6. OPERATING INSTRUCTIONS

Once connected and the program is selected, the CT5 Time to Go operates automatically through its 8-step charging cycle.

Charging Programs:

- **NORMAL:** For most lead-acid batteries (WET, MF, Ca/Ca, EFB, GEL).
- **AGM:** For AGM batteries, which require a slightly higher charging voltage.
- **RECOND:** For reconditioning deeply discharged and stratified batteries. Use this mode sparingly and only when necessary.

Understanding the Display:

- **Time to Go:** The LED indicators show the estimated time until the battery is fully charged (e.g., 8, 4, 2, 1 hours).
- **Start Indicator:** An LED will illuminate when the battery has sufficient charge to start a vehicle, even if not fully charged.
- **Care:** Indicates the charger is in maintenance mode, keeping the battery at optimal charge.

RECONDITION. RESTORE. MAINTAIN.

8-STEP, FULLY AUTOMATIC CHARGING CYCLE



Image 6.1: The CTEK CT5 Time to Go utilizes an 8-step charging cycle to recondition, restore, and maintain battery health.

7. MAINTENANCE

Regular maintenance ensures the longevity and optimal performance of your charger and battery.

- **Charger Care:** Keep the charger clean and dry. Wipe with a soft, damp cloth if necessary. Do not use solvents or harsh chemicals.
- **Cable Inspection:** Periodically inspect the charging cables and connectors for any signs of damage, wear, or corrosion. Replace if damaged.
- **Battery Maintenance:** Ensure battery terminals are clean. For flooded batteries, check electrolyte levels periodically and top up with distilled water if needed (refer to battery manufacturer guidelines).
- **Storage:** When not in use, store the charger in a cool, dry place.

8. TROUBLESHOOTING

If you encounter issues with your CTEK CT5 Time to Go charger, refer to the following common problems and solutions:

Problem	Possible Cause	Solution
---------	----------------	----------

Problem	Possible Cause	Solution
Charger does not start	No AC power; poor connection to battery; battery voltage too low.	Check AC power outlet; ensure secure connections to battery terminals; if battery voltage is extremely low, it may require professional assessment.
Charging takes too long	Battery is deeply discharged or damaged; incorrect program selected; extreme temperatures.	Allow more time; ensure correct mode (e.g., RECOND for deeply discharged); charging efficiency can be affected by cold.
Error indicator lights up	Reverse polarity; short circuit; internal fault.	Check connections for correct polarity; ensure no short circuits; if problem persists, contact support.
Charger gets warm	Normal operation during charging.	This is normal. Ensure adequate ventilation around the charger.

9. SPECIFICATIONS

Feature	Detail
Manufacturer	CTEK
Model	CT5 Time To Go (40-255)
Input Voltage	100-240V AC, 50-60Hz (Typical for universal chargers)
Output Voltage	12 Volts DC
Charging Current	4.3 Amps
Battery Capacity	1.2-110 Ah (charging), up to 160 Ah (maintenance)
Dimensions (L x W x H)	11.02 x 5.9 x 2.33 inches
Weight	1.7 pounds
Protection	IP65 (Splash and dustproof), Reverse Polarity, Short-Circuit
Operating Temperature	-20°C to +50°C (-4°F to +122°F)

Image 9.1: The CTEK CT5 Time to Go charger is compatible with various vehicles, including cars, motorcycles, and recreational vehicles.

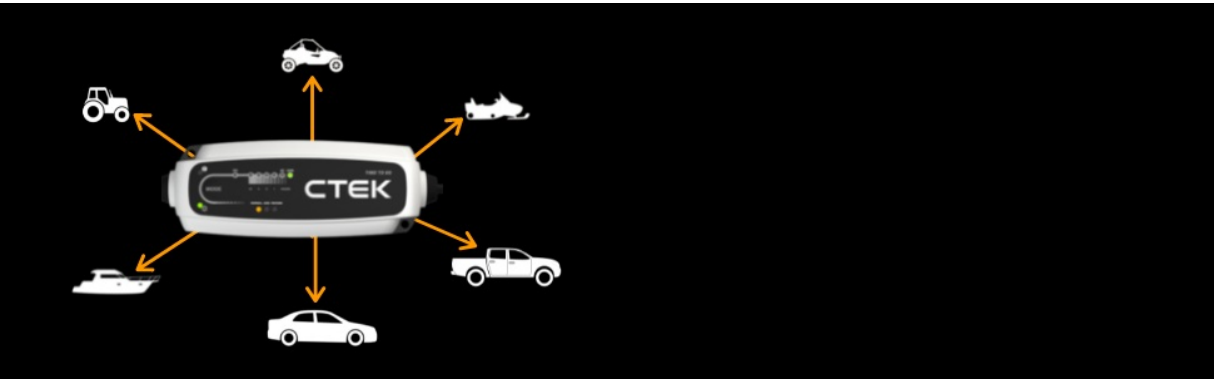

10. WARRANTY AND SUPPORT

The CTEK CT5 Time To Go charger comes with a **5-year warranty** from the date of purchase, covering defects in material and workmanship.



For technical support, warranty claims, or further information, please contact CTEK customer service or visit the official CTEK website. Keep your proof of purchase for warranty validation.

CTEK is committed to maximizing battery performance and providing reliable battery management solutions.

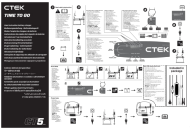
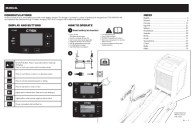

Image 10.1: The CTEK brand logo, representing quality in battery management systems.

Related Documents - CT5 Time To Go (40-255)

	<p>CTEK Start/Stop Battery Charger and Maintainer User Guide</p> <p>Comprehensive guide to the CTEK Start/Stop battery charger and maintainer, covering technical specifications, usage instructions, and warranty information. Supports various 12V lead-acid batteries including AGM and EFB.</p>
	<p>CTEK CT5 TIME TO GO Battery Charger User Manual and Specifications</p> <p>User manual and technical specifications for the CTEK CT5 TIME TO GO battery charger. This guide provides detailed instructions on safe operation, charging modes (NORMAL, AGM, RECOND), indicator lights, technical data, and warranty information. It covers multiple languages and aims for accessibility and SEO optimization.</p>
	<p>CTEK PRO60 Professional Battery Charger Manual</p> <p>A comprehensive guide to operating and understanding the CTEK PRO60 professional switch-mode battery charger, covering its features, charging programs for lead-acid and lithium batteries, technical specifications, and troubleshooting.</p>
	<p>CTEK MXS 5.0 Battery Charger User Manual</p> <p>Comprehensive user manual for the CTEK MXS 5.0 battery charger, covering safety instructions, operating procedures, charging programs, technical specifications, and warranty information.</p>
	<p>CTEK CS FREE User Manual and Safety Guide</p> <p>Comprehensive user manual for the CTEK CS FREE battery charger, detailing setup, operation, technical specifications, and essential safety precautions for various battery types.</p>



[CTEK MXS 7.0 Battery Charger User Manual](#)

Comprehensive user manual for the CTEK MXS 7.0 battery charger, detailing its features, charging programs, technical specifications, and safety guidelines for all types of 12V lead-acid batteries.

Documents - CTEK – CT5 Time To Go (40-255)



[\[pdf\] Guide Accessories](#)

20023419A 57 098 Product Guide Brochure US Letter Print file 006.indd CTEK North America

Maximizing Battery Performance Chargers smartercharger product guide 11 cdn shopify s files 1 0117 5237 4372 |||

NORTH AMERICA PRODUCT GUIDE 2018 BATTERY CHARGERS AND ACCESSORIES 20023419A, 57-098, Product Guide Brochure US, Letter, Print file 006.indd 1 2017-10-03 14:53:14 20023419A, 57-098, Product Guide Brochure US, Letter, Print file 006.indd 2 2017-10-03 14:53:20 CONTENTS EASY CHARGING CONSUMER C...

lang:en score:18 filesize: 17.34 M page_count: 28 document date: 2019-04-02