

Manuals+

[Q & A](#) | [Deep Search](#) | [Upload](#)

[manuals.plus](#) /

› [Thule](#) /

› [Thule TracRac TracOne Truck Rack User Manual](#)

Thule TracOne

Thule TracRac TracOne Truck Rack User Manual

Brand: Thule

Model: TracOne (Part Number: 27000XT)

1. INTRODUCTION

The Thule TracRac TracOne Truck Rack is a robust and versatile solution designed for transporting various types of cargo, including ladders, lumber, and sports equipment. This universal truck bed rack is engineered for easy, drill-free installation on most truck models. It features an integrated T-Track mounting system on the load bars, allowing for seamless integration with a wide range of Thule accessories. The rack is built to handle significant loads, with a capacity of up to 800 lbs when properly installed and weight is evenly distributed.

This manual provides essential information regarding the setup, operation, maintenance, and specifications of your Thule TracRac TracOne Truck Rack. Please read it thoroughly before installation and use.

2. SAFETY INFORMATION

Adhering to safety guidelines is crucial for the proper and safe operation of your truck rack.

- **Load Capacity:** Do not exceed the maximum load capacity of 800 lbs (363 kg). Ensure the weight is distributed evenly across the rack.
- **Vehicle Limits:** Always verify your vehicle's specific load limits and consult the Thule Buyer's Guide or your vehicle's owner's manual, as vehicle limits may vary and could be lower than the rack's capacity.
- **Secure Installation:** Ensure all components, especially the C-clamps and load stops, are securely fastened before each use. Regularly check the tightness of all bolts and connections.
- **Cargo Securement:** Always properly secure all cargo to the rack using appropriate tie-downs or straps. Unsecured cargo can shift during transit, leading to dangerous situations.
- **Clearance:** Be aware of the increased height of your vehicle with the rack and cargo installed. Check for overhead clearances, especially in garages, carports, and drive-thrus.
- **Driving Habits:** Adjust your driving speed and habits to account for the added weight and dimensions of the rack and cargo. Avoid sudden maneuvers.

3. COMPONENTS OVERVIEW

The Thule TracRac TracOne Truck Rack typically includes the following main components:

- **Load Bars:** Two horizontal bars that span the width of your truck bed, featuring the T-track system for accessory attachment.
- **Uprights/Supports:** Four vertical supports that connect the load bars to the truck bed rails.
- **C-Clamps:** Specialized clamps used for securing the rack to the truck bed rails without drilling.
- **Load Stops:** Four adjustable stops that slide into the T-track system on the load bars, used to secure cargo laterally.
- **Mounting Hardware:** Various bolts, washers, and other fasteners required for assembly.

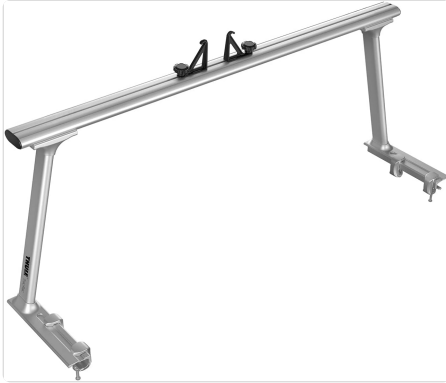

Figure 3.1: Overview of the Thule TracRac TracOne Truck Rack components. This image shows the two load bars, the four upright supports, and the integrated load stops.



Figure 3.2: Close-up view of the adjustable load stops inserted into the T-track system on the load bar. These stops help secure cargo.



Figure 3.3: Detailed view of a C-clamp, which is used to secure the rack to the truck

bed rails without requiring drilling.

4. SETUP AND INSTALLATION

The Thule TracRac TracOne is designed for straightforward, drill-free installation. Follow these general steps for assembly and mounting. For detailed, step-by-step instructions, always refer to the official PDF user manual provided by Thule.

1. **Unpack and Verify:** Carefully unpack all components and compare them against the parts list in the official manual to ensure everything is present and undamaged.
2. **Assemble Uprights to Load Bars:** Attach the four upright supports to the two load bars using the provided hardware. Ensure all connections are snug but do not overtighten until the rack is positioned on the truck.
3. **Position Rack on Truck Bed:** Carefully place the assembled rack onto your truck bed rails. Ensure it is centered and positioned according to your cargo needs and vehicle specifications.
4. **Secure with C-Clamps:** Attach the C-clamps to the base of each upright and secure them to the truck bed rails. Tighten the clamps evenly and firmly. It is important to ensure the threads are clear and free of obstruction for proper tightening.
5. **Final Tightening:** Once the rack is properly positioned and all clamps are in place, perform a final tightening of all bolts and clamps. Double-check all connections for security.
6. **Install Load Stops:** Slide the four load stops into the T-track channels on the load bars. These can be adjusted later to accommodate specific cargo widths.



Figure 4.1: The Thule TracRac TracOne Truck Rack fully installed on a pickup truck, demonstrating its appearance and positioning.

5. OPERATING INSTRUCTIONS

Once installed, the Thule TracRac TracOne is ready for use. Its design allows for flexible cargo management.

- **Adjusting Load Stops:** The included load stops can be easily repositioned along the T-track system on the load bars. Loosen the knob, slide the stop to the desired position to cradle your cargo, and then tighten the knob to secure it. This allows for precise fitment for various load widths.
- **Utilizing the T-Track System:** The integrated T-track system on the load bars is compatible with a wide range of Thule accessories, such as cargo boxes, kayak carriers, or bike racks. Consult the instructions for your specific Thule accessory for proper attachment to the T-track.
- **Loading Cargo:** When loading items, ensure the weight is evenly distributed and does not exceed the rack's 800 lbs capacity or your vehicle's roof/bed load limit. Place longer items centrally across both load bars.
- **Securing Cargo:** Always use appropriate tie-down straps, ropes, or nets to firmly secure your cargo to the rack. Ensure

there is no movement or shifting possible during transit. Periodically check cargo securement during long journeys.

6. MAINTENANCE

Regular maintenance will ensure the longevity and safe operation of your Thule TracRac TracOne.

- **Regular Inspection:** Before each use, visually inspect the rack for any signs of wear, damage, or loose components. Pay close attention to the C-clamps, load bars, and upright connections.
- **Tighten Fasteners:** Periodically re-tighten all bolts and fasteners, especially after the first few uses and after driving on rough terrain. Vibrations can cause fasteners to loosen over time.
- **Cleaning:** Clean the aluminum surfaces with mild soap and water. Avoid abrasive cleaners or solvents that could damage the finish. Rinse thoroughly and dry.
- **Winter Care:** In colder climates, ensure that moving parts and fasteners are free of ice and snow before operation.
- **Storage:** If removing the rack for extended periods, store it in a dry, protected area to prevent corrosion and damage.

7. TROUBLESHOOTING

If you encounter issues with your Thule TracRac TracOne, consider the following common solutions:

- **Rack Feels Loose After Installation:**
 - Ensure all C-clamps are fully and evenly tightened to the truck bed rails.
 - Verify that the uprights are securely fastened to the load bars.
 - Check for any obstructions between the clamps and the truck bed that might prevent a secure grip.
- **Difficulty Tightening C-Clamps:**
 - Ensure the threads on the C-clamp bolts and within the clamp body are clean and free of debris or excess coating. Carefully work the bolt in and out to clear any obstructions if necessary.
 - Use the correct tool and apply steady, firm pressure.
- **Unusual Noise During Driving:**
 - Check all connections and fasteners for tightness. Loose components can vibrate and cause noise.
 - Ensure cargo is securely fastened and not shifting.
 - While the rack is designed to be aerodynamic, some wind noise is normal, especially at higher speeds or with certain cargo.

If problems persist, refer to the official Thule TracRac TracOne PDF User Manual or contact Thule customer support.

8. SPECIFICATIONS

Feature	Detail
Brand	Thule
Model Name	TracOne
Part Number	27000XT
Color	Aluminium
Item Dimensions (L x W x H)	65 x 16 x 30 inches (165.1 x 40.6 x 76.2 cm)

Feature	Detail
Load Capacity	800 Pounds (363 kg)
Mounting Type	Rack (Drill-free C-clamp system)
UPC	091021747982
Included Components	Pick up truck rack (includes load bars, uprights, C-clamps, load stops, and hardware)

9. WARRANTY INFORMATION

The Thule TracRac TracOne Truck Rack comes with a warranty covering **manufacturer defects**. For specific details regarding the warranty period, coverage, and claims process, please refer to the official warranty documentation included with your product or visit the official Thule website.



Keep your proof of purchase for any warranty claims.

10. SUPPORT

For further assistance, detailed installation guides, or product support, please utilize the following resources:

- **Official User Manual (PDF):** A comprehensive PDF manual is available for download. [Download PDF Manual](#)
- **Thule Website:** Visit the official Thule website for product information, FAQs, and customer service contact details. www.thule.com

Related Documents - TracOne

 <p>THULE Instructions Thule Approach 2 301925/301926</p>	<p>Thule Approach 2 Rooftop Tent Installation and Safety Guide</p> <p>Comprehensive instructions and safety guidelines for the Thule Approach 2 rooftop tent, including model numbers, installation steps, and weight capacity information. Learn how to safely mount and use your Thule rooftop tent.</p>
 <p>THULE INSTALLATION > Instructions Thule Awning Adapter 301925</p>	<p>Thule Awning Adapter 301925 Installation Guide</p> <p>Comprehensive installation instructions for the Thule Awning Adapter (model 301925). This guide provides step-by-step directions, compatibility information, and safety warnings for mounting the adapter to various Thule roof bar systems.</p>

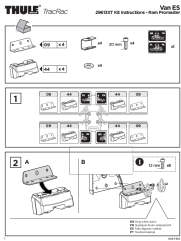

[Thule TracRac 29613XT Kit Installation Instructions for Ram Promaster](#)

Step-by-step installation guide for the Thule TracRac 29613XT kit, designed for Ram Promaster vehicles. Includes parts list, assembly instructions, safety guidelines, and warranty information.



[Thule Product Guide - Van & Minivan Accessories 2020](#)

Explore Thule's 2020 Product Guide for van and minivan accessories, featuring innovative roof rack systems, versatile awnings, smart storage solutions, and specialized carriers for bikes, water sports, and winter sports gear. Discover high-quality, secure, and easy-to-use products designed to enhance your active outdoor lifestyle and simplify bringing all your essential gear.



[Thule Verse Bike Rack Installation and User Manual](#)

Comprehensive instructions for installing and using the Thule Verse 2-Bike 2" and 2-Bike 1.25" bike racks. Includes safety information, load capacity details, and step-by-step assembly guides.



[Thule Verse 2-Bike Rack Installation Guide \(903452, 903651\)](#)

Comprehensive installation and user manual for the Thule Verse 2-bike rack (model 903452) and its add-on (model 903651). Includes parts, assembly, safety, and compatibility information.