

Good Earth Lighting SE1163-WH3-00LF0-G

Good Earth Lighting Three-Head LED Security Flood Light

Model: SE1163-WH3-00LF0-G

1. INTRODUCTION

This manual provides detailed instructions for the installation, operation, and maintenance of your Good Earth Lighting Three-Head LED Security Flood Light, Model SE1163-WH3-00LF0-G. This fixture is designed to provide bright, energy-efficient illumination for outdoor areas such as backyards, driveways, and building perimeters. Please read these instructions thoroughly before installation and retain them for future reference.

2. SAFETY INFORMATION

- **WARNING:** Risk of electric shock. Disconnect power at the fuse or circuit breaker before installation or servicing.
- This product must be installed in accordance with the applicable installation code by a person familiar with the construction and operation of the product and the hazards involved.
- Grounding is required for safe operation.
- Do not handle live wires with wet hands.
- Ensure all connections are secure and properly insulated.
- This fixture is rated for 120V AC power supply.
- Do not attempt to disassemble or modify the integrated LED components. There are no user-serviceable parts inside.

3. PACKAGE CONTENTS

Verify that all components are present before beginning installation:

- Three-Head LED Security Flood Light Fixture

- Universal Mounting Plate
- Mounting Hardware (screws, wire nuts)
- Instruction Manual

4. INSTALLATION INSTRUCTIONS

4.1 Pre-Installation

1. **Turn off power:** Locate the circuit breaker or fuse box controlling the outdoor lighting circuit and turn off the power. Verify power is off using a voltage tester.
2. **Prepare mounting surface:** This fixture is designed for direct wire installation and can be mounted on a wall, eave, or surface box. Ensure the mounting surface is structurally sound and can support the fixture's weight.

4.2 Mounting the Fixture

1. Attach the universal mounting plate to the junction box using the provided screws. Ensure the plate is securely fastened.
2. Feed the electrical wires from the junction box through the center hole of the mounting plate and into the fixture's wiring compartment.



Figure 1: Front view of the Good Earth Lighting Three-Head LED Security Flood Light.

4.3 Wiring Connections

1. Connect the **black** wire from the fixture to the **black** (hot) wire from the junction box using a wire nut.
2. Connect the **white** wire from the fixture to the **white** (neutral) wire from the junction box using a wire nut.
3. Connect the **green** or bare copper (ground) wire from the fixture to the **green** or bare copper (ground) wire from the junction box using a wire nut.

4. Carefully tuck all wires into the junction box and align the fixture with the mounting plate. Secure the fixture to the mounting plate using the provided screws.

4.4 Adjusting Light Heads

The three LED light heads feature swivel joints, allowing for independent adjustment. Loosen the adjustment screws on each head, position the light beam to the desired area, and then securely tighten the screws to lock the position.



Figure 2: Good Earth Lighting flood light installed on an exterior wall, illuminating the area.

5. OPERATION

Once installed and power is restored, the Good Earth Lighting Three-Head LED Security Flood Light operates via a standard wall switch. Flip the switch to the "ON" position to activate the light and to the "OFF" position to deactivate it.

The adjustable heads allow you to direct the light precisely where needed, providing broad coverage for enhanced visibility and security.

6. MAINTENANCE

- **Cleaning:** To clean the fixture, ensure power is off. Use a soft, damp cloth to wipe down the exterior. Do not use abrasive cleaners or solvents, as these may damage the finish or polycarbonate diffuser.
- **LEDs:** This fixture features integrated LED lamps with an estimated life of 50,000 hours. The LEDs are not replaceable. If the LEDs cease to function, the entire fixture should be replaced.
- **Inspection:** Periodically inspect the fixture for any signs of damage, loose wiring, or corrosion. Address any issues promptly to ensure safe and proper operation.

7. TROUBLESHOOTING

| Problem | Possible Cause | Solution |
|----------------------------|--|--|
| Light does not turn on. | No power to the fixture. Loose wiring connection. Faulty wall switch. | Check circuit breaker/fuse. Verify all wire connections are secure (ensure power is off first). Test or replace the wall switch. |
| Light flickers. | Loose wiring connection. Incompatible dimmer switch (this fixture is not designed for dimming). | Check all wire connections (ensure power is off first). Ensure a standard ON/OFF switch is used. |
| Insufficient illumination. | Light heads are not aimed correctly. | Adjust the swivel joints of the light heads to direct light to the desired areas. |

If troubleshooting steps do not resolve the issue, contact customer support.

8. SPECIFICATIONS

Model: SE1163-WH3-00LF0-G

Power Source: AC/DC

Voltage: 120 Volts

Wattage: 34 Watts (LED)

Brightness: 3317 Lumens

Light Color: Day White (approx. 5164 Kelvin)

Light Source Type: Integrated LED

Number of Light Sources: 3

Lamp Life: 50,000 Hours (estimated)

Material: Die-cast Aluminum Housing, Polycarbonate Diffuser

Finish: Textured White

Dimensions: 12.25" L x 9.00" W x 5.75" H

Item Weight: 2.17 lbs

Installation Type: Direct Wire, Surface Mounted, Wall Mounted

Indoor/Outdoor Usage: Outdoor

Special Features: Shatter Resistant Diffuser, Adjustable Heads

Certifications: ETL Listed, Energy Star Certified

UPC: 755284017908

9. WARRANTY AND SUPPORT



This Good Earth Lighting product is backed by a **6-year limited warranty** from the date of purchase.

This warranty covers defects in materials and workmanship under normal use.

For warranty claims, technical assistance, or further inquiries, please contact Good Earth Lighting customer support. Refer to the product packaging or the official Good Earth Lighting website for current contact information.

Note: Keep your purchase receipt as proof of purchase for warranty purposes.

Related Documents - SE1163-WH3-00LF0-G

| | |
|--|--|
|  <p>Good Earth Lighting LED Motion Activated Hyper Bright Flood Light (page 2) Projecteur à DEL Hyper Bright Activé Par Le Mouvement (page 11) Reflector LED Hyper Bright Activado Por Movimiento (page 21) Model: Model: Model: SE1163-WH3-00LF0-G</p> | <p>Good Earth Lighting LED Motion Activated Flood Light Installation and Operation Guide</p> <p>Comprehensive guide for installing and operating the Good Earth Lighting LED Motion Activated Hyper Bright Flood Light. Includes setup instructions, troubleshooting, and feature explanations.</p> |
|  <p>Good Earth Lighting IP65 Motion-Activated 2N1 Downfire Security Light (page 2) Lampe d'éclairage de sécurité à rayonnement vers le sol IP65 2N1 activée par le mouvement (page 12) Luz de seguridad dirigida hacia abajo 2N1 activada por movimiento IP65 (page 22) Model: Model: Model: SE1291-BP2-02LF0-G, SE1291-WH3-02LF0-G</p> | <p>Good Earth Lighting IP65 Motion-Activated Security Light Installation Manual</p> <p>Detailed installation manual for the Good Earth Lighting IP65 Motion-Activated 2N1 Downfire Security Light. Includes setup, wiring, controls, troubleshooting, and warranty information.</p> |
|  <p>Good Earth Lighting IP65 Motion-Activated Security Light (page 2) Lampe d'éclairage de sécurité à rayonnement vers le sol IP65 2N1 activée par le mouvement (page 12) Luz de seguridad dirigida hacia abajo 2N1 activada por movimiento IP65 (page 22) Model: Model: Model: SE1291-BP2-02LF0-G, SE1291-WH3-02LF0-G</p> | <p>Good Earth Lighting IP65 Motion-Activated Security Light Installation and Operation Manual</p> <p>Comprehensive guide for installing, operating, and troubleshooting the Good Earth Lighting IP65 Motion-Activated Security Light (Models SE1291-BP2-02LF0-G, SE1291-WH3-02LF0-G). Includes safety, wiring, controls, and warranty information.</p> |



[Good Earth Lighting IP65 Motion-Activated 2N1 Security Light Installation Manual](#)

This guide provides comprehensive installation and operation instructions for the Good Earth Lighting IP65 Motion-Activated 2N1 Security Light, designed for reliable outdoor security and enhanced property visibility.

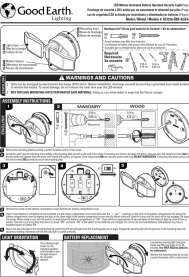

[Good Earth Lighting SE1216-BRS-02LF4-G LED Motion-Activated Security Light Installation and User Guide](#)

Comprehensive guide for the Good Earth Lighting SE1216-BRS-02LF4-G LED motion-activated security light, covering installation, operation, maintenance, and troubleshooting. Features battery power, 40ft detection range, and 180-degree coverage.

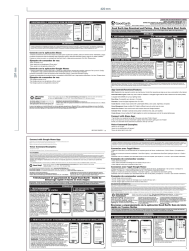

[Good Earth Lighting Smart Under Cabinet Bar Quick Start Guide](#)

A quick start guide for Good Earth Lighting Smart Under Cabinet Bars, detailing app download, registration, device pairing, and voice command integration with Alexa and Google Assistant.