

## KRUPS BW710D51

# KRUPS BW710D51 Electric Kettle Instruction Manual

Model: BW710D51

## INTRODUCTION

This manual provides essential information for the safe and efficient operation of your KRUPS BW710D51 Cool-touch Stainless Steel Electric Kettle. Please read these instructions carefully before first use and retain them for future reference.



Image: The KRUPS BW710D51 Electric Kettle, showcasing its sleek stainless steel design and handle with temperature controls.

## IMPORTANT SAFETY INSTRUCTIONS

When using electrical appliances, basic safety precautions should always be followed, including the following:

- Read all instructions before use.
- Do not touch hot surfaces. Use handles or knobs.
- To protect against fire, electric shock, and injury to persons, do not immerse cord, plugs, or electric

kettle in water or other liquid.

- Close supervision is necessary when any appliance is used by or near children.
- Unplug from outlet when not in use and before cleaning. Allow to cool before putting on or taking off parts, and before cleaning the appliance.
- Do not operate any appliance with a damaged cord or plug or after the appliance malfunctions, or has been damaged in any manner. Return appliance to the nearest authorized service facility for examination, repair, or adjustment.
- The use of accessory attachments not recommended by the appliance manufacturer may result in fire, electric shock, or injury to persons.
- Do not use outdoors.
- Do not let cord hang over edge of table or counter, or touch hot surfaces.
- Do not place on or near a hot gas or electric burner, or in a heated oven.
- Always attach plug to appliance first, then plug cord into the wall outlet. To disconnect, turn any control to "off", then remove plug from wall outlet.
- Do not use appliance for other than intended use.
- Scalding may occur if the lid is removed during the heating cycle.
- This appliance is for household use only.

## PRODUCT OVERVIEW

The KRUPS BW710D51 Electric Kettle is designed for fast and precise water heating. Key features include:

- 1.7 Liter Capacity
- 1500 Watts for Fast Heating
- Adjustable Temperature Control with 6 Pre-set Options (160°F Delicate, 175°F Green, 185°F White, 190°F Oolong, 200°F Herbal, BOIL)
- 30-Minute Keep Warm Function
- Cordless Design with 360° Rotating Base
- Stay-Cool Handle
- One-Touch Easy Open Lid
- Removable Scale Filter



Image: An annotated view of the KRUPS BW710D51 Electric Kettle highlighting its features: 1.7L capacity, 1500 watts, 360° rotating base, removable scale filter, one-touch easy open lid, 6 pre-set temperatures, stay-cool handle, and 30-minute keep warm function.



## 6 PRE-SET TEMPERATURES

Image: A close-up of the kettle's handle, showing the six pre-set temperature buttons (160°F Delicate, 175°F Green, 185°F White, 190°F Oolong, 200°F Herbal, BOIL Black) and the power/warm buttons.

### SETUP

1. **Unpacking:** Carefully remove the kettle and its base from the packaging. Retain packaging for storage or disposal.
2. **Initial Cleaning:** Before first use, fill the kettle with fresh water to the MAX level. Boil the water, then discard it. Repeat this process two to three times to remove any manufacturing residues.
3. **Placement:** Place the power base on a dry, flat, stable, and heat-resistant surface. Ensure the power cord is not dangling where it can be pulled or tripped over.
4. **Power Connection:** Plug the power cord into a grounded electrical outlet.



## CORD-FREE

Image: The KRUPS BW710D51 Electric Kettle separated from its cord-free base, illustrating its cordless convenience.

### OPERATING INSTRUCTIONS

1. **Filling the Kettle:** Press the lid release button to open the lid. Fill the kettle with the desired amount of fresh water, ensuring it is between the MIN (0.5L) and MAX (1.7L) fill lines. Close the lid securely.
2. **Placing on Base:** Place the kettle firmly onto its 360° rotating power base.

### 3. Selecting Temperature:

- Press the power button ( ) to turn on the kettle.
  - Select one of the six pre-set temperature options by pressing the corresponding button on the handle:
    - **160°F (Delicate):** For delicate teas.
    - **175°F (Green):** For green teas.
    - **185°F (White):** For white teas.
    - **190°F (Oolong):** For oolong teas.
    - **200°F (Herbal):** For herbal infusions.
    - **BOIL (Black):** For black coffee or tea, and general boiling.
  - The selected temperature button will illuminate, and the kettle will begin heating.
4. **Boiling Process:** The kettle will automatically shut off once the selected temperature is reached. A chime may sound to indicate completion.
5. **Keep Warm Function:** After reaching the target temperature, press the "WARM" button to activate the 30-minute keep warm function. The kettle will maintain the water at the selected temperature for up to 30 minutes.
6. **Serving:** Carefully lift the kettle from its base to pour. The stay-cool handle ensures safe handling.
7. **Turning Off:** The kettle will automatically turn off when the desired temperature is reached or if it runs dry. To manually turn off, press the power button ( ) again.



**PERFECT FOR  
ALL TEAS**

Image: The KRUPS BW710D51 Electric Kettle on a countertop next to a glass of tea, demonstrating its suitability for various tea types.



Image: A close-up view of the kettle's 360° rotating power base, indicating its rotational capability with arrows.

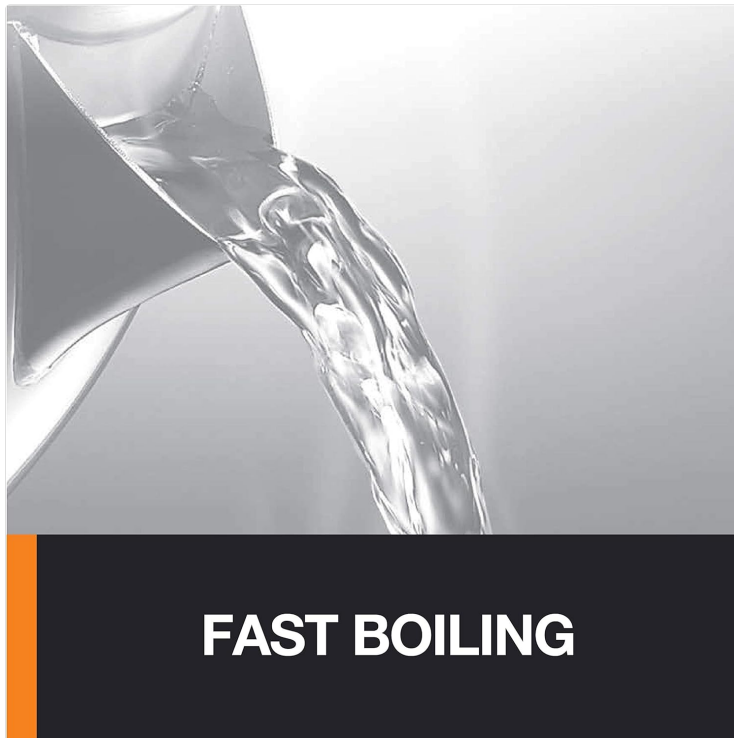

Image: Water being poured from the KRUPS BW710D51 Electric Kettle, illustrating its fast boiling capability.

## MAINTENANCE AND CLEANING

Regular cleaning and maintenance will ensure the longevity and optimal performance of your kettle.

- **Before Cleaning:** Always unplug the kettle from the power outlet and allow it to cool completely before cleaning.
- **Exterior Cleaning:** Wipe the exterior of the kettle and the power base with a damp cloth. Do not use abrasive cleaners or scouring pads, as they may scratch the stainless steel finish.
- **Interior Cleaning (Descaling):** Over time, mineral deposits (limescale) may build up inside the kettle, especially in hard water areas. This can affect performance.
  - Fill the kettle with a mixture of 1 part white vinegar and 2 parts water.
  - Bring the mixture to a boil and let it stand for at least 30 minutes, or longer for heavy deposits.
  - Empty the kettle and rinse thoroughly with fresh water several times.
  - For stubborn deposits, gently scrub the interior with a non-abrasive sponge.
  - Alternatively, use a commercial descaling solution designed for electric kettles, following the product's instructions.

- **Removable Scale Filter:** The kettle includes a removable scale filter. Periodically remove and rinse it under running water to clear any trapped scale. Reinsert it correctly before use.
- **Storage:** When not in use, store the kettle on its base in a dry place.

## TRUBLESHOOTING

Problem	Possible Cause	Solution
Kettle does not heat up.	Not plugged in; kettle not properly seated on base; no power at outlet; kettle has boiled dry.	Ensure plug is firmly in outlet. Place kettle correctly on base. Check circuit breaker. Allow kettle to cool, then refill with water.
Water takes too long to boil.	Limescale buildup; kettle overfilled.	Descale the kettle as per maintenance instructions. Do not exceed the MAX fill line.
Kettle turns off before boiling.	Limescale buildup affecting temperature sensor.	Descale the kettle.
Water has an unusual taste.	New kettle odor; mineral deposits.	Perform initial cleaning steps (boil and discard water several times). Descale the kettle.

## SPECIFICATIONS

- **Model Name:** BW710D51
- **Brand:** KRUPS
- **Capacity:** 1.7 Liters
- **Power:** 1500 Watts
- **Material:** Stainless Steel housing, cool touch handle
- **Color:** Silver
- **Special Features:** Temperature Control, Cordless, 30-minute Keep Warm, Removable Scale Filter
- **Product Dimensions:** 8.9"L x 8.11"W x 9.65"H
- **Item Weight:** 3.8 Pounds
- **UPC:** 010942223924
- **ASIN:** B07BB4H6KX

## WARRANTY AND SUPPORT

This product is covered by a manufacturer's warranty. Please refer to the "Kettle Guarantee Instructions" included with your product for detailed warranty information, terms, and conditions.



For technical support, service, or to inquire about replacement parts, please contact KRUPS customer service. Contact information can typically be found on the manufacturer's website or in the included documentation.





You can also visit the official KRUPS store on Amazon for more information: [KRUPS Store](#)

© 2023 KRUPS. All rights reserved.

This manual is for informational purposes only. Product specifications are subject to change without notice.

## Related Documents - BW710D51

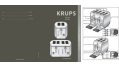
	<p><a href="#">KRUPS Digital Kettle User Manual and Guide</a></p> <p>Comprehensive user manual for the KRUPS Digital Kettle, covering safety instructions, operation, cleaning, maintenance, and troubleshooting for optimal performance.</p>
	<p><a href="#">Krups Excellence Kettle User Manual and Safety Guide</a></p> <p>Comprehensive user manual for the Krups Excellence Kettle, detailing setup, operation, safety precautions, cleaning, descaling, and troubleshooting. Includes multilingual index and safety guidelines.</p>

	<p><a href="#">KRUPS 866 IL Caffè Grande User Manual and Operating Instructions</a></p> <p>Comprehensive user manual and operating instructions for the KRUPS 866 IL Caffè Grande coffee, espresso, and cappuccino maker. Learn about its features, parts, safety precautions, and how to brew perfect espresso.</p>
	<p><a href="#">Krups Digital Kettle User Manual</a></p> <p>Comprehensive user manual for the Krups Digital Kettle, covering safety instructions, operation, cleaning, maintenance, troubleshooting, and warranty information.</p>
	<p><a href="#">KRUPS KH732/KH734 Toaster User Manual: Features, Operation, and Safety</a></p> <p>Comprehensive user manual for KRUPS KH732 and KH734 toasters. Learn about important safety precautions, product features, how to toast bread, use special functions like defrost and bagel, cleaning, troubleshooting, and warranty information.</p>
	<p><a href="#">Krups EA9000 Espresso Automatic User Manual</a></p> <p>Comprehensive user manual for the Krups EA9000 Espresso Automatic coffee machine, covering setup, operation, maintenance, and troubleshooting.</p>

Documents - KRUPS – BW710D51

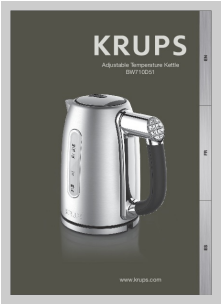

[\[pdf\]](#) User Manual Instructions

Download manual KRUPS ADJUSTABLE TEMPATURE KETTLE 1 7L BW710D51 9100021351 IFU timestamp 20250312005013 dam groupeseb m 3a624838620 EN FR Adjustable Temperature Kettle **BW710D51** www.krups.com ES IMPORTANT SAFEGUARDS IMPORTANT SAFEGUARDS \ precautions should always be followed to reduce the risk of fire, electric shock, and/or injury to persons including the following: Read lang:en score:35 filesize: 457.73 K page\_count: 29 document date: 2020-03-10

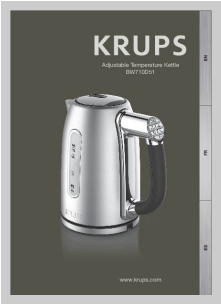

[\[pdf\]](#) User Manual Instructions

User Manual KRUPS BW710D51 Cool touch Stainless Steel Electric Kettle with Adjustable Temperature 1 7 Liter Silver Home Kitchen 813hf2DH2cL m media ama EN FR Adjustable Temperature Kettle **BW710D51** www.krups.com ES IMPORTANT SAFEGUARDS IMPORTANT SAFEGUARDS \ precautions should always be followed to reduce the risk of fire, electric shock, and/or injury to persons including the following: Read lang:en score:33 filesize: 498.93 K page\_count: 29 document date: 2020-04-02

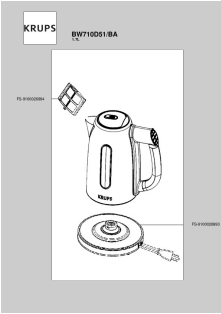

[\[pdf\]](#)

Download the exploded view KRUPS ADJUSTABLE TEMPATURE KETTLE 1 7L BW710D51 explodedview BA dam groupeseb m fb2d4bb6b4348185 original time **BW710D51/BA** 1.7L FS-9100026994 FS-9100026993 ... lang:en score:25 filesize: 16.19 K page\_count: 1 document date: 2024-07-10



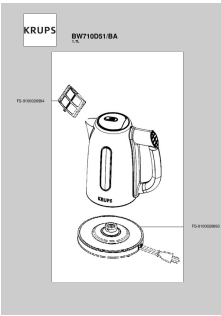

[pdf]

Download the exploded view for BW710D51 BA KRUPS ADJUSTABLE TEMPATURE KETTLE 1 7L explodedview timestamp 20250316193847 dam grou peseb m  
**BW710D51/BA** 1.7L FS-9100026994 FS-9100026993 ...  
lang:en score:25 filesize: 16.24 K page\_count: 1 document date: 2024-07-10

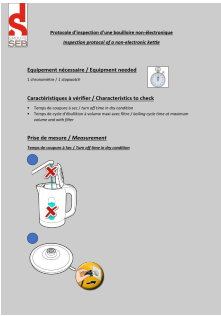

[pdf] User Manual

DUMOUX Marin Download the repair manual KRUPS ADJUSTABLE TEMPATURE KETTLE 1 7L BW710D51 repairmanual 2914478 dam grou peseb m 401423ab  
Protocole d inspection d une bouilloire non-lectronique Inspection protocol of a non-electronic kettle Equipement ncessaire / Equipm  
vrifier / Characteristics to check Temps de coupe sec / turn off time in dry condition Temps de cycle d bull...  
lang:en score:21 filesize: 1.02 M page\_count: 6 document date: 2020-01-31

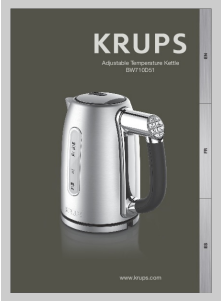

[pdf] Instructions

context bWFzdGVyIHJvb3R8NTA4NDQ2IGFwcGxpY2F0aW9uL3BkZnxoODEvaDRhLzEzMDY1MzlyNjkyNjM4LnBkZnw1NmM5YWM3ZTc0MmNmJmGYxZTc3MjBjI  
bWFzdGVyIHJvb3R8NTA4NDQ2IGFwcGxpY2F0aW9uL3BkZnxoODEvaDRhLzEzMDY1MzlyNjkyNjM4LnBkZnw1NmM5YWM3ZTc0MmNmJmGYxZTc3MjBjNjc4NmI  
EN Adjustable Temperature Kettle BW710D51 3 ENGLISH Never touch the filter or lid when water is boiling open CAUTION This machine intended for household u  
EN FR Adjustable Temperature Kettle **BW710D51** www.krups.com ES IMPORTANT SAFEGUARDS IMPORTANT SAFEGUARDS \n  
precautions should always be followed to reduce the risk of fire, electric shock, and/or injury to persons including the following: Read  
lang:en score:20 filesize: 496.53 K page\_count: 29 document date: 2018-11-08

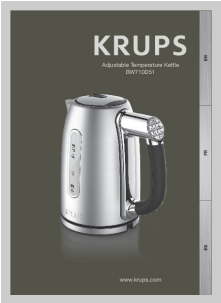

[pdf] Instructions

9100021351 IFU dam grou peseb m 3a624838620fc912 original  
EN FR Adjustable Temperature Kettle **BW710D51** www.krups.com ES IMPORTANT SAFEGUARDS IMPORTANT SAFEGUARDS \n  
precautions should always be followed to reduce the risk of fire, electric shock, and/or injury to persons including the following: Read  
lang:en score:13 filesize: 455.49 K page\_count: 29 document date: 2020-03-10