

Tenda TEF1005D

Tenda TEF1005D 5-Port Fast Ethernet Switch User Manual

Model: TEF1005D

1. INTRODUCTION

The Tenda TEF1005D is a 5-port 10/100Mbps Fast Ethernet Switch designed to expand your wired network connectivity. This unmanaged switch offers plug-and-play functionality, requiring no configuration. Its fanless metal casing ensures quiet operation and efficient heat dissipation, making it suitable for various environments. The device supports both desktop placement and wall-mount installation.

2. PACKAGE CONTENTS

Verify the following items are included in your package:

- Tenda TEF1005D 5-Port Fast Ethernet Switch
- Power Adapter
- Quick Installation Guide



Image: Package contents including the Tenda TEF1005D switch, power adapter, and documentation.

3. PRODUCT OVERVIEW

3.1 Front Panel

The front panel of the TEF1005D features five RJ45 Ethernet ports and LED indicators for power and port status.

Expand Your Network

Add more Gigabit Ethernet ports to your mesh system, routers, smart TV, switches, etc.

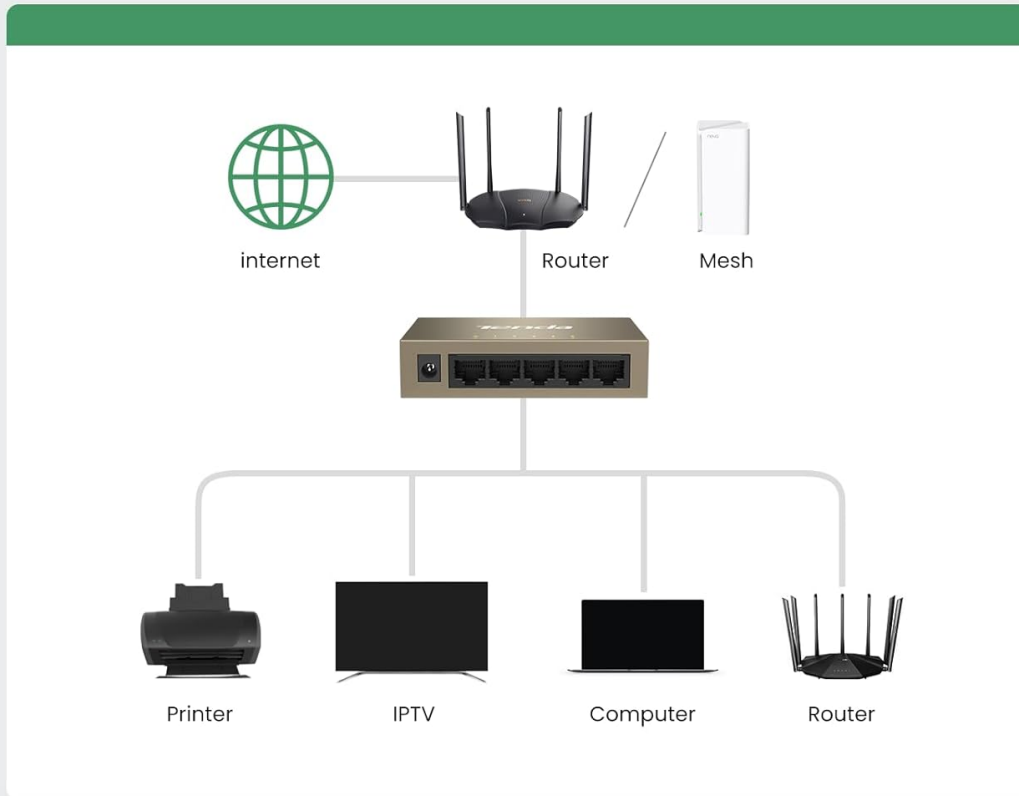

Image: Front view of the Tenda TEF1005D switch.

3.2 LED Indicators

- **Power LED:** Indicates the power status of the switch.
- **Link/Act LEDs (per port):** Indicates a stable network connection (Link) and data activity (Act) on the corresponding port.

3.3 Physical Features

The TEF1005D features a sturdy metal case for enhanced durability and efficient heat dissipation. Its fanless design ensures silent operation. The compact size allows for flexible placement options.

Premium Quality, Longer Life

With a fine steel housing, it features excellent durability and heat dissipation performance.



Image: Tenda TEF1005D switch with its physical dimensions.

4. SETUP

The Tenda TEF1005D is a plug-and-play device, requiring no software configuration. Follow these steps to set up your switch:

1. **Connect Power:** Connect the provided power adapter to the switch's power input port and then plug it into a power outlet. The Power LED should illuminate.
2. **Connect Devices:** Use standard Ethernet cables to connect your network devices (e.g., router, computer, printer, IPTV) to any of the five RJ45 ports on the switch.
3. **Verify Connection:** Once connected, the Link/Act LED for each active port should light up, indicating a successful network connection.

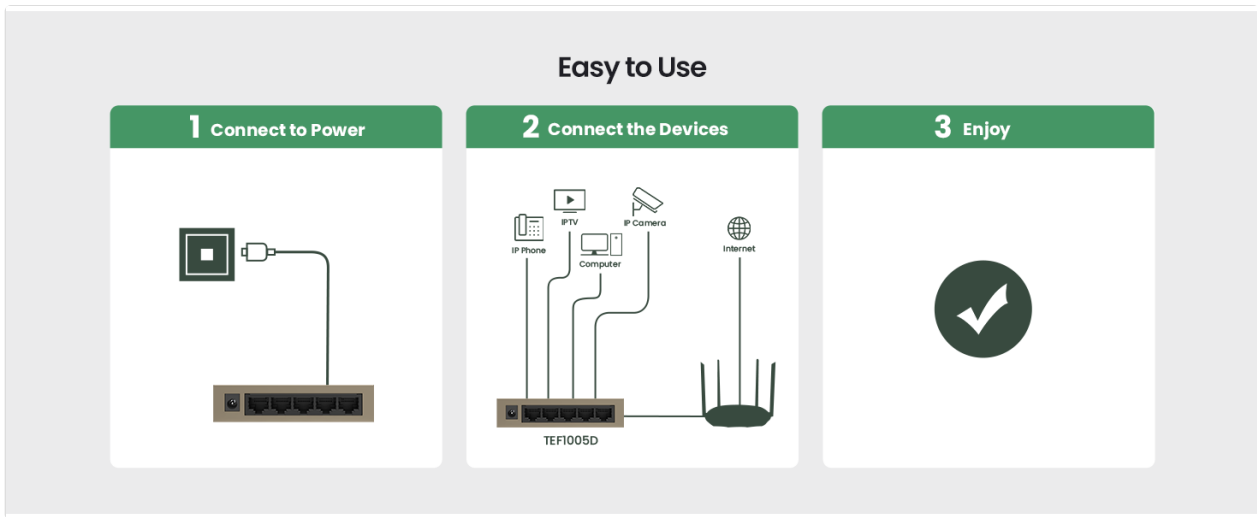

Image: Easy setup steps for the Tenda TEF1005D switch.

4.1 Network Expansion Example

The switch allows you to expand your existing wired network by adding more Ethernet ports to your router or mesh system, connecting devices like smart TVs, printers, and additional computers.



Image: Diagram illustrating how to expand your network using the Tenda TEF1005D switch.

5. OPERATING INSTRUCTIONS

The Tenda TEF1005D operates automatically once connected. It supports Auto-negotiation for speed and duplex mode, and Auto MDI/MDIX, eliminating the need for crossover cables. Data transfer occurs at 10/100Mbps, providing reliable and stable transmission for your connected devices.

■ Reliable Fast Ethernet Switch

TEF1005D provides 5*10/100Mbps ports (Auto MDI/MDIX), achieving high performance and reliability.

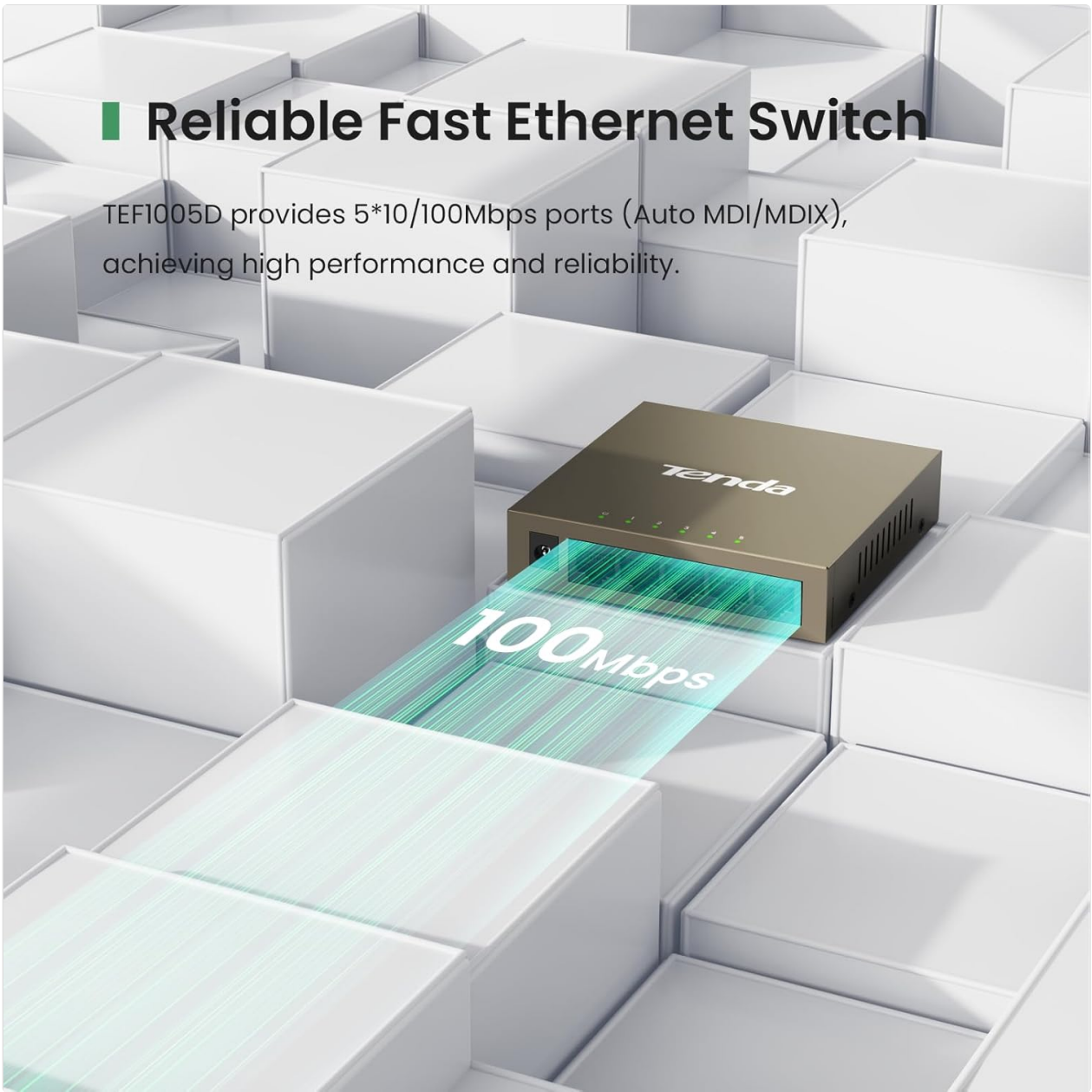

Image: The switch facilitating 100Mbps data transfer.



Reliable and Stable Transmission

Zero packet loss rate of measured transmission data and 7×24 -hour stable operation without dropping the line.

Image: The switch provides reliable and stable 7x24 hour transmission.

6. MAINTENANCE

To ensure optimal performance and longevity of your Tenda TEF1005D switch, follow these maintenance guidelines:

- **Placement:** Place the switch in a cool, dry environment, away from direct sunlight, heat sources, and excessive moisture.
- **Ventilation:** Ensure adequate airflow around the switch. Do not block the ventilation holes on the casing.
- **Cleaning:** Use a soft, dry cloth to clean the exterior of the switch. Do not use liquid or aerosol cleaners.
- **Cable Management:** Keep network cables organized and avoid excessive bending or crimping.
- **Lightning Protection:** The switch features 6kV lightning protection for all ports, enhancing its stability during electrical storms. However, it is always recommended to disconnect the device during severe weather conditions if possible.

■ Fanless Design

Fanless design effectively ensures silent operation of the device.



Image: The fanless design ensures quiet operation.



Image: The all-steel casing provides extraordinary heat dissipation.

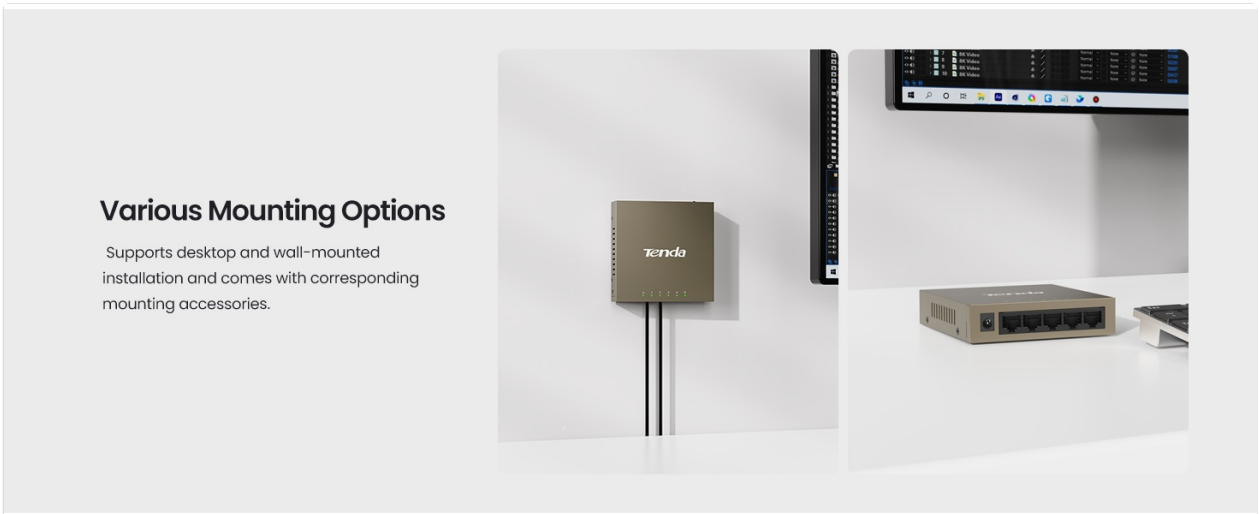

Image: Various mounting options for the switch, including desktop and wall-mounted.

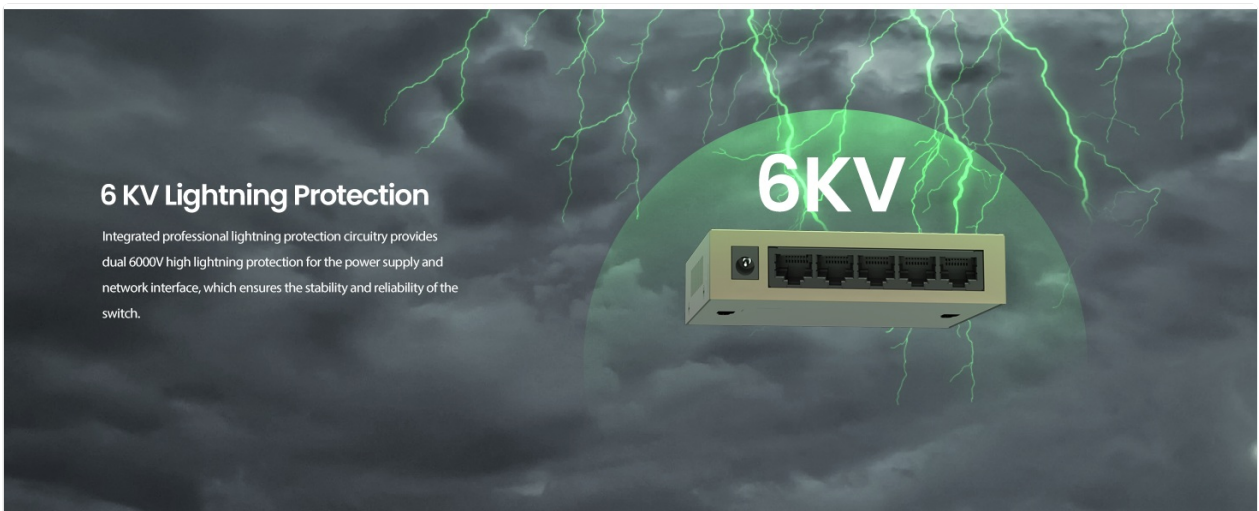

Image: The switch features 6KV lightning protection.

7. TROUBLESHOOTING

If you encounter issues with your Tenda TEF1005D switch, refer to the following common troubleshooting steps:

- **No Power:**

- Ensure the power adapter is securely connected to the switch and a working power outlet.
- Check if the power outlet is functional by plugging in another device.

- **No Link/Activity LED:**

- Verify that the Ethernet cable is properly connected to both the switch port and the network device.
- Ensure the connected network device (e.g., computer, router) is powered on and functioning correctly.
- Try using a different Ethernet cable to rule out cable issues.
- Test with a different port on the switch.

- **Slow Network Speed:**

- Ensure all connected devices and cables support 10/100Mbps speeds.
- Check for excessive network traffic or bandwidth-intensive applications on your network.
- Verify that the Ethernet cables are not damaged or too long.

8. SPECIFICATIONS

Feature	Description
Brand	Tenda
Model Number	TEF1005D
Number of Ports	5
Interface	RJ45
Data Transfer Rate	100 Megabits Per Second
Voltage	5 Volts
Case Material Type	Metal
Item Dimensions (L x W x H)	2.5"L x 3.9"W x 1"H
Item Weight	0.35 Pounds
Lightning Protection	6kV (all ports)
Fanless Design	Yes
Compatible Devices	Printer, IPTV, Computer, Router, etc.

8.1 Energy Efficiency

The Tenda TEF1005D incorporates energy-efficient technology to reduce power consumption while expanding your network capacity.

Save Energy for Greenness

Expand your network capacity while consuming far less power with the latest innovative energy-efficient technology.



other power consumption



TEF1005D less power consumption



Image: The TEF1005D switch demonstrates lower power consumption compared to other devices.

9. WARRANTY AND SUPPORT

Warranty information for the Tenda TEF1005D is not explicitly provided in the product details. For detailed warranty terms and conditions, please refer to the official Tenda website or contact Tenda customer support directly.

For technical support, product inquiries, or further assistance, please visit the official Tenda support page:

[Tenda Official Support](#)