

[manuals.plus](#) /

› [Koolatron](#) /

› [Koolatron Countertop Ice Maker KIM-26B Instruction Manual](#)

Koolatron KIM-26B

Koolatron Countertop Ice Maker Instruction Manual

Model: KIM-26B

WELCOME TO YOUR NEW KOOLATRON ICE MAKER

Thank you for choosing the Koolatron Countertop Ice Maker. This manual provides essential information for the safe and efficient operation, maintenance, and troubleshooting of your new appliance. Please read it thoroughly before first use and keep it for future reference.



The Koolatron Countertop Ice Maker, shown with an ice scoop and freshly made ice cubes.

IMPORTANT SAFETY INSTRUCTIONS

To reduce the risk of fire, electric shock, or injury when using your ice maker, follow these basic precautions:

- Read all instructions before use.
- Do not touch the evaporator or the ice basket when the unit is operating, as this may cause frostbite.
- Do not immerse the appliance, power cord, or plug in water or other liquids.
- Close supervision is necessary when any appliance is used by or near children.
- Unplug the ice maker from the outlet when not in use and before cleaning.
- Do not operate any appliance with a damaged cord or plug, or after the appliance malfunctions or has been damaged in any manner.
- Use only potable water for ice production.
- This product may contain materials cautioned by California Proposition 65.

PRODUCT FEATURES

Your Koolatron Ice Maker is designed for convenience and efficiency:

- **Fast Ice Production:** Produces the first set of 9 bullet-shaped ice cubes in just 6 minutes.
- **High Capacity:** Capable of producing up to 26 lbs (11.7 kg) of ice per day with a 1.85 Liter water reservoir.
- **Dual Ice Cube Sizes:** Choose between large or small ice nuggets to suit your preference.
- **Auto-Clean Function:** Features a self-cleaning cycle for effortless maintenance.
- **Compact Design:** Sleek black stainless steel finish with a portable handle, designed to fit easily on your countertop.
- **User-Friendly Controls:** Simple digital controls for easy operation.

MAKE ICE IN 6 MINS

6MINS  = 9PCS 



Quick ice production in just 6 minutes.



TWO ICE CUBE SIZES



Select between two different ice cube sizes.



SIMPLE DIGITAL CONTROLS



High daily ice production capacity.



Easy-to-use digital control panel.

WHAT'S IN THE BOX

Upon unpacking, please ensure all components are present:

- Ice-maker base unit
- Removable ice bucket
- Ice scoop



The ice maker unit with its included ice scoop.

GETTING STARTED: SETUP

Follow these steps to set up your ice maker for the first time:

1. **Unpack:** Remove all packaging materials and check for any damage. Place the unit on a stable, level surface away from direct sunlight and heat sources. Ensure proper ventilation around the unit.
2. **Clean:** Before first use, clean the interior of the ice maker. Refer to the 'Cleaning and Care' section for detailed instructions.
3. **Add Water:** Open the lid and remove the ice basket. Fill the water reservoir with potable water up to the MAX fill line. Do not overfill.
4. **Plug In:** Connect the power cord to a grounded electrical outlet.



Place your ice maker on a stable countertop.

OPERATION

Once set up, operating your ice maker is straightforward:

1. **Power On:** Press the 'ON/OFF' button on the control panel. The 'POWER' indicator light will illuminate.
2. **Select Ice Size:** Press the 'SELECT' button to choose between small or large ice cubes. The corresponding indicator light ('SMALL' or 'LARGE') will light up.
3. **Ice Production:** The ice maker will begin the ice-making cycle. The first batch of ice will typically be ready in 6-10 minutes, depending on the selected size and ambient temperature.
4. **Ice Full Indicator:** When the ice basket is full, the 'ICE FULL' indicator light will illuminate, and the unit will pause ice production. Remove ice from the basket to resume operation.
5. **Add Water Indicator:** If the water level in the reservoir is too low, the 'ADD WATER' indicator light will illuminate. Add more water to the reservoir to continue ice production.
6. **Power Off:** To stop ice production, press the 'ON/OFF' button again.



The control panel allows for easy power and size selection.

CLEANING AND CARE

Regular cleaning ensures optimal performance and hygiene:

- **Daily Cleaning:** Wipe the exterior with a soft, damp cloth. The removable ice basket and scoop are top-rack dishwasher safe.
- **Self-Cleaning Cycle:**
 - a. Ensure the ice basket is removed.
 - b. Fill the water reservoir with clean water up to the MAX line.
 - c. With the unit in standby mode (plugged in but off), press and hold the 'ON/OFF' button for 5 seconds to initiate the self-cleaning cycle.
 - d. The cycle will run for approximately 30 minutes. Once complete, drain the water.
- **Draining Water:** To drain excess water, locate the drain plug at the bottom of the unit. Place the unit over a sink or use a container to collect the water.

- **Storage:** If storing for an extended period, ensure the unit is completely drained and dry. Store in a cool, dry place.

CLEANING AND MAINTENANCE

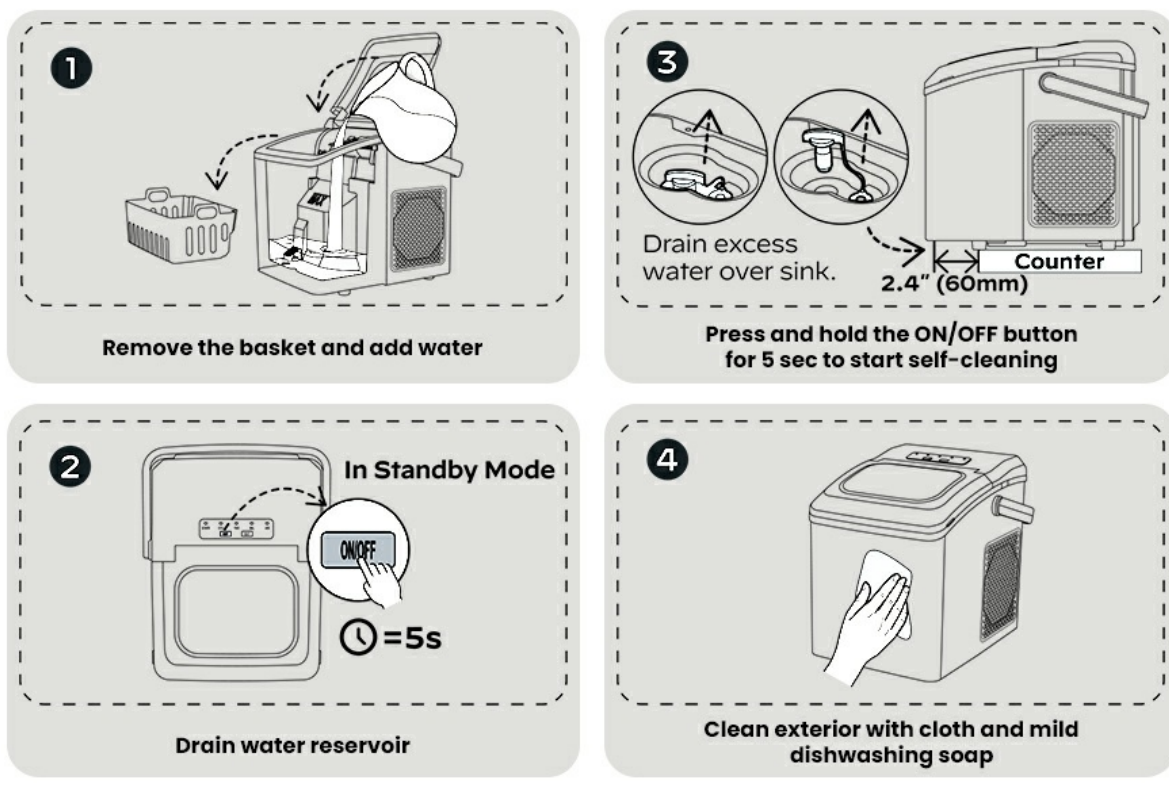

Visual guide for cleaning and maintenance procedures.

TROUBLESHOOTING GUIDE

If you encounter issues with your ice maker, consult the table below:

Problem	Possible Cause	Solution
Ice maker not producing ice.	No water in reservoir; Water pump malfunction; Refrigerant leak.	Add water to MAX line; Check for obstructions in water lines; Contact customer support if issue persists.
'ADD WATER' indicator is on.	Water level is too low.	Fill the water reservoir with potable water.
'ICE FULL' indicator is on.	Ice basket is full; Ice is blocking the sensor.	Remove ice from the basket; Gently move ice away from the sensor.
Ice cubes are too small or not forming properly.	Water temperature too high; Ambient temperature too high; Unit needs cleaning.	Use colder water; Ensure unit is in a cool, well-ventilated area; Perform self-cleaning cycle.
Unit is noisy.	Normal compressor operation; Unit not level; Fan obstruction.	Some noise is normal; Ensure unit is on a level surface; Check for debris near fan vents.
Metallic taste in ice.	New unit residue; Water quality.	Run several cleaning cycles and discard first few batches of ice; Use filtered water.

PRODUCT SPECIFICATIONS

Detailed specifications for your Koolatron Ice Maker:

Specification	Detail
Brand	Koolatron
Model Name	KIM-26B
Product Dimensions	11.5"D x 9.5"W x 11.5"H
Capacity	1.85 Liters (Water Reservoir)
Wattage	105 watts
Voltage	220 Volts
Refrigerant	R600a
Material	Stainless Steel
Item Weight	13.53 pounds
Color	Black
UPC	059586610950



MAKES ICE IN 6 MINUTES

6 MINS  = 9 PCS 

Product dimensions for proper placement.

WARRANTY AND CUSTOMER SUPPORT

Your Koolatron Ice Maker comes with a **1-year warranty**, providing peace of mind and assurance of quality. This warranty covers any manufacturing defects or issues that may arise during normal use.

For warranty claims, technical assistance, or any questions regarding your product, please contact Koolatron Customer Support. Refer to the contact information provided with your purchase or visit the official Koolatron website for the most up-to-date support details.

Please retain your proof of purchase for warranty validation.