

VTech VM3252

VTech VM3252 Video Baby Monitor Instruction Manual

Model: VM3252

INTRODUCTION

The VTech VM3252 Video Baby Monitor provides a secure and reliable way to monitor your baby. This system includes a parent unit with a 2.8-inch color LCD screen and a baby unit (camera). Key features include two-way audio, automatic night vision, a temperature sensor, and soothing lullabies. This manual will guide you through the setup, operation, and maintenance of your monitor.

PACKAGE CONTENTS

Ensure all items are present in your package:

- 1 Parent Unit
- 1 Baby Unit (Camera)
- 2 Power Adapters (one for each unit)



Image: The VTech VM3252 Video Baby Monitor system, showing the parent unit with a screen and the baby unit camera.

SETUP

The VTech VM3252 is designed for easy setup, offering a plug-and-play experience for local monitoring.

1. **Charging the Parent Unit:** Before initial use, fully charge the parent unit battery for optimal performance. Connect the small plug of the power adapter to the parent unit and the large plug to a wall outlet.
2. **Powering the Baby Unit:** Connect the small plug of the power adapter to the baby unit and the large plug to a wall outlet. The baby unit will power on automatically.
3. **Placement:** Position the baby unit in the nursery, ensuring a clear view of your baby. The camera angle can be adjusted manually. Keep the baby unit at least 3 feet (1 meter) away from your baby to avoid potential hazards.
4. **Link Confirmation:** Once both units are powered on, they should automatically link. The parent unit display will show the video feed from the baby unit.

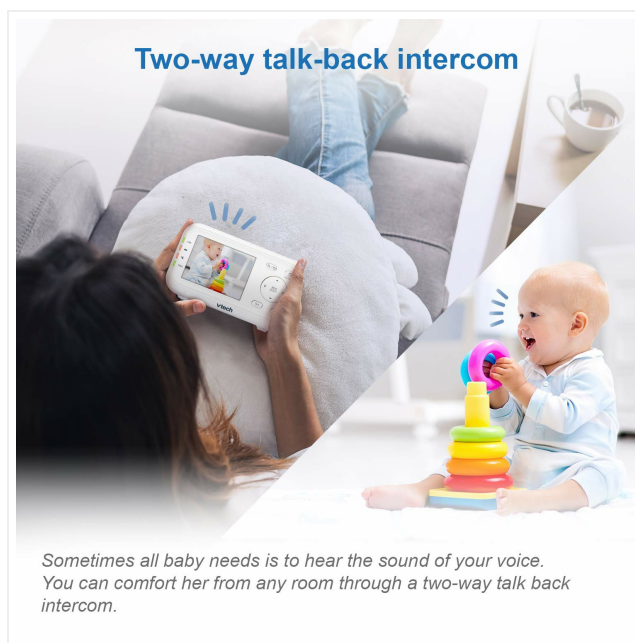

Image: Diagram illustrating the simple plug-and-play setup of the VTech VM3252 monitor, showing the baby unit and parent unit connecting wirelessly.

FEATURES

The VTech VM3252 monitor is equipped with several features to enhance your monitoring experience:

- **2.8-inch Color LCD Screen:** Provides a clear view of your baby.
- **Long Range:** Maintain connection up to 1000 feet outdoors, allowing you to move freely around your home or yard.
- **Two-Way Talk-Back Intercom:** Comfort your baby from another room by speaking through the parent unit.
- **Automatic Infrared Night Vision:** The camera automatically adjusts to low-light conditions, providing a clear black-and-white image in the dark.
- **Temperature Sensor:** Monitors the room temperature in your baby's nursery and alerts you if it goes outside a set range.
- **Soothing Sounds and Lullabies:** Play 5 calming melodies and 4 ambient sounds directly from the baby unit to help your baby sleep.
- **Sound Activation Mode:** The parent unit screen can be set to turn off to save power and activate only when noise is detected from the baby unit.
- **Wall-Mountable Camera:** The baby unit can be mounted on a wall for optimal positioning.

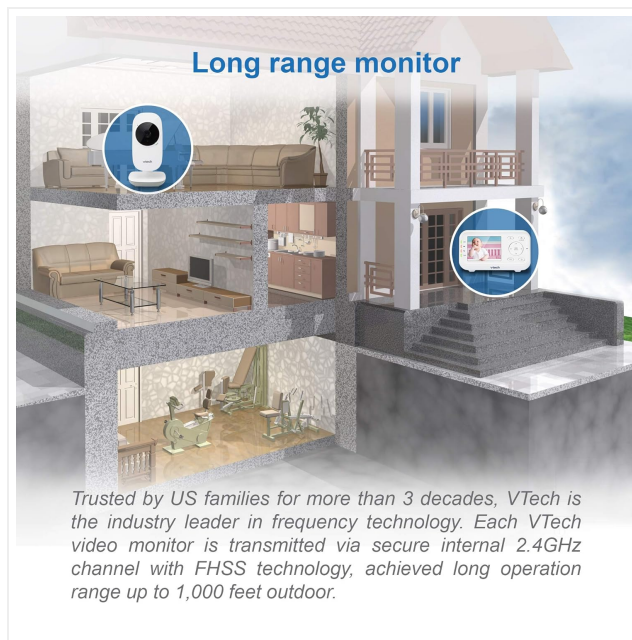

Image: An overview of the VTech VM3252's key features, including full-motion video, adjustable camera angle, temperature sensor, wall-mountability, 1000ft range, 6-level sound indicator, volume control, two-way talk, automatic infrared night vision, and sound activation mode.



Image: A diagram illustrating the 1000ft long-range capability of the VTech VM3252 monitor, showing connectivity across multiple rooms and outdoors.



Image: A visual representation of the 2.8-inch screen displaying a baby, highlighting the clear view provided by the monitor.



Image: A parent using the VTech VM3252 parent unit to communicate with a baby, demonstrating the two-way talk-back intercom feature.

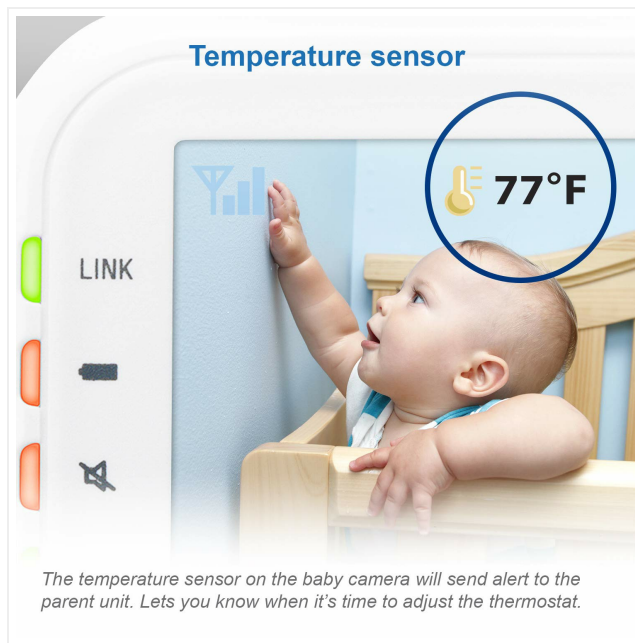

Image: A split view showing the VTech VM3252 monitor display in both day vision (color) and automatic infrared night vision (black and white).



Image: The VTech VM3252 parent unit displaying the room temperature, indicating the built-in temperature sensor feature.



Image: A parent holding the VTech VM3252 parent unit, which is displaying a baby and sound wave icons, illustrating the sound activation mode.

OPERATING INSTRUCTIONS

Familiarize yourself with the parent unit controls to utilize all monitor functions.

- **Power On/Off:** Press and hold the power button on the parent unit to turn it on or off. The baby unit powers on automatically when connected to power.
- **Volume Control:** Use the volume buttons on the parent unit to adjust the listening volume.
- **Two-Way Talk:** Press and hold the 'TALK' button on the parent unit to speak to your baby through the baby unit's speaker. Release the button to hear your baby.
- **Lullabies:** Access the menu on the parent unit to select and play lullabies or soothing sounds. You can choose from 5 melodies and 4 ambient sounds.
- **Temperature Alerts:** The parent unit will display the temperature detected by the baby unit. You can set alerts for temperatures outside your preferred range through the menu.
- **Sound Activation (VOX) Mode:** Enable VOX mode in the parent unit's menu. This feature turns off the screen to conserve battery and activates it when sound is detected from the baby's room.
- **Zoom:** Use the zoom function in the parent unit's menu to get a closer look at your baby.

MAINTENANCE

Proper care ensures the longevity of your VTech VM3252 monitor.

- **Cleaning:** Clean the monitor units with a soft, damp cloth. Do not use cleaning sprays or liquid cleaners.
- **Battery Care:** For optimal battery life, fully charge the parent unit before first use. Avoid extreme temperatures.
- **Storage:** If storing the monitor for an extended period, remove the battery from the parent unit and store both units in a cool, dry place.

TROUBLESHOOTING

If you encounter issues with your monitor, refer to the following common solutions:

Problem	Solution
No picture/sound on parent unit	Ensure both units are powered on and connected to their adapters. Check if the parent unit battery is charged. Move the parent unit closer to the baby unit.
Static or interference	Move the units away from other electronic devices (e.g., cell phones, Wi-Fi routers). Adjust the position of the baby unit.
Parent unit beeps	This may indicate low battery, out of range, or a temperature alert. Check the icons on the screen for specific indicators.
Cannot hear baby	Increase the volume on the parent unit. Ensure the baby unit is not too far from the baby.

SPECIFICATIONS





Feature	Detail
Model Name	VM3252
Screen Size	2.8 Inches
Connectivity Technology	Wireless (2.4 GHz FHSS)
Video Capture Resolution	480p
Range	Up to 1000 feet (outdoor)
Battery Life (Parent Unit)	Up to 9 Hours
Power Source	Battery Powered (Parent Unit), AC Adapter (Both Units)
Mounting Type	Wall Mount
Special Features	2-Way Audio, Cry Detection, Night Vision, Temperature Sensor, Lullabies, Sound Activation Mode
Item Weight	1.28 pounds
Product Dimensions	4.89 x 4.77 x 2.83 inches

WARRANTY AND SUPPORT

For warranty information or technical support, please refer to the documentation included with your product or visit the official VTech website. Keep your purchase receipt as proof of purchase.



Related Documents

	<p>VTech VM3252/VM3252-2 Video Baby Monitor Quick Start Guide</p> <p>A comprehensive guide to setting up and operating the VTech VM3252 and VM3252-2 video baby monitors. This document covers essential safety information, step-by-step setup instructions, basic operations, troubleshooting tips, and technical specifications.</p>
	<p>VTech VM819-2 Video Baby Monitor FAQ and Troubleshooting Guide</p> <p>Comprehensive FAQ and troubleshooting guide for the VTech VM819-2 Video Baby Monitor. Find solutions for common issues including pairing baby and parent units, battery charging problems, audio not working, connection errors, and intermittent performance. Learn how to reset your device and optimize settings for reliable monitoring.</p>
	<p>VTech VM3254/VM3254-2 Video Baby Monitor: Setup, Features, and Safety Guide</p> <p>Learn how to set up and use your VTech VM3254 or VM3254-2 video baby monitor. This guide covers basic operations, key features like night vision and two-way talk, important safety instructions, technical specifications, and troubleshooting tips.</p>
	<p>VTech VM3252/VM3252-2 Video Monitor Quick Start Guide</p> <p>Comprehensive guide for setting up and using the VTech VM3252 and VM3252-2 Video Monitors, including safety instructions, operation, features, troubleshooting, and warranty information.</p>

Documents - VTech – VM3252

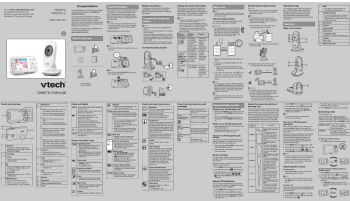

[VTech VM3252/VM3252-2 Video Monitor User Manual](#)

User manual for the VTech VM3252 and VM3252-2 video baby monitors. Includes setup, operation, features, troubleshooting, and safety instructions.

lang:en score:48 filesize: 4.4 M page_count: 2 document date: 2018-01-19

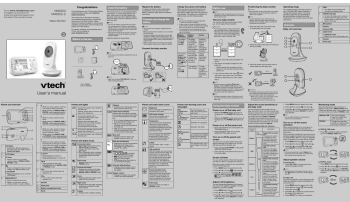

[\[pdf\] User Manual Instructions Warranty](#)

User s manual on purchasing your new VTech product Before using this please read Important safety instructions VM3252 X CIB V1 20171025 cdn media vtechphones products VM

Go to [www.vtechphones.com](#) to register your product for enhanced warranty support and the latest VTech product news. **VM3252 VM3252-2** Video Monitor BC User s manual Parent unit overview b c d a e f g h i j m k l n 1 LED lights Indicate the different statuses of the parent unit. For details,...

lang:en score:47 filesize: 3.77 M page_count: 2 document date: 2017-10-26

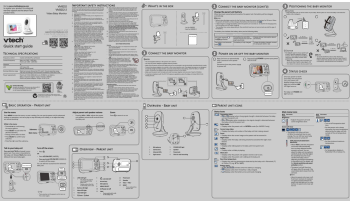

[\[pdf\] Quick Start Guide Instructions Specifications Guide Warranty](#)

3 Positioning the baby monitorQuick start guide© 2025 VTech Communications Inc All rights reserved 03 25 VM3252 Quick guide Talk to your unit Press and hold TALK speak toC1pU79WNw3LC1pU79WNw3Lm media amazon images I C1pU79WNw3Lm C1pU79WNw3L |||

Go to [www.vtechbabycare.com](#) to register your product for enhanced warranty support and the latest VTech product news. **VM3252 VM3252-2** Video Baby Monitor For more support, email support [vtechbabycare.com](#) or scan the QR code below for product information. Quick start guide S m **VM3252 VM3252-2** T...

lang:en score:44 filesize: 6 M page_count: 2 document date: 2025-04-01

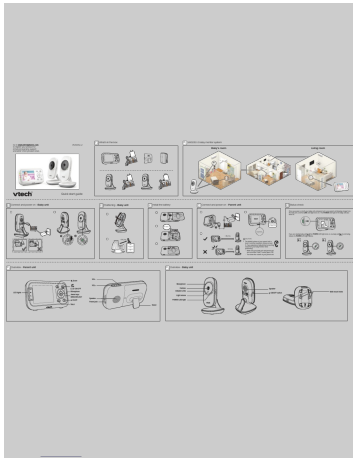

[\[pdf\]](#) User Manual Quick Start Guide Installation Guide Guide Warranty

Provided by ManualsAndMore Download User Manual VTech VM3252 2 Quick Start vtech vm32522 quick start manual 1 manualsandmore |||

Go to www.vtechphones.com to register your product for enhanced warranty support and latest VTech product news. **VM3252-2** What s in the box **VM3252-2** baby monitor system Baby s room Living room Connect and power on - Baby unit Quick start guide Positioning - Baby unit Overview - Parent unit LE...

lang:en **score:43** filesize: 7.13 M page_count: 2 document date: 2019-07-24

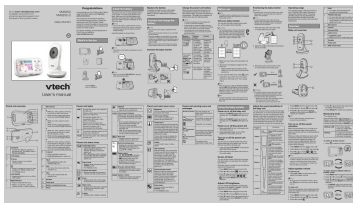

[\[pdf\]](#) User Manual Warranty

Vtech VM3252 2 Video Monitor User Manual Manuals Clip X CIB V4 20180119 manualsclip 2023 03 |||

Go to www.vtechphones.com to register your product for enhanced warranty support and the latest VTech product news. **VM3252 VM3252-2** Video Monitor BC User s manual Parent unit overview b c d e a f g h i j k n l m o 1 LED lights Indicate the different statuses of the parent unit. For det...

lang:en **score:43** filesize: 1.4 M page_count: 2 document date: 2023-03-08

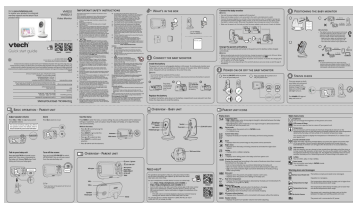

[VTech VM3252/VM3252-2 Video Baby Monitor Quick Start Guide](#)

A comprehensive guide to setting up and operating the VTech VM3252 and VM3252-2 video baby monitors. This document covers essential safety information, step-by-step setup instructions, basic operations, troubleshooting tips, and technical specifications.

lang:en **score:42** filesize: 6.15 M page_count: 2 document date: 2020-09-28

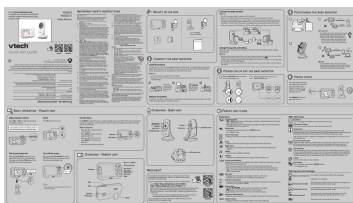

[\[pdf\]](#) Quick Start Guide Frequently Asked Questions Specifications Guide Warranty

Quick start guide VM3252-X_QSG_V8_20200807 cdn-web vtp-media products VM VM3252 No N L 3 CAUTION: D R E H N É K RK For operations and guides to help you using your video monitor for latest information supports go check the online topics FAQs

Credits: The Background Noise sound file was created by Caroline Ford, and is used under the Creativ ... ones.com to register your product for enhanced warranty support and the latest VTech product news. **VM3252 VM3252-2** Video Monitor Quick start guide For more support information S m **VM3252 VM3252-2**...

lang:en **score:42** filesize: 6.08 M page_count: 2 document date: 2020-08-11

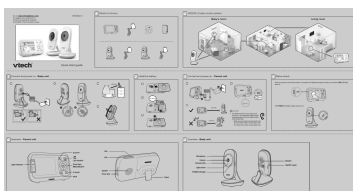

[\[pdf\]](#) User Manual Quick Start Guide Installation Guide Guide Warranty

VTECH VM3252 2 01 MANUAL drive google uc id 15SQtedjTa9EfPoT2ZobvEwM81MeQ dGj export |||

Go to www.vtechphones.com to register your product for enhanced warranty support and latest VTech product news. **VM3252-2** What s in the box **VM3252-2** baby monitor system Baby s room Living room Connect and power on - Baby unit Quick start guide 3ft 1m Overview - Parent unit Light indicator...

lang:en **score:41** filesize: 5.71 M page_count: 2 document date: 2017-10-26

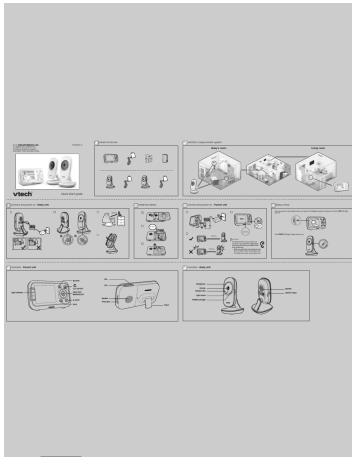

[\[pdf\]](#) User Manual Quick Start Guide Installation Guide Guide Warranty

Provided by ManualsAndMore Download User Manual VTech VM3252 2 Quick Start VM32522 manualsandmore |||

Go to www.vtechphones.com to register your product for enhanced warranty support and latest VTech product news. **VM3252-2** What s in the box **VM3252-2** baby monitor system Baby s room Living room Connect and power on - Baby unit Quick start guide 3ft 1m Overview - Parent unit Light indicator...

lang:en **score:41** filesize: 5.7 M page_count: 2 document date: 2019-07-24

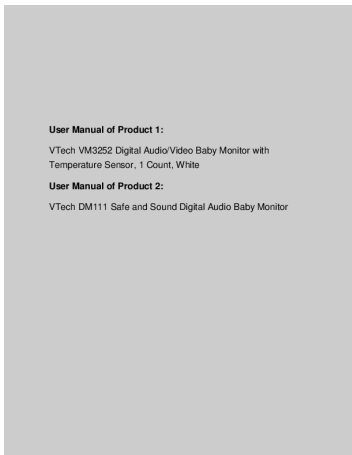

[\[pdf\]](#) User Manual Installation Guide Instructions Troubleshooting Guide Warranty

User Manual of Product 1 VTech VM3252 Digital Audio Video BabyFollow the instructions to install and charge battery The CEC charging testing mode is activated while Even if parent unit paired C1Yg NY2QTLm media amazon images I C1Yg NY2QTL BabyUser paired DM111 DM111 2 DM112 Monitor Go vtechcanada for latest product news Congratulations on purchasing your new m ||| ||| User Manual of Product 1: VTech VM3252 Digital Audio/Video Baby Monitor with Temperature Sensor, 1 Count, White User Manual of Product 2: VTech DM111 Safe and Sound Digital Audio Baby Monitor Go to www.vtechphones.com to register your produ

User Manual of Product 1: VTech**VM3252** Digital Audio/Video Baby Monitor with Temperature Sensor, 1 Count, White User Manual of Product 2: VTech DM111 Safe and Sound Digital Audio Baby Monitor Go to www.vtechphones.com to register your product for enhanced warranty support and the latest VTech prod...

lang:en **score:40** filesize: 7.36 M page_count: 7 document date: 2023-05-31

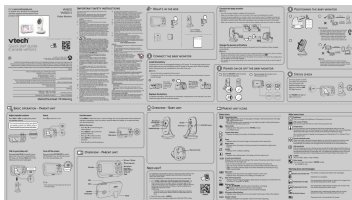

[VTech VM3252/VM3252-2 Video Monitor Quick Start Guide](#)

Comprehensive guide for setting up and using the VTech VM3252 and VM3252-2 Video Monitors, including safety instructions, operation, features, troubleshooting, and warranty information.

lang:en **score:39** filesize: 5.98 M page_count: 2 document date: 2020-08-11

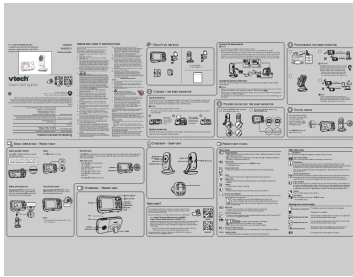

[\[pdf\]](#) User Manual Quick Start Guide Specifications Guide Warranty

VM3252 X QSG V9 20200928 herbertw User Manual VTech Telecommunications Ltd 80 1320 01A Video

Baby Monitor Parent Unit EW780 EW780132001A 01a

Credits: The Background Noise sound file was created by Caroline Ford, and is used under the Creativ ... are subject to change without notice. 2020 VTech

Communications, Inc. All rights reserved. 09/20. **VM3252-X_QSG_V9**. Crystal controlled PLL synthesizer Baby unit: 2405 - 2475 MHz Parent unit: 2405 - ...

lang:en **score:36** filesize: 2.05 M page_count: 2 document date: 2020-09-28



[\[pdf\]](#) Quick Start Guide Installation Guide Specifications Guide Warranty

Quick start guide Go to vtechphones register your product for enhanced warranty support and the latest VTech news What s in box VM3252 2 1 Install battery 3 Power on or off baby monitor Slide ON OFF

switch power unit Press hold parent Caution C1 0vEzSRvS m media amazon images I

Go to www.vtechphones.com to register your product for enhanced warranty support and the latest VTech product news. **VM3252 VM3252-2** Video Monitor What s in the box **VM3252 VM3252-2** Specifications are subject to change without notice. 2018 VTech Communications, Inc. All rights reserved. 10/18. VM...

lang:en **score:36** filesize: 6.26 M page_count: 2 document date: 2018-10-29



[\[pdf\]](#) Quick Start Guide Installation Guide Specifications Guide Warranty

Quick start guide m media amazon Go to vtechphones register your product for enhanced warranty support and the latest VTech news What s in box VM3252 2 1 Install battery 3 Power on or off baby

monitor Slide ON OFF switch power unit Press hold parent Caution C16WAtSj9GS images I

Go to www.vtechphones.com to register your product for enhanced warranty support and the latest VTech product news. **VM3252 VM3252-2** Video Monitor What s in the box **VM3252 VM3252-2** Specifications are subject to change without notice. 2019 VTech Communications, Inc. All rights reserved. 03/19. VM...

lang:en **score:36** filesize: 6.26 M page_count: 2 document date: 2019-03-06

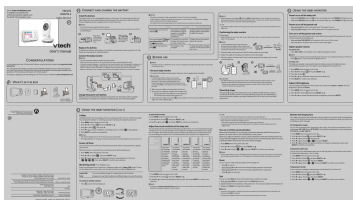

[\[pdf\]](#) User Manual Installation Guide Instructions Troubleshooting Guide Warranty Label

User s manual Congratulations VM3252 X CIB V7 20181113 cdn web vtp media products VM

Go to www.vtechphones.com to register your product for enhanced warranty support and the latest VTech product news. **VM3252 VM3252-2** Video Monitor User s manual Congratulations on purchasing your new VTech product. Before using this product, please read Important safety instructions. This manual ha...

lang:en **score:36** filesize: 4.63 M page_count: 2 document date: 2018-11-13

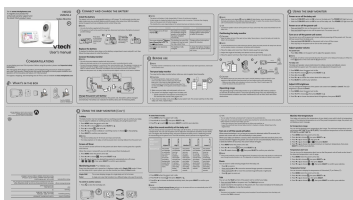

[\[pdf\]](#) User Manual Installation Guide Instructions Troubleshooting Guide Warranty Label

User s manual Congratulations VM3252 X CIB V6 20180725 cdn web vtp media products VM |||

Go to www.vtechphones.com to register your product for enhanced warranty support and the latest VTech product news. **VM3252 VM3252-2** Video Monitor User s manual Congratulations on purchasing your new VTech product. Before using this product, please read Important safety instructions. This manual ha...

lang:en **score:36** filesize: 4.37 M page_count: 2 document date: 2018-07-25

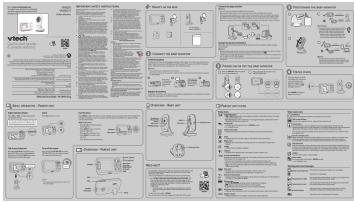

[\[pdf\]](#) Quick Start Guide Specifications Guide Warranty

Quick start guide Canada versionm media amazonC1J1UEsmCCLm amazon images I C1J1UEsmCCL
ref dp product quick view |||

Credits: The Background Noise sound file was created by Caroline Ford, and is used under the Creativ ... are subject to change without notice. 2020 VTech Communications, Inc. All rights reserved. 08/20. **VM3252-X_CA_QSG_V4**. Frequency control Transmit frequency Channels LCD Nominal effective range Power...
lang:en **score:34** filesize: 5.98 M page_count: 2 document date: 2020-08-11

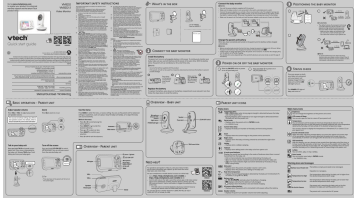

[VTech VM3252 / VM3252-2 Video Baby Monitor Quick Start Guide](#)

This VTech VM3252 and VM3252-2 video baby monitor quick start guide provides essential safety instructions, setup steps, basic operation details, and technical specifications for new parents.

lang:en **score:32** filesize: 3.92 M page_count: 1 document date: 2024-04-11

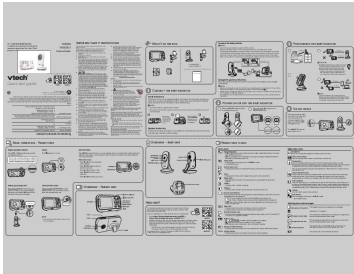

[\[pdf\]](#) User Manual Quick Start Guide Specifications Guide Warranty

Manual User VTech Telecommunications Ltd 80 1320 00 Video Monitor Baby Unit EW780 EW780132000

Credits: The Background Noise sound file was created by Caroline Ford, and is used under the Creativ ... are subject to change without notice. 2020 VTech Communications, Inc. All rights reserved. 09/20. **VM3252-X_QSG_V9**. Crystal controlled PLL synthesizer Baby unit: 2405 - 2475 MHz Parent unit: 2405 - ...
lang:en **score:32** filesize: 2.05 M page_count: 2 document date: 2020-09-28

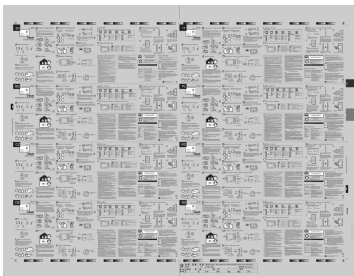

[\[pdf\]](#) Quick Start Guide Guide

VM3252 QSG EE 96 012450 010 100 00 012451 1A cdn vtech jouets assets 4c0d8a51 550c 4a11 9665
26507ff9de57

. 96-012450-010-100-00-00.p1.pdf EN **VM3252** Video Monitor 1 Connect the baby monitor NOTES Use only the power adaptors supplied with this product. Make sure the baby monitor is not connected to the switch controlled electric outlet. Connect the power adaptors in a vertical or floor mount po...

lang:en **score:31** filesize: 34.79 M page_count: 2 document date: 2018-11-20

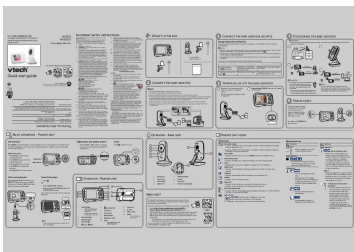

[\[pdf\]](#) User Manual Quick Start Guide Instructions Specifications Guide Warranty

Manual herbertw User VTech Telecommunications Ltd 80 1320 00A Video Baby Monitor Parent Unit EW780 EW780132000A 00a

Crystal controlled PLL synthesizer Baby unit: 2405 - 2475 MHz Parent unit: 2405 - 2475 MHz 32 2.8 C ... are subject to change without notice. 2022 VTech Communications, Inc. All rights reserved. 09/22. **VM3252-X_QSG_V1**. Frequency control Transmit frequency Channels LCD Nominal effective range Power re...
lang:en **score:31** filesize: 2.15 M page_count: 2 document date: 2022-12-08

[\[pdf\]](#) User Manual Installation Guide Instructions Troubleshooting Guide Warranty Label

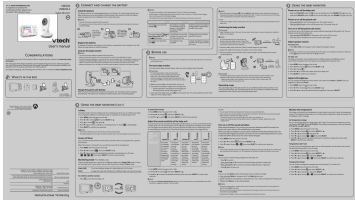

THIS SIDE UP 3ft 1m User s manual Note This baby monitor is intended as an aid It not a substitute for proper adult supervision and should be used such Test your VM3252 X CIB V8 20190306 web vtp media products VM Mar 06 2019 · Congratulations **Available via firmware update later in KEY FEATURES DESCR cdn

Go to www.vtechphones.com to register your product for enhanced warranty support and the latest VTech product news. **VM3252 VM3252-2** Video Monitor User s manual Congratulations on purchasing your new VTech product. Before using this product, please read Important safety instructions. This manual ha...

lang:en score:30 filesize: 4.63 M page_count: 2 document date: 2019-03-06

[\[pdf\]](#) Label

VM3252 series label artwork 80 1320 xx 11 1329 Label Artwork and Location VTech Telecommunications Ltd 3401 01 Video Baby Monitor EW780 EW780340101

VM3252 Series Engraving draft_R0 PU MANUFACTURED IN CHINA FCC ID: EW780-3401-01 IC: 1135B-80340101 HVIN: 35-201977PUA Model: **VM3252** PU S/N: XXXXXXXXXXXX A/V I.C.T.E. VTech Customer Service 1-800-595-9511 www.vtechphones.com 16MBCFM MANUFACTURED IN CHINA FCC ID: EW780-3401-01 IC: 1135B-80340101 HV...

lang:de score:30 filesize: 998.68 K page_count: 1 document date: 2024-04-10

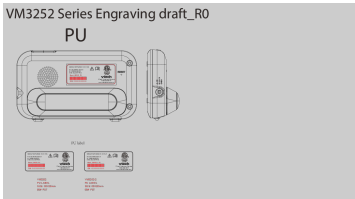

[\[pdf\]](#) Label

VM3252 series label artwork 80 1320 00 11 herbertw Label Artwork and Location VTech Telecommunications Ltd 00A Video Baby Monitor Parent Unit EW780 EW780132000A 00a MANUFACTURED IN CHINA FCC ID: EW780-1320-00A IC: 1135B-80132000A HVIN: 35-201987PU Model: **VM3252** PU S/N: XXXXXXXXXXXX VTech Customer Service 1-800-595-9511 www.vtechphones.com 16MBCFM MANUFACTURED IN CHINA FCC ID: EW780-1320-00A IC: 1135B-80132000A HVIN: 35-201987PU Model: **VM3252** PU S/N: XXXXXXXXXXXX...

lang:de score:29 filesize: 94.16 K page_count: 1 document date: 2022-12-08

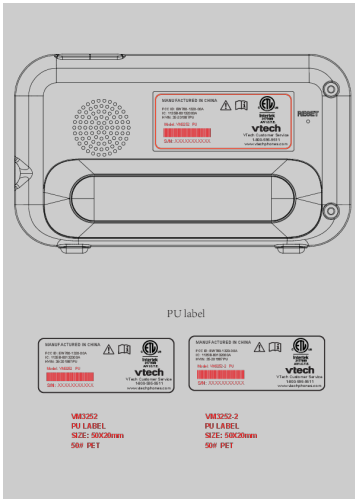

[\[pdf\]](#) Label

92 033348 010 100 VM3252 BU LABEL R0 Label Artwork and Location VTech Telecommunications Ltd 80 1320 00 Video Monitor Baby Unit EW780 EW780132000

VM3252 US CAN label artwork BU MANUFACTURED IN CHINA www.vtechphones.com VTech Customer Service 1-800-595-9511 A/V I.C.T.E. FCC ID: EW780-1320-00 IC: 1135B-80132000 HVIN: 35-201850BU DC 6V 500mA Model: **VM3252** BU S/N: XXXXXXXXXXXX #6MBCFM MANUFACTURED IN CHINA www.vtechphones.com VTech Customer Ser...

lang:i-klingson score:29 filesize: 702.26 K page_count: 1 document date: 2022-08-18

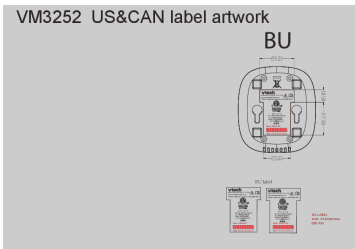

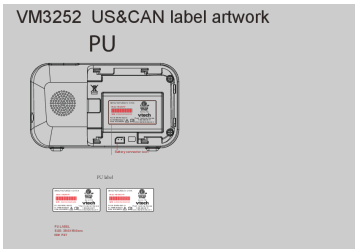

[pdf] Label

92 033348 010 100 VM3252 BU LABEL R0 Label Artwork and Location VTech Telecommunications Ltd

80 1320 01 Video Monitor Parent Unit EW780 EW780132001

VM3252 US CAN label artwork PU MANUFACTURED IN CHINA Model: **VM3252** PU

S/N: XXXXXXXXXXXX A/V I.C.T.E. FCC ID: EW780-1320-01 IC: 1135B-80132001

HVIN: 35-201853PU VTech Customer Service 1-800-595-9511

www.vtechphones.com Battery connector icon 16MBCFM MANUFACTURED IN CHINA Model: **VM3252** PU S/N:...

lang:de score:29 filesize: 722.63 K page_count: 1 document date: 2022-07-26

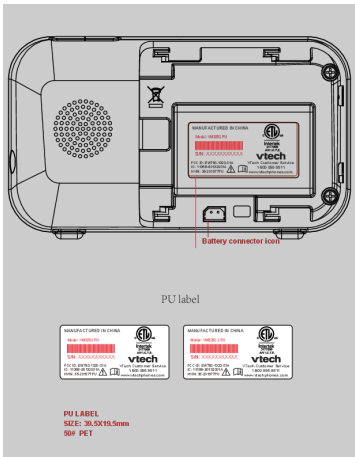

[pdf] Label

VM3252 series label artwork June 01 2022 herbertw Label Artwork and Location VTech

Telecommunications Ltd 80 1320 01A Video Baby Monitor Parent Unit EW780 EW780132001A 01a

PU MANUFACTURED IN CHINA Model: **VM3252** PU S/N: XXXXXXXXXXXX FCC ID:

EW780-1320-01A IC: 1135B-80132001A HVIN: 35-201977PU VTech Customer

Service 1-800-595-9511 www.vtechphones.com Battery connector icon 16MBCFM

MANUFACTURED IN CHINA Model: **VM3252** PU S/N: XXXXXXXXXXXX FCC ID:

EW780-1320-01A IC:...

lang:de score:29 filesize: 121.1 K page_count: 1 document date: 2022-06-01

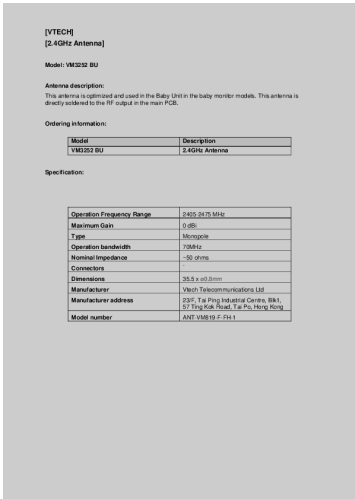

[pdf] Specifications Datasheet Dimension Guide Test Report

Microsoft Word Antenna Data Sheet VM3252 BU update docx VTT08078 Test Report VTech

Telecommunications Ltd 80 1320 00 Video Monitor Baby Unit EW780 EW780132000

VTECH 2.4GHz Antenna Model: **VM3252** BU Antenna description: This antenna is

optimized and used in the Baby Unit in the baby monitor models. This antenna is

directly soldered to the RF output in the main PCB. Ordering information: Model

VM3252 BU Description 2.4GHz Antenna Specification: Oper...

lang:en score:28 filesize: 344.76 K page_count: 3 document date: 2023-05-30

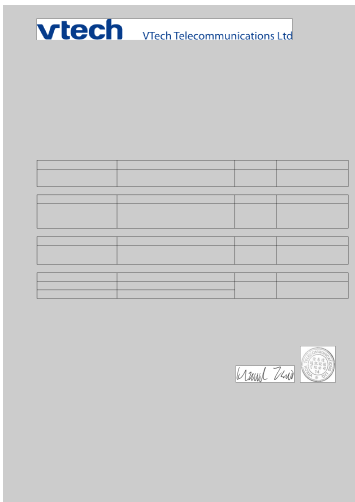

[pdf] Specifications Declaration of Conformity

Revision History dc tel VTech EN 50385 2017 ITS 18030331HKG 001 Parent unit 50566 Manufacturer s

Representative Telecommunications Limited Michael Tsui VM3252 Declaration of Conformity CE cdn

vtech jouets assets a4f49421 3824 49bd bc0d 25320e925b26

CE DECLARATION OF CONFORMITY The **VM3252** Video Baby Monitor Does

comply with the Radio Equipment Directive 2014/53/EU The product should be

marked with the CE Mark, without a Notified Body reference. The relevant test

standards are: Safety : Specification Baby Parent unit EN 60950-1:2006 A1...

lang:it score:28 filesize: 36.23 K page_count: 1 document date: 2018-11-20

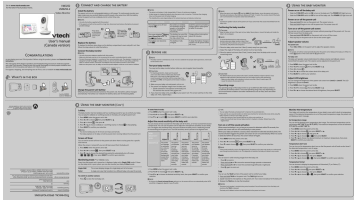

[pdf] User Manual Installation Guide Instructions Troubleshooting Guide Label

VM3252 X CA CIB V5 20181112 Index of media products VM phones vtechcanada |||

Go to www.vtechcanada.com for the latest VTech product news. **VM3252 VM3252-2** Video Monitor User s manual Canada version Congratulations on purchasing your new VTech product. Before using this product, please read Important safety instructions. This manual has all the feature operations and troub...

lang:en score:28 filesize: 4.6 M page_count: 2 document date: 2018-11-13

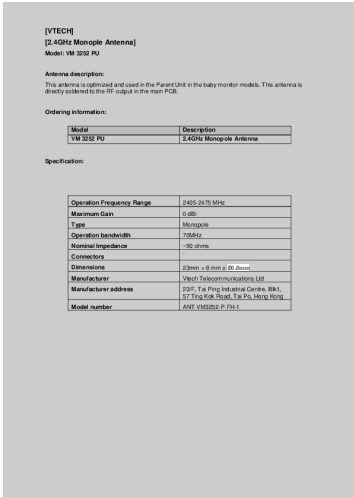

[pdf] Specifications Datasheet Dimension Guide Test Report

Microsoft Word Antenna Data Sheet VM3252 PU docx VTT08078 Test Report VTech

Telecommunications Ltd 80 1320 00A Video Baby Monitor Parent Unit EW780 EW780132000A 00a

VTECH 2.4GHz Monopole Antenna Model: VM 3252 PU Antenna description: This antenna is optimized a ... ecommunications Ltd 23/F, Tai Ping Industrial Centre, Blk1, 57 Ting Kok Road, Tai Po, Hong Kong ANT-**VM3252**-P-FH-1 VTECH 2.4GHz Monopole Antenna Antenna pattern 2436MHz the frequency with maxim...

lang:en score:27 filesize: 510.32 K page_count: 3 document date: 2022-12-07

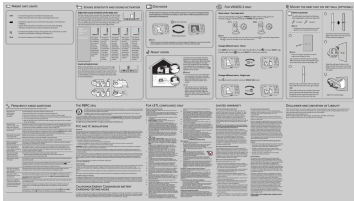

[pdf] User Manual

User Manual VTech Telecommunications Ltd 80 3401 01 Video Baby Monitor EW780 EW780340101

Parent unit lights LINK TALK On when the parent unit is linked to the baby unit.

Flashes when th ... in which there is neither key pressed nor alert received from the baby unit. 10 min inactivity For **VM3252-2** only Status check - Two baby units If you are viewing baby unit , the POWER LED light of b...

lang:en score:26 filesize: 2.32 M page_count: 1 document date: 2024-04-11

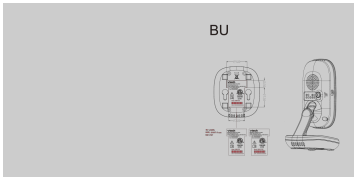

[pdf] Label

VM819 09 Engraving Label 20231211 Artwork and Location VTech Telecommunications Ltd 80 2365 00A EW780 EW780236500A 00a

BU MANUFACTURED IN CHINA www.vtechphones.com VTech Customer Service 1-800-595-9511 FCC ID: EW780-23 ... B A/V I.C.T.E. Model: VM819 BU S/N:

XXXXXXXXXXXX A/V I.C.T.E. Model: VM819-2 BU S/N: XXXXXXXXXXXX **VM3252**

Series Engraving draft_R0 BU MANUFACTURED IN CHINA www.vtechphones.com VTech Customer Servic...

lang:de score:24 filesize: 2.68 M page_count: 3 document date: 2024-05-21

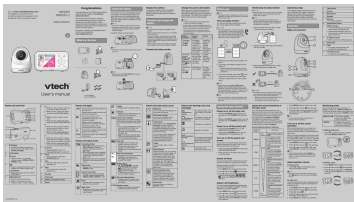

[pdf] User Manual Installation Guide Instructions Troubleshooting Guide Warranty

User Manual VTech Telecommunications Ltd 80 0618 00 Video Monitor Baby Unit EW780 EW780061800

Go to www.vtechphones.com to register your product for enhanced warranty support and the latest VTec ... ght vision Displays when the baby unit being viewed has activated the night vision feature. * For **VM3252-2** only. Lullaby Displays when a lullaby is playing. Talkback Displays when talking back t...

lang:en score:24 filesize: 4.36 M page_count: 2 document date: 2017-11-28



[pdf] User Manual

vtech vm3252 quick start manual 2 cdn2 guidessimo view 885960 |||

...

lang:en score:24 filesize: 6.27 M page_count: 2 document date: 2018-12-21

[pdf] Label

VM320 US ENGRAVING R3 02Jul2020 Label Artwork and Location VTech Telecommunications Ltd 80

2365 00 EW780 EW780236500

BU MANUFACTURED IN CHINA www.vtechphones.com VTech Customer Service 1-800-595-9511 FCC ID: EW780-23 ... ervice 1-800-595-9511 FCC ID: EW780-2365-00 IC: 1135B-80236500 HVIN: 35-201931BU DC 6V 500mA Model: **VM3252** BU S/N: XXXXXXXXXXXX #6MBCFM MANUFACTURED IN CHINA www.vtechphones.com VTech Customer Servic...

lang:de score:24 filesize: 1.64 M page_count: 2 document date: 2022-09-08

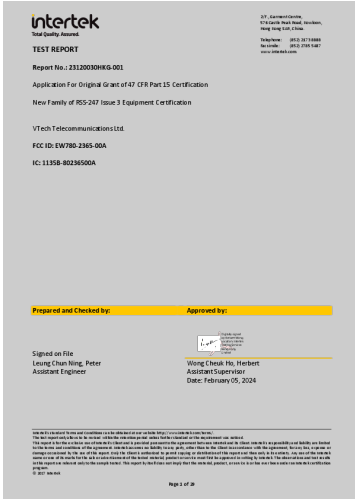
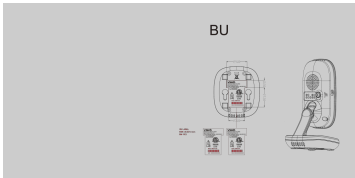

[pdf] Test Report

Date of Type wtcheung Intertek Testing Services Test Report VTech Telecommunications Ltd 80 2365

00A EW780 EW780236500A 00a

TEST REPORT Report No.: 23120030HKG-001 Application For Original Grant of 47 CFR Part 15 Certificati ... dong, China. FCC Part 15, October 1, 2022 Edition EW780-2365-00A VM819 BU, VM819-2 BU, VM819-ab BU, **VM3252** BU, **VM3252**-2 BU, VM350 BU, VM350-2 BU RSS-247 Issue 3, August 2023 RSS-Gen Issue 5 Amendment ...

lang:en score:23 filesize: 1.25 M page_count: 29 document date: 2024-08-20



[pdf] Test Report

22060748HKG 001 herbertw Test Report VTech Telecommunications Ltd 80 1320 01A Video Baby

Monitor Parent Unit EW780 EW780132001A 01a

TEST REPORT Report Number: 22060748HKG-001 Application for Original Grant of 47 CFR Part 15 Certific ... , Block 1, 57 Ting Kok Road, Tai Po, Hong Kong. FCC Part 15, October 1, 2021 Edition EW780-1320-01A **VM3252** PU, **VM3252**-2 PU RSS-247 Issue 2, February 2017 RSS-Gen Issue 5 Amendment 2, February 2021 113...

lang:en score:23 filesize: 741.77 K page_count: 42 document date: 2023-11-21

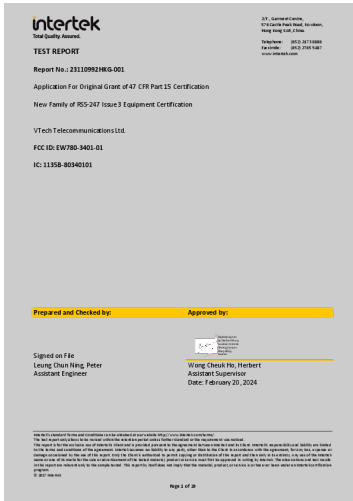

[pdf] Test Report

Date of Type wtcheung Intertek Testing Services Test Report VTech Telecommunications Ltd 80 3401 01 Video Baby Monitor EW780 EW780340101

TEST REPORT Report No.: 23110992HKG-001 Application For Original Grant of 47 CFR Part 15 Certificati ... gement Zone, Liaobu, Dongguan, Guangdong, China. FCC Part 15, October 1, 2022 Edition EW780-3401-01 **VM3252** PU, **VM3252**-2 PU RSS-247 Issue 3, August 2023 RSS-Gen Issue 5 Amendment 2, February 2021 1135B... lang:en score:23 filesize: 768.5 K page_count: 29 document date: 2024-08-14

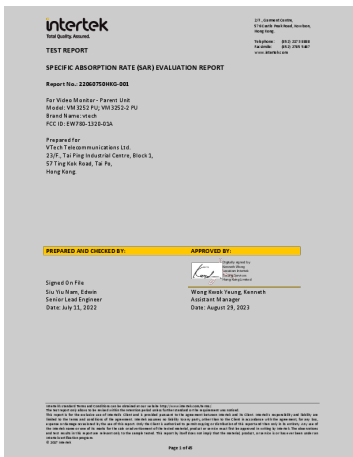

[pdf] Test Report SAR Rating

22060750HKG 001 herbertw SAR Report VTech Telecommunications Ltd 80 1320 01A Video Baby Monitor Parent Unit EW780 EW780132001A 01a

TEST REPORT SPECIFIC ABSORPTION RATE SAR EVALUATION REPORT Report No.: 22060750HKG-001 For Video Monitor - Parent Unit Model: **VM3252** PU; **VM3252**-2 PU Brand Name: vtech FCC ID: EW780-1320-01A Prepared for VTech Telecommunications Ltd. 23/F., Tai Ping Industrial Centre, Block 1, 57 Ting Kok Road, Tai...

lang:en score:21 filesize: 2.24 M page_count: 76 document date: 2023-11-22

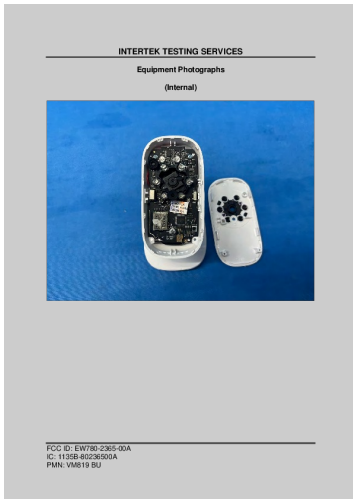

[pdf] Product Photos Teardown

Applicant Name user Intertek Testing Services Internal Photos VTech Telecommunications Ltd 80 2365 00A EW780 EW780236500A 00a

INTERTEK TESTING SERVICES Equipment Photographs Internal FCC ID: EW780-2365-00A IC: 1135B-80236500 ... K TESTING SERVICES Equipment Photographs Internal FCC ID: EW780-2365-00A IC: 1135B-80236500A PMN: **VM3252** BU INTERTEK TESTING SERVICES Equipment Photographs Internal FCC ID: EW780-2365-00A IC: 11...

lang:i-klinton score:17 filesize: 1.47 M page_count: 78 document date: 2024-06-07



[pdf] Quick Start Guide Installation Guide Frequently Asked Questions Guide Warranty

Floor Stand VM350 VM3254 VM3258 33mm 2 Note Install the screws according to distance of wall mount hole baby unit 1 C D *The applicable models FloorStand 344200 QSG US V1 20240709 3 cdn web vtp media products |||

Go to www.vtechphones.com to register your product for enhanced warranty support and latest VTech pr ... to help prevent the stand from tipping. Distances between screw holes VM5266 27.6mm 1 VM819 /**VM3252** /VM320 VM350 /VM3254 /VM3258 33mm 2 *The applicable models may be updated over time. 9. ...

lang:en score:17 filesize: 1.71 M page_count: 2 document date: 2024-07-09



[\[pdf\]](#) Product Photos

Applicant Name user Intertek Testing Services External Photos VTech Telecommunications Ltd 80 2365 00A EW780 EW780236500A 00a

INTERTEK TESTING SERVICES Equipment Photographs External FCC ID: EW780-2365-00A IC: 1135B-80236500 ... K TESTING SERVICES Equipment Photographs External FCC ID: EW780-2365-00A IC: 1135B-80236500A PMN: **VM3252** BU INTERTEK TESTING SERVICES Equipment Photographs External FCC ID: EW780-2365-00A IC: 11...

lang:i-klnglon **score:16** filesize: 1.08 M page_count: 15 document date: 2024-06-07

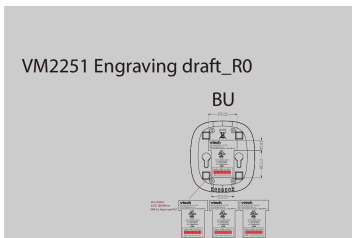

[\[pdf\]](#) Label

VM2251 VM3252 BU Bottom engraving sn0418 ID Label and Location Info VTech Telecommunications Ltd 80 1318 00 Video Monitor with Adjustable Lens Baby Unit EW780 EW780131800

VM2251 Engraving draft_R0 BU MANUFACTURED IN CHINA

www.vtechphones.com VTech Customer Service 1-800-595-9511 4H20 I.T.E. FCC ID: EW780-1318-00 IC: 1135B-80131800 HVIN:35-200930BU DC 6V 400mA Model: VM2251 BU MMY S/N: XXXXXXXXXXXX BU LABEL SIZE: 38X29mm 50# UL Approved PET MANUFACTURED IN CHINA ww...

lang:da **score:16** filesize: 442.01 K page_count: 1 document date: 2017-11-14

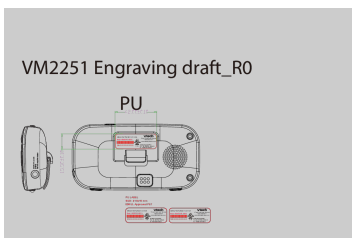

[\[pdf\]](#) Label

VM2251 VM3252 BU Bottom engraving sn0418 ID Label and Location Info VTech Telecommunications Ltd 80 1318 01 Video Monitor with Adjustable Lens Parent Unit EW780 EW780131801

VM2251 Engraving draft_R0 PU 42.000.10 MANUFACTURED IN CHINA Model:

VM2251 PU MMY 4H20 VTech Customer Service 1-800-595-9511 www.vtechphones.com SN:XXXXXXXXXXXX I.T.E. HVIN:35-200937PU FCC ID: EW780-1318-01 IC: 1135B-80131801 400 15.500.10 PU LABEL SIZE: 41.5x15 mm 50# UL Approved PET MANU...

lang:de **score:16** filesize: 552.54 K page_count: 1 document date: 2017-11-14



[\[pdf\]](#) SAR Rating

Intertek SAR Photos VTech Telecommunications Ltd 80 3401 01 Video Baby Monitor EW780 EW780340101

INTERTEK TESTING SERVICES The Worst Case Configuration Photographs 23110994 **VM3252** PU Figure 1 Front 0mm separation Figure 2 Front 0mm separation FCC ID: EW780-3401-01 IC: 1135B-80340101 ...

lang:de **score:15** filesize: 140.76 K page_count: 1 document date: 2024-04-15