



[Manuals.plus](#) /

> [TEC](#) /

> Technolink TC-750LC Audiophile RIAA Phono Preamp User Manual

TEC TC-750LC_SVRprem

Technolink TC-750LC Audiophile RIAA Phono Preamp User Manual

Model: TC-750LC_SVRprem

1. INTRODUCTION

Thank you for choosing the Technolink TC-750LC Audiophile RIAA Phono Preamp. This device is designed to amplify the low-level signal from a turntable's magnetic cartridge to a line-level signal, suitable for input into an amplifier or receiver that lacks a dedicated phono input. The TC-750LC features accurate RIAA equalization and an output level control for optimal sound reproduction from your vinyl records.

This manual provides detailed instructions for setting up, operating, and maintaining your TC-750LC phono preamp. Please read it thoroughly before use to ensure proper functionality and longevity of your device.

2. SAFETY INFORMATION

- Always use the provided 12VDC 1000mA regulated SMPS AC adaptor. Using an incorrect power supply may damage the unit and void the warranty.
- Do not expose the unit to moisture, rain, or extreme temperatures.
- Do not open the casing. There are no user-serviceable parts inside. Refer all servicing to qualified personnel.
- Ensure proper ventilation around the unit to prevent overheating.
- Disconnect the power adaptor from the wall outlet if the unit will not be used for an extended period.

3. PACKAGE CONTENTS

Please check the package for the following items:

- Technolink TC-750LC Audiophile RIAA Phono Preamp
- 12VDC 1000mA Regulated SMPS AC Adaptor
- RCA Cable
- Miniplug Adaptor



Image: The TC-750LC phono preamp unit shown alongside its included 12VDC 1000mA regulated SMPS AC power adapter.

4. PRODUCT OVERVIEW

4.1 Front Panel

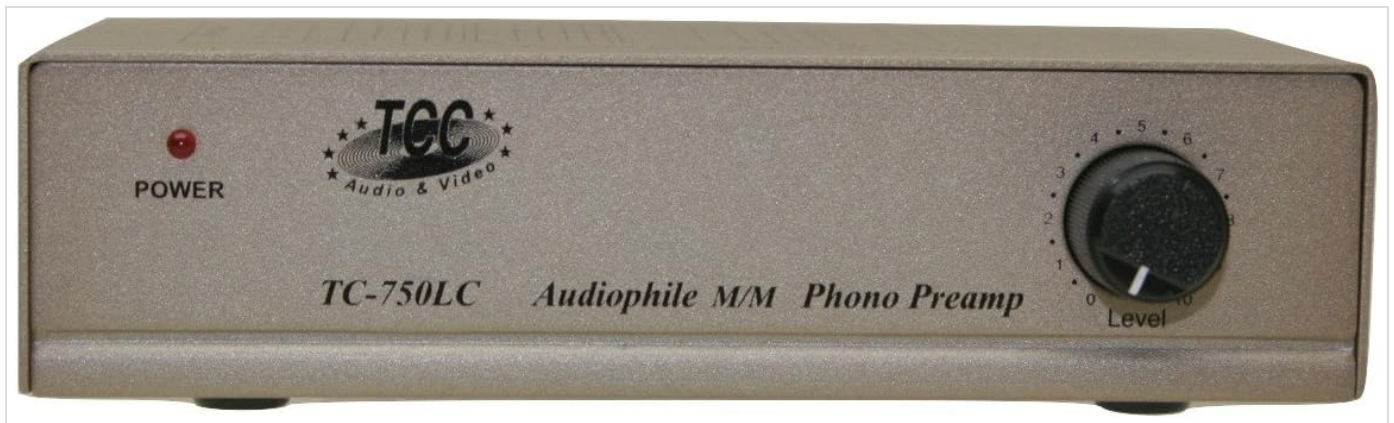

Image: Front panel of the TC-750LC phono preamp, showing the Power LED and Level control knob.

- **POWER LED:** Illuminates when the unit is powered on.
- **LEVEL Control:** An output attenuator knob (0-10) to adjust the output signal level.

4.2 Rear Panel



Image: Rear panel of the TC-750LC phono preamp, showing input, output, ground terminal, and power input.

- **MM Input (R/L):** RCA jacks for connecting your turntable's output. Impedance: 47kΩ/220pf.
- **Ground Terminal:** Screw terminal for connecting your turntable's ground wire.
- **Output (R/L):** RCA jacks for connecting to a line-level input on your amplifier or receiver.
- **DC 12V Input:** Power input jack for the included AC adaptor.

5. SETUP AND CONNECTION

Follow these steps to connect your TC-750LC phono preamp to your audio system:

1. **Connect Turntable to Preamp:** Connect the RCA output cables from your turntable to the **MM Input (R/L)** jacks on the rear of the TC-750LC. Ensure the right (red) and left (white) channels are matched.
2. **Connect Ground Wire:** If your turntable has a separate ground wire, connect it to the **Ground Terminal** on the TC-750LC. This helps reduce hum and noise.
3. **Connect Preamp to Amplifier/Receiver:** Using the included RCA cable, connect the **Output (R/L)** jacks of the TC-750LC to a *line-level input* on your amplifier or receiver. This can be an input labeled AUX, CD, TAPE, TUNER, or any other input that is **NOT** labeled "PHONO".

Important: NEVER connect the output of the TC-750LC to an amplifier's dedicated PHONO input. Doing so will result in distorted sound and potential damage to your equipment, as the PHONO input already has a built-in preamplifier.

4. **Connect Power:** Insert the barrel connector of the 12VDC 1000mA regulated SMPS AC adaptor into the **DC 12V Input** jack on the rear of the TC-750LC. Then, plug the AC adaptor into a suitable wall outlet. The POWER LED on the front panel should illuminate.

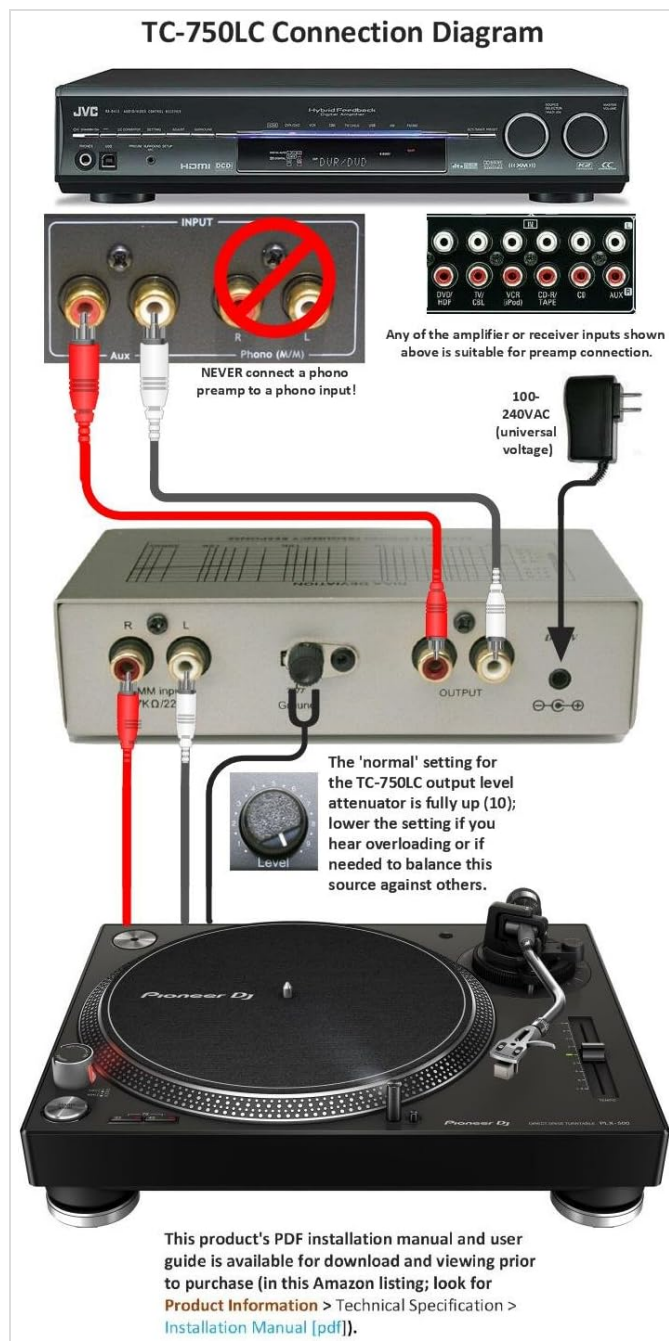

Image: A visual diagram illustrating the correct connection of the TC-750LC phono preamp between a turntable and an amplifier/receiver, highlighting the use of a line-level input.

6. OPERATING INSTRUCTIONS

Once all connections are made and the unit is powered on, you can begin playing your vinyl records.

- **Output Level Control:** The **LEVEL** knob on the front panel allows you to adjust the output signal strength of the preamp. The 'normal' setting for the TC-750LC output level attenuator is typically fully up (10).
- **Adjusting Level:** You may need to lower the setting if you hear overloading or if it's needed to balance this source against others in your audio system. Start with the knob at a lower setting and gradually increase it to a comfortable listening level, ensuring no distortion occurs.
- **Playback:** Select the corresponding input on your amplifier/receiver (e.g., AUX, CD) and start playing a record on your turntable.

7. MAINTENANCE

The TC-750LC phono preamp requires minimal maintenance. Follow these guidelines to keep your unit in optimal condition:

- **Cleaning:** Use a soft, dry cloth to wipe the exterior of the unit. Do not use liquid cleaners or abrasive chemicals, as they may damage the finish.
- **Storage:** If storing the unit for an extended period, disconnect it from power and store it in a cool, dry place away from direct sunlight and extreme temperatures.
- **Ventilation:** Ensure the unit has adequate airflow around it. Do not block ventilation openings.

8. TROUBLESHOOTING

If you encounter issues with your TC-750LC, please refer to the following common problems and solutions:

Problem	Possible Cause / Solution
No sound or very low sound.	<ul style="list-style-type: none">◦ Ensure the power adapter is securely connected and the POWER LED is illuminated.◦ Check all RCA cable connections between the turntable, preamp, and amplifier.◦ Verify that the correct input is selected on your amplifier/receiver (e.g., AUX, CD, not PHONO).◦ Increase the LEVEL control knob on the front of the preamp.◦ Ensure your turntable's cartridge is properly installed and functioning.
Humming or buzzing noise.	<ul style="list-style-type: none">◦ Ensure the turntable's ground wire is securely connected to the Ground Terminal on the preamp.◦ Check for loose or faulty RCA cables.◦ Ensure the preamp is not placed too close to other electronic devices that may cause interference.◦ Try plugging the power adapter into a different electrical outlet.
Distorted sound.	<ul style="list-style-type: none">◦ Ensure the preamp's output is connected to a line-level input (AUX, CD, etc.), NOT a PHONO input, on your amplifier/receiver.◦ Lower the LEVEL control knob on the preamp.◦ Check your turntable's cartridge and stylus for damage or improper alignment.
Power LED does not light up.	<ul style="list-style-type: none">◦ Verify the power adapter is fully plugged into both the preamp and a working wall outlet.◦ Try a different wall outlet.◦ Ensure the power adapter itself is not damaged.

9. SPECIFICATIONS

- **RIAA Frequency Response:** 20Hz-20,000Hz +/- 0.5dB
- **Signal-to-Noise Ratio (S/N):** 85dB
- **MM Gain:** 40dB
- **Input Impedance:** 47kΩ/220pf

- **Power Supply:** 12VDC 1000mA Regulated SMPS AC Adaptor (included)
- **Connectors:** Gold plated RCA jacks for input and output, screw terminal for ground.
- **Casing:** Anodized metal casing for shielding.
- **Dimensions (Approx.):** 1.8 pounds (Item Weight)
- **Model Number:** TC-750LC_SVRprem

10. WARRANTY AND SUPPORT

The Technolink TC-750LC comes with a **Lifetime limited defective repair or exchange warranty**. Please retain your proof of purchase for warranty claims.

For further assistance or detailed technical information, please refer to the official User Guide PDF available online. A link to the PDF installation manual and user guide is typically found under the "Product Information / Technical Specification" section on the product's listing page.

You can also visit the [TEC Store](#) for more information and support.