

## GreenTouch GT-IR-F43.0-1

# GreenTouch 43-inch Multi-Touch Infrared Touch Frame User Manual

Model: GT-IR-F43.0-1

## 1. PRODUCT OVERVIEW

The GreenTouch 43-inch Multi-Touch Infrared Touch Frame transforms any display into an interactive touchscreen. Featuring a light-resistant design, it is suitable for various environments, including financial services, advertising, industrial control, public inquiry, self-service kiosks, education, and gaming. It offers intelligent automatic calibration, is drive-free, and requires minimal maintenance.



Image: The GreenTouch 43-inch Infrared Touch Frame, designed to convert standard displays into interactive touchscreens.

## Package Contents

Upon unpacking, ensure all the following items are present:

- 4 pcs touch frame segments
- 8 screws and corner covers



Item Weight	0.95 Kilograms
Response Time	10 Milliseconds
Connectivity Technology	USB
Hardware Connectivity	Infrared, USB
Voltage	5 Volts
Additional Features	Touchscreen

## Dimensions and Size Chart

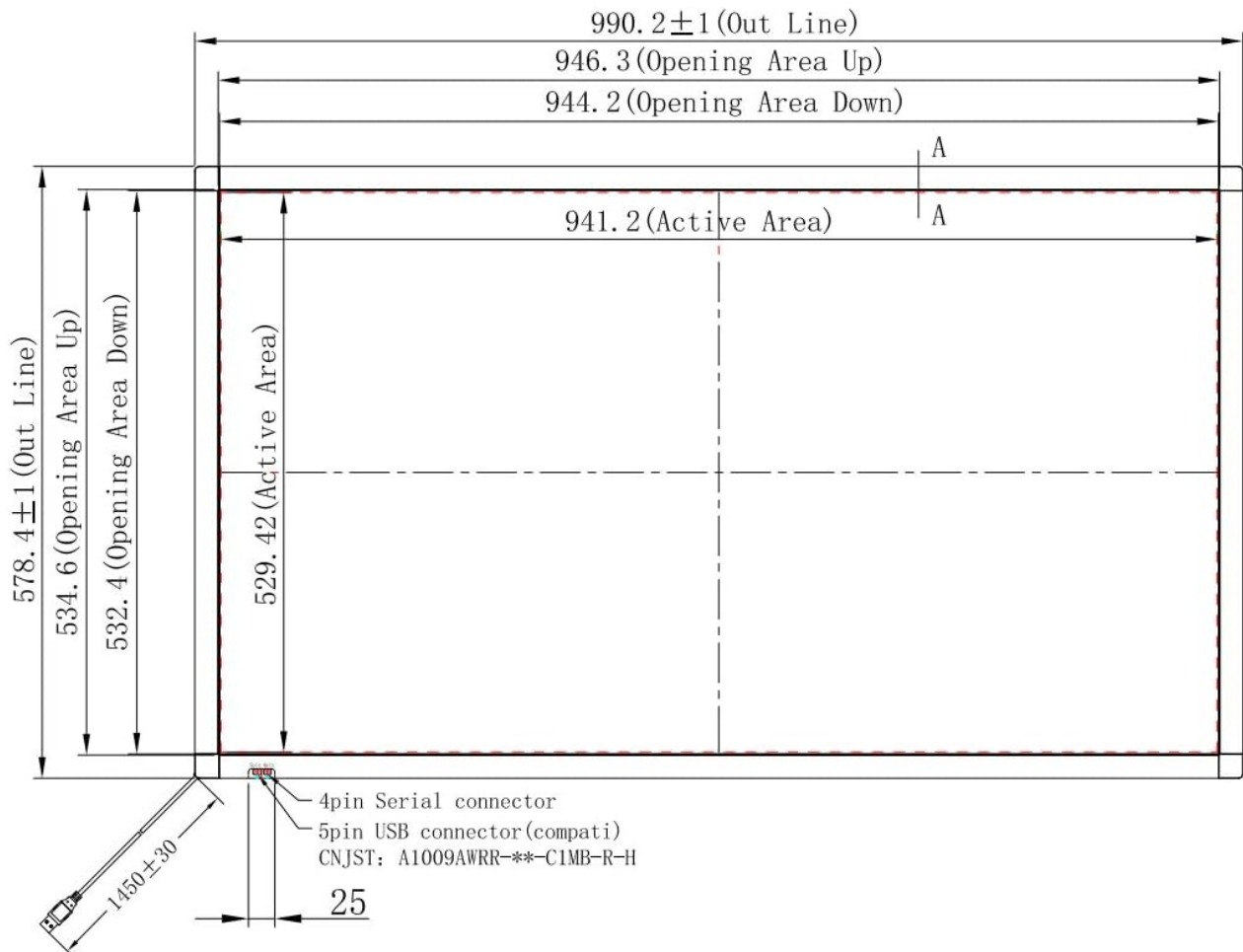

Image: Detailed technical drawing showing the outer measurements and active area of the 43-inch touch frame.

Size	Outer Measurements	Active Area
32"	29.44 x 17.41 in.	27.47 x 15.44 in.
40"	36.83 x 21.58 in.	34.87 x 19.61 in.
42"	38.59 x 22.57 in.	36.62 x 20.60 in.
43"	38.98 x 22.77 in.	37.05 x 20.84 in.
49"	44.20 x 25.71 in.	42.27 x 23.78 in.
50"	45 x 26.12 in.	43.14 x 24.27 in.
55"	49.60 x 28.75 in.	47.63 x 26.77 in.
60"	54.29 x 31.40 in.	52.33 x 29.43 in.
65"	58.27 x 33.66 in.	56.24 x 31.63 in.
70"	62.97 x 36.28 in.	61 x 34.31 in.
75"	66.82 x 38.43 in.	64.97 x 36.55 in.

*Image: A table illustrating outer measurements and active areas for different sizes of GreenTouch Infrared Touch Frames.*

### 3. SETUP: ASSEMBLY AND CONNECTION

Follow these steps to assemble your GreenTouch Infrared Touch Frame:

1. **Unpack Components:** Carefully remove all four touch frame segments from the packaging.
2. **Identify Segments:** Each segment end is marked (A, B, C, D). Ensure you match A to A, B to B, C to C, and D to D for correct assembly. The C end does not have pins and does not require connection to another segment.
3. **Connect Segments:** Gently push the corresponding segments together, ensuring the pins align and connect securely into their sockets.

# Put A-A , B-B , C-C ,D-D

## Pin connection stable signal transmission

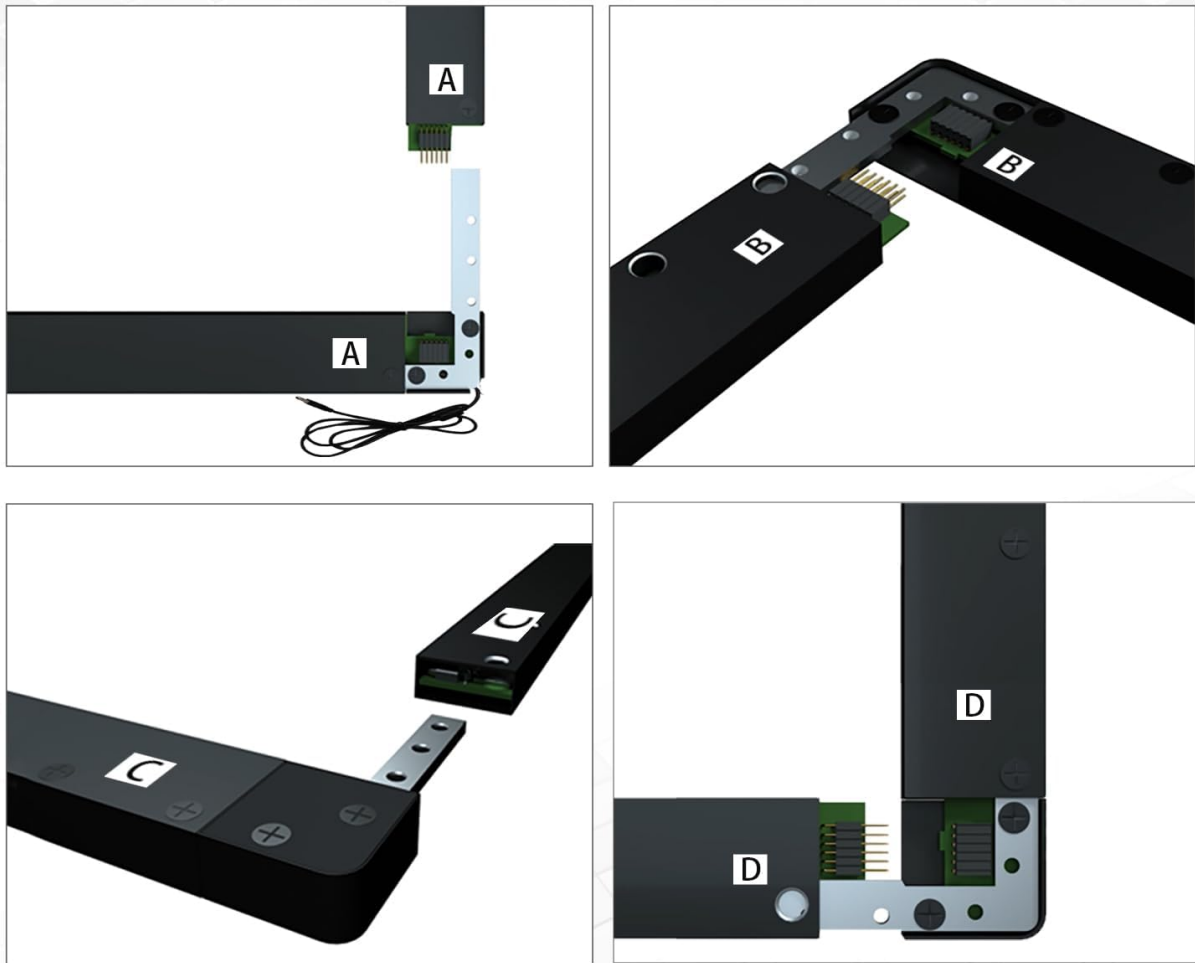

*Image: A close-up view demonstrating the precise pin connection required when assembling the touch frame segments.*

4. **Secure with Screws:** Once all segments are connected, place the corner covers and use the provided screws to fix them tightly.



*Image: A corner of the assembled touch frame, showing the screws securing the segments and corner cover.*

## **Assembly Videos**

*Video: This video demonstrates the step-by-step installation process for the IR Touch Frame, showing how to connect the segments and secure them.*

*Video: This video provides detailed assembly instructions for the GreenTouch TF series infrared touch frame, highlighting key connection points.*

## **Connecting to a Display**

The touch frame is designed to be placed over your existing display (monitor or TV). It connects to your computer via a standard USB interface, offering plug-and-play functionality without requiring additional drivers.



*Image: The aluminum alloy shell of the touch frame, showing the integrated USB cable for connection.*

## 4. OPERATING INSTRUCTIONS

### Initial Connection and Testing

After assembly, connect the touch frame's USB cable to your PC (Windows) or Android OS device. The system should automatically detect the touch frame. You can then test its function, sensitivity, and touch points.

*Video: This video demonstrates the working performance of the GreenTouch IR Touch Frame, showcasing its responsiveness and multi-touch capabilities.*

### Calibration

The touch frame features intelligent automatic calibration. In most cases, it will calibrate itself upon connection. If you experience any inaccuracies, a partial calibration can be performed using the provided software or system settings.

*Video: This video illustrates the process of performing a partial calibration for the GreenTouch infrared touch frame to ensure accurate touch response.*

## 5. CARE AND MAINTENANCE

---

To ensure the longevity and optimal performance of your GreenTouch Infrared Touch Frame, follow these maintenance guidelines:

- **Cleaning:** Use a soft, lint-free cloth slightly dampened with water or a mild, non-abrasive cleaner to wipe the frame. Avoid harsh chemicals or abrasive materials that could damage the surface.
- **Handling:** Handle the frame carefully during installation and relocation to prevent damage to the internal components or the aluminum alloy shell.
- **Environment:** While designed to be light-resistant, avoid prolonged exposure to direct, intense sunlight or extreme temperatures, which could affect performance.

## 6. TROUBLESHOOTING

---

If you encounter issues with your touch frame, refer to the following common problems and solutions:

- **No Touch Response:**
  - Ensure the USB cable is securely connected to both the touch frame and your computer.
  - Verify that the computer's operating system recognizes the USB device.
  - Restart your computer and reconnect the touch frame.
- **Inaccurate Touch or Drifting:**
  - Perform a calibration using the touch frame's software or your operating system's touch settings.
  - Ensure there are no obstructions (dust, debris, or foreign objects) on the frame's infrared sensors.
  - Check for strong light sources directly hitting the frame, which might interfere with infrared detection.
- **Intermittent Touch:**
  - Check the USB cable for any damage or loose connections. Try a different USB port.
  - Ensure the frame segments are tightly screwed together and there is no movement.

## 7. WARRANTY AND SUPPORT

---

GreenTouch provides a 5-year EU spare part availability duration for this product, ensuring long-term support and serviceability.

For further assistance, technical support, or warranty claims, please contact GreenTouch US customer service. Refer to your purchase documentation for specific contact details.