

FreedConn BM2-S

FreedConn BM2-S Motorcycle Bluetooth Helmet Instruction Manual

1. INTRODUCTION

This manual provides detailed instructions for the proper use, maintenance, and troubleshooting of your FreedConn BM2-S Motorcycle Bluetooth Helmet. This helmet is designed to offer enhanced safety and communication features for motorcyclists, integrating Bluetooth 3.0 for connectivity with mobile phones, music players, and GPS systems, alongside an intercom function for rider-to-rider communication. It meets both ECE and DOT safety standards.

2. PRODUCT OVERVIEW

The FreedConn BM2-S helmet combines robust protection with advanced communication technology. Key features include a dual visor system, multiple air vents for comfort, and an integrated Bluetooth system.



Figure 2.1: Front view of the FreedConn BM2-S helmet, highlighting its integrated Bluetooth capabilities for mobile phone, calls, intercom, music, FM radio, and GPS audio.



2 Riders Intercom



3 Riders pair but 2 riders talk at the same time, range up to 1640ft.





Only compatible with FreedConn BM12 helmet, TCOM-SC and T-COMVB

Figure 2.2: Illustration of the 2-rider intercom function, allowing communication up to 1640 feet. The control panel for volume and function selection is also shown.

Dual Visors system for Your Safety

 High Impact Visor
  Scratch Resistant
  UV Resistant

 Quick Release
  Visor Large Field of Vision





Multiple Air Vents system for more comfortable



 Aerodynamics Shell
  Ventilation System
  Operable with Gloves

Figure 2.3: The helmet features a dual visor system for safety (high impact, scratch-resistant, UV resistant, quick release, large field of vision) and multiple air vents for enhanced comfort and aerodynamics.



Used Helmet
(Used like new or used very good)



Helmet Bag



User Manual



Charge Cable



Battery

Figure 2.4: Components included with the helmet:
helmet bag, user manual, charge cable, and battery.

3. SETUP

3.1 Initial Charging

Before first use, fully charge the helmet's Bluetooth system battery. If the system has not been used for a long time, the battery may enter a deep sleep mode. To reactivate, charge for approximately half an hour, then unplug, wait half an hour, and charge again. Regular monthly charging is recommended if not in use.

Large Capacity Battery

[NOTE] To avoid battery enter deep sleep, pls charge it regularly, at least 1 time a month, even when you don't use it. If it can't charge, use standard 5V, 1A charger to charge it for half an hour, then unplug it, wait half an hour before charge again.



Figure 3.1: Battery specifications: 2-3 hours charging time, 8-10 hours call time, 300 hours standby time.

3.2 Liner Removal and Installation

The helmet liner is removable for cleaning or replacement. Pay attention to the microphone placement during removal and reinstallation.

Your browser does not support the video tag.

Video 3.1: This video demonstrates the process of disassembling the helmet and removing the helmet liner, with specific attention to the microphone. This is useful for cleaning or replacing the liner.

3.3 Bluetooth Pairing

To pair your helmet with a mobile phone or other Bluetooth device:

1. Ensure the helmet's Bluetooth system is charged and powered on.
2. Activate Bluetooth on your mobile device.
3. Search for available devices and select the FreedConn helmet (e.g., "BM2-S" or similar).
4. Confirm pairing if prompted.

4. OPERATING INSTRUCTIONS

4.1 Call Control

The helmet supports one-button control for managing phone calls:

- **Answering/Rejecting Calls:** Use the designated button on the helmet.
- **Redialing:** A specific button press can redial the last number.
- **Voice Command:** Long press the MFB button for 2 seconds to activate Siri or Android voice commands.

Incoming phone calls will override intercom, music, FM, and GPS navigation audio.

4.2 Intercom Function

The built-in Bluetooth intercom supports 2 riders talking simultaneously or 3 riders pairing, with a range of up to 500m (1640 ft). It features 2 premium speakers with full stereo sound and advanced DSP echo cancellation and noise suppression technology for clear communication at high speeds.

4.3 Music and GPS Audio

Connect to your music player or GPS system via Bluetooth 3.0 for stable audio streaming. Audio from music and GPS navigation will be temporarily paused during incoming calls.

5. MAINTENANCE

5.1 Cleaning the Liner

The cheek pads and liner are deodorant, absorbent, and removable for easy cleaning. Refer to Video 3.1 for instructions on how to remove the liner. Hand wash the liner with mild soap and water, then air dry completely before reinstallation.



Figure 5.1: The helmet features a comfortable, removable, and hand-washable interior made from moisture-wicking fabric to keep your head cooler and more comfortable.

5.2 Visor Care

The dual visors are designed to be high impact, scratch-resistant, and UV resistant. Clean visors with a soft cloth and mild soap or a specialized helmet visor cleaner. Avoid abrasive materials that could scratch the surface.

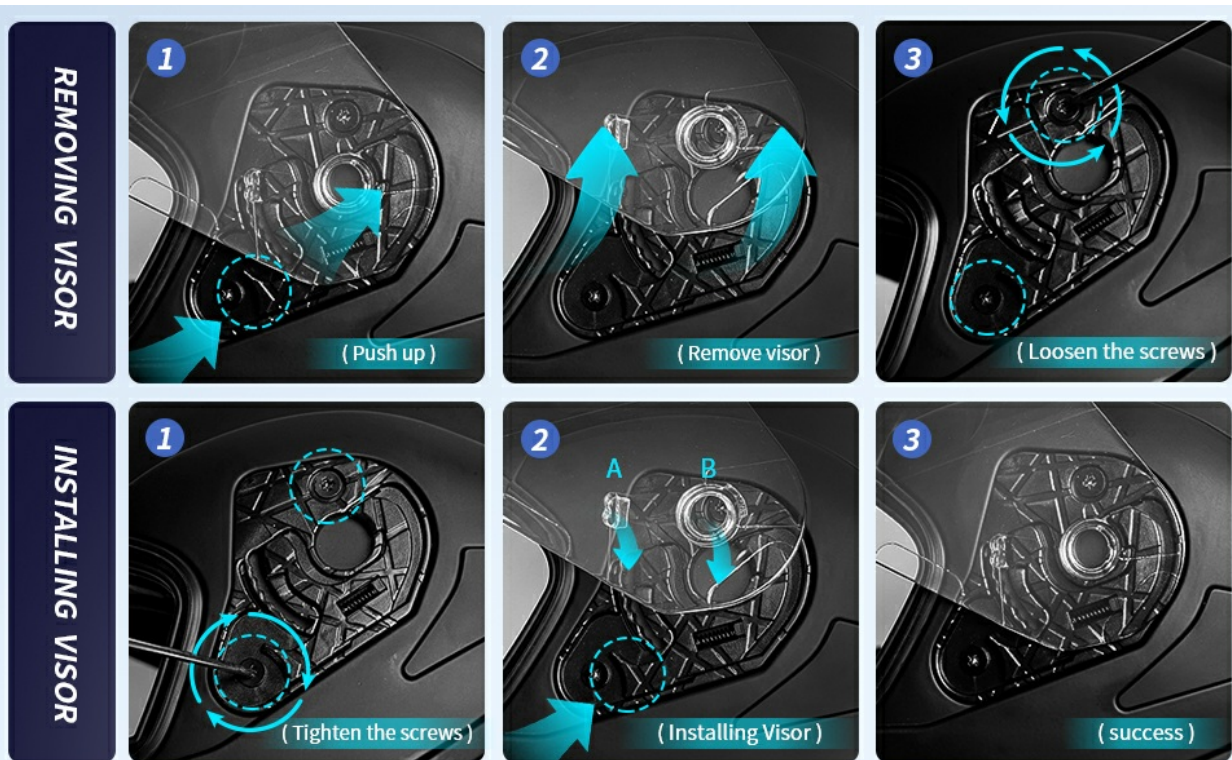

Figure 5.2: Instructions for removing and installing the helmet visor. To remove, push up, remove the visor, and loosen screws. To install, tighten screws, install the visor, and ensure it is secure.

5.3 Battery Maintenance

To prolong battery life, fully charge the helmet before its first use. If the helmet is not used for extended periods, charge it once a month regularly to prevent the battery from entering deep sleep mode.

6. TROUBLESHOOTING

- **Bluetooth System Not Available:** If the helmet Bluetooth system hasn't been used for a long time, the battery may enter deep sleep mode. Charge the battery for about half an hour to wake it up.
- **Connectivity Issues:** Ensure the helmet is fully charged and within range of the paired device. Try unpairing and re-pairing the device.
- **Audio Quality Issues:** Check speaker placement within the helmet. Ensure the microphone is correctly positioned. High speeds can affect audio clarity.
- **Helmet Fit:** If the helmet size does not fit well, contact customer support for assistance with obtaining a larger or smaller liner.

7. SPECIFICATIONS

Feature	Detail
Model Name	BM2-S
Brand	FreedConn
Bluetooth Version	3.0
Intercom Range	Up to 500m (1640 ft)

Intercom Riders	2 riders talking, 3 riders pairing
Phone Time	Up to 12 hours
Intercom Time	Up to 9 hours
Standby Time	Up to 120 hours
Charging Time	2-3 hours
Safety Standards	DOT, ECE
Shell Type	Hard (ABS Outer Material)
Visor Features	Dual Visor, High Impact, Scratch Resistant, UV Resistant, Quick Release
Liner	Removable, Washable, Deodorant, Absorbent
Included Components	Battery, Charge Cable
Item Weight	4.1 Pounds

8. WARRANTY AND SUPPORT

The FreedConn BM2-S Motorcycle Bluetooth Helmet comes with a 1-year warranty. For any issues or support inquiries, please contact FreedConn customer service. You can typically find contact information by clicking on the seller's name (e.g., "Fodsports Direct") on the product page and then selecting "Ask A Question." Customer service aims to respond within 12 hours.