

ELECOM TK-FDP099TWH

ELECOM TK-FDP099TWH Wireless Compact Pantograph Keyboard User Manual

Model: TK-FDP099TWH

1. INTRODUCTION

Thank you for purchasing the ELECOM TK-FDP099TWH Wireless Compact Pantograph Keyboard. This manual provides essential information for the proper setup, operation, and maintenance of your new keyboard. Please read this manual thoroughly before use and retain it for future reference.



Image: The ELECOM TK-FDP099TWH Wireless Compact Pantograph Keyboard in white, showcasing its full layout.

2. PACKAGE CONTENTS

Verify that all items listed below are included in your package:

- ELECOM TK-FDP099TWH Wireless Compact Pantograph Keyboard x 1
- USB Receiver x 1
- AAA Alkaline Dry Batteries x 2
- User's Manual (this document) x 1

3. SAFETY PRECAUTIONS

To ensure safe and proper use of this product, please observe the following precautions:

- Do not expose the keyboard or receiver to water, moisture, or extreme temperatures.
- Avoid dropping or subjecting the device to strong impacts.
- Do not attempt to disassemble or modify the product. This may void the warranty and cause damage.
- Keep batteries out of reach of children. If swallowed, seek immediate medical attention.
- Dispose of used batteries according to local regulations.
- Use only the specified battery type (AAA).

4. SETUP

Follow these steps to set up your ELECOM wireless keyboard:

1. **Install Batteries:** Open the battery compartment cover on the back of the keyboard. Insert two AAA alkaline batteries, ensuring correct polarity (+/-). Close the cover securely.



Image: Close-up view of the keyboard's power switch and battery compartment, indicating where to insert two AAA batteries.

2. **Connect USB Receiver:** Insert the compact USB receiver into an available USB port on your computer (Windows or Macintosh). The system will automatically detect and install the necessary drivers.

2.4GHzの無線接続

日本語104キー

Win

Mac

対応

1 円玉サイズの
小型レシーバー



※画像はイメージです。

Image: A compact USB receiver is shown next to a keyboard, illustrating its small size and indicating compatibility with both Windows and Mac operating systems.

3. **Power On:** Locate the power switch on the keyboard (usually on the top right edge) and slide it to the 'ON' position. The keyboard is now ready for use.

5. OPERATING INSTRUCTIONS

The ELECOM TK-FDP099TWH keyboard offers a comfortable typing experience and convenient function keys.

5.1 Basic Typing

Simply begin typing. The keyboard uses a standard Japanese 104-key layout. The pantograph key mechanism provides a light and responsive feel, similar to laptop keyboards.

5.2 Function Keys (Fn Key Combinations)

The keyboard features multimedia and system control functions accessible via the 'Fn' key in combination with the F1-F12 keys. Press and hold the **Fn** key, then press the desired function key.

- **Fn + F1:** Play/Pause media
- **Fn + F2:** Previous Track

- **Fn + F3:** Next Track
- **Fn + F4:** Mute Audio
- **Fn + F5:** Volume Down
- **Fn + F6:** Volume Up
- **Fn + F7:** Open Web Browser
- **Fn + F8:** Open Mail Application
- **Fn + F9:** Open Search Function
- **Fn + F10:** Turn Display Off
- **Fn + F11:** Turn Display On
- **Fn + F12:** Open 'My Computer' or equivalent file explorer

作業を助ける12種類のマルチファンクションキー

Web ブラウザ機能等をすぐ実行できるので 作業時間の短縮が可能です

ファンクションキー

Fn キーを押しながら、アイコンが記載されているキーを押すことで、システム全体のボリュームを調整したり、メディアプレーヤーなどの操作や画面の明るさを調整することができます。

- ホーム**
デスクトップを表示します。
- 検索**
検索チャーム・検索ウィンドウ・[検索]画面を起動します。
- ブラウザ起動**^{※1}
Web ブラウザーを起動します。
- 電卓**^{※1}
Windows® 標準の「電卓」を起動します。
- 前のトラックへ**
音楽などを再生中、前の曲へ移動します。^{※2}

- 再生 / 一時停止**
音楽などのメディアを再生します。再生中に押すと一時停止します。^{※2}
- 次のトラックへ**
音楽などを再生中、次の曲へ移動します。^{※2}
- ミュート**
システム全体の音声出力を止めます。もう一度押すと、ミュートを解除します。
- ボリューム -**
システム全体のボリュームを下げます。
- ボリューム +**
システム全体のボリュームを上げます。
- 画面を暗くする**
画面の表示を暗くします。
- 画面を明るくする**
画面の表示を明るくします。

※1 Windows® 8.1 では、モダン版アプリが起動します。
※2 メディアプレーヤーなどがアクティブな時
ご使用の環境により動作しない場合や異なる動作をする場合があります。



Image: A detailed view of the keyboard's function keys (F1-F12) with their corresponding multimedia and system control icons, along with a diagram explaining their use with the Fn key.

6. MAINTENANCE

Proper maintenance ensures the longevity of your keyboard:

- **Cleaning:** Use a soft, dry cloth to wipe the keyboard surface. For stubborn dirt, slightly dampen the cloth with water or a mild cleaning solution. Do not spray cleaners directly onto the keyboard.
- **Battery Replacement:** When the keyboard's performance degrades or it stops responding, replace both

AAA batteries. The estimated battery operating period is approximately 1.1 years with alkaline batteries.

- **Storage:** When not in use for extended periods, turn off the keyboard to conserve battery life. Store in a cool, dry place away from direct sunlight.

7. TROUBLESHOOTING

If you encounter issues with your keyboard, refer to the following common solutions:

- **Keyboard not responding:**
 - Ensure the keyboard is powered on.
 - Check if the batteries are correctly installed and have sufficient charge. Replace if necessary.
 - Verify that the USB receiver is securely plugged into a working USB port on your computer.
 - Try plugging the USB receiver into a different USB port.
 - Restart your computer.
- **Keys not working or typing incorrectly:**
 - Clean around the affected keys to remove any debris.
 - Ensure the keyboard is connected and powered on.
 - Check your operating system's keyboard settings to ensure the correct layout is selected.
- **Wireless connection issues:**
 - Move the keyboard closer to the USB receiver.
 - Avoid placing the receiver near other wireless devices or large metal objects that might cause interference.

8. SPECIFICATIONS

Detailed specifications for the ELECOM TK-FDP099TWH Wireless Compact Pantograph Keyboard:

Feature	Specification
Model Number	TK-FDP099TWH
Dimensions (Keyboard)	367.1 mm (W) x 127.5 mm (D) x 21.2 mm (H) (14.45" L x 5.02" W x 0.83" H)
Weight (Keyboard)	Approx. 488 g (1.29 lbs) (excluding batteries)
Dimensions (Receiver)	19.5 mm (W) x 15.7 mm (D) x 6.5 mm (H)
Weight (Receiver)	Approx. 2 g
Connection Method	Wireless (2.4 GHz band)
Key Type	Pantograph
Keystroke	2.0 mm
Key Pitch	19.0 mm
Power Source	AAA dry battery x 2
Battery Operating Period	Approx. 1.1 years (using alkaline batteries, ELECOM test value)

Feature	Specification
Supported OS	Windows OS, Macintosh OS
Material	Acrylonitrile Butadiene Styrene (ABS)
Color	White

薄型・軽量モデルなので 持ち運びも楽々



Image: The keyboard's dimensions (367.1mm width, 127.5mm depth) are illustrated, emphasizing its compact and lightweight design for easy portability.

ノートパソコンと同じ 軽い打ち心地



見やすいフォント



パンタグラフ

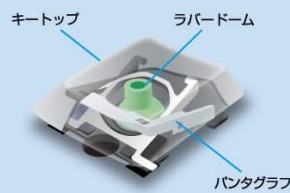

キーピッチ：19.0mm
キーストローク：2.0mm



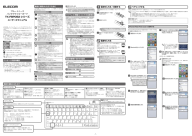
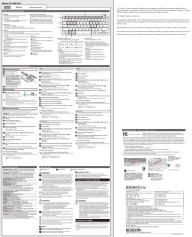

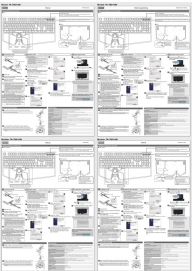
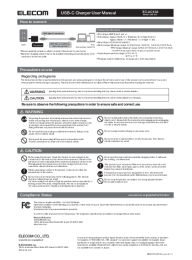

Image: A diagram illustrating the pantograph key mechanism, showing the keycap, rubber dome, and the scissor-like structure that provides stable and quiet keystrokes.

9. WARRANTY AND SUPPORT

ELECOM products are designed for reliability and performance. For warranty information, please refer to the warranty card included with your purchase or visit the official ELECOM website. For technical support or further inquiries, please contact ELECOM customer service through the contact information provided on the official website.

© 2023 ELECOM Co., Ltd. All rights reserved.

Related Documents - TK-FDP099TWH

	<p><u>ELECOM TK-FBP052 Series Bluetooth Pantograph Keyboard User Manual</u></p> <p>Detailed user manual for the ELECOM TK-FBP052 Series Bluetooth Pantograph Keyboard, covering setup, pairing with various devices (Windows, Mac, iOS, Android, PlayStation 3), troubleshooting, and specifications.</p>
	<p><u>ELECOM TK-FBP102 Wireless Keyboard User Manual</u></p> <p>Comprehensive guide to setting up and using the ELECOM TK-FBP102 Wireless Keyboard, including pairing instructions for various operating systems and safety precautions.</p>
	<p><u>ELECOM TK-FBM112BK Bluetooth 5.0 Keyboard: User Guide and Specifications</u></p> <p>Comprehensive guide for the ELECOM TK-FBM112BK wireless Bluetooth 5.0 keyboard. Includes setup instructions for Windows, macOS, iOS, and Android, technical specifications, and support information.</p>
	<p><u>ELECOM TK-TB01UM Wired Keyboard with Trackball: User Manual and Setup Guide</u></p> <p>Comprehensive user manual for the ELECOM TK-TB01UM wired keyboard, detailing setup, driver installation, features, specifications, and safety precautions. Learn how to connect, configure, and maintain your trackball keyboard.</p>
	<p><u>ELECOM EC-AC13A 45W USB-C PD Charger User Manual Specifications & Safety</u></p> <p>Download the user manual for the ELECOM EC-AC13A 45W USB-C PD charger. Find specifications, connection guide, safety precautions, and compliance information.</p>
	<p><u>ELECOM TK-FDM106 Wireless Keyboard and Mouse Combo User Manual</u></p> <p>This manual provides comprehensive instructions for setting up and using the ELECOM TK-FDM106 wireless keyboard and mouse combo. It includes details on installation, product specifications, safety precautions, and compliance information.</p>