

Amazon Basics B07894S727

Amazon Basics Microwave User Manual

Model: B07894S727



1. INTRODUCTION

This manual provides essential information for the safe and efficient operation of your Amazon Basics Microwave. This compact, 0.7 cubic foot, 700-watt microwave oven is designed for convenient food preparation and reheating. It features integration with Alexa, allowing for voice-controlled cooking and simplified operation when paired with a compatible Echo device (sold separately).

Amazon Basics Microwave

Voice-controlled microwave



Image: The Amazon Basics Microwave, highlighting its voice-controlled capabilities.

2. IMPORTANT SAFETY INFORMATION

To reduce the risk of fire, electric shock, injury to persons, or exposure to excessive microwave energy when using your appliance, follow basic precautions, including the following:

- Read all instructions before using the appliance.
- Do not attempt to operate this oven with the door open as this can result in harmful exposure to microwave energy.
- Do not place any object between the oven front face and the door or allow soil or cleaner residue to accumulate on sealing surfaces.
- Do not heat liquids or other foods in sealed containers since they are liable to explode.
- Do not overcook food.
- Do not use corrosive chemicals or vapors in this appliance.
- Always ensure proper ventilation around the microwave.

- This appliance is intended for household use only.

3. SETUP AND INSTALLATION

Follow these steps to set up your Amazon Basics Microwave:

1. **Unpacking:** Carefully remove the microwave from its packaging. Retain packaging materials for future transport or storage if needed.
2. **Placement:** Place the microwave on a flat, stable surface, such as a kitchen counter. Ensure there is adequate space around the unit for ventilation (at least 4 inches on all sides and top). Do not block ventilation openings.
3. **Power Connection:** Plug the microwave into a grounded electrical outlet. The power cord is approximately 3-4 feet long.
4. **Alexa Pairing:** To enable voice control, you will need a compatible Echo device (e.g., Echo Dot, Echo Plus). Ensure your Echo device is set up and connected to your Wi-Fi network. The microwave should automatically connect to your Alexa account once powered on and within range of your Echo device. Follow the instructions in the Alexa app for any additional setup.

4. OPERATING INSTRUCTIONS

Your Amazon Basics Microwave offers both manual keypad operation and convenient Alexa voice control.

4.1 Manual Keypad Operation



Image: Front view of the Amazon Basics Microwave, displaying the control panel and digital clock.

- **Setting Cook Time:** Use the number pad (1-9, 0) to enter the desired cooking time.

- **Power Levels:** The microwave features 10 power levels. Press the "POWER LEVEL" button and then a number to select the desired power level (e.g., 5 for 50% power).
- **Start:** Press the "START +30 SEC." button to begin cooking. Each press of this button adds 30 seconds to the cooking time.
- **Pause/Stop:** Press the "PAUSE/STOP" button once to pause cooking, or twice to cancel the current cooking cycle.
- **Kitchen Timer:** Use the "KITCHEN TIMER" button to set a countdown timer without activating the microwave function.

4.2 Alexa Voice Control

With an Echo device, you can use voice commands for quick and convenient cooking. Ensure your Echo device is active and connected.

- **General Commands:**
 - "Alexa, start microwaving."
 - "Alexa, microwave for [X] minutes [Y] seconds."
 - "Alexa, set microwave power to [level 1-10]."
 - "Alexa, STOP Microwave." (Note: Use "STOP Microwave" specifically to end a cycle.)
- **Quick-Cook Presets:** Alexa offers various presets for common foods.
 - "Alexa, microwave a potato." (Alexa will ask for quantity.)
 - "Alexa, reheat one cup of coffee."
 - "Alexa, microwave 1.5 ounces of popcorn."
 - "Alexa, defrost [X] ounces of frozen vegetables."



Image: Demonstrating voice command for reheating coffee.



Image: Demonstrating voice command for microwaving popcorn.

4.3 Using the Ask Alexa Button

The "Ask Alexa" button on the microwave's control panel allows you to initiate voice commands without saying the wake word "Alexa".

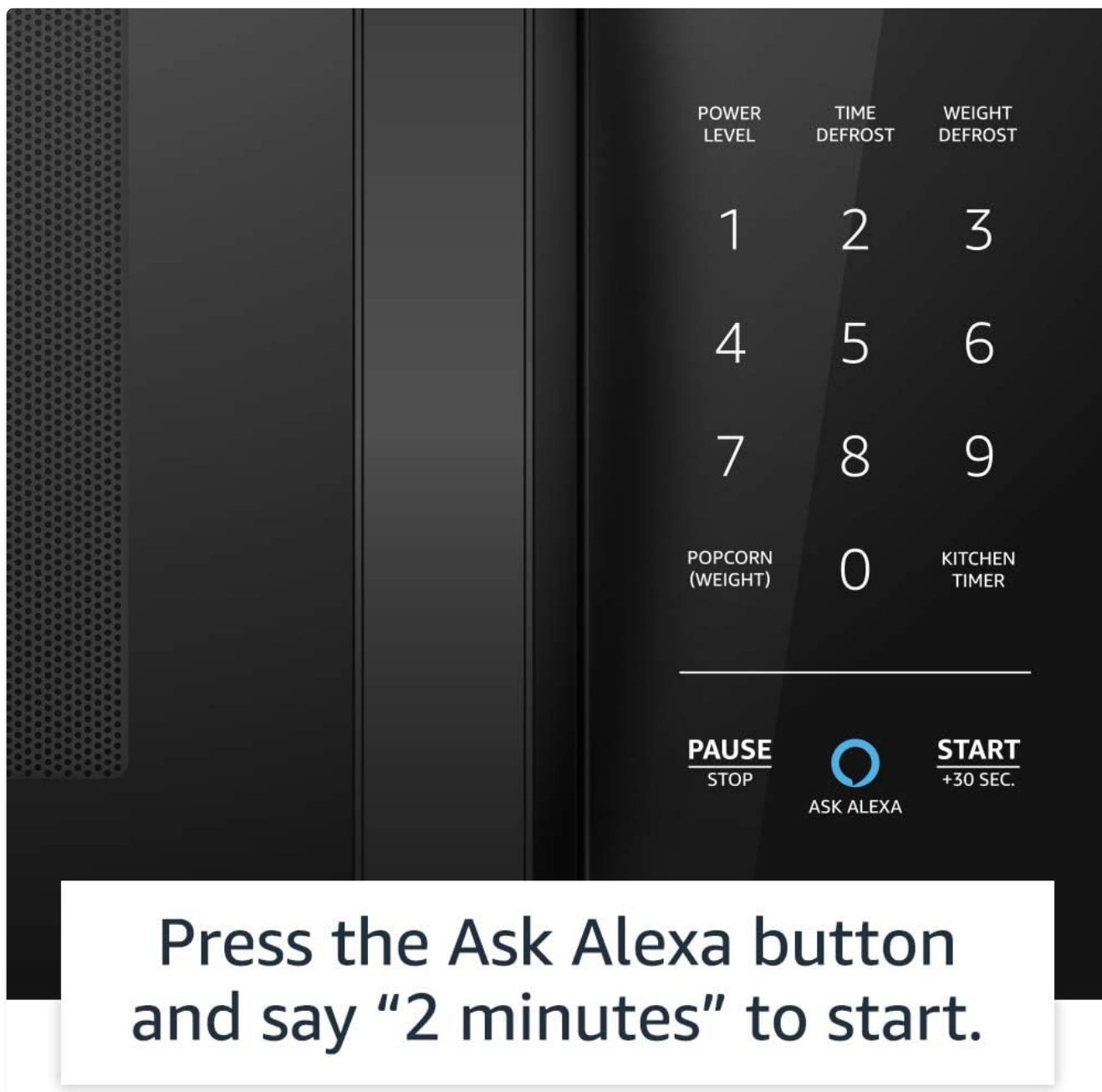

Image: Detail of the control panel, showing the "Ask Alexa" button for direct voice input.

- Press the **Ask Alexa** button (blue circle icon).
- Once the microwave indicates it's listening, state your command (e.g., "2 minutes," "reheat coffee," "popcorn").

4.4 Child Lock Function

To prevent unintended operation, especially by children, you can activate the child lock:

- **To Activate:** Press the "PAUSE/STOP" button once, then press the "0" button twice. The Wi-Fi indicator on the display will turn off, indicating the lock is active.
- **To Deactivate:** Repeat the same process: Press the "PAUSE/STOP" button once, then press the "0" button twice. The Wi-Fi indicator will reappear, and the microwave will be operational.

5. MAINTENANCE AND CLEANING

Regular cleaning helps maintain the performance and longevity of your microwave.

- **Interior:** Clean the oven cavity after each use with a damp cloth and mild detergent. For stubborn stains, place

a bowl of water with lemon slices inside and microwave for a few minutes to loosen residue, then wipe clean.

- **Exterior:** Wipe the exterior surfaces with a soft, damp cloth. Avoid abrasive cleaners or solvents.
- **Turntable:** The glass turntable and turntable support can be removed for cleaning. Wash them in warm, soapy water or in the dishwasher. Ensure they are completely dry before placing them back in the oven.
- **Door Seal:** Keep the door seal and adjacent parts clean. Wipe with a damp cloth.

6. TROUBLESHOOTING

If you encounter issues with your Amazon Basics Microwave, refer to the following common problems and solutions:

Problem	Possible Cause / Solution
Microwave does not start.	Ensure the door is securely closed. Check if the microwave is plugged into a working outlet. Verify if a circuit breaker has tripped. Check if the child lock is activated (see Section 4.4).
Food is not cooking or heating properly.	Ensure correct cooking time and power level are set. Check if the turntable is rotating correctly. Food quantity may be too large for the set time.
Alexa voice commands are not working.	Ensure your Echo device is powered on and connected to Wi-Fi. Verify the microwave is linked to your Alexa account in the Alexa app. Speak clearly and ensure you are within range of your Echo device. Confirm the child lock is not active.
Unusual noises during operation.	Ensure the turntable and its support ring are correctly positioned. Check for any foreign objects inside the microwave.

If the problem persists after attempting these solutions, please contact Amazon customer support.

7. SPECIFICATIONS

Detailed specifications for the Amazon Basics Microwave:

Feature	Specification
Model Number	B07894S727
Capacity	0.7 Cu. Ft.
Cooking Power	700 Watts
Power Levels	10
External Dimensions (W x H x D)	17.3 in. x 10.1 in. x 14.1 in.

Feature	Specification
Internal Dimensions (W x H x D)	10 7/8 in. x 6 7/8 in. x 10 in.
Turntable Diameter	10 in.
Max Popcorn Bag Size	3 oz
Connectivity	Works with Alexa (Echo device required)



Image: Interior view of the microwave, highlighting its features like the turntable.

8. WARRANTY AND SUPPORT

For information regarding your product's warranty, please refer to the warranty card included with your purchase or visit the Amazon Basics official website. For technical support, troubleshooting assistance beyond this manual, or to inquire about replacement parts, please contact Amazon customer support directly. You can typically find support contact information on the Amazon website under "Help & Customer Service" or by

Related Documents - B07894S727

[illegible]

