

GLOBE 91205

GLOBE ELECTRIC 91205 3" White Integrated Recessed Kit User Manual

Model: 91205

1. IMPORTANT SAFETY INFORMATION

Please read and understand all instructions before beginning installation. Failure to do so may result in electric shock, fire, or other injuries that could be hazardous or fatal. Keep these instructions for future reference.

- **WARNING:** Risk of electric shock. Disconnect power at the fuse or circuit breaker before installing or servicing.
- **WARNING:** Risk of fire. Use only with specified voltage and wattage.
- This product must be installed in accordance with the applicable installation code by a person familiar with the construction and operation of the product and the hazards involved.
- Ensure all electrical connections are secure and comply with local codes and ordinances.
- Do not alter or modify the fixture.
- Suitable for damp locations.
- IC Rated for direct contact with insulation.

2. PRODUCT OVERVIEW

The GLOBE ELECTRIC 91205 is a 3-inch white integrated LED recessed lighting kit designed for easy installation and efficient illumination. This ultra-slim fixture provides 370 lumens of light output with a 3000K color temperature, offering a warm white glow. Its integrated LED design ensures long-lasting performance without the need for bulb replacement.

Key Features:

- 370 lumens of light output
- 3000K color temperature (Warm White)
- Dimmable construction
- Integrated LED for 50,000 hours of illumination
- Ultra-slim design for easy installation in shallow ceilings
- IC Rated for direct contact with insulation

- Wet rated, suitable for damp locations

Package Contents:

- 1 x 3" Integrated LED Recessed Light Fixture
- 1 x Remote Driver/Junction Box with Integrated LED Connect Cable
- Installation Hardware (e.g., wire connectors)



Figure 2.1: Overview of the GLOBE ELECTRIC 91205 recessed light kit, showing the LED fixture, remote driver/junction box, and connecting cable.



Figure 2.2: Close-up view of the 3-inch integrated LED recessed light fixture.

3. INSTALLATION INSTRUCTIONS

Before starting, ensure the power is turned off at the circuit breaker. This fixture is designed for flush mount installation in ceilings.

Tools Required (Not Included):

- Measuring Tape
- Pencil
- Drywall Saw or Hole Saw
- Wire Strippers
- Screwdriver

Installation Steps:

1. **Turn Off Power:** Locate the circuit breaker controlling the area where you will install the light and turn off the power. Verify power is off using a voltage tester.
2. **Determine Location:** Choose the desired location for your recessed light. Ensure there are no obstructions (joists, pipes, wires) in the ceiling space.
3. **Cut Hole:** Using a pencil, mark a 3.25-inch (8.25 cm) diameter hole in the ceiling. Carefully cut the hole using a drywall saw or hole saw.

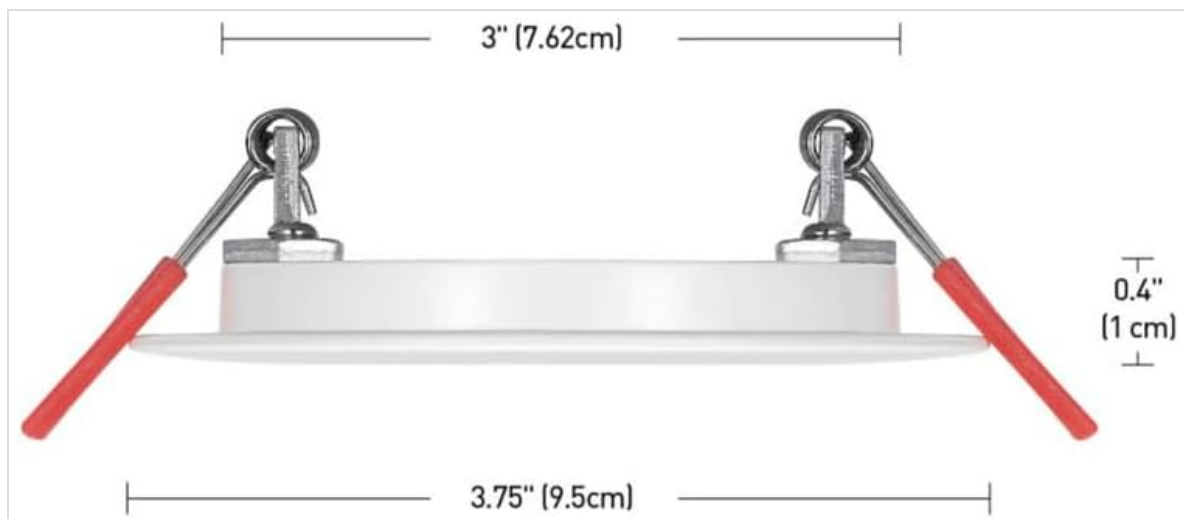

Figure 3.1: Dimensions of the recessed light fixture, showing a 3-inch (7.62cm) diameter and 0.4-inch (1cm) thickness.

4. **Prepare Wiring:** Run electrical supply wires (live, neutral, ground) to the cut-out hole.
5. **Connect Junction Box:** Open the cover of the remote driver/junction box. Remove the appropriate knock-out for your electrical cable. Insert the electrical supply cable into the junction box and secure it with a cable connector (not included, if required by local code).
6. **Wire Connections:** Connect the house wiring to the wires inside the junction box using the provided push-in quick connectors or wire nuts (if preferred):
 - Connect the **black** (Live) wire from the house to the **black** wire in the junction box.
 - Connect the **white** (Neutral) wire from the house to the **white** wire in the junction box.
 - Connect the **green** or bare copper (Ground) wire from the house to the **green** wire in the junction box.

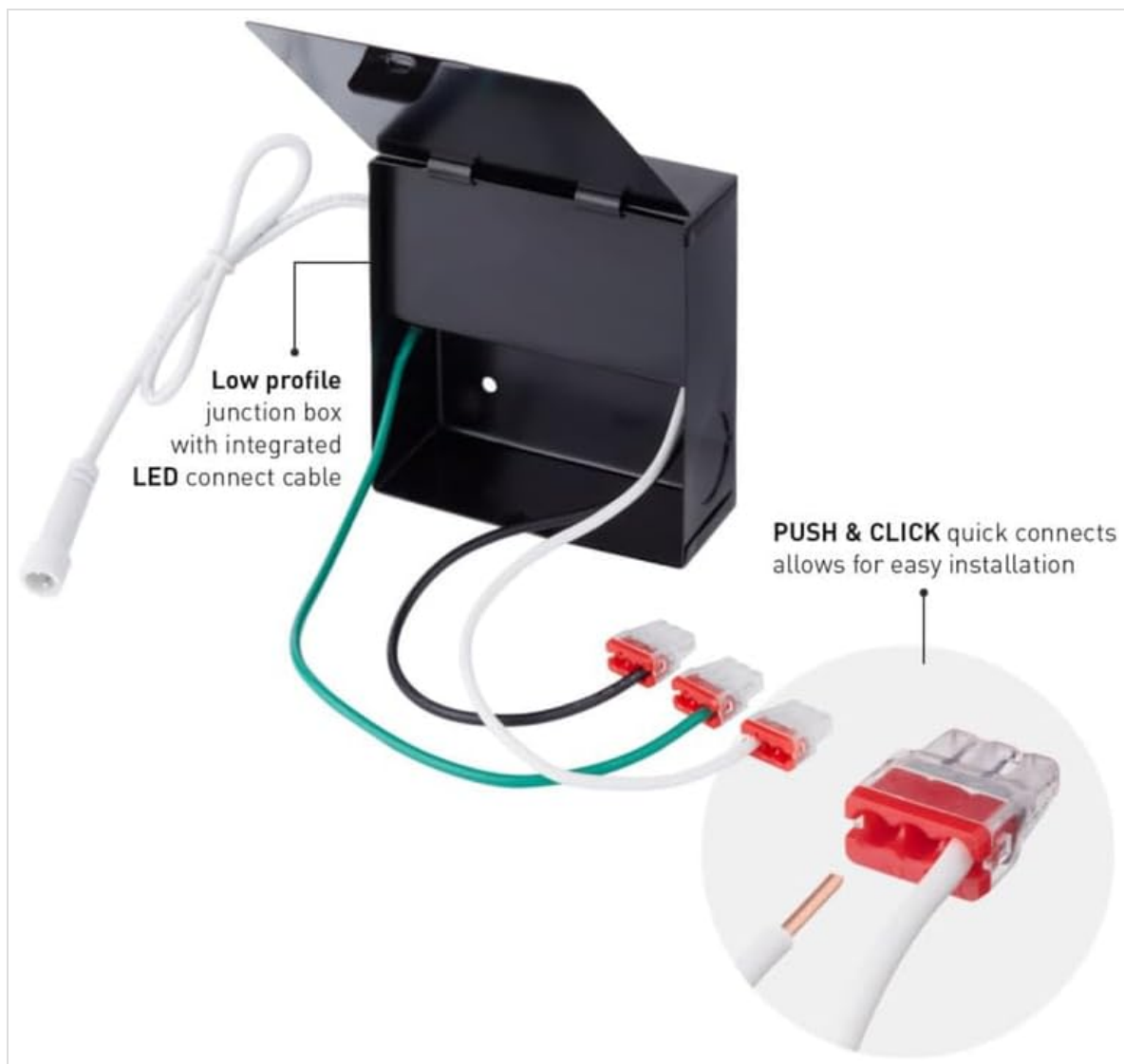

Figure 3.2: Wiring connections inside the low-profile junction box using push & click quick connectors for easy installation.

7. **Secure Junction Box:** Close the junction box cover and place the junction box into the ceiling opening.
8. **Connect Fixture:** Connect the integrated LED connect cable from the fixture to the corresponding connector on the junction box. Ensure the connection is secure.
9. **Install Fixture:** Push the spring clips on the sides of the recessed light fixture upwards. Insert the fixture into the ceiling hole. The spring clips will hold the fixture securely in place against the ceiling.
10. **Restore Power:** Once the fixture is securely installed, restore power at the circuit breaker.

4. OPERATING INSTRUCTIONS

The GLOBE ELECTRIC 91205 recessed light is designed for simple operation.

- **Turning On/Off:** Use a standard wall switch (not included) connected to the circuit to turn the light fixture on or off.
- **Dimming:** This fixture is dimmable. To utilize the dimming feature, connect it to a compatible LED dimmer switch (sold separately). Follow the dimmer switch manufacturer's instructions for installation and operation.



Figure 4.1: Example of GLOBE ELECTRIC recessed lights installed in a living room setting.



Figure 4.2: Example of GLOBE ELECTRIC recessed lights providing illumination in a kitchen.



Figure 4.3: Example of GLOBE ELECTRIC recessed lights installed in a covered outdoor entryway, suitable for damp locations.

5. MAINTENANCE

The GLOBE ELECTRIC 91205 recessed light requires minimal maintenance.

- **Cleaning:** Ensure power is off before cleaning. Wipe the fixture with a soft, dry, or slightly damp cloth. Do not use harsh chemicals or abrasive cleaners, as they may damage the finish or electrical components.
- **LED Longevity:** The integrated LED is designed for a long lifespan (50,000 hours) and does not require bulb replacement.

6. TROUBLESHOOTING

If you experience issues with your recessed light, refer to the following common problems and solutions:

Problem	Possible Cause	Solution
---------	----------------	----------

Problem	Possible Cause	Solution
Light does not turn on	No power to the fixture Loose wiring connection Faulty switch	Check circuit breaker and wall switch. Ensure power is on. Verify all wire connections are secure (with power off). Test the switch with another device or replace if faulty.
Light flickers or dims inconsistently	Incompatible dimmer switch Loose wiring connection	Ensure you are using an LED-compatible dimmer switch. Check all wiring connections (with power off).
Light is not as bright as expected	Dimmer setting too low Incorrect voltage supply	Adjust the dimmer to its maximum setting. Verify the voltage supply to the fixture is correct (220 Volts as per specifications).

If the problem persists after attempting these solutions, contact a qualified electrician or GLOBE ELECTRIC customer support.

7. SPECIFICATIONS

Feature	Specification
Model Number	91205
Brand	GLOBE ELECTRIC
Light Source Type	Integrated LED
Light Output	370 Lumens
Color Temperature	3000K (Warm White)
Wattage	6W (Equivalent to 40W incandescent)
Voltage	220 Volts
Dimmable	Yes
Fixture Diameter	3 inches (7.62 cm)
Hole Cut-out Size	3.25 inches (8.25 cm)
Material	Copper (internal), Plastic (shade)
Finish	White
Indoor/Outdoor Usage	Indoor (Wet Rated)
Certifications	ES, IC, Wet, Airtight, ETL, CEC Title 24 approved

Feature	Specification
Estimated Lifespan	50,000 hours
Product Dimensions	2.83 x 5.12 x 5.12 inches
Item Weight	0.01 Ounces



8. WARRANTY AND SUPPORT



For warranty information or technical support, please contact GLOBE ELECTRIC customer service. Keep your purchase receipt as proof of purchase.

- **Manufacturer:** GLOBE ELECTRIC
- **Contact Information:** Refer to the GLOBE ELECTRIC official website or product packaging for the most current customer support details.

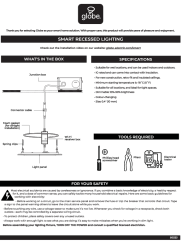
© 2023 GLOBE ELECTRIC. All rights reserved.

Related Documents - 91205

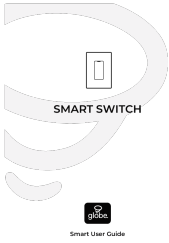
	<p>Globe SMART FLOOR LAMP User Manual and Setup Guide</p> <p>Comprehensive guide for the Globe SMART FLOOR LAMP, including safety instructions, features, specifications, assembly, and connecting to the Globe Suite app and voice assistants like Google Home and Amazon Alexa.</p>
	<p>Globe Smart Recessed Lighting Installation Guide and Specifications</p> <p>Comprehensive guide for installing Globe's Smart Recessed Lighting, including what's in the box, tools required, safety precautions, mounting instructions, specifications, and warranty information.</p>
	<p>Globe SMART 4 LIGHT TRACK BAR Installation and Safety Guide</p> <p>Comprehensive guide for the Globe SMART 4 LIGHT TRACK BAR, including safety instructions, electrical installation, features, specifications, and app connectivity for smart home integration. This document is primarily in English with supplementary French content.</p>
	<p>Globe Streamwatch Xtreme Prepaid User Manual and Setup Guide</p> <p>Comprehensive user manual for the Globe Streamwatch Xtreme Prepaid device. Learn how to connect to the internet, stream content on your TV, access apps via Google Play, and find troubleshooting solutions. Includes setup guides and device information.</p>

 The image shows the cover of the 'Globe Smart Switch User Guide'. It features a large, stylized 'G' logo in the background. In the center, there is a small icon of a smart switch. Below the icon, the text 'SMART SWITCH' is written. At the bottom, there is a small 'globe' logo and the text 'Smart User Guide'.	<p>Globe Smart Switch User Guide</p> <p>User guide for the Globe Smart Switch, detailing installation, setup via the Globe Suite™ app, features like remote control, scheduling, and voice assistant integration. Learn how to enhance your home with smart lighting control.</p>
 The image shows the cover of the 'Globe Running Boards Assembly Guide for Haul LT Bicycle'. It features a collage of four small images: a running board, a bicycle, a person riding a bicycle, and a close-up of the running board being installed on a bicycle.	<p>Globe Running Boards Assembly Guide for Haul LT Bicycle</p> <p>Step-by-step instructions and safety information for assembling Globe Running Boards onto your Globe Haul LT bicycle, including parts lists, torque specifications, and weight limits.</p>