

PERLESMITH PSLTK1

PERLESMITH Tilt TV Wall Mount Instruction Manual

MODEL: PSLTK1

INTRODUCTION

This manual provides detailed instructions for the safe and proper installation and operation of your PERLESMITH Tilt TV Wall Mount, Model PSLTK1. Please read all instructions carefully before beginning installation to ensure correct setup and to prevent damage or injury.

The PERLESMITH PSLTK1 is designed to securely mount flat and curved televisions ranging from 37 to 82 inches, with a maximum weight capacity of 132 lbs (60 kg). It supports various VESA mounting patterns up to 600x400mm and allows for a low-profile installation with adjustable tilt for optimal viewing.

SAFETY INFORMATION

WARNING: Failure to read and follow all instructions may result in personal injury, property damage, or voiding of your warranty. If you have any questions, please contact PERLESMITH customer service.

- **Weight Capacity:** Do not exceed the maximum weight capacity of 132 lbs (60 kg). This mount is intended for use only with the maximum weights indicated. Use with products heavier than the maximum weights indicated may result in instability causing possible injury.
- **TV Size:** This mount is compatible with TVs between 37 and 82 inches. Ensure your TV's width is 26 inches or above to properly conceal the mount.
- **Wall Type:** This mount is designed for installation on wood studs (16-24 inch spacing), solid concrete, or brick walls. **DO NOT install on drywall alone.** A stud finder is highly recommended for wood stud installations.
- **VESA Compatibility:** Verify your TV's VESA mounting pattern (horizontal x vertical distance between mounting holes) is between 200x100mm and 600x400mm.
- Always ensure the mounting surface can safely support the combined weight of the mount and the television.
- Use appropriate safety gear during installation, including eye protection.

- Two people are recommended for installation, especially when lifting the television.

PACKAGE CONTENTS

Please check that all components are present and undamaged before installation. If any parts are missing or defective, contact PERLESMITH customer service.

- 1x TV Wall Mount Assembly
- 1x Standard Mounting Hardware Kit (various screws, washers, spacers)
- 1x User Manual Guide (this document)
- 1x 3-Axis Magnetic Bubble Level
- 5x Cable Ties



Image: All components of the PERLESMITH Tilt TV Wall Mount PSLTK1, including the wall plate, TV brackets, a bubble level, and cable ties.

COMPATIBILITY CHECK

Before proceeding with installation, confirm your TV and wall meet the following criteria:

- **TV Size:** Your TV diagonal measurement should be between 37 and 82 inches.
- **TV Weight:** Your TV must weigh less than 132 lbs (60 kg).
- **VESA Pattern:** Measure the horizontal and vertical distance between the mounting holes on the back of your TV. This distance must be within the range of 200x100mm to 600x400mm.
- **Wall Type:** Ensure your wall has 16-24 inch wood studs, or is solid concrete/brick. Do not install on drywall alone.
- **TV Width:** The width of your TV should be 26 inches or greater to ensure the mount is hidden behind the TV.



Image: Diagram illustrating the wide compatibility of the mount for TVs between 37-82 inches and VESA patterns from 200x100mm to 600x400mm, with wood stud spacing of 16-24 inches.

WILL THE TV MOUNT FIT YOUR TV ?

Must know before purchase

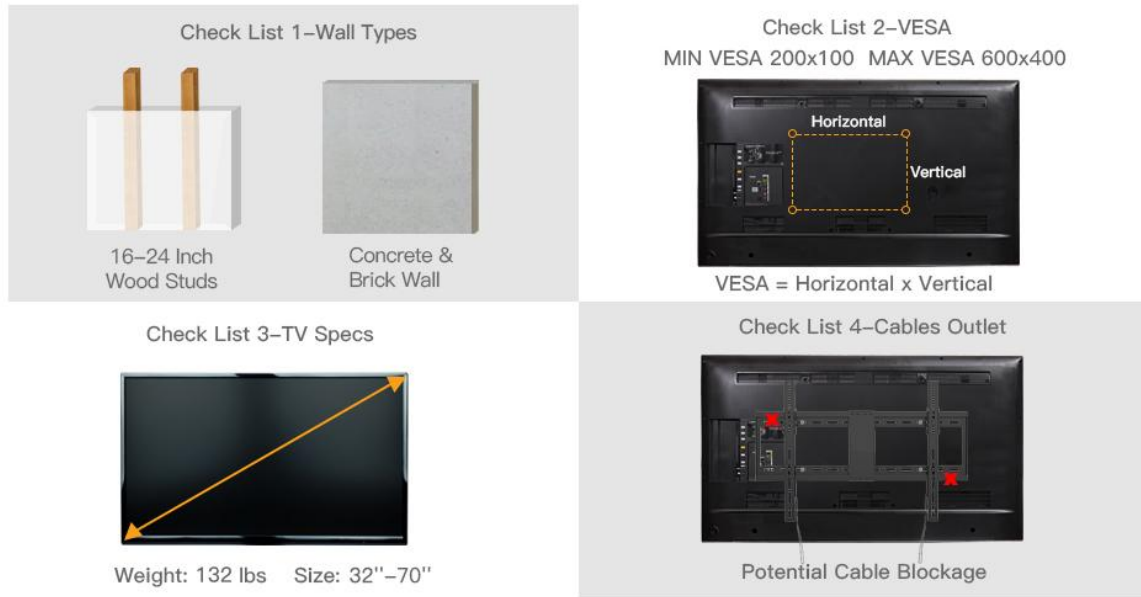

Image: A visual checklist detailing wall types (wood studs, concrete/brick), VESA compatibility (min 200x100, max 600x400), TV specifications (weight 132 lbs, size 32-70 inches), and potential cable outlet blockage.

SETUP AND INSTALLATION

Tools Required (Not Included)

- Pencil
- Tape Measure
- Drill
- Stud Finder (essential for wood stud installation)
- Socket Wrench
- Phillips Head Screwdriver

Installation Steps

1. Step 1: Locate Wall Studs or Mark Concrete/Brick Wall.

For wood stud installation, use a stud finder to locate the edges and center of two adjacent wood studs. Mark the center of the studs. The mount is designed for 16-inch or 24-inch stud spacing. For concrete or brick walls, determine the desired mounting location and mark the drill points directly.

2. Step 2: Position and Level the Wall Plate.

Hold the wall plate against the wall at your desired height. Use the included bubble level (or a more reliable level) to ensure the wall plate is perfectly horizontal. Mark the drilling locations through the holes on the wall plate. For the two-piece wall plate design, ensure both sections are aligned and level before marking holes. It is crucial to align the two sections precisely to avoid a tilted TV.

3. Step 3: Drill Pilot Holes.

Using an appropriate drill bit size (refer to hardware kit instructions for specific sizes based on wall type and lag bolt dimensions), drill pilot holes at the marked locations. Ensure the depth of the holes is sufficient for the lag bolts.

4. Step 4: Attach Wall Plate to Wall.

Align the wall plate with the drilled holes. Insert the lag bolts with washers through the wall plate and into the pilot holes. Tighten the lag bolts firmly with a socket wrench until the wall plate is securely fastened to the wall. Do not overtighten.

5. **Step 5: Attach TV Brackets to Television.**

Lay your TV face down on a soft, clean surface. Identify the VESA mounting holes on the back of your TV. Select the appropriate screws, washers, and spacers from the hardware kit that fit your TV's mounting holes. Attach the two vertical TV brackets to the back of your TV, ensuring they are centered and oriented correctly. The hooks on the brackets should face upwards and away from the TV's bottom edge.

6. **Step 6: Hang Television on Wall Plate.**

With assistance, carefully lift the television and hook the TV brackets onto the top edge of the wall plate. Gently lower the TV until the brackets are fully seated on the wall plate. Ensure both brackets are securely engaged.

7. **Step 7: Secure Television to Wall Plate.**

Locate the locking mechanisms on the bottom of the TV brackets. Pull the integrated cords to engage the locking tabs, securing the TV to the wall plate. This prevents accidental dislodgement.

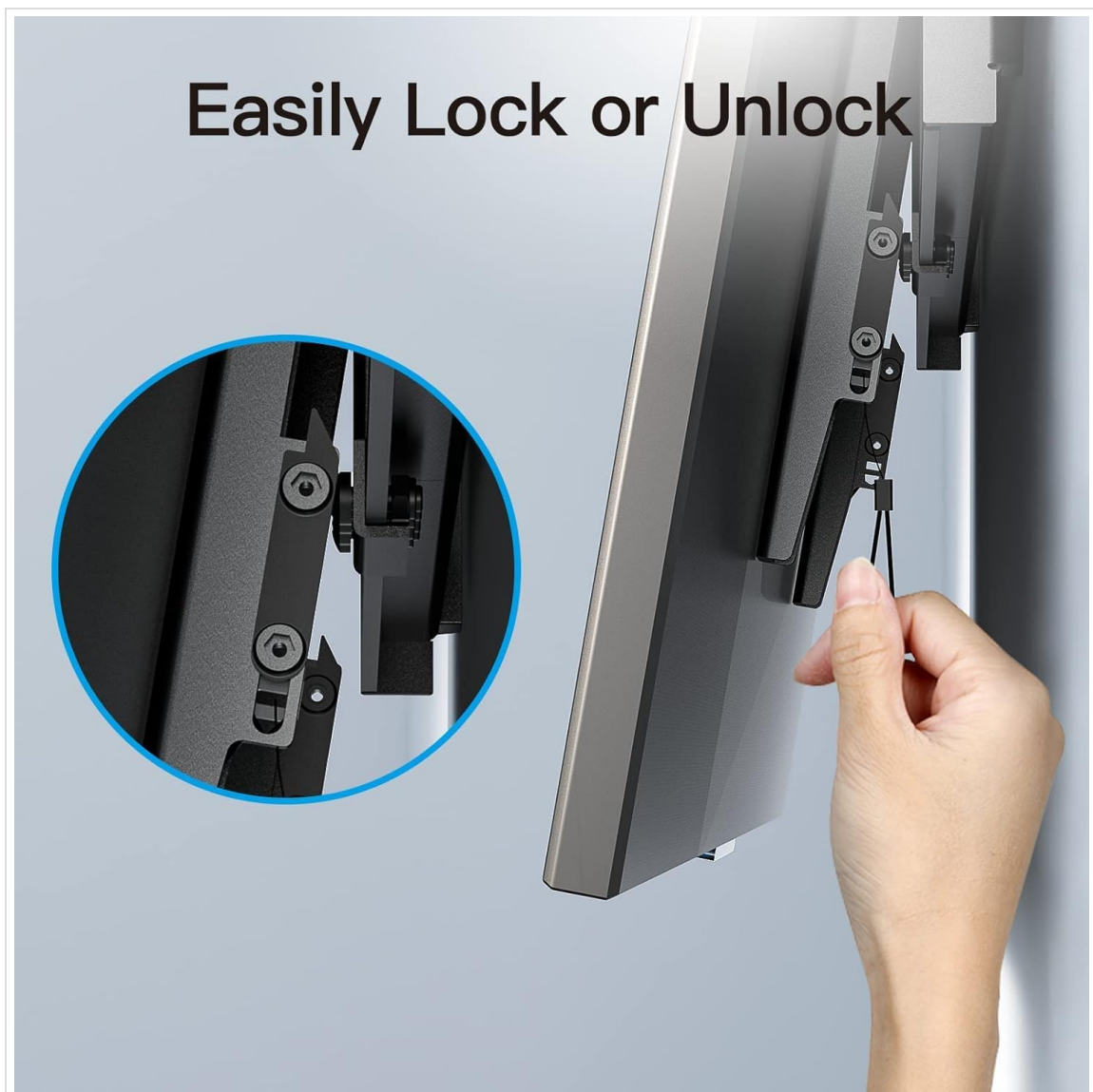

Image: A close-up view demonstrating how to easily lock or unlock the TV from the wall plate using the integrated pull cord mechanism.

8. **Step 8: Cable Management.**

Use the provided cable ties to neatly organize and secure your TV cables, routing them along the mount or behind the TV for a clean appearance.

OPERATING THE MOUNT

Adjusting Tilt Angle

The PERLESMITH PSLTK1 allows for a downward tilt of 0 to 7 degrees. To adjust the tilt:

1. Loosen the tilt adjustment screws located on the sides of the TV brackets.
2. Carefully tilt the TV to your desired viewing angle.
3. Tighten the tilt adjustment screws firmly to secure the TV in place. Ensure both sides are tightened equally to maintain a level screen.

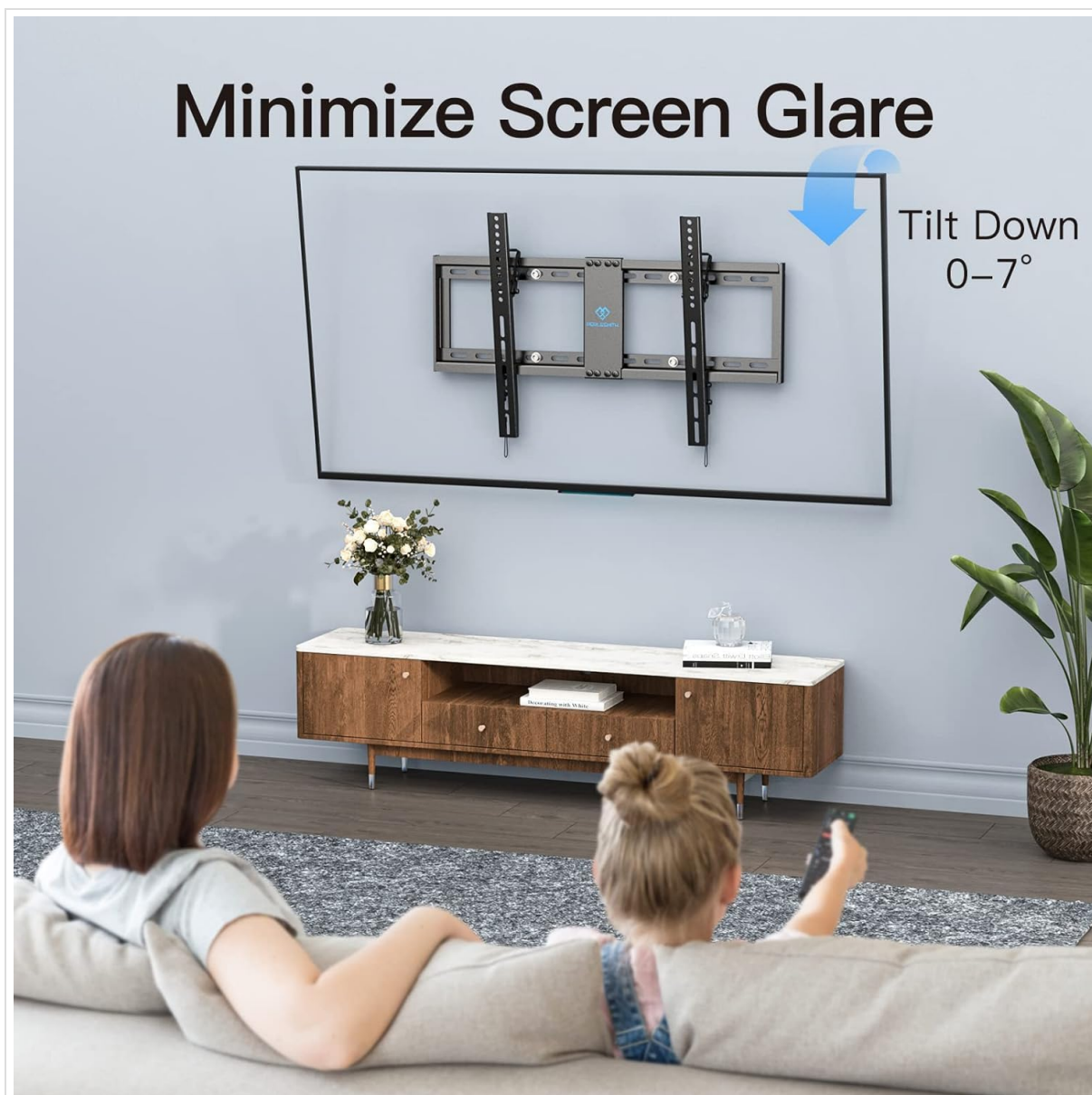

Image: A living room scene demonstrating how tilting the TV downwards (0-7 degrees) can help minimize screen glare for an improved viewing experience.

Centering the TV

The design of the wall plate allows for lateral shift movement of the TV, enabling you to perfectly center it on your wall even if the wall studs are off-center.

1. Ensure the TV is unlocked from the wall plate (if applicable).
2. Gently slide the TV left or right along the wall plate until it is in the desired position.
3. Relock the TV to the wall plate using the integrated pull cords.

MAINTENANCE

Regular maintenance helps ensure the longevity and safety of your TV wall mount.



- **Cleaning:** Dust the mount periodically with a soft, dry cloth. Avoid using abrasive cleaners or solvents.
- **Fastener Check:** Periodically check all screws and bolts to ensure they remain tight and secure. Retighten if necessary.
- **Damage Inspection:** Inspect the mount for any signs of wear, damage, or corrosion. If any issues are found, contact PERLESMITH customer service for assistance.

TROUBLESHOOTING

- **TV appears tilted after installation:**
The wall plate for this model consists of two pieces joined together. Ensure both sections are perfectly aligned and level during installation. Use a reliable, longer level to verify horizontal alignment across the entire wall plate before tightening all fasteners. If already installed, loosen the wall plate fasteners slightly, adjust for level, and retighten.
- **Mount feels flimsy or unstable:**
Ensure all lag bolts securing the wall plate to the wall are fully tightened into solid wood studs or concrete/brick. Verify that the TV brackets are correctly attached to the TV and securely hooked onto the wall plate, with the locking mechanisms engaged. This mount is tested to hold 4 times its rated weight, so proper installation is key to stability.
- **TV does not fit the mount:**
Re-check the compatibility criteria: TV size (37-82 inches), TV weight (under 132 lbs/60 kg), and VESA mounting pattern (200x100mm to 600x400mm). Also, ensure your TV's width is at least 26 inches. If your TV falls outside these specifications, it is not compatible with this mount.
- **Cannot adjust tilt:**
Ensure the tilt adjustment screws on the TV brackets are sufficiently loosened before attempting to adjust the angle. After adjusting, tighten them firmly.

SPECIFICATIONS

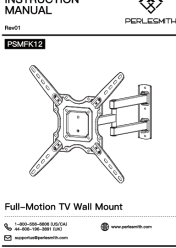
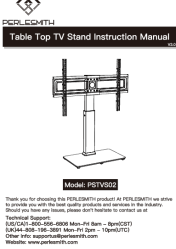
Brand	PERLESMITH
Model	PSLTK1
Compatible Devices	Monitor, Television
Mounting Type	Wall Mount
Movement Type	Tilt
Material	Alloy Steel

	<p>PERLESMITH PSTM2 TV Tripod Stand Instruction Manual</p> <p>Instruction manual for the PERLESMITH PSTM2 TV Tripod Stand, detailing assembly, safety instructions, and adjustments for mounting TVs up to 75 inches.</p>
	<p>PERLESMITH PSMFK12 Full-Motion TV Wall Mount Instruction Manual</p> <p>Comprehensive instruction manual for the PERLESMITH PSMFK12 Full-Motion TV Wall Mount, covering installation, safety, and adjustment for TVs up to 77lbs with VESA patterns up to 400x400mm.</p>
	<p>PERLESMITH PSTVS02 Table Top TV Stand Instruction Manual</p> <p>Comprehensive instruction manual for the PERLESMITH PSTVS02 Table Top TV Stand, detailing assembly, safety instructions, and compatibility checks for various TV sizes and VESA patterns.</p>
	<p>Perlesmith PSXF4 TV Wall Mount Instruction Manual</p> <p>Comprehensive instruction manual for the Perlesmith PSXF4 TV Wall Mount, detailing safety information, parts list, tools needed, and step-by-step installation for various wall types and TV back configurations.</p>

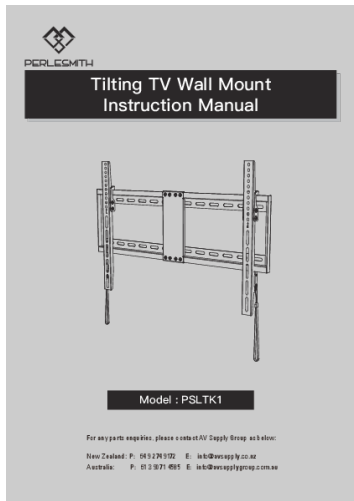

[\[pdf\]](#) User Manual Installation Guide Instructions

860 00285 02 Rev00 A PSLTK1 C J Manual YN 2022 05 31 AVSG M avsupply co nz site files

Perlesmith |||

Tilting TV Wall Mount Instruction Manual Model :**PSLTK1** For any parts enquiries, please contact AV Supply Group as below: New Zealand: P: 64 9 274 9172 E: info avsupply.co.nz Australia: P: 61 3 9071 4585 E: info avsupplygroup.com.au

IMPORTANT SAFETY INFORMATION Please carefully read all instructio...

lang:en score:31 filesize: 3.56 M page_count: 14 document date: 2022-12-15

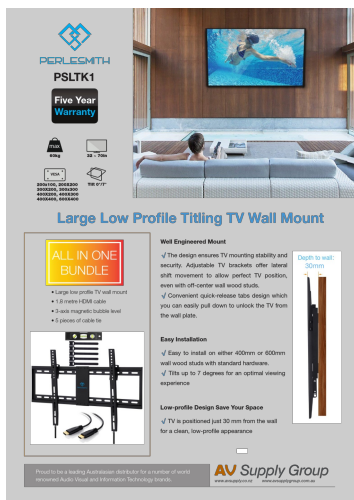

[\[pdf\]](#) Installation Guide Warranty

PSLTK1 SS avsupply co nz site files Perlesmith |||

PSLTK1 Five Year Warranty max 60kg 32 - 70in VESA 200x100, 200X200 300X200, 300x300 400X200, 400X300 400X400, 600X400 Tilt 0/7 Large Low Profile Tilting TV Wall Mount ALL IN ONE BUNDLE Large low profile TV wall mount 1.8 metre HDMI cable 3-axis magnetic bubble level 5 pieces of cable tie ...

lang:en score:30 filesize: 3.99 M page_count: 1 document date: 2018-11-05

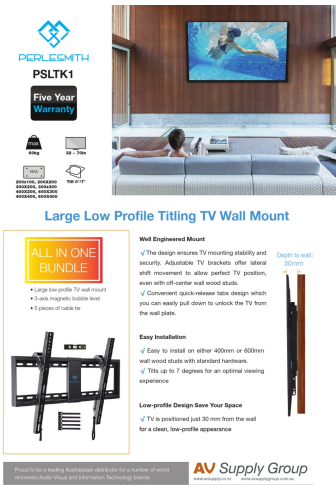

[pdf] Installation Guide Warranty

PSMTK1 SS1 SS 24012022 avsupply co nz site files Perlesmith |||

PSMTK1 Five Year Warranty max 60kg 32 - 70in VESA 200x100, 200X200 300X200, 300x300 400X200, 400X300 400X400, 600X400 Tilt 0/7 Large Low Profile Tiltng TV Wall Mount ALL IN ONE BUNDLE Large low profile TV wall mount 3-axis magnetic bubble level 5 pieces of cable tie Well Engineered Mount ...

lang:en score:30 filesize: 4.18 M page_count: 1 document date: 2022-01-24



[pdf] Installation Guide Instructions

PSMTK1 1 Administrator Medium Full Motion Tv Wall Mount perlesmith medium full motion tv wall mount instructions C1iNHREqz5S images na ssl amazon I |||

MEDIUM FULL MOTION TV WALL MOUNT V1.0 supportus perlesmith.com 16 PSMFK5 supportus perlesmith.com 2/5 in. 10mm 5/34 in. 4 mm Concrete Drill Wood Drill Max400mm 15 3/4 in Wall Anchor L Philips Philips Philips Philips Philips Philips Lag Bolts Washers Washers Spacers Spacers Screws Screw...

lang:en score:25 filesize: 5.39 M page_count: 2 document date: 2019-04-08



[pdf] User Manual

860 00285 07 Rev00 D PSMTK1 C J Manual JH 2023 01 12 zq User Amazon PERLESMITH UL Listed TV Mount for Most 32 82 inch Universal Tilt Wall Fits 16 24 Wood Stud with Loading 132 lbs Max VESA 600x400mm Low Profile Flat Bracket Electronics C1E3SxA4bZL m media amazon images I |||

lang:en score:14 filesize: 4.99 M page_count: 14 document date: 2023-08-21