

## SCHWAIGER 719444

# SCHWAIGER 9444 Motion TV Wall Mount User Manual

Model: 719444 | Brand: SCHWAIGER

[Introduction](#) [Safety Information](#) [Package Contents](#) [Setup & Installation](#) [Operation](#) [Maintenance](#) [Troubleshooting](#) [Specifications](#) [Warranty & Support](#)

## 1. INTRODUCTION

This manual provides detailed instructions for the safe and effective installation and use of your SCHWAIGER 9444 Motion TV Wall Mount. This wall mount is designed to securely attach flat-screen televisions ranging from 23 to 55 inches to a wall, offering versatile adjustment options including tilt, swivel, and height adjustment. The robust construction ensures secure mounting for televisions up to 30 kg.

## 2. SAFETY INFORMATION

Please read all instructions carefully before installation and use. Failure to follow these instructions may result in property damage, serious injury, or death. Keep this manual for future reference.

- Weight Capacity:** Do not exceed the maximum load capacity of 30 kg (66 lbs). This mount is intended for use only with the maximum weights indicated.
- Screen Size:** Compatible with TVs from 23 to 55 inches.
- Wall Type:** Installation is only possible on stable walls. Ensure the wall structure can safely support the combined weight of the mount and your television. Suitable wall types include concrete, solid brick, and wood studs. Avoid mounting on drywall alone without proper stud support.
- Professional Assistance:** If you are unsure about the installation process or the suitability of your wall, consult a qualified professional.
- Tools:** Use appropriate tools for installation. Wear safety glasses and gloves.
- Children:** Keep children away from the installation area.
- Assembly:** Two people are recommended for safe assembly and mounting of the television.

## 3. PACKAGE CONTENTS

Verify that all components are present and undamaged before beginning installation. The package includes:

- SCHWAIGER 9444 Motion TV Wall Mount assembly

- Mounting accessories (various screws, anchors, washers)
- Installation instructions (this manual)
- Small wrench and Allen key for adjustments



Figure 1: Overview of the SCHWAIGER 9444 Motion TV Wall Mount and all included mounting accessories.

## 4. SETUP & INSTALLATION

Follow these steps carefully to install your TV wall mount. It is recommended that two people perform the installation.

### 4.1. Determine VESA Standard

Before installation, identify the VESA mounting pattern on the back of your television. The VESA standard is measured in millimeters (mm) and represents the horizontal and vertical distance between the threaded holes. This mount supports VESA standards: 75x75, 100x100, 200x100, 200x200, 300x300, 400x200, and 400x400.

If you do not know your TV's VESA standard, measure the distance between the horizontal and vertical threaded holes on the back of your TV.

### 4.2. Wall Preparation

Ensure the chosen wall is stable and capable of supporting the weight of the mount and your TV. The mount can be installed on concrete, solid brick, or wood stud walls.

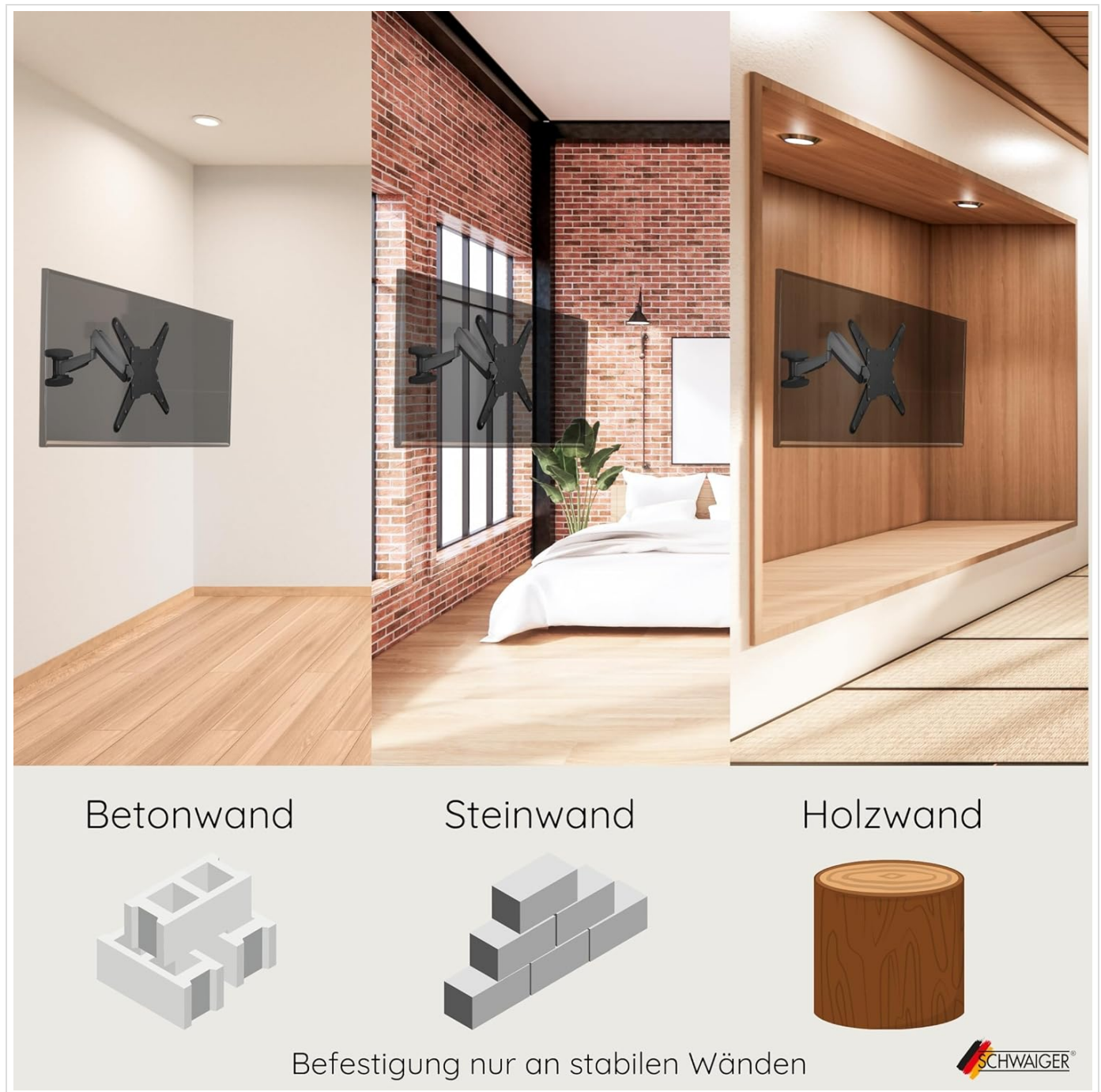

Figure 2: The wall mount is suitable for concrete, brick, and wood walls. Installation must only be on stable walls.

#### 4.3. Mounting the Wall Plate

1. Position the wall plate on your desired mounting location. Use a level to ensure it is perfectly horizontal.
2. Mark the five drilling points through the holes on the wall plate.
3. Drill five 10mm diameter holes at the marked positions. The depth of the holes should match the length of the wall anchors.
4. Insert the wall anchors into the drilled holes.
5. Align the wall plate with the anchors and secure it using the five long screws. Tighten the screws firmly using a wrench or ratchet until the plate is securely fastened to the wall.

#### 4.4. Attaching TV Brackets to the Television

1. Carefully place your TV face down on a soft, clean surface to prevent screen damage.
2. Attach the TV mounting brackets to the VESA holes on the back of your television using the appropriate screws and washers from the accessory kit. Ensure the brackets are oriented correctly (usually with the hooks facing upwards).

#### 4.5. Hanging the Television

1. With the help of a second person, carefully lift the television.
2. Hook the TV brackets onto the wall mount arm. Ensure the TV is securely seated on the mount.
3. Once the TV is hung, use the provided screws to secure the TV brackets to the mount, preventing accidental dislodgement.



Figure 3: The SCHWAIGER 9444 wall mount installed, demonstrating its range of motion in a living room.

#### 5. OPERATION AND ADJUSTMENTS

The SCHWAIGER 9444 wall mount offers multiple adjustment options for optimal viewing comfort.



## 5.1. Tilt Adjustment

The TV can be tilted forward by up to 10 degrees and backward by up to 20 degrees. Loosen the tilt adjustment knobs or screws on the TV bracket, adjust to the desired angle, and then re-tighten to secure the position.





Figure 4: Illustrates the tilt functionality of the TV mount, allowing adjustment for optimal viewing angles.

## 5.2. Swivel and Pivot Adjustment

The mount allows for horizontal swivel (left/right) and axial pivot. Gently push or pull the TV to achieve the desired viewing angle. The mount can swivel up to 90 degrees in each direction, depending on TV size and wall distance.

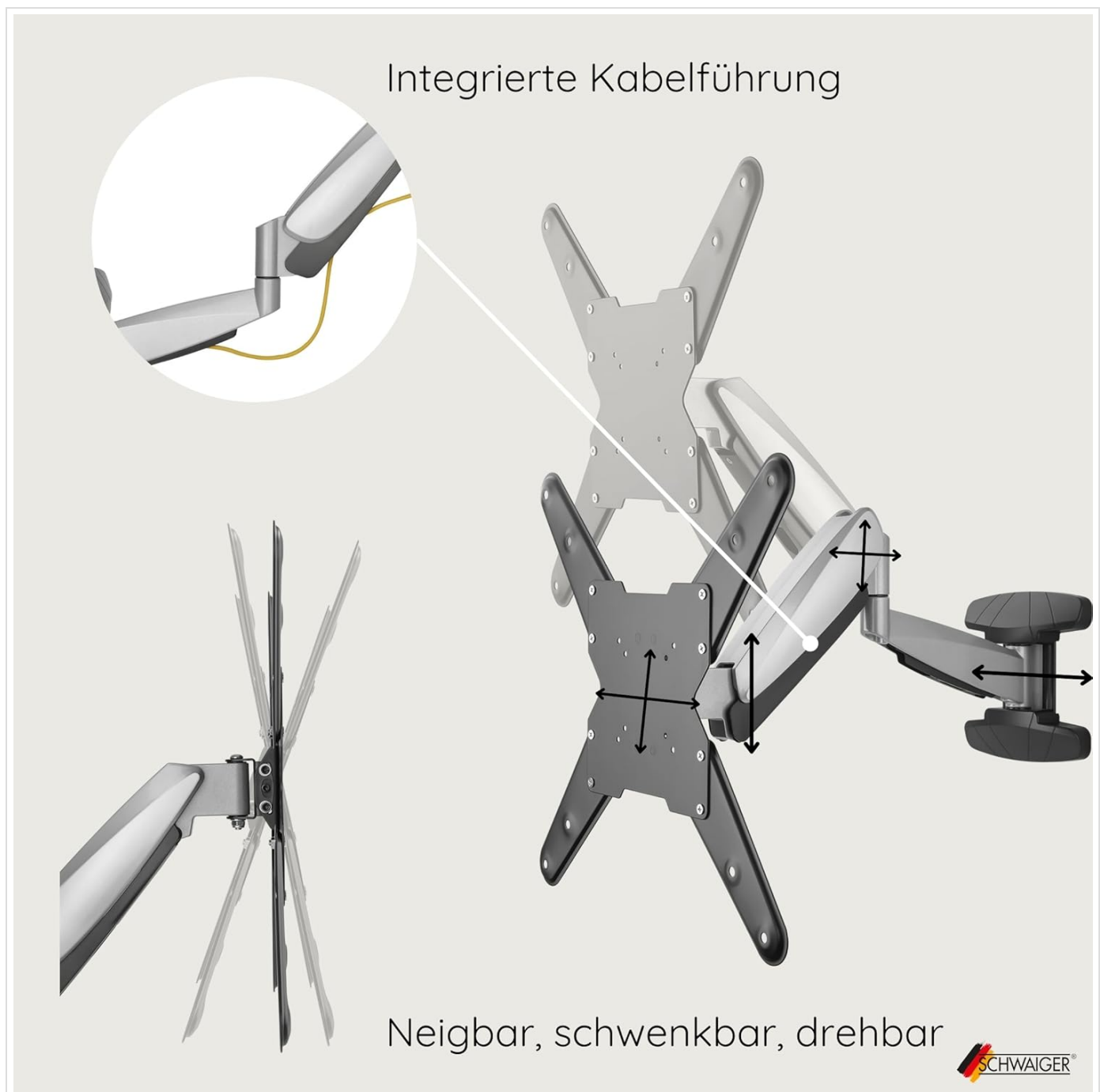

Figure 5: This diagram highlights the swivel, tilt, and integrated cable management features of the wall mount.

### 5.3. Distance from Wall Adjustment

The mount can extend the TV from the wall, with an adjustable distance ranging from 5.8 cm to 59.5 cm. Pull the TV gently away from the wall or push it closer to achieve the desired distance.



Figure 6: A side view illustrating the adjustable distance of the TV from the wall, ranging from 5.8 cm to 59.5 cm.

#### 5.4. Height Adjustment (Gas Spring Technology)

The integrated gas spring technology allows for vertical height adjustment of up to 32 cm. To adjust the height, you may need to fine-tune the tension screw on the gas spring mechanism. This screw typically requires an Allen key. Adjust the tension until the TV can be moved up and down with moderate effort and stays in the desired position.

*Note:* If the TV is too light, it might not stay down, or if too heavy, it might not stay up. Adjust the gas spring tension accordingly. Refer to the technical drawing for the location of adjustment points.

#### 5.5. Cable Management

The mount features integrated cable routing to keep cables organized and out of sight. Route your TV and power cables along the arms of the mount and secure them with cable ties or clips (not always included) to maintain a tidy appearance.





Figure 7: The wall mount provides flexible viewing angles, allowing a family to comfortably watch television.

## 6. MAINTENANCE

---

Regular maintenance ensures the longevity and safe operation of your TV wall mount.

- **Cleaning:** Clean the mount with a soft, dry cloth. Do not use abrasive cleaners or solvents, as they may damage the finish.
- **Check Connections:** Periodically check all screws and bolts to ensure they remain tight. Re-tighten if necessary.
- **Inspect for Damage:** Regularly inspect the mount for any signs of wear, damage, or corrosion. If any damage is found, discontinue use and contact customer support.

## 7. TROUBLESHOOTING

---

If you encounter issues with your SCHWAIGER 9444 Motion TV Wall Mount, refer to the following common problems and solutions:

| Problem                                  | Possible Cause   | Solution   |
|--|--|--|
| TV does not stay at desired height.      | Gas spring tension is incorrect for TV weight.                     | Adjust the gas spring tension screw using the provided Allen key. Increase tension if the TV sags; decrease if it floats up.             |
| TV is difficult to tilt or swivel.       | Adjustment screws are too tight.                                   | Loosen the relevant tilt or swivel adjustment screws slightly, adjust the TV, then re-tighten to hold the position.                      |
| Mount feels unstable after installation. | Wall plate screws are not fully tightened or wall is not suitable. | Ensure all five wall plate screws are securely tightened. If instability persists, the wall may not be adequate; consult a professional. |
| Missing parts or damaged components.     | Manufacturing defect or shipping damage.                           | Do not proceed with installation. Contact SCHWAIGER customer support immediately for assistance.   |

## 8. SPECIFICATIONS

---

| Feature                       | Detail  |
|-------------------------------|---|
| Model Number                  | 719444  |
| Compatible Screen Sizes       | 23 - 55 inches (58 - 140 cm)                                |
| Maximum Load Capacity         | 30 kg (66 lbs)  |
| VESA Standards Supported      | 75x75, 100x100, 200x100, 200x200, 300x300, 400x200, 400x400 |
| Distance to Wall (Adjustable) | 5.8 cm to 59.5 cm   |
| Tilt Angle                    | -10° to +20°  |
| Swivel Angle                  | Up to 90° left/right (depending on TV size)                 |
| Height Adjustment             | Up to 32 cm (via gas spring)                                |
| Material                      | Aluminum  |
| Dimensions (W x H x D)        | 42 x 42 x 5.8 cm (minimum depth)                            |

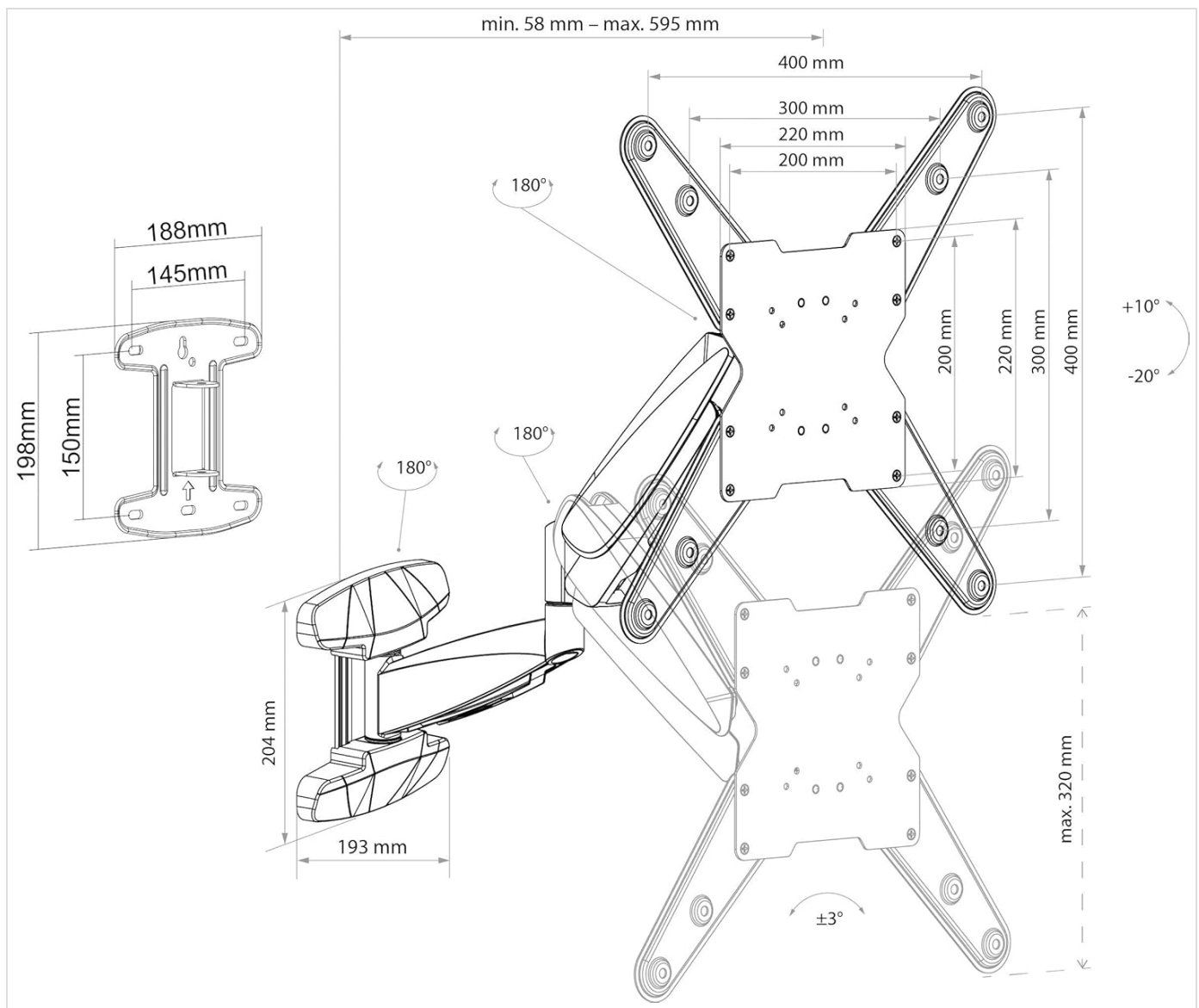

Figure 8: Technical drawing illustrating the dimensions, VESA patterns, and range of motion for the wall mount.







## 9. WARRANTY & SUPPORT

SCHWAIGER stands for competence and quality, with over 70 years of experience in providing innovative and high-quality solutions.

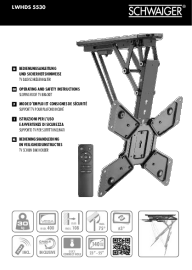
- **Warranty:** This product typically comes with a 2-year warranty. Please refer to your purchase documentation for specific warranty terms and conditions.
- **Customer Service:** For technical support, warranty claims, or any questions regarding your product, please contact SCHWAIGER customer service. Contact information can usually be found on the official SCHWAIGER website or your product packaging.
- **Spare Parts:** Information regarding the availability of spare parts is currently unavailable.

For further assistance, please visit the official SCHWAIGER website or contact their customer support directly.

## Related Documents - 719444

|   |  |
|---|--|
|  <p><b>LWHDS 5530</b><br/><b>SCHWAIGER</b></p> <p> <ul style="list-style-type: none"> <li>• KONTAKTIEREN SIE SICH MIT UNSEREM KUNDENSERVICE</li> <li>• VERSTÄNDLICHE ANLEITUNG UND SICHERHEITSHINWEISE</li> <li>• KONTAKTIEREN SIE SICH MIT UNSEREM KUNDENSERVICE</li> <li>• VERSTÄNDLICHE ANLEITUNG UND SICHERHEITSHINWEISE</li> <li>• KONTAKTIEREN SIE SICH MIT UNSEREM KUNDENSERVICE</li> <li>• VERSTÄNDLICHE ANLEITUNG UND SICHERHEITSHINWEISE</li> </ul> </p>   | <p><a href="#">SCHWAIGER LWHDS 5530 Motorisierte TV-Deckenhalterung – Bedienungsanleitung</a></p> <p>Umfassende Bedienungs- und Sicherheitshinweise für die motorisierte TV-Deckenhalterung SCHWAIGER LWHDS 5530. Dieses Handbuch beschreibt die Installation, technische Daten, Fernbedienungsfunktionen und Fehlerbehebung für die sichere und effektive Nutzung des Produkts, geeignet für gerade und schräge Decken.</p> |
|  <p><b>CALED300 531</b><br/><b>SCHWAIGER</b></p> <p> <ul style="list-style-type: none"> <li>• KONTAKTIEREN SIE SICH MIT UNSEREM KUNDENSERVICE</li> <li>• VERSTÄNDLICHE ANLEITUNG UND SICHERHEITSHINWEISE</li> <li>• KONTAKTIEREN SIE SICH MIT UNSEREM KUNDENSERVICE</li> <li>• VERSTÄNDLICHE ANLEITUNG UND SICHERHEITSHINWEISE</li> <li>• KONTAKTIEREN SIE SICH MIT UNSEREM KUNDENSERVICE</li> <li>• VERSTÄNDLICHE ANLEITUNG UND SICHERHEITSHINWEISE</li> </ul> </p>   | <p><a href="#">Schwaiger CALED300 531 LED Campingleuchte mit Powerbank – Bedienungsanleitung</a></p> <p>Umfassende Bedienungsanleitung für die Schwaiger CALED300 531 2-in-1 LED-Campingleuchte mit integrierter Powerbank. Erfahren Sie mehr über Funktionen, Bedienung und Sicherheitshinweise.</p>  |
|  <p><b>Luftreiniger</b><br/>mit HEPA H13- und Aktivkohlefilter</p> <p><b>SCHWAIGER</b></p> <p> <ul style="list-style-type: none"> <li>• KONTAKTIEREN SIE SICH MIT UNSEREM KUNDENSERVICE</li> <li>• VERSTÄNDLICHE ANLEITUNG UND SICHERHEITSHINWEISE</li> <li>• KONTAKTIEREN SIE SICH MIT UNSEREM KUNDENSERVICE</li> <li>• VERSTÄNDLICHE ANLEITUNG UND SICHERHEITSHINWEISE</li> <li>• KONTAKTIEREN SIE SICH MIT UNSEREM KUNDENSERVICE</li> <li>• VERSTÄNDLICHE ANLEITUNG UND SICHERHEITSHINWEISE</li> </ul> </p>  | <p><a href="#">Schwaiger Luftreiniger 658002 Bedienungsanleitung und Sicherheitshinweise</a></p> <p>Umfassende Bedienungsanleitung und Sicherheitshinweise für den Schwaiger Luftreiniger Modell 658002 mit HEPA H13- und Aktivkohlefilter. Erfahren Sie mehr über Inbetriebnahme, Bedienung, Wartung und Fehlerbehebung.</p>  |
|  <p><b>STDL2415</b><br/><b>SCHWAIGER</b></p> <p> <ul style="list-style-type: none"> <li>• KONTAKTIEREN SIE SICH MIT UNSEREM KUNDENSERVICE</li> <li>• VERSTÄNDLICHE ANLEITUNG UND SICHERHEITSHINWEISE</li> <li>• KONTAKTIEREN SIE SICH MIT UNSEREM KUNDENSERVICE</li> <li>• VERSTÄNDLICHE ANLEITUNG UND SICHERHEITSHINWEISE</li> <li>• KONTAKTIEREN SIE SICH MIT UNSEREM KUNDENSERVICE</li> <li>• VERSTÄNDLICHE ANLEITUNG UND SICHERHEITSHINWEISE</li> </ul> </p>   | <p><a href="#">Schwaiger STDL2415 Power Strip with 2 USB Ports - User Guide and Safety Information</a></p> <p>Comprehensive user guide and safety instructions for the Schwaiger STDL2415 power strip, featuring 4 Euro sockets and 2 USB-A ports. Includes technical specifications, maintenance, and warranty details.</p>   |
|  <p><b>HANDBUCH</b><br/><b>GOOGLE HOME</b></p> <p><b>SCHWAIGER</b><br/><b>HOME4YOU</b></p> <p> <ul style="list-style-type: none"> <li>• KONTAKTIEREN SIE SICH MIT UNSEREM KUNDENSERVICE</li> <li>• VERSTÄNDLICHE ANLEITUNG UND SICHERHEITSHINWEISE</li> <li>• KONTAKTIEREN SIE SICH MIT UNSEREM KUNDENSERVICE</li> <li>• VERSTÄNDLICHE ANLEITUNG UND SICHERHEITSHINWEISE</li> <li>• KONTAKTIEREN SIE SICH MIT UNSEREM KUNDENSERVICE</li> <li>• VERSTÄNDLICHE ANLEITUNG UND SICHERHEITSHINWEISE</li> </ul> </p> | <p><a href="#">Schwaiger Google Home Setup Guide</a></p> <p>Learn how to set up and control your smart home devices using Google Home and Schwaiger's Home4You system with this comprehensive guide.</p>   |
|  <p><b>HA101</b><br/><b>SCHWAIGER</b><br/><b>HOME4YOU</b></p> <p><b>GOOGLE HOME</b></p> <p> <ul style="list-style-type: none"> <li>• KONTAKTIEREN SIE SICH MIT UNSEREM KUNDENSERVICE</li> <li>• VERSTÄNDLICHE ANLEITUNG UND SICHERHEITSHINWEISE</li> <li>• KONTAKTIEREN SIE SICH MIT UNSEREM KUNDENSERVICE</li> <li>• VERSTÄNDLICHE ANLEITUNG UND SICHERHEITSHINWEISE</li> <li>• KONTAKTIEREN SIE SICH MIT UNSEREM KUNDENSERVICE</li> <li>• VERSTÄNDLICHE ANLEITUNG UND SICHERHEITSHINWEISE</li> </ul> </p>    | <p><a href="#">Schwaiger HA101 Google Home Handbuch: Einrichtungs- und Integrationsanleitung</a></p> <p>Anleitung zur Einrichtung und Steuerung von Schwaiger Smart Home Geräten mit Google Home. Erfahren Sie, wie Sie Ihr Home4You Konto verknüpfen und Sprachbefehle nutzen.</p>  |

