

## Focal ICU165

# Focal ICU-165 Integration Series 6.5 Inch Coaxial Speakers User Manual

Model: ICU165

## 1. INTRODUCTION

Thank you for choosing Focal ICU-165 Integration Series 6.5 Inch Coaxial Speakers. These speakers are designed to deliver high-fidelity audio performance in your vehicle. This manual provides essential information for proper installation, operation, and maintenance to ensure optimal performance and longevity of your product.

## 2. SAFETY INSTRUCTIONS

Please read all safety instructions before installing or operating the speakers. Failure to follow these guidelines may result in injury or damage to the product or vehicle.

- Always disconnect the vehicle's battery before beginning any electrical work.
- Ensure all wiring is correctly connected and insulated to prevent short circuits.
- Do not install speakers in locations that obstruct vehicle operation or safety features.
- Use appropriate tools and protective gear during installation.
- Consult a professional installer if you are unsure about any part of the installation process.

## 3. PACKAGE CONTENTS

Verify that all components are present in the package:

- Focal ICU-165 6.5 Inch Coaxial Speakers (Pair)
- Mounting hardware (screws, clips)
- Speaker grilles (if included with specific models)
- Instruction Manual

If any items are missing or damaged, contact your authorized Focal dealer immediately.

## 4. SETUP AND INSTALLATION

Proper installation is crucial for optimal sound quality and speaker longevity. These speakers are designed for in-car audio systems.

### 4.1 Speaker Placement and Mounting

The ICU-165 speakers are 6.5 inches in diameter and require a mounting depth of approximately 48.40 mm (1.9 inches). Ensure the chosen location in your vehicle provides adequate space and does not interfere with window mechanisms or other components.



Figure 1: Focal ICU-165 Coaxial Speakers (Pair)

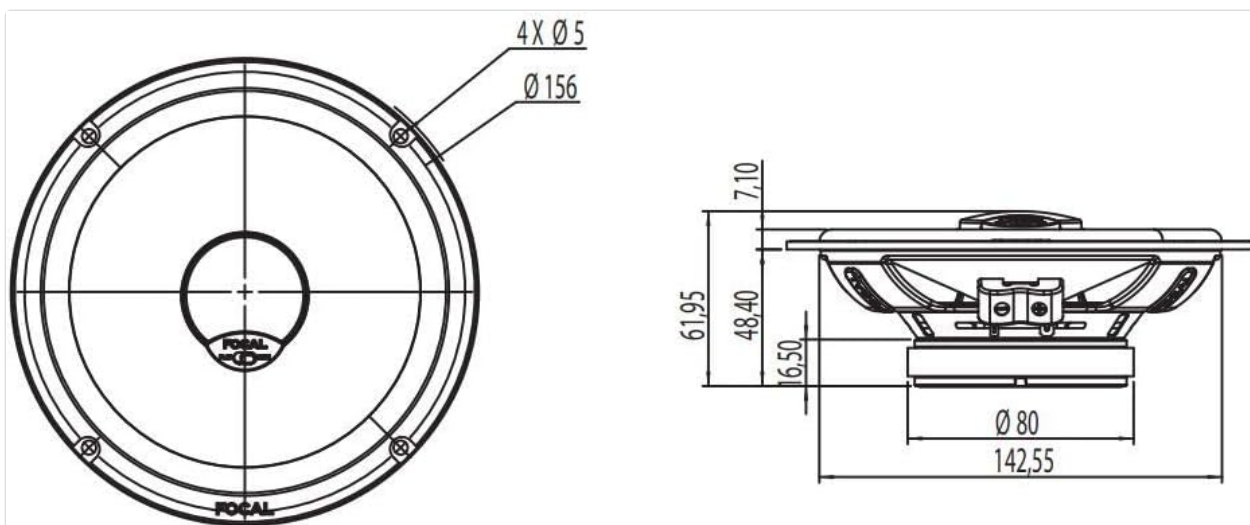

Figure 2: Technical drawing showing dimensions for Focal ICU-165 speakers.

### 4.2 Wiring Connections

Connect the speaker wires to your amplifier or head unit. Observe correct polarity: connect the positive (+) terminal of the speaker to the positive output of the amplifier, and the negative (-) terminal of the speaker to the negative output. Incorrect polarity can lead to poor sound quality and reduced bass response.

- **Positive Connection:** Typically marked with a red wire or a '+' symbol.
- **Negative Connection:** Typically marked with a black wire or a '-' symbol.

### 4.3 Tweeter Adjustment

The ICU-165 speakers feature an Al/Mg inverted dome tweeter with a switch for adjusting the high-frequency response. This switch allows you to select between 'FLAT' and 'HIGH' settings to optimize the sound based on your listening preference and vehicle acoustics.



Figure 3: Top view of the speaker, highlighting the tweeter and its 'FLAT' / 'HIGH' adjustment switch.

- **FLAT:** Provides a neutral high-frequency response.
- **HIGH:** Boosts high frequencies for a brighter sound.

Experiment with both settings to find the one that best suits your audio system and personal taste.

## 5. OPERATING INSTRUCTIONS

Once installed, operate your Focal ICU-165 speakers through your vehicle's head unit or amplifier. Start with low volume levels and gradually increase to your desired listening level. Avoid excessive volume that causes

distortion, as this can damage the speakers.

- Ensure your head unit's equalizer and sound settings are configured appropriately for coaxial speakers.
- For optimal performance, consider using a high-pass filter to protect the speakers from very low frequencies if you have a separate subwoofer.

## 6. MAINTENANCE

Focal ICU-165 speakers require minimal maintenance to ensure long-lasting performance.

- **Cleaning:** Use a soft, dry cloth to gently wipe dust from the speaker cones and grilles. Avoid using harsh chemicals or abrasive cleaners.
- **Inspection:** Periodically check speaker connections for tightness and ensure no wires are frayed or exposed.
- **Environmental Factors:** While the speakers have a water-resistant level, avoid direct exposure to excessive moisture or extreme temperatures.

## 7. TROUBLESHOOTING

If you experience issues with your Focal ICU-165 speakers, refer to the following common problems and solutions:

Problem	Possible Cause	Solution
No sound from speakers	Incorrect wiring, loose connections, amplifier off, head unit settings.	Check all wiring connections for proper polarity and tightness. Ensure amplifier is powered on and head unit output is enabled.
Distorted sound	Volume too high, incorrect gain settings on amplifier, damaged speaker.	Reduce volume. Adjust amplifier gain settings. If distortion persists at moderate volumes, inspect speakers for physical damage.
Lack of bass	Incorrect wiring polarity, phase issues, inadequate enclosure.	Verify speaker wire polarity. Ensure speakers are in phase. While these are coaxial, proper mounting in a sealed environment helps bass response.
Harsh or dull treble	Tweeter adjustment switch setting, equalizer settings.	Adjust the 'FLAT' / 'HIGH' switch on the tweeter. Modify equalizer settings on your head unit.

If the problem persists after attempting these solutions, contact your authorized Focal dealer or a qualified car audio technician.

## 8. SPECIFICATIONS

Detailed technical specifications for the Focal ICU-165 Integration Series 6.5 Inch Coaxial Speakers:

Feature	Specification
Model	ICU165







Feature	Specification
Speaker Type	Coaxial
Speaker Size	6.5 Inches (Woofer Diameter)
Nominal Power (RMS)	70 Watts
Maximum Power	140 Watts
Impedance	4 Ohm
Sensitivity (2.83V/1m)	93 dB
Frequency Response	60 Hz - 21 kHz
Tweeter	Al/Mg Inverted Dome
Mounting Depth	48.40 mm (1.9 inches)
Material	Plastic (frame/basket)
Water Resistance Level	Water Resistant
Connectivity Technology	Wired (Coaxial)
Audio Output Mode	Stereo
Item Weight	1.65 pounds (750 Grams)

## 9. WARRANTY AND SUPPORT

Focal ICU-165 speakers come with a Limited Warranty. For specific warranty terms and conditions, please refer to the warranty card included with your product or contact your authorized Focal dealer. Keep your purchase receipt as proof of purchase for warranty claims.

For technical support or service, please contact the dealer where you purchased the product. You can also visit the official Focal website for additional resources and contact information.



 <p>FLAX EVO™ PS 165 FE   PS 165 FSE   PS 165 FSE PS 165 FSE   PS 165 FSE   PS 165 FSE Manual d'installation / User Manual / Gebrauchsanleitung Manuale di installazione / Instrucciones de montaje / Инструкция по установке / 說明書 165 165 / 165 165 / 165 165</p> <p>FOCAL LISTEN BEYOND</p>	<p><a href="#">Focal FLAX EVO™ Car Speaker Systems: User Manual &amp; Specifications</a></p> <p>Explore the Focal FLAX EVO™ series car audio speakers with this comprehensive guide. It includes user manuals, installation instructions, safety guidelines, and detailed technical specifications for models like PS 165 FE, PS 165 FSE, and more. Learn about Focal's 'Listen Beyond' philosophy and product features.</p>
 <p>SLATEFIBER PC 165 SF   PS 165 SF</p> <p>Manual d'installation / User Manual / Gebrauchsanleitung Manuale di installazione / Instrucciones de montaje / Инструкция по установке / 說明書 165 165 / 165 165 / 165 165</p> <p>FOCAL</p>	<p><a href="#">Focal PC 165 SF   PS 165 SF User Manual and Specifications</a></p> <p>User manual and technical specifications for Focal PC 165 SF and PS 165 SF car speakers, featuring Slatefiber cones and high-efficiency design.</p>
 <p>K2 POWER ES 100 KE   EC 165 KE   ES 165 KE   ES 165 KE ES 165 KX2E   ES 165 KX3E   ES 165 KX3E SUB 25 KXE   SUB 30 KXE   SUB 25 KXE Dépannage rapide / Quick Start</p> <p>ADD TO THE FOCAL SYSTEM</p> <p>FOCAL</p>	<p><a href="#">Focal K2 Power Series Car Audio Speakers and Subwoofers: Quick Start &amp; User Manual</a></p> <p>Quick start guide and user manual for Focal K2 Power car audio speakers and subwoofers. Includes installation, wiring, adjustments, safety, and technical specifications for models like ES 100 KE, ES 165 KE, SUB 25 KXE, and more.</p>
 <p>K2 POWER ES 100 KE   EC 165 KE   ES 165 KE   ES 165 KE ES 165 KX2E   ES 165 KX3E   ES 165 KX3E SUB 25 KXE   SUB 30 KXE   SUB 25 KXE Dépannage rapide / Quick Start</p> <p>ADD TO THE FOCAL SYSTEM</p> <p>FOCAL</p>	<p><a href="#">Focal K2 Power Car Audio Speakers &amp; Subwoofers: User Manual and Specifications</a></p> <p>Comprehensive guide for Focal K2 Power car audio components, including ES 100 KE, ES 165 KE, ES 165 KX2E, ES 165 KX3E, ES 165 K2S, and subwoofers. Features installation, technical specs, and safety information.</p>
 <p>IS PSA 165 &amp; IC PSA 165</p> <p>Manual d'installation / User Manual / Gebrauchsanleitung Manuale di installazione / Instrucciones de montaje / Инструкция по установке / 說明書 165 165 / 165 165 / 165 165</p> <p>FOCAL</p>	<p><a href="#">Focal IS PSA 165 &amp; IC PSA 165 Car Speaker User Manual: Installation and Specifications</a></p> <p>Comprehensive user manual for Focal IS PSA 165 and IC PSA 165 car audio speakers. Includes detailed technical specifications, step-by-step installation guides for woofers and tweeters, warranty information, and responsible disposal instructions.</p>
 <p>K2 POWER ES 100 KE   EC 165 KE   ES 165 KE   ES 165 KE ES 165 KX2E   ES 165 KX3E   ES 165 KX3E SUB 25 KXE   SUB 30 KXE   SUB 25 KXE Dépannage rapide / Quick Start</p> <p>ADD TO THE FOCAL SYSTEM</p> <p>FOCAL</p>	<p><a href="#">Focal K2 Power Series: Installation and Adjustment Guide</a></p> <p>Comprehensive guide to installing and adjusting Focal K2 Power series speakers, including ES 100 KE, EC 165 KE, ES 165 KE, ES 165 K2E, ES 165 KX2E, ES 165 KX3E, ES 165 K2S, SUB 25 KXS, SUB 30 KXE, and SUB 25 KXE.</p>