

Manuals+

[Q & A](#) | [Deep Search](#) | [Upload](#)

manuals.plus /

- › [GROHE](#) /
- › [GROHE Red Fuse Technology Mixing Valve 40841001 User Manual](#)

GROHE 40841001



GROHE Red Fuse Technology Mixing Valve 40841001 User Manual

Model: 40841001

1. INTRODUCTION

This manual provides comprehensive instructions for the installation, operation, and maintenance of your GROHE Red Fuse Technology Mixing Valve, model 40841001. Please read this manual carefully before installation and use to ensure proper function and safety. Keep this manual for future reference.



Image 1.1: The GROHE Red Fuse Technology Mixing Valve. This image displays the brass-colored mixing valve with its various connection points and a black adjustment dial, indicating its robust construction and functional design.

2. SAFETY INFORMATION

- Installation must be performed by a qualified professional in accordance with local plumbing and building codes.
- Ensure the main water supply is turned off before beginning any installation or maintenance work.
- Wear appropriate personal protective equipment (PPE) during installation.
- Do not modify the product in any way, as this may void the warranty and create safety hazards.
- Protect the product from freezing temperatures.

3. PACKAGE CONTENTS

Verify that all components are present before beginning installation:

- GROHE Red Fuse Technology Mixing Valve (Model 40841001)
- Care Instructions

4. SETUP AND INSTALLATION

The GROHE Red Fuse Technology Mixing Valve is designed for wall mounting and integrates with the GROHE Red system, typically alongside a boiler and filter set. Refer to the exploded view for component identification and

assembly sequence.

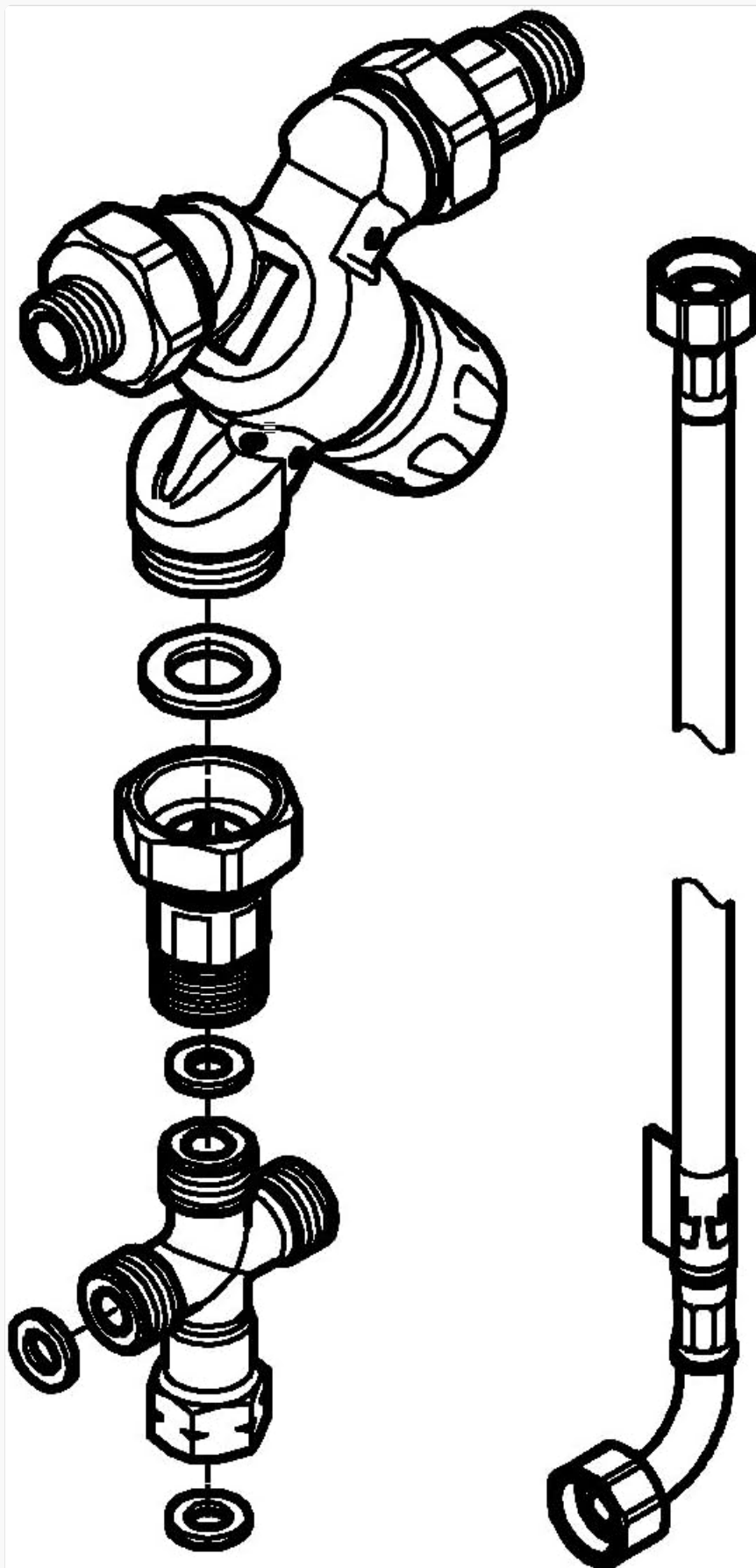

Image 4.1: Exploded view of the mixing valve and associated plumbing connections. This diagram illustrates the individual components of the mixing valve and how they connect, including seals and threaded fittings, crucial for correct assembly.

1. **Prepare the Installation Area:** Ensure the wall mounting location is clear and accessible. Turn off the main water supply.

2. **Connect Water Lines:** Connect the hot and cold water supply lines to the designated inlets on the mixing valve. Ensure all connections are secure and watertight using appropriate sealing materials.
3. **Integrate with GROHE Red System:** The mixing valve is an optional accessory for the GROHE Red Starter Kit. Connect it according to the specific instructions provided with your GROHE Red boiler (Size L or M) and filter set. The valve is essential for the ColdFill function.
4. **Secure Wall Mounting:** Mount the valve securely to the wall using appropriate fasteners.
5. **Check for Leaks:** Once all connections are made, slowly turn on the main water supply and carefully inspect all connections for any signs of leakage.



Image 4.2: Diagram illustrating the components of a GROHE Red Starter Kit. This image shows two boiler sizes (L and M), a filter set, and the GROHE Red Mixing Valve (model 40841001) as an optional accessory, demonstrating how these components integrate into a complete system.

5. OPERATING INSTRUCTIONS

The GROHE Red Fuse Technology Mixing Valve allows for precise control over the water temperature. The valve features a numbered dial (e.g., 1, 2, 3) for adjusting the mixing ratio of hot and cold water.

- **Temperature Adjustment:** Rotate the black adjustment dial to select the desired temperature setting. Higher numbers typically correspond to a greater proportion of hot water.
- **ColdFill Function:** This valve supports the ColdFill function, which allows for efficient use of the GROHE Red boiler by mixing cold water directly, reducing the need to heat all water.

6. MAINTENANCE

Regular maintenance ensures the longevity and optimal performance of your mixing valve.

- **Cleaning:** Clean the chrome finish with a soft cloth and mild soap. Avoid abrasive cleaners, scouring pads, or harsh chemicals, as these can damage the surface.
- **Inspection:** Periodically check all connections for leaks or signs of wear. Tighten any loose connections as needed.
- **Filter Replacement:** If used as part of a GROHE Red system with a filter, follow the filter replacement schedule outlined in the filter's instruction manual.

7. TROUBLESHOOTING

If you encounter issues with your mixing valve, refer to the following common problems and solutions:

Problem	Possible Cause	Solution
No water flow or reduced flow	Water supply turned off; clogged filter; debris in valve.	Check main water supply; replace filter if applicable; consult a professional for valve inspection.
Water temperature inconsistent	Incorrect dial setting; issues with hot/cold water supply pressure.	Adjust the mixing dial; check water pressure from both supplies.
Leaks at connections	Loose connections; worn seals.	Tighten connections; replace seals if necessary (consult a professional).

If problems persist, contact GROHE customer support or a qualified plumber.

8. SPECIFICATIONS

Feature	Detail
Brand	GROHE
Model Name	40841001
Part Number	40841001
Material	Metal
Finish Type	Chrome
Mounting Type	Wall mounting
Number of Handles	1 (adjustment dial)
Style	Mixing valve for ColdFill function
Item Weight	2.09 pounds (0.95 kg)
Product Dimensions	5.71 x 5.51 x 4.72 inches (14.5 x 14 x 12 cm)
Included Components	Mixing valve, care instructions
Recommended Uses	Riegel

9. WARRANTY INFORMATION

GROHE products are manufactured to the highest quality standards. For detailed warranty terms and conditions, please refer to the official GROHE website or the warranty card included with your product. Keep your proof of purchase for warranty claims.

10. SUPPORT

For technical assistance, spare parts, or further information, please visit the official GROHE website or contact their customer service department. Contact details can typically be found on the GROHE website or in the product packaging.

[Visit GROHE Official Website](#)



© 2023 GROHE. All rights reserved. Information subject to change without notice.

Related Documents - 40841001

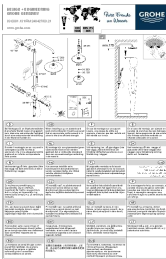
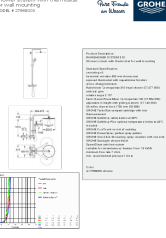
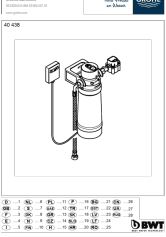
	<p>GROHE Essence Basin Mixer 1/2" S-Size - Brushed Nickel</p> <p>Detailed product information for the GROHE Essence Basin Mixer 1/2" S-Size in brushed nickel, including features, specifications, and spare parts.</p>
	<p>GROHE Euphoria 260 Shower System Installation Guide</p> <p>Official installation guide for the GROHE Euphoria 260 Shower System, featuring detailed instructions and safety information for mounting and use.</p>
	<p>GROHE Rainshower System 310 Thermostatic Shower System - Model 27968000</p> <p>Detailed specifications for the GROHE Rainshower System 310, a wall-mounted thermostatic shower system featuring a 450mm swivable shower arm, Rainshower Cosmopolitan 310 head shower, Power&Soul Cosmopolitan 130 hand shower, and GROHE CoolTouch technology. Includes information on temperature control, spray patterns, and installation requirements.</p>
	<p>GROHE Blue Filter Set Installation and Maintenance Guide</p> <p>Official installation and maintenance guide for the GROHE Blue Filter Set (Model 40 438), designed for GROHE Red hot water systems. Includes technical specifications, installation steps, filter replacement, and troubleshooting.</p>

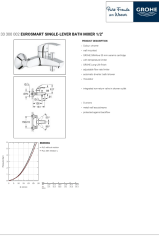
	<p>GROHE Start Single-Lever Basin Mixer 1/2" S-Size (32 559 002) - Technical Overview and Spare Parts</p> <p>Comprehensive details and spare parts list for the GROHE Start Single-Lever Basin Mixer, 1/2" S-Size, model 32 559 002. Features include GROHE SilkMove, Long-Life finish, and GROHE Water Saving technology for efficient water use.</p>
	<p>GROHE Eurosmart Single-Lever Bath Mixer 1/2" - Product Information and Spare Parts</p> <p>Detailed product information and spare parts list for the GROHE Eurosmart Single-Lever Bath Mixer 1/2". Features include chrome finish, wall mounting, GROHE SilkMove ceramic cartridge, temperature limiter, adjustable flow rate, and automatic diverter.</p>