

## GROHE 30320000

# GROHE Red 30320000 II Kitchen Sink Tap with Medium Size Boiler User Manual

Model: 30320000

## 1. INTRODUCTION

---

This manual provides essential information for the installation, operation, and maintenance of your GROHE Red 30320000 II Kitchen Sink Tap with Medium Size Boiler. This system delivers filtered, chilled, and boiling hot water directly from your kitchen tap. Please read these instructions carefully before installation and use to ensure safe and efficient operation.

## 2. SAFETY INFORMATION

---

**WARNING: Failure to follow these safety instructions could result in fire, electric shock, personal injury, or property damage.**

- Always disconnect power before performing any maintenance or installation.
- Installation must be performed by a qualified professional in accordance with local plumbing and electrical codes.
- The boiler contains boiling hot water. Exercise extreme caution when dispensing hot water.
- Ensure the child lock feature for boiling water is understood and used correctly, especially in households with children.
- Do not operate the system if any part is damaged or malfunctioning.
- Only use genuine GROHE replacement parts and filters.

## 3. PACKAGE CONTENTS

---

Verify that all components are present and undamaged before beginning installation:

- GROHE Red Single-Handle Kitchen Sink Tap (C Spout)
- GROHE Red Medium Size Boiler
- GROHE Blue S-Size Filter

- Connection Hoses and Fittings
- Installation Hardware



Image 1: Overview of the GROHE Red kitchen tap system, showing the C-spout faucet, the medium-sized boiler unit, and the water filter cartridge.

## 4. SETUP AND INSTALLATION

---

Installation of the GROHE Red system requires plumbing and electrical connections. It is strongly recommended that installation be carried out by a certified professional.

### 4.1 Pre-Installation Checks

- Ensure adequate space under the sink for the boiler and filter unit. Refer to the dimensions provided in the specifications.
- Verify that suitable water supply lines (hot and cold) and an electrical outlet are available.
- The countertop opening for the faucet should be compatible with the faucet's base diameter (Ø34mm).

### 4.2 Installation Steps (Summary)

1. Mount the faucet onto the sink or countertop.
2. Connect the hot and cold water supply lines to the faucet.
3. Install the GROHE Blue filter unit in an accessible location.
4. Connect the filter unit to the water supply and the boiler.
5. Position the medium-sized boiler unit securely under the sink.
6. Connect the boiler to the faucet and the filtered water supply.
7. Plug the boiler into a grounded electrical outlet.
8. Flush the system thoroughly before first use.

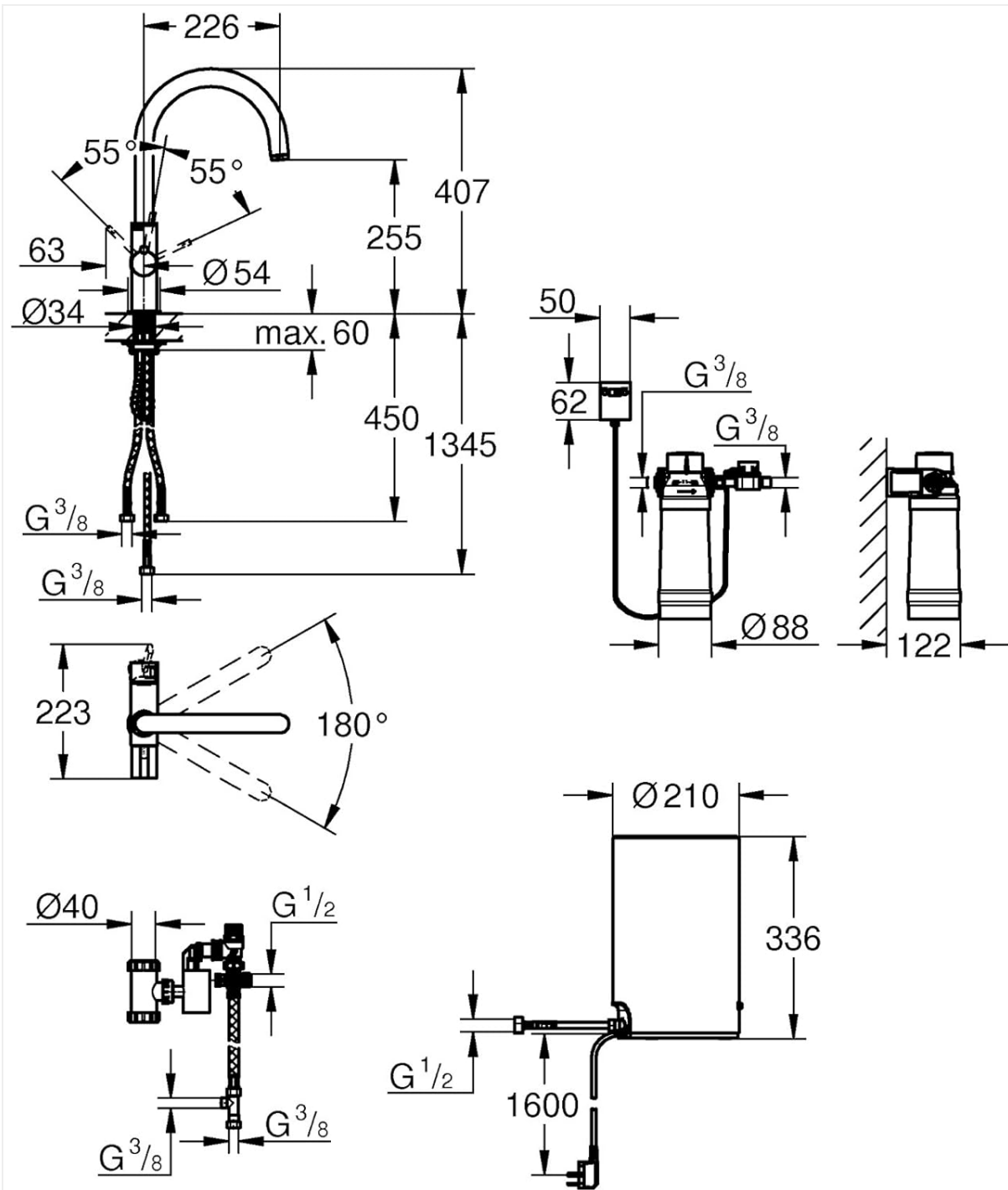

Image 2: Technical drawing illustrating the dimensions and connection points for the GROHE Red faucet, filter, and boiler components. This diagram provides critical measurements for installation planning.

## 5. OPERATING INSTRUCTIONS

### 5.1 Dispensing Hot and Cold Water

The single-handle lever controls the flow and temperature of regular hot and cold water. Move the lever to the left for hot water and to the right for cold water. Adjust the lever position to achieve the desired temperature and flow rate.

### 5.2 Dispensing Boiling Water (Child Lock)

The GROHE Red system features a child lock for safe dispensing of boiling water. To dispense boiling water:

1. Activate the child lock mechanism (refer to the specific instructions provided with your faucet for

exact operation, typically a push-and-turn or pull-and-hold action on a dedicated control).

2. Once activated, boiling water will flow from the C-spout.
3. Release the control to stop the flow of boiling water.

*The GROHE CoolTouch® technology ensures the faucet body remains cool to the touch, even when dispensing boiling water, enhancing safety.*

## 6. MAINTENANCE

---

### 6.1 Cleaning the Faucet

The GROHE StarLight® chrome finish is durable and easy to clean. Use only mild soap and water with a soft cloth. Avoid abrasive cleaners, scouring pads, or chemical solvents, as these can damage the finish.

### 6.2 Filter Replacement

The GROHE Blue filter cartridge requires regular replacement to maintain water quality and system performance. The frequency of replacement depends on water hardness and usage. Refer to the filter's specific instructions for replacement procedures and indicators.

### 6.3 Descaling the Boiler

Depending on water hardness, the boiler may require periodic descaling. Consult a qualified service technician for descaling procedures to avoid damaging the unit.

## 7. TROUBLESHOOTING

---

Before contacting customer support, review the following common issues and solutions:

- **No Boiling Water:**
  - Check if the boiler is plugged in and receiving power.
  - Ensure the child lock mechanism is correctly activated.
  - Verify that the boiler's indicator lights are functioning as expected.
  - Check water supply to the boiler.
- **Reduced Water Flow:**
  - Check for kinks in the water supply lines.
  - The filter cartridge may be clogged and require replacement.
  - Aerator on the faucet may be blocked by debris.
- **Leaking:**
  - Tighten all connections, ensuring not to overtighten.
  - Inspect O-rings and seals for damage.
  - If leaks persist, contact a professional plumber.

For issues not listed here or if troubleshooting steps do not resolve the problem, please contact GROHE customer support.

## 8. SPECIFICATIONS

---



Feature	Detail
Model Number	30320000
Brand	GROHE
Item Weight	26.7 pounds
Product Dimensions	23.62 x 15.75 x 25.39 inches (overall package)
Color	Chrome
Finish	Polished
Installation Method	Single Hole Deck Mount
Number of Handles	1
Included Components	Boiler, Kitchen Sink Tap
Special Features	GROHE CoolTouch®, GROHE StarLight®, GROHE SilkMove®





## 9. WARRANTY AND SUPPORT

For detailed warranty information, please refer to the warranty card included with your product or visit the official GROHE website. For technical assistance, spare parts, or service inquiries, please contact GROHE customer support directly. Keep your proof of purchase for warranty claims.

You can find more information and support on the official GROHE website: [www.grohe.com](http://www.grohe.com)

### Related Documents - 30320000

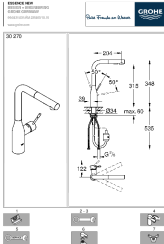
	<p><a href="#">GROHE Start Single-Lever Basin Mixer 1/2" S-Size (32 559 002) - Technical Overview and Spare Parts</a></p> <p>Comprehensive details and spare parts list for the GROHE Start Single-Lever Basin Mixer, 1/2" S-Size, model 32 559 002. Features include GROHE SilkMove, Long-Life finish, and GROHE Water Saving technology for efficient water use.</p>
	<p><a href="#">GROHE Eurosmart Cosmopolitan Basin Mixer 1/2" S-Size (23 925 000) - Product Overview</a></p> <p>Detailed product overview and spare parts list for the GROHE Eurosmart Cosmopolitan Basin Mixer 1/2" S-Size, model 23 925 000. Features include chrome finish, SilkMove cartridge, flow rate limiter, and FastFixation system.</p>

 <p>23 051 002 GROHE EURODISC COSMOPOLITAN XS-SIZE STANDVENTIL</p> <p>Technical drawing showing the product and its dimensions.</p>	<p><a href="#">GROHE Eurodisc Cosmopolitan XS-Size Standventil (23 051 002) - Technical Specifications and Parts</a></p> <p>Detailed technical specifications, product description, and spare parts list for the GROHE Eurodisc Cosmopolitan XS-Size Standventil (model 23 051 002), including dimensions and flow rate data.</p>
 <p>Technical drawing showing the product and its dimensions.</p>	<p><a href="#">GROHE QuickFix Kitchen Mixer Tap Installation Guide</a></p> <p>Comprehensive installation guide for the GROHE QuickFix kitchen mixer tap, covering safety, technical specifications, and step-by-step assembly with multilingual support.</p>
 <p>30 270</p> <p>Technical drawing showing the product and its dimensions.</p>	<p><a href="#">GROHE Essence New 30 270 Kitchen Mixer Tap Installation Guide</a></p> <p>Comprehensive installation guide and technical specifications for the GROHE Essence New kitchen mixer tap (model 30 270). Features dimensions, parts list, step-by-step installation instructions, and contact information.</p>
 <p>21 001 001 GROHE BLUE PROFESSIONAL C-SPOUT KIT</p> <p>Technical drawing showing the product and its dimensions.</p>	<p><a href="#">GROHE Blue Professional C-Spout Kit Spare Parts List</a></p> <p>Official spare parts list for the GROHE Blue Professional C-Spout Kit, valid from September 2021. Includes part numbers for components like filters, cartridges, CO2 adapters, and accessories.</p>