

Ledlenser P7

Ledlenser P7 LED Flashlight User Manual

Model: P7 | Part Number: 501046

1. INTRODUCTION

The Ledlenser P7 is a high-quality LED flashlight designed for versatile everyday use. It incorporates the Ledlenser Advanced Focus System, enabling a seamless transition between a wide flood beam for close-up illumination and a sharply focused long-distance beam. This manual provides essential information for the safe and effective operation, maintenance, and troubleshooting of your P7 flashlight.



Image 1.1: The Ledlenser P7 LED Flashlight, showcasing its sleek black aluminum casing.

2. WHAT'S IN THE BOX

Please verify that all the following items are included in your package:

- 1 x Ledlenser P7 Pro Torch (Black)
- 1 x Belt Pouch
- 1 x Wrist Strap
- 4 x AAA Duracell Batteries

3. SETUP

3.1 Battery Installation

1. Unscrew the tail cap of the flashlight by turning it counter-clockwise.
2. Insert four (4) AAA batteries into the battery compartment, ensuring correct polarity (+/-) as indicated inside

the flashlight.

3. Screw the tail cap back on clockwise until it is securely tightened.

3.2 Initial Check

After installing the batteries, press the end cap switch to turn on the flashlight. Verify that the LED illuminates. If not, check battery orientation and ensure the tail cap is fully tightened.

4. OPERATING INSTRUCTIONS

4.1 Power On/Off

To turn the flashlight on or off, firmly press the end cap switch located at the rear of the flashlight.

4.2 Light Modes

The Ledlenser P7 features three distinct light modes:

- **Power Mode:** Standard bright illumination.
- **Low Power Mode:** Reduced brightness for extended battery life.
- **Boost Mode:** Maximum brightness for a short duration.

To cycle through these modes, lightly press the end cap switch repeatedly while the flashlight is on. A full click will turn the flashlight off.

4.3 Advanced Focus System

The P7 utilizes an Advanced Focus System for adjustable beam control:

- To achieve a wide, homogeneous flood beam for close-range illumination, push the flashlight head forward.
- To achieve a sharply bundled, long-distance spot beam, pull the flashlight head backward.



Image 4.1: Demonstrating the wide beam of the Ledlenser P7 flashlight during outdoor use.

5. MAINTENANCE

5.1 Cleaning

Wipe the flashlight's exterior with a soft, damp cloth. Do not use abrasive cleaners or solvents. Ensure the lens is clean for optimal light output.

5.2 Battery Care

- Replace depleted batteries promptly to maintain performance.
- If the flashlight will not be used for an extended period, remove the batteries to prevent leakage and potential damage.
- Always use high-quality AAA alkaline batteries.

6. TROUBLESHOOTING

Problem	Possible Cause	Solution
Flashlight does not turn on.	Batteries are depleted or incorrectly inserted. Tail cap is loose.	Replace batteries or ensure correct polarity. Tighten the tail cap securely.
Light output is dim.	Batteries are low. Lens is dirty.	Replace batteries. Clean the lens with a soft cloth.

Problem	Possible Cause	Solution
Focus mechanism is stiff.	Dirt or debris in the focusing mechanism.	Gently clean the area around the flashlight head. Avoid forcing the mechanism.

7. SPECIFICATIONS

Feature	Detail
Model	P7
Part Number	501046
Light Source	LED
Max Luminosity	450 Lumens
Max Lighting Range	300 meters (984 feet)
Battery Type	4 x AAA Alkaline (included)
Max Battery Duration	25 hours
Water Resistance	IP54 (Protection against dust and splashing water)
Material	Aluminum
Dimensions (L x D)	130 mm (5.12 in) x 37 mm (1.46 in)
Weight (with batteries)	175 grams (6.2 oz)
Special Features	Advanced Focus System with Rapid Focus, 3 Light Modes (Power, Low Power, Boost)



Image 7.1: The Ledlenser P7 flashlight shown with its approximate length of 5.4 inches (13 cm).

8. WARRANTY AND SUPPORT

8.1 Warranty Information



The Ledlenser P7 flashlight comes with a full manufacturer's warranty. Please refer to the warranty card included in your product packaging for specific terms and conditions, or visit the official Ledlenser website for detailed information.

8.2 Customer Support

For technical assistance, spare parts, or any inquiries regarding your Ledlenser P7 flashlight, please visit the official Ledlenser website or contact their customer service department. You can find more information and products at the [Ledlenser Store](#).

© 2024 Ledlenser. All rights reserved.

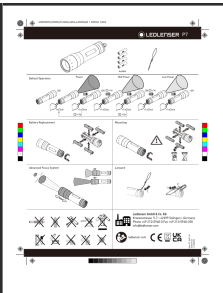
Related Documents - P7

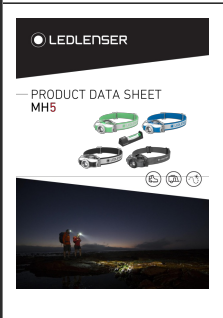
	<p>LEDLENSER P7 Flashlight User Manual and Operating Guide</p> <p>Comprehensive guide to the LEDLENSER P7 flashlight, covering default operation, battery replacement, advanced focus system, lanyard attachment, and recycling information.</p>
	<p>Ledlenser X21.2 High-Power Torch User Manual</p> <p>Comprehensive user manual for the Ledlenser X21.2 high-power torch, covering operation, features like Smart Light Technology, battery replacement, safety instructions, and specifications.</p>
	<p>Ledlenser MH5 Rechargeable Headlamp: Technical Data, Features, and Specifications</p> <p>Comprehensive product data sheet for the Ledlenser MH5 rechargeable headlamp, detailing its technical specifications, light performance, power options, packaging information, and warranty. Features include Advanced Focusing Optics, IP54 rating, and versatile usage modes.</p>

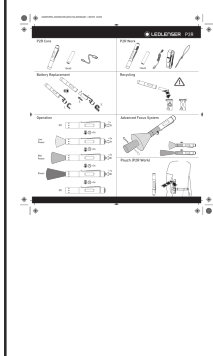

[Ledlenser P2R Core and P2R Work Flashlight User Guide](#)

Comprehensive user manual for Ledlenser P2R Core and P2R Work rechargeable flashlights, detailing operation, battery management, charging systems, and advanced features.

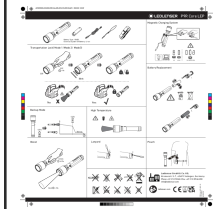

[Ledlenser P9R Core LEP Quick User Guide](#)

Concise guide to operating the Ledlenser P9R Core LEP flashlight, covering features like magnetic charging, transportation lock, backup mode, and various lighting modes.

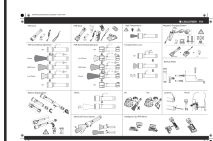

[Ledlenser P5R Core and P5R Work Flashlight User Guide](#)

Comprehensive guide to operating and customizing the Ledlenser P5R Core and P5R Work LED flashlights, covering basic functions, battery replacement, advanced features, and light mode customization.