

## Nobsound NS-03G

# Nobsound NS-03G 100W Full Frequency Mono Channel Digital Power Amplifier User Manual

Model: NS-03G

## 1. INTRODUCTION

This manual provides essential information for the proper setup, operation, and maintenance of your Nobsound NS-03G 100W Full Frequency Mono Channel Digital Power Amplifier. Please read this manual thoroughly before using the product to ensure optimal performance and safety.



Figure 1.1: Front view of the Nobsound NS-03G amplifier, showcasing its compact design and volume knob.

## 2. PRODUCT OVERVIEW

## Key Features

- Designed as a mono channel power amplifier specifically for a single passive speaker. It is not compatible with active or powered speakers.
- Incorporates the TPA3116D2 chip, capable of delivering up to 100W of power. Features a smooth volume control knob for precise audio adjustment.
- Compact size and robust aluminum casing allow for easy placement on desktops or near speakers.
- Equipped with a 3.5mm AUX input for connecting various audio sources such as smartphones, CD players, and televisions.
- Requires an external power supply (not included). A 12V to 24V DC power supply with at least 4A is recommended for optimal performance.



**Figure 2.1:** Illustration highlighting the TPA3116D2 chip, central to the amplifier's 100W output capability.



# Reasonable circuit

Concise wiring layout and perfect protection, no sparks no shock.

Adopting NE5532 op amp with ultra-low distortion, the sound is very smooth and natural, powerful in low frequency and delicate in high frequency, full of music styles.



**Figure 2.2:** The amplifier's internal circuit, featuring the NE5532 op amp for sound processing.

# Mini size with exquisite appearance

Aluminum alloy black case looks fashionable and attractive. With strong output power and high-quality sound, especially designed for the customers who pursue HiFi sound.



**Figure 2.3:** Demonstrates the compact and aesthetically pleasing design of the NS-03G amplifier.

## What's in the Box

- 1 x Nobsound NS-03G Mono Channel Amplifier

*Note: A power adapter is not included and must be purchased separately.*

# PACKING LIST

Net Weight: 226g/0.50lb

Package Weight: 400g/0.88lb

(Power Adapter Not Included)



1 × NS-03G FR Amplifier

Figure 2.4: Packaging contents and physical dimensions of the amplifier.

## 3. SAFETY INFORMATION

- Ensure the power supply voltage matches the amplifier's requirements (DC 8-25V). Using an incorrect voltage can damage the device.
- Do not expose the amplifier to water, moisture, or extreme temperatures.
- Avoid placing the amplifier in direct sunlight or near heat sources.
- Do not open the amplifier casing. Refer all servicing to qualified personnel.
- Keep out of reach of children.
- Ensure proper ventilation around the unit to prevent overheating.

## 4. SETUP

Follow these steps to set up your Nobsound NS-03G amplifier:

1. **Connect the Speaker:** Use banana plugs to connect your passive speaker to the amplifier's output terminals. Ensure correct polarity (+ to + and - to -). This amplifier is designed for a single mono passive speaker.
2. **Connect the Audio Source:** Plug your audio source (e.g., smartphone, CD player, TV) into the 3.5mm



AUX input on the rear of the amplifier using a 3.5mm audio cable.

3. **Connect the Power Supply:** Connect a compatible DC power supply (8-25V, at least 3A; 12-24V, at least 4A recommended) to the DC IN port on the rear of the amplifier. The power supply is not included.



## With 3.5mm AUX audio input

Perfectly compatible with many audio devices such as phone, TV, MP3, CD players, computers, DAC etc.. With built-in preamplification circuit, can match well with the audio sources that with low signal output.

**Figure 4.1:** Rear panel connections, including 3.5mm AUX input and speaker output terminals.

# Full Frequency Mono Channel Version

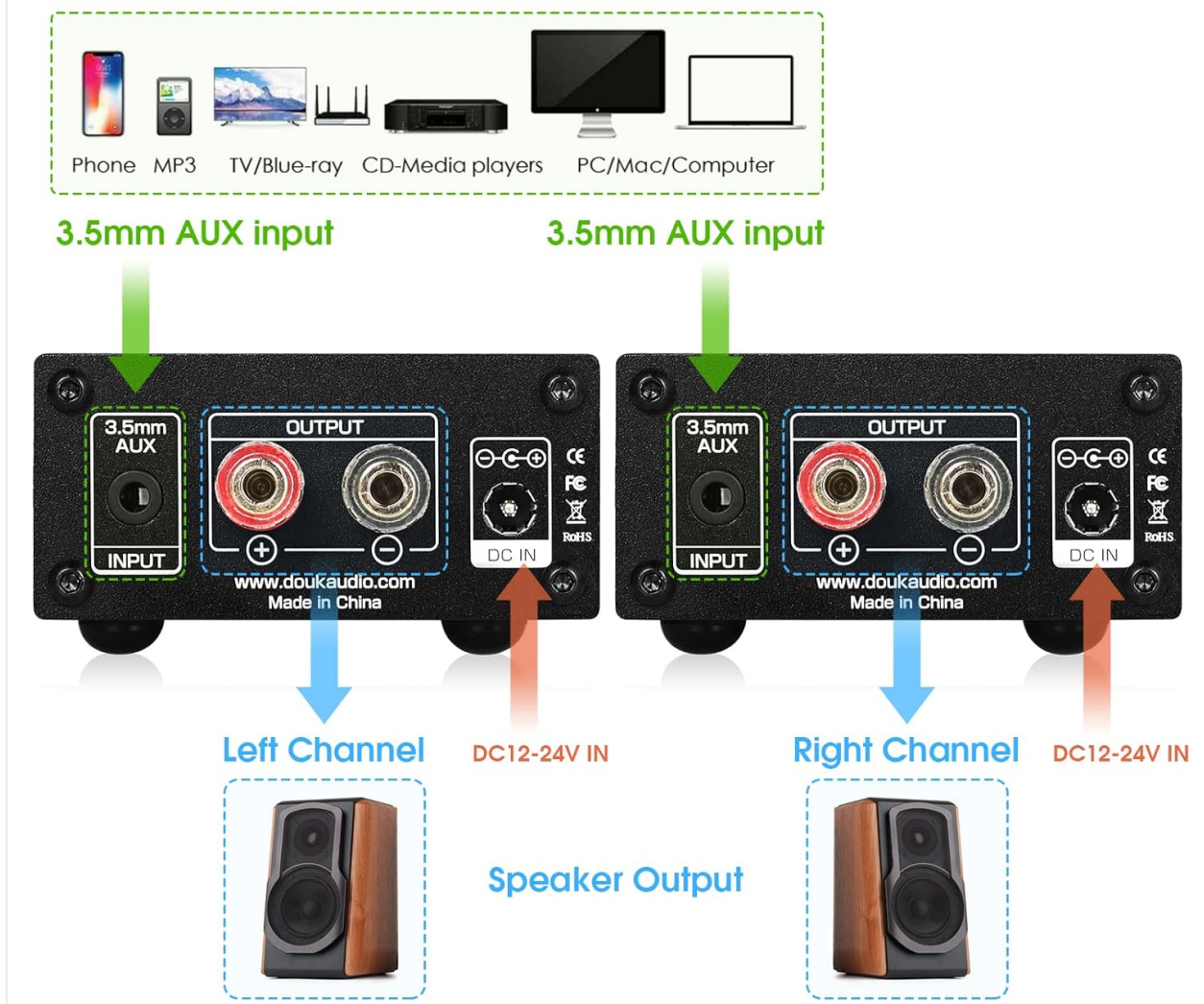

Figure 4.2: Diagram illustrating the connection process for audio input, power, and speaker output.

## 5. OPERATING INSTRUCTIONS

Once all connections are made, operate the amplifier as follows:

1. **Power On/Off and Volume Control:** The large knob on the front panel serves as both the power switch and volume control. Rotate it clockwise to turn on the amplifier and increase the volume. Rotate counter-clockwise to decrease volume and turn off the amplifier.
2. **Power Indicator:** A red LED light on the front panel indicates that the amplifier is powered on.
3. **Adjusting Volume:** Start with the volume knob at its minimum position before playing audio. Gradually increase the volume to a comfortable listening level.





Figure 5.1: Front panel controls, including the power indicator and combined power/volume knob.

## 6. SPECIFICATIONS

Parameter	Value
Audio Input	3.5mm AUX
Audio Output	Banana plug
Power Supply	DC 8-25V; at least 3A (Recommended: 12-24V, at least 4A)
Maximum Power	100W @ 4 ohm
Chipset	TPA3116D2 + NE5532
Signal-to-Noise Ratio (SNR)	≥98dB
Total Harmonic Distortion (THD)	≤0.04%
Terminating Impedance	2~8 ohm
Frequency Range	20~200Hz
Input Sensitivity	≤280mV
Dimensions (L*W*H)	68.5 * 33 * 90 mm (not including terminals)
Weight (without package)	0.2 Kg (0.44 lbs)
Material	Aluminum
Item Model Number	5228680963



Parameter	Value
-----------	-------

## 7. TROUBLESHOOTING

If you encounter issues with your amplifier, refer to the following common problems and solutions:

- **No Sound:**

- Ensure the power supply is correctly connected and the power indicator light is on.
- Verify that the volume knob is turned up.
- Check all audio input and speaker output connections for secure fit and correct polarity.
- Confirm that your audio source is playing and its volume is adequately set.
- Ensure you are using a passive speaker, as this amplifier is not compatible with active/powered speakers.

- **Distorted Sound:**

- Reduce the volume on both the amplifier and your audio source. Distortion can occur if the input signal or output volume is too high.
- Check speaker impedance. Ensure it is within the recommended 2-8 ohm range.
- Verify the power supply meets the recommended specifications (12-24V, at least 4A). An insufficient power supply can lead to distortion at higher volumes.

- **Hissing or Background Noise:**

- Ensure all cables are properly shielded and securely connected.
- Try using a different audio source or cable to rule out external interference.
- Ensure the power supply is of good quality, as some power supplies can introduce noise.

- **Amplifier Overheating:**

- Ensure the amplifier has adequate ventilation and is not covered.
- Reduce the volume or operating time if the unit becomes excessively hot.

## 8. MAINTENANCE

To ensure the longevity and optimal performance of your Nobsound NS-03G amplifier, follow these maintenance guidelines:







- **Cleaning:** Use a soft, dry cloth to clean the exterior of the amplifier. Do not use liquid cleaners, aerosols, or solvents.
- **Storage:** When not in use for extended periods, store the amplifier in a cool, dry place away from direct sunlight and moisture.
- **Ventilation:** Always ensure that the ventilation openings are clear and unobstructed during operation.

## 9. WARRANTY AND SUPPORT

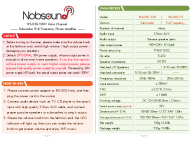
For warranty information and customer support, please refer to the documentation provided at the time of

purchase or visit the official Nobsound website. Specific warranty terms may vary by region and retailer. For additional products and support, you may visit the [Nobsound Store on Amazon](#).

## Related Documents - NS-03G

	<p><a href="#">Nobsound NS-03G 100W Mono Channel Amplifier: User Guide and Specifications</a></p> <p>Comprehensive guide for the Nobsound NS-03G 100W Mono Channel Subwoofer and Full Frequency Power Amplifier, including setup instructions, technical parameters, and troubleshooting tips.</p>
	<p><a href="#">Nobsound G2 and G2 PRO Amplifier Manual</a></p> <p>User manual for Nobsound G2 and G2 PRO Hi-Fi audio amplifiers, detailing front and back panel connections and features.</p>
	<p><a href="#">Nobsound HiFi 5.1 Channel Bluetooth Amplifier User Manual</a></p> <p>This user manual provides instructions and troubleshooting tips for the Nobsound HiFi 5.1 Channel Bluetooth Amplifier, covering setup, operation, and common issues.</p>
	<p><a href="#">Nobsound NS-13G/NS-15G/NS-15G PRO Digital Amplifier User Manual and Specifications</a></p> <p>Detailed user manual and technical specifications for Nobsound NS-13G, NS-15G, and NS-15G PRO digital HiFi stereo audio amplifiers. Includes setup, operation, troubleshooting tips, and contact information.</p>
	<p><a href="#">Nobsound NS-01G PRO, NS-10G, NS-10G PRO, NS-20G Mini Bluetooth Amplifier User Manual</a></p> <p>Comprehensive user manual for Nobsound NS-01G PRO, NS-10G, NS-10G PRO, and NS-20G mini Bluetooth digital amplifiers. Learn about features, setup, operation, troubleshooting, and specifications.</p>
	<p><a href="#">Nobsound NS-08E &amp; NS-10P: Vacuum Tube Headphone Amplifier &amp; Preamp User Guide</a></p> <p>Detailed guide for Nobsound NS-08E vacuum tube headphone amplifier and NS-10P tube preamp, covering features, operation, specifications, and troubleshooting. Supports various tube replacements and HiFi audio.</p>