

American Lighting LS2-M-24-48-BK

American Lighting LS2-M-24-48-BK Commercial Grade Light String Instruction Manual

Model: LS2-M-24-48-BK

1. INTRODUCTION

The American Lighting LS2-M-24-48-BK is a 48-foot commercial grade light string designed for both indoor and outdoor applications. It features 25 medium base sockets, factory-molded onto a durable 14-gauge wire, ensuring suitability for various commercial and residential settings. The formulated PVC sockets create a tight, weatherproof seal around bulbs, enhancing durability and safety. This light string is ideal for adding ambient lighting to patios, building outlines, tents, and gazebos.

2. SAFETY INFORMATION

Please read all safety instructions carefully before installation and use. Failure to follow these instructions may result in electric shock, fire, or other hazards.

- **Electrical Safety:** Ensure the power source is disconnected before installation, maintenance, or bulb replacement. Use only bulbs rated for 120 Volts and a maximum of 25 Watts per socket. Do not exceed the total wattage capacity of the string.
- **Installation:** Mount the light string securely to prevent damage from wind or other environmental factors. Do not use staples or nails to secure the wiring, as this can damage insulation.
- **Weather Resistance:** While the sockets are designed to be weatherproof, ensure all connections are tight and bulbs are properly seated to maintain water resistance. Avoid submerging the string in water.
- **Damage Inspection:** Regularly inspect the light string for any signs of damage to the wire, sockets, or plug. Do not use if damaged.
- **Proposition 65 Warning:** This product may contain chemicals known to the State of California to cause cancer and birth defects or other reproductive harm. Wash hands after handling.

3. PACKAGE CONTENTS

Verify that all components are present before beginning installation:

- 1 x American Lighting LS2-M-24-48-BK 48-Foot Commercial Grade Light String (with 25 medium base

sockets)

- (Bulbs are typically sold separately and are not included)

4. SETUP AND INSTALLATION

Follow these steps for proper installation of your light string:

1. **Plan Placement:** Determine the desired location for your light string. Ensure the length of the string (48 feet) is suitable for the area. Consider the proximity to a power outlet.
2. **Secure Mounting:** Use appropriate hardware (e.g., guide wires, hooks, zip ties) to securely mount the light string. The string features integrated mounting holes near each socket for easy attachment. Avoid hanging the string by its electrical cord alone.
3. **Install Bulbs:** With the light string unplugged, carefully screw medium base bulbs (E26/E27) into each socket. Ensure bulbs are rated for 120V and do not exceed 25W per bulb. Hand-tighten until snug to create a weatherproof seal.
4. **Connect to Power:** Once all bulbs are installed and the string is securely mounted, plug the light string into a standard 120V AC outlet.



Figure 1: The American Lighting LS2-M-24-48-BK Commercial Grade Light String, shown coiled. This image illustrates the overall appearance of the 48-foot string with its 25 medium base sockets.



Figure 2: A close-up view of a single medium base socket on the light string. This detail highlights the robust, factory-molded PVC construction designed for a weatherproof seal.

5. OPERATING INSTRUCTIONS

Operating the American Lighting LS2-M-24-48-BK light string is straightforward:

- **Power On/Off:** Plug the light string into a power outlet to turn it on. Unplug it to turn it off.
- **Control Method:** While the product specifications mention "App" as a control method, specific details for app integration are not provided with this model. If you intend to use app control, ensure you have compatible smart plugs or controllers that can integrate with a standard corded electric light string.

6. MAINTENANCE

Regular maintenance helps prolong the life and performance of your light string:

- **Cleaning:** Periodically wipe down the light string and sockets with a damp cloth. Ensure the string is unplugged before cleaning. Do not use harsh chemicals or abrasive cleaners.
- **Bulb Replacement:** If a bulb burns out, unplug the light string before attempting to replace it. Carefully unscrew the old bulb and screw in a new medium base (E26/E27) bulb, ensuring it is 120V and does not exceed 25W.
- **Storage:** If storing the light string for an extended period, clean it thoroughly, coil it neatly, and store it in a cool, dry place away from direct sunlight and extreme temperatures.

7. TROUBLESHOOTING

Here are some common issues and their potential solutions:

Problem	Possible Cause	Solution
Lights do not turn on.	No power to the outlet, loose plug, faulty bulb(s), damaged string.	Check the power outlet with another device. Ensure the plug is fully inserted. Inspect all bulbs and replace any burnt-out ones. Check the entire string for visible damage.
Some lights are out.	Burnt-out bulb(s), loose bulb(s).	Unplug the string and carefully check each bulb. Replace any burnt-out bulbs and ensure all bulbs are securely tightened.
Flickering lights.	Loose bulb connection, unstable power supply.	Unplug the string and tighten all bulbs. Ensure the power outlet is stable.

8. SPECIFICATIONS

Detailed technical specifications for the American Lighting LS2-M-24-48-BK:

Model Number: LS2-M-24-48-BK

Length: 48 Feet

Number of Sockets: 25

Socket Type: Medium Base (E26/E27)

Wire Gauge: 14-gauge
Input Voltage: 120 Volts AC
Max Wattage per Socket: 25 Watts
Total Max Wattage: 625 Watts (25 sockets x 25W)
Indoor/Outdoor Usage: Indoor, Outdoor
Special Features: Waterproof (sockets), Commercial Grade
Material: Polyvinyl Chloride (PVC)
Color: Black
Product Dimensions: 18 x 12 x 6 inches (packaged)
Item Weight: 6.64 pounds
UPC: 714176026190



9. WARRANTY AND SUPPORT

For warranty information and customer support, please refer to the official American Lighting website or contact their customer service directly. Keep your purchase receipt as proof of purchase for any warranty claims.

Manufacturer: American Lighting

Website: www.americanlighting.com (Please verify the actual manufacturer's website for support.)

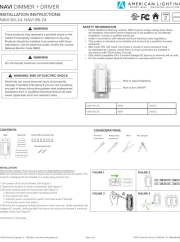
Related Documents - LS2-M-24-48-BK

	<p>American Lighting Spektrum+ Series Landscape Lights - Product Information</p> <p>Detailed information on American Lighting's Spektrum+ Series RGB+TW landscape lights, including specifications, ordering information, accessories, setup, and warranty.</p>
	<p>NAVI Dimmer + Driver Installation Instructions (NAVI-60-24, NAVI-96-24)</p> <p>Installation instructions for the American Lighting NAVI Dimmer + Driver models NAVI-60-24 and NAVI-96-24. Includes safety information, wiring diagrams, troubleshooting, and voltage adjustment.</p>
	<p>American Lighting NeonFlex Pro-L Series LED Neon Lighting</p> <p>Discover the American Lighting NeonFlex Pro-L Series, a 24V DC single color side bend LED neon lighting solution designed for seamless architectural installations. This document provides detailed product specifications, features, custom cut ordering information, assembly fees, accessories, recommended power supplies, handling guidelines, and warranty details. It includes comprehensive cut increment tables for precise project planning.</p>

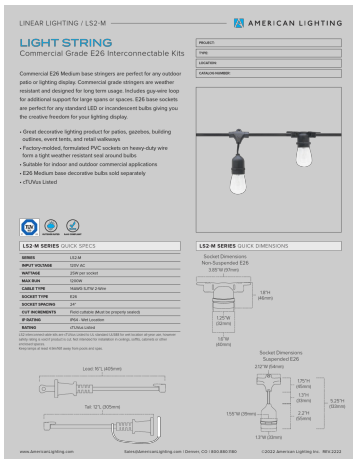

[pdf] Specifications Catalog

Commercial Grade Light String LS2 E26 48ft Black American Lighting SpecSheet AML

CommercialGradeLightString americanlighting media pdpResourceTab |||

LINEAR LIGHTING / LS2-M LIGHT STRING Commercial Grade E26

Interconnectable Kits Commercial E26 Mediu ... EAR LIGHTING / LS2-M LS2S-

EMRSIEESRIEE2S60- R12D0EWRINOGRDINEFROINRGMAINTFIOONRMATION

ITEM NUMBER **LS2-M-24-48-BK** VOLTAGE 120V AC LENGTH 48ft 15m SOCKET

TYPE Non-Suspended E26 LED SPACING 24 ...

lang:en score:20 filesize: 339.66 K page_count: 3 document date: 2023-07-13

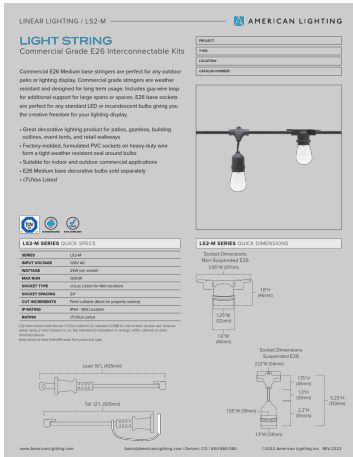

[pdf] Specifications Catalog

LS2 E26 Spec Sheet COMMERCIAL GRADE American Lighting SpecSheet CommercialGradeLightString

cdn sanity io files anbkks9g production c79461f852db5647921e4af84ea6b99f245bf60d |||

LINEAR LIGHTING / LS2-M LIGHT STRING Commercial Grade E26

Interconnectable Kits Commercial E26 Mediu ... EAR LIGHTING / LS2-M LS2S-

EMRSIEESRIEE2S60- R12D0EWRINOGRDINEFROINRGMAINTFIOONRMATION

ITEM NUMBER **LS2-M-24-48-BK** VOLTAGE 120V AC LENGTH 48ft 15m SOCKET

TYPE Non-Suspended E26 LED SPACING 24 ...

lang:en score:20 filesize: 432.86 K page_count: 3 document date: 2022-05-27

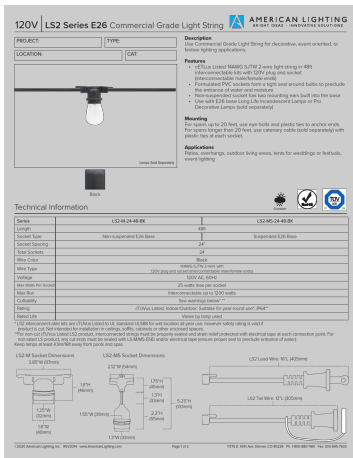

[pdf] Specifications

LS2 E26 Spec Sheet COMMERCIAL GRADE SUSPENDE American Lighting SpecSheet

CommercialGradeLightString cdn sanity io files anbkks9g production

657ec1c4b2f183044fe8a91c0f46aa1f896d0913 |||

120V LS2 Series E26 Commercial Grade Light String PROJECT: LOCATION: TYPE:

CAT: Description Use C ... as, tents for weddings or festivals, event lighting Black

Technical Information Outdoor Series **LS2-M-24-48-BK** LS2-MS-24-48-BK Length 48ft

Socket Type Non-suspended E26 Base Suspended E26 Ba...

lang:en score:20 filesize: 378.28 K page_count: 2 document date: 2022-04-19

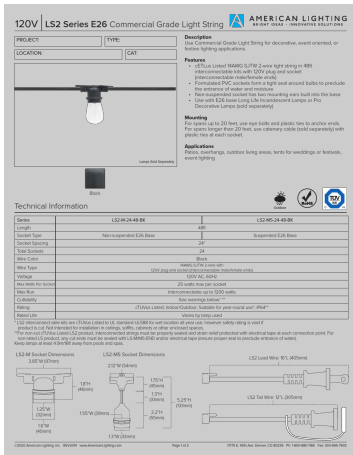

[pdf] Datasheet

COMMERCIAL GRADE SUSPENDE E26 120V Suspended Medium Base Stringers Proluxe by

American Lighting AV iQ cdn docs av iq dataSheet |||

120V LS2 Series E26 Commercial Grade Light String PROJECT: LOCATION: TYPE:

CAT: Description Use C ... as, tents for weddings or festivals, event lighting Black

Technical Information Outdoor Series **LS2-M-24-48-BK** LS2-MS-24-48-BK Length 48ft

Socket Type Non-suspended E26 Base Suspended E26 Ba...

lang:en score:20 filesize: 407.83 K page_count: 2 document date: 2021-03-17

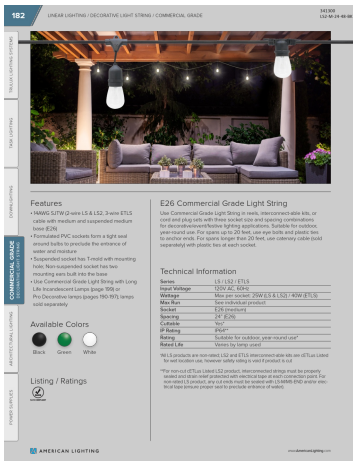

[pdf]

Cut Sheet American Lighting LS M 24 48 BK Pavilion Light String Commercial Grade Kit Rexel USA annls
m bk i DF8392CE C452 4DFB AEF0 6E9323A93E73 rexel cdn products |||

182 LINEAR LIGHTING / DECORATIVE LIGHT STRING / COMMERCIAL GRADE
341300 **LS2-M-24-48-BK** TRULUX LIGHTING SYSTEMS TASK LIGHTING
DOWNLIGHTING COMMERCIAL GRADE DECORATIVE LIGHT STRING
ARCHITECTURAL LIGHTING Features 14AWG SJTW 2-wire LS LS2, 3-wire ETLs
cable with medium and suspended medium ...

lang:en **score:18** filesize: 1.37 M page_count: 2 document date: 2018-06-12

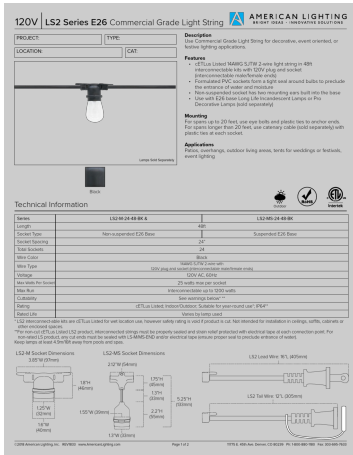

[pdf] Specifications Catalog

Spec SheetAmerican Lighting 48ft 24 E26 Commercial Grade String Lightspecsheet
commgradelightstring ls2americanlighting assets specsheet ls2 LS2 Series Light LightBulbsSpec
SheetCover the unused female receptacle at last light string with attached end cap and electrical tape to
preclude entrance of water 4 For spans American LightLS2 Sheetspecsheet ls2lightbulbs catalog product
s american lighting Sheetamericanlighting |||
120V LS2 Series E26 Commercial Grade Light String PROJECT: LOCATION: TYPE:
CAT: Description Use C ... as, tents for weddings or festivals, event lighting Black
Technical Information Outdoor Series **LS2-M-24-48-BK** LS2-MS-24-48-BK Length 48ft
Socket Type Non-suspended E26 Base Suspended E26 ...

lang:en **score:18** filesize: 384.72 K page_count: 2 document date: 2018-08-23



[pdf]

Commercial Grade Light String Cut Sheet COMMERCIAL GRADE E26 American Lighting Cutsheet
CGLS cdn sanity io files anbkks9g production f9fe855a6728707fad859b84083ffef34171f78b |||
247 LINEAR LIGHTING / COMMERCIAL GRADE LIGHT STRING SPEKTRUM
TRULUX LIGHTING SYSTEMS TASK LIGHT ... 48ft ITEM NUMBER LENGTH
SOCKETS SOCKET SPACING SOCKET TYPE MAX WATTAGE IP RATING Rating
LS2-M-24-48-BK 48 ft 24 24 in Non-suspended 25W per socket IP64 TUV LS2-MS-
24-48-BK 48 ft ...

lang:en **score:16** filesize: 1.21 M page_count: 2 document date: 2022-04-08

182 LINEAR LIGHTING / DECORATIVE LIGHT STRING / COMMERCIAL GRADE



Features

- Available in E26, E17 and E26/29 variants
- Formulated PVC sockets form a tight seal around bulbs to provide the protection of water and moisture
- Expanded socket base T model with mounting tabs. Non-suspended socket base only
- Mounting tabs built into the base
- Use Commercial Grade Light String with Long Life The Decorative Lamp, sold separately

Available Colors

Black

Listing / Ratings

Commercial Grade Light String - 120V

Use Commercial Grade Light String in wet, intermediate-dry, or damp and plug only with these socket type and wiring combinations for intermediate-dry lighting applications. Suitable for outdoor use when used with the proper plug type. Use only bulbs and plugs that are listed for use with the proper plug type. For more information, see the listing for the proper plug type.

Technical Information

Series	LS2 (LS2)
Input Voltage	120V AC, 60Hz
Wattage	Max per socket: 25W (E26) / 25W (E17) (E29)
Max Run	See technical product
Socket	E26 (standard)
Spacing	24" (24" / 12" / 12" / 12")
Wiring	2-Wire (14/16 AWG)
IP Rating	IP64
Listing	UL Listed (UL1818) Suitable for your local code
Rated Life	Varies by lamp used

Light String Accessories

LS2-M-24-48-BK 48ft 24 in Non-suspended 25W per socket IP64 Yes LS2-MS-24-48-BK 48 ft ...

[pdf]

American Lighting 330 ft 25W LED String Lights Suspended E26 120V Green LS MS 24 GR

HomElectrical Cutsheet CGLS drive google file d 17ddTwl62G7jIT48WMrb2rrgeFm ivFIIf view usp sharing u003eSpec |||

182 LINEAR LIGHTING / DECORATIVE LIGHT STRING / COMMERCIAL GRADE TRULUX LIGHTING SYSTEMS TASK LIG ... ft ITEM NUMBER LENGTH SOCKETS SOCKET SPACING SOCKET TYPE MAX WATTAGE IP RATING TUV Listed **LS2-M-24-48-BK** 48 ft 24 24 in Non-suspended 25W per socket IP64 Yes LS2-MS-24-48-BK 48 ft ...

lang:en score:15 filesize: 1.2 M page_count: 2 document date: 2020-05-06

120V LS2 Series E26 Commercial Grade Light String

PROJECT: LOCATION: TYPE: CAT:



Technical Information

Series	LS2 (LS2)
Length	48ft
Socket Type	Non-suspended E26 Base
Socket Spacing	24"
Base Color	Black
Wire Type	14/16 AWG SJTW 2-Wire with Long Life The Decorative Lamp, sold separately
Wattage	Max per socket: 25W (E26) / 25W (E17) (E29)
Max Run	See technical product
Socket	E26 (standard)
Spacing	24" (24" / 12" / 12" / 12")
Wiring	2-Wire (14/16 AWG)
IP Rating	IP64
Listing	UL Listed (UL1818) Suitable for your local code
Rated Life	Varies by lamp used

LS2-M-24-48-BK Dimensions

48ft 24 in Non-suspended 25W per socket IP64 Yes LS2-MS-24-48-BK 48 ft ...

[pdf] Specifications

specs sheet commgrade Index of @site takethreelighting ssl commgradelightstring ls2 p9 secure hostingprod |||

120V LS2 Series E26 Commercial Grade Light String PROJECT: LOCATION: TYPE: CAT: Description Use C ... ng Black Technical Information Series Length Socket Type Socket Spacing Total Sockets Wire Color **LS2-M-24-48-BK** 48ft Non-suspended E26 Base 24 24 Black Outdoor Wire Type 14AWG SJTW 2-wire with ...

lang:en score:15 filesize: 381.42 K page_count: 2 document date: 2017-08-16

PAVILION LIGHT STRING



Pavilion Light String

- Great for outdoor lighting product for patios, gazebos, ...
- Factory-installed, formulated PVC sockets on heavy-duty wire form a tight weather-resistant seal around bulbs
- Expandable socket base T model with mounting tabs. Non-suspended socket base only
- Mounting tabs built into the base
- Use Commercial Grade Light String with Long Life The Decorative Lamp, sold separately

Specifications: LS2 Series Kits

Input Voltage	120V AC, 60Hz
Wattage	Max per socket: 25W (E26) / 25W (E17) (E29)
Maximum run	See technical product
Socket	E26 (standard)
Spacing	24" (24" / 12" / 12" / 12")
Wiring	2-Wire (14/16 AWG)
IP Rating	IP64
Listing	UL Listed (UL1818) Suitable for your local code
Rated Life	Varies by lamp used

Specifications: LS2 Series Kits & Runs

Input Voltage	120V AC, 60Hz
Wattage	Max per socket: 25W (E26) / 25W (E17) (E29)
Maximum run	See technical product
Socket	E26 (standard)
Spacing	24" (24" / 12" / 12" / 12")
Wiring	2-Wire (14/16 AWG)
IP Rating	IP64
Listing	UL Listed (UL1818) Suitable for your local code
Rated Life	Varies by lamp used

[pdf] Specifications

ssnscutsheet pavilion lightstring americanlighting assets |||

PAVILION LIGHT STRING Pavilion Light String Great decorative lighting product for patios, gazebos, ... 8-BK BLACK 2-WIRE LS2-MS-24-48-WH WHITE 2-WIRE 48ft Kit E26 Base Sockets 24 Spacing 1200W Max **LS2-M-24-48-BK** BLACK 2-WIRE E26 MEDIUM CORD PLUG SETS PART NUMBER WIRE 100ft Kit E26 Suspend...

lang:da score:15 filesize: 2.18 M page_count: 2 document date: 2019-04-17



[\[pdf\]](#) Specifications Accessories

American Lighting Seasonal 2021 07 Seasonal estrin co |||

2021 SEASONAL For the most current product specifications and ordering information Please visit us ... ctual product Bulbs sold separately COMMERCIAL E26 LIGHT STRING ORDERING INFORMATION ITEM NUMBER **LS2-M-24-48-BK** LS-M-24-100-BK LS-M-24-BK LEAD/TAIL 120V AC Plug/Socket 120V AC Plug/Sealed End Bare...

lang:en score:14 filesize: 84.75 M page_count: 72 document date: 2021-06-02



[\[pdf\]](#) Specifications

American Lighting Seasonal 2020 Marketing Estrin Zirkman Sales Seasonal@AmericanLighting Denver CO 800 880 1180 6 LIGHT S TRING TINGERS REELS A CCESSORIES ARCHITECTURAL LINEAR LIGHTING estrin co 08 |||

2020 SEASONAL For the most current product specifications and ordering information Please visit us ... ctual product Bulbs sold separately COMMERCIAL E26 LIGHT STRING ORDERING INFORMATION ITEM NUMBER **LS2-M-24-48-BK** LS-M-24-100-BK LS-M-24-BK COLOR Black Black Black LENGTH 48ft 100ft 330ft SOCKETS ...

lang:en score:12 filesize: 14.72 M page_count: 68 document date: 2020-08-18



[\[pdf\]](#) Specifications Catalog

american lighting 20 Index of 2020 10 rev2015 low res estrin co |||

2020 CATALOG For the most current product specifications and ordering information Please visit us ... AL GRADE DECORATIVE LIGHT STRING MEDIUM BASE E26 cETLus LISTED ORDERING INFORMATION ITEM NUMBER **LS2-M-24-48-BK** LS2-MS-24-48-BK LS2-MS-24-48-WH LENGTH 48 ft 48 ft 48 ft SOCKETS 24 24 24 SOCKET S...

lang:en score:11 filesize: 61.26 M page_count: 260 document date: 2020-04-21



[\[pdf\]](#) Specifications Catalog

Resources catalog american lighting 2019 web 216 92 145 71 assets |||

2019 CATALOG For the most current product specifications and ordering information
Please visit us ... nterconnectable Sets 24 sockets / 24 socket spacing 25W max per
socket / cETLus Listed / 1200W max **LS2-M-24-48-BK** Black Suspended Medium E26
Base 48ft Interconnectable Sets 24 sockets / 24 sock...

lang:en **score:11** filesize: 41.24 M page_count: 228 document date: 2019-01-03