

VOYOR VRMM1-NEW

VOYOR Electric Cellulite Massager VRMM1-NEW User Manual

Model: VRMM1-NEW

1. INTRODUCTION

Thank you for choosing the VOYOR Electric Cellulite Massager. This multi-functional device is designed to provide powerful deep tissue massage, assist in cellulite reduction, and offer effective skin cleansing for various body parts including the face, hands, belly, arms, neck, feet, and body. With its cordless and waterproof design, it offers convenience and versatility for your daily wellness routine.

This manual provides essential information on the safe and effective use of your VOYOR massager, including setup, operation, maintenance, and troubleshooting tips. Please read it thoroughly before first use and keep it for future reference.



Figure 1.1: VOYOR Electric Cellulite Massager with its packaging and various interchangeable heads.

2. SAFETY INFORMATION

Please adhere to the following safety guidelines to ensure safe operation and prevent injury or damage to the device:

- Do not use the massager on burnt, traumatic, or fractured areas.
- Always fully charge the device before its first use or when it is completely powered off to ensure proper functioning.
- The device cannot be turned on while charging. Please unplug the USB charging cable before attempting to turn it on.
- This facial massager is IPX7 waterproof, allowing for safe use in the shower. However, ensure the charging port is completely dry before charging.
- Keep the device out of reach of children.
- Avoid dropping the device or subjecting it to strong impacts.
- Do not attempt to disassemble or repair the device yourself. Contact customer support for assistance.

3. PRODUCT OVERVIEW

The VOYOR Electric Cellulite Massager is designed for comprehensive body care, featuring multiple functions and user-friendly controls.

Key Features:

- **Powerful Deep Tissue Massage:** Equipped with an upgraded motor and 8 groups of massage rollers (80 wave heads) delivering over 42,900 rotations per minute to promote blood circulation and relieve muscle tension.
- **Cellulite Reduction:** Specialized cellulite massage rollers help creams and oils penetrate deeper into the skin, aiding in fat elimination and exfoliation for smoother skin.
- **Facial & Body Cleansing:** Includes two different types of brush heads for effective skin cleansing.
- **IPX7 Waterproof:** Safe for use in the shower.
- **3 Strength Levels:** Adjustable speeds (LOW, MID, HIGH) to suit your preference.
- **2 Massage Directions:** Clockwise and anti-clockwise rotation for varied massage techniques.
- **Cordless & Portable:** Ergonomic design for easy handling and use anywhere.

MULTIFUNCTIONAL RECHARGEABLE MASSAGER

Know what you need, care at any time, your companion

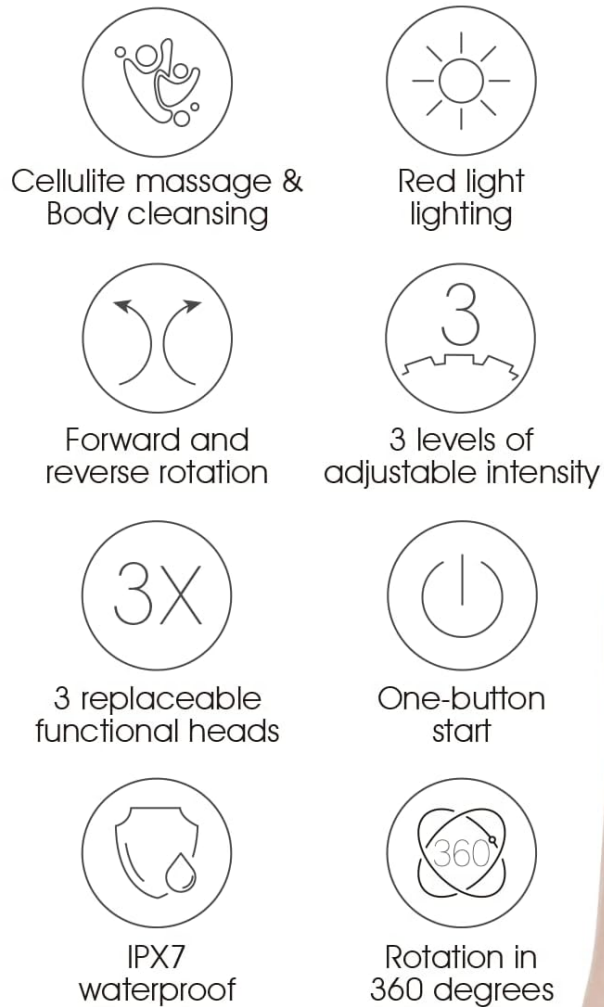

Figure 3.1: Overview of the massager's multi-functional features.

Components:

- Main Massager Unit
- Cellulite Massage Head (with 8 groups of wave heads)
- Soft Bristle Face & Body Brush Head
- Silicone Face & Body Brush Head
- USB Charging Cable (Type-C)

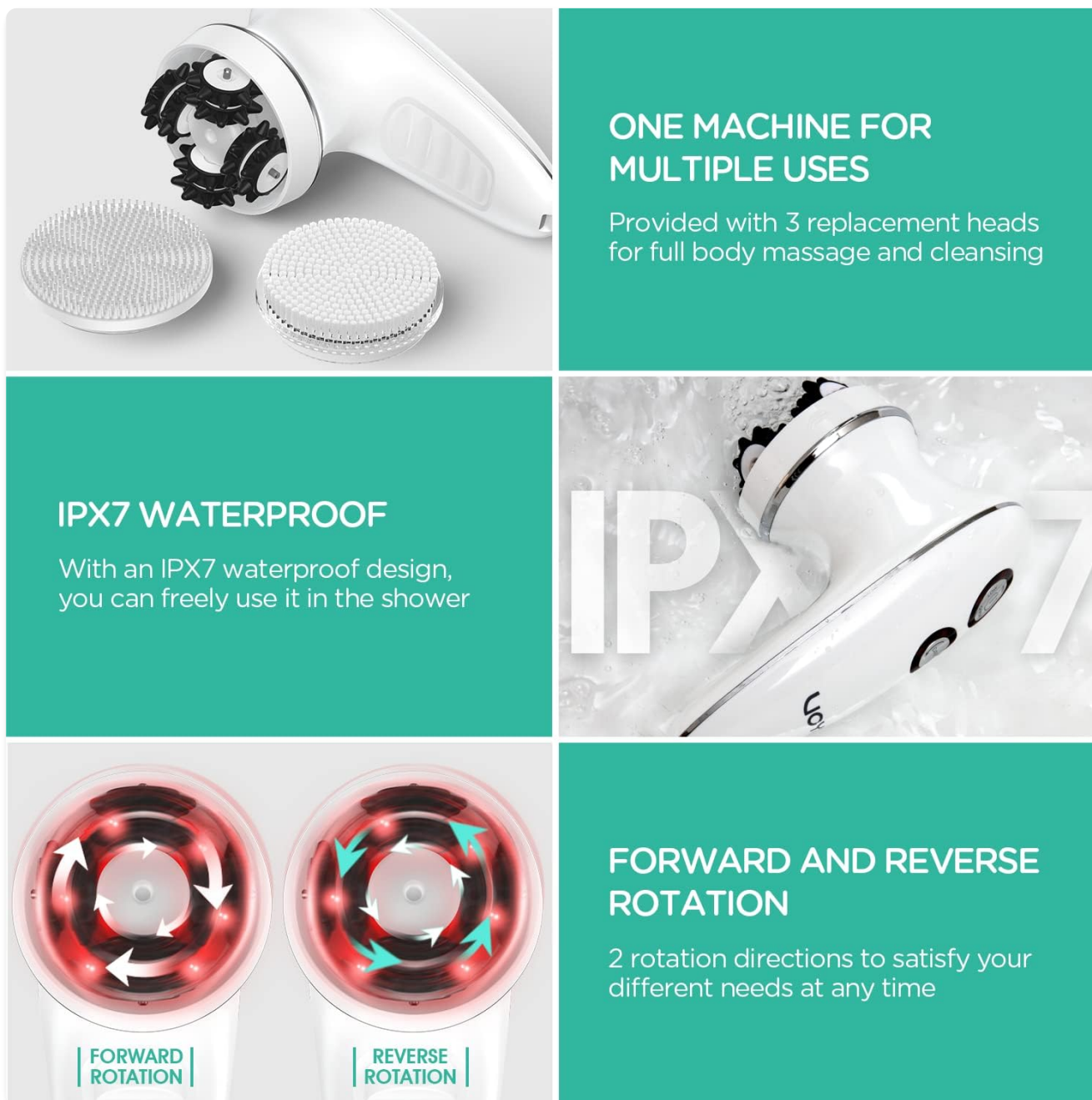

Figure 3.2: The three interchangeable heads provided with the massager.

4. SETUP

Charging the Device:

1. Locate the Type-C charging port on the bottom of the massager.
2. Connect the provided USB charging cable to the massager and a suitable USB power adapter (not included).
3. Ensure the device is fully charged before first use. The charging indicator light will provide status.
4. **Important:** The massager cannot be turned on while charging. Unplug the USB cable before use.



Figure 4.1: Proper charging procedure and caution against operating while charging.

Attaching/Changing Heads:

1. Select the desired massage or brush head (Cellulite, Soft Bristle, or Silicone).
2. Align the head with the central shaft on the main unit.
3. Gently push and twist until it clicks securely into place.
4. To remove, gently pull the head away from the main unit.

5. OPERATION

Basic Controls:

The massager features two main control buttons on its top surface:

- **Power Switch & Intensity Button:** Controls power ON/OFF and cycles through LOW, MID, and HIGH intensity levels.
- **Direction Switch & Red Light Button:** Changes the rotation direction (clockwise/anti-clockwise) and activates/deactivates the red light function.

ONE-KEY START, SIMPLE OPERATION

Let you enjoy a relaxed and healthy life



Figure 5.1: Control buttons and their functions.

Usage Instructions:

1. Ensure the desired head is securely attached.
2. Press the Power Switch to turn on the device. It will start at the LOW intensity setting.
3. Press the Power Switch again to cycle through MID and HIGH intensity levels. Pressing it a fourth time will turn the device off.
4. Press the Direction Switch to change the rotation direction of the massage head.
5. The red light function can be activated or deactivated by pressing the Direction Switch button.
6. Apply the massager to the desired body area. For cellulite reduction, consider applying a suitable cream or oil beforehand to enhance penetration.

Figure 5.2: Recommended usage areas for the massager.

Your browser does not support the video tag.

Video 5.1: Official product video demonstrating the massager's use for various body parts and its benefits for muscle relaxation and skin health.

6. MAINTENANCE

Proper maintenance ensures the longevity and hygiene of your VOYOR massager.

- **Cleaning:** After each use, especially when used with creams or oils, detach the head and rinse it under running water. The main unit can be wiped clean with a damp cloth.
- **Drying:** Ensure all parts, especially the charging port, are completely dry before storing or recharging.
- **Storage:** Store the massager and its attachments in a cool, dry place away from direct sunlight and extreme temperatures.
- **Battery Care:** To prolong battery life, avoid fully discharging the battery frequently. Charge it regularly, even if not in constant use.

7. TROUBLESHOOTING

Problem	Possible Cause	Solution
Device does not turn on.	Battery is low or depleted. Charging cable is still connected.	Charge the device fully. Ensure the USB charging cable is unplugged before attempting to turn it on.
Massage head is not rotating.	Head not properly attached. Obstruction.	Ensure the head is securely clicked into place. Check for any debris or hair obstructing the rotation mechanism.
Reduced massage intensity.	Low battery. Incorrect intensity setting.	Recharge the device. Cycle through the intensity settings (LOW, MID, HIGH) to select a stronger mode.
Charging port shows rust.	Moisture in the charging port.	Ensure the charging port is completely dry before plugging in the cable. While the device is waterproof, the port itself needs to be dry for charging. If rust persists and affects function, contact customer support.

8. SPECIFICATIONS

Feature	Specification
Model Number	VRMM1-NEW
Brand	VOYOR
Product Dimensions	6.69 x 4.33 x 3.15 inches
Item Weight	13.33 ounces (378 Grams)
Material	Acrylonitrile Butadiene Styrene
Power Source	Battery Powered
Battery Type	1 D battery (included)
Waterproof Rating	IPX7
Manufacturer	VOYOR
Country of Origin	China

9. WARRANTY AND SUPPORT

VOYOR products are designed for quality and performance. For any product-related inquiries, technical support, or warranty claims, please contact VOYOR customer service.

While specific warranty details are not provided in this manual, VOYOR aims to ensure customer satisfaction. Please refer to your purchase documentation or the official VOYOR website for the most up-to-date warranty information.

Extended protection plans may be available for purchase separately. Check with your retailer for options such as 2-Year or 3-Year Protection Plans.

For more information, visit the official VOYOR Store:[VOYOR Store on Amazon](#)