



Manuals.plus /

› GL.iNet /

› GL.iNet GL-MT300N-V2 (Mango) Portable Mini Travel Wireless Pocket VPN WiFi Router User Manual

GL.iNet GL-MT300N-V2

GL.iNet GL-MT300N-V2 (Mango) Portable Mini Travel Wireless Pocket VPN WiFi Router User Manual

Model: GL-MT300N-V2

1. INTRODUCTION

The GL.iNet GL-MT300N-V2 (Mango) is a compact and portable mini travel router designed for secure and flexible network connectivity. It functions as a wireless router, repeater, access point, or Wi-Fi hotspot, providing a private Wi-Fi network from public wired or wireless connections. Featuring OpenWrt pre-installed and OpenVPN/WireGuard client support, it offers enhanced security and customization for various networking needs, including travel, home, and small office use.



Figure 1: GL.iNet GL-MT300N-V2 (Mango) Router

2. PACKAGE CONTENTS

Verify that all items are present in your package:

- GL-MT300N-V2 (Mango) mini router
- USB cable
- Ethernet cable
- User Manual

3. PRODUCT OVERVIEW

3.1 Physical Components

Familiarize yourself with the ports, buttons, and indicators on your GL-MT300N-V2 router:

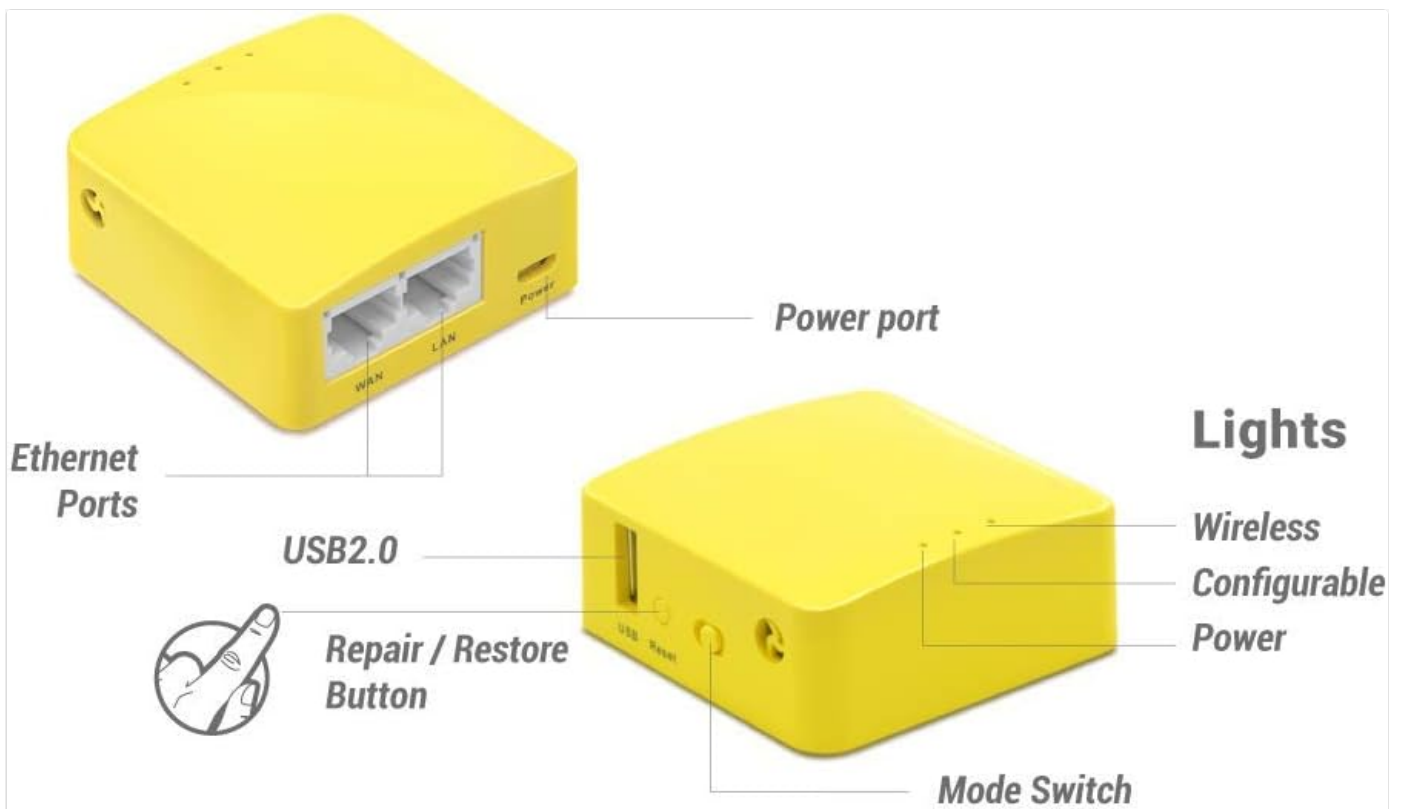

Product Dimension

Weight: 40g / 1.411oz

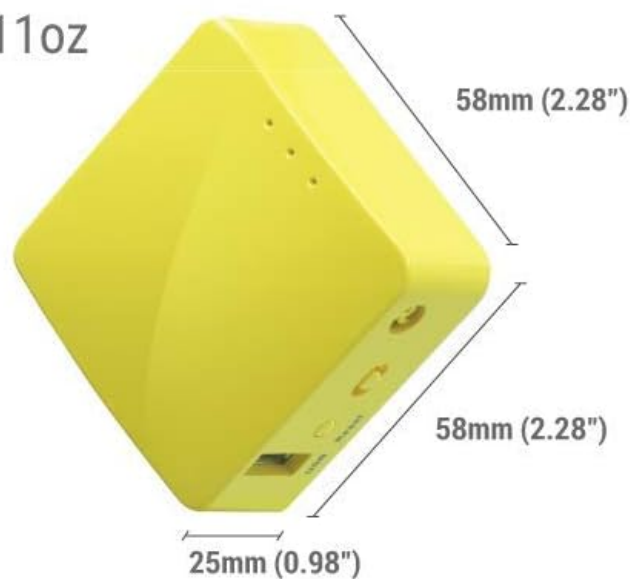

Figure 2: GL-MT300N-V2 Physical Layout

- **WAN Port:** Connects to the internet source (e.g., modem, hotel Ethernet).
- **LAN Port:** Connects to wired devices (e.g., computer, game console).
- **Power Port:** Micro USB port for power input (5V/2A DC adapter or USB power source).
- **USB 2.0 Port:** For USB tethering or connecting external storage.
- **Reset Button:** Used for factory reset or repair/restore functions.
- **Mode Switch:** Toggles between different operating modes or functions.
- **LED Indicators:** Lights indicating power, wireless activity, and configurable status.

Portable and Flexible

Travel-sized and Compact Design Fits in with Any Pockets

USB port

Tethering compatible



Micro USB port

Powered by any laptop, power bank or a standard **5V/2A** DC adapters as a power supply

Figure 3: USB and Micro USB Ports

The Micro USB port is used to power the device, compatible with any laptop USB port, power banks, or standard 5V/2A DC adapters (sold separately). The USB port supports tethering for internet access from a smartphone or cellular data dongle.

4. SETUP GUIDE

Follow these steps for the initial setup of your GL-MT300N-V2 router:

1. **Power On:** Connect the router to a power source using the provided USB cable and a 5V/2A DC adapter or a laptop's USB port.
2. **Connect to the Router:**
 - **Via Ethernet:** Connect your computer to the router's LAN port using the Ethernet cable.
 - **Via Wi-Fi:** Search for the router's Wi-Fi network (SSID) on your device and connect to it. The default SSID and password can be found on the router's label.
3. **Access Admin Panel:** Open a web browser and navigate to <http://192.168.8.1>.

4. **Initial Configuration:** Follow the on-screen instructions to set up a new administrator password and configure your basic network settings.
5. **Firmware Update:** It is recommended to update the router to the latest firmware version for optimal performance and security. This option is typically found in the System or Firmware section of the Admin Panel.

QoS (Quality of service)

Get Faster Internet When You Really Need It

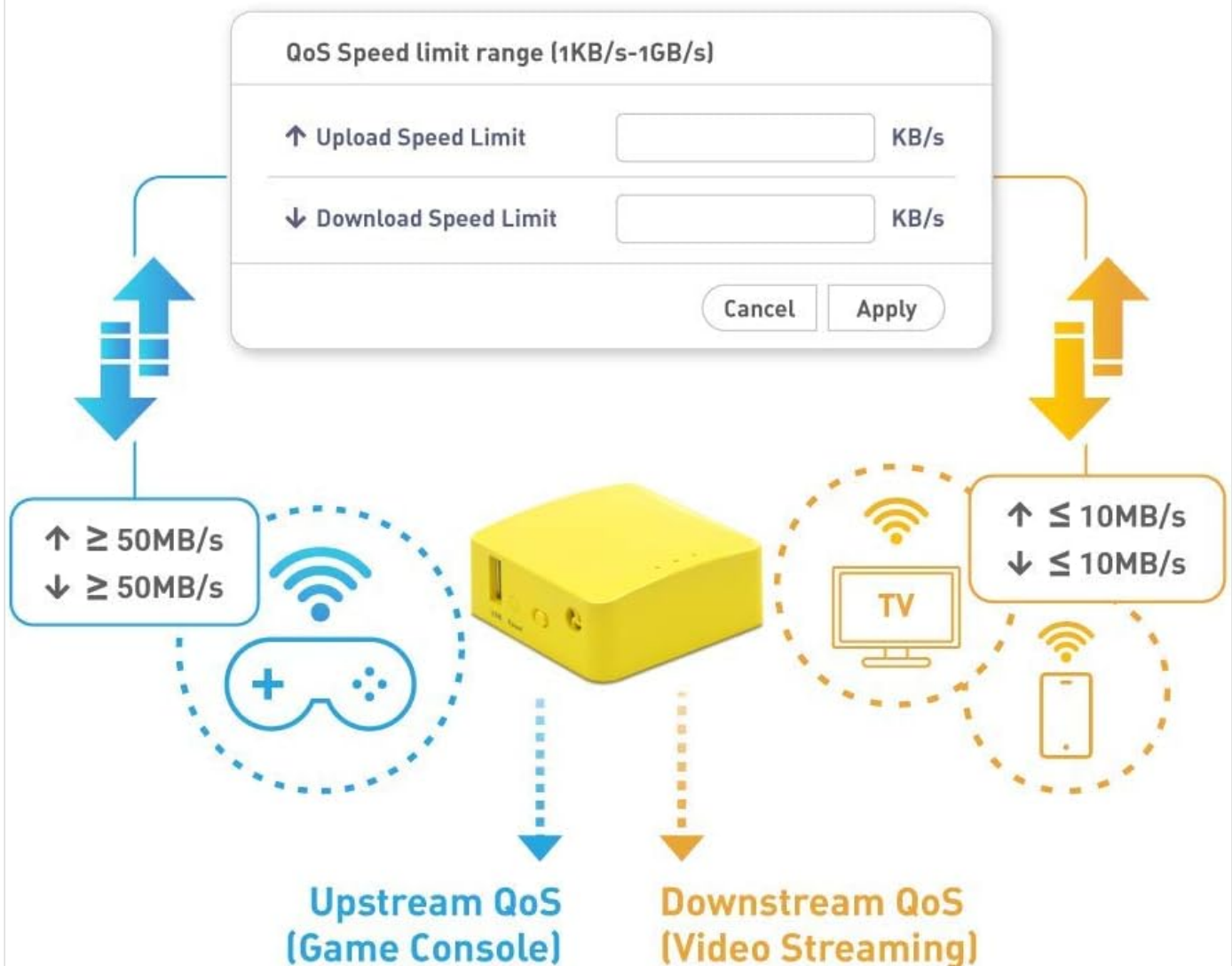

Figure 4: Mobile-Optimized Web Admin Panel

The Admin Panel is mobile-optimized and responsively designed for easy configuration from various devices.

5. OPERATING MODES

The GL-MT300N-V2 supports multiple operating modes to suit different networking scenarios:

Quickly Create an Internet Access Anywhere

Use as a Router, Repeater, Access Point or Wi-Fi Hotspot

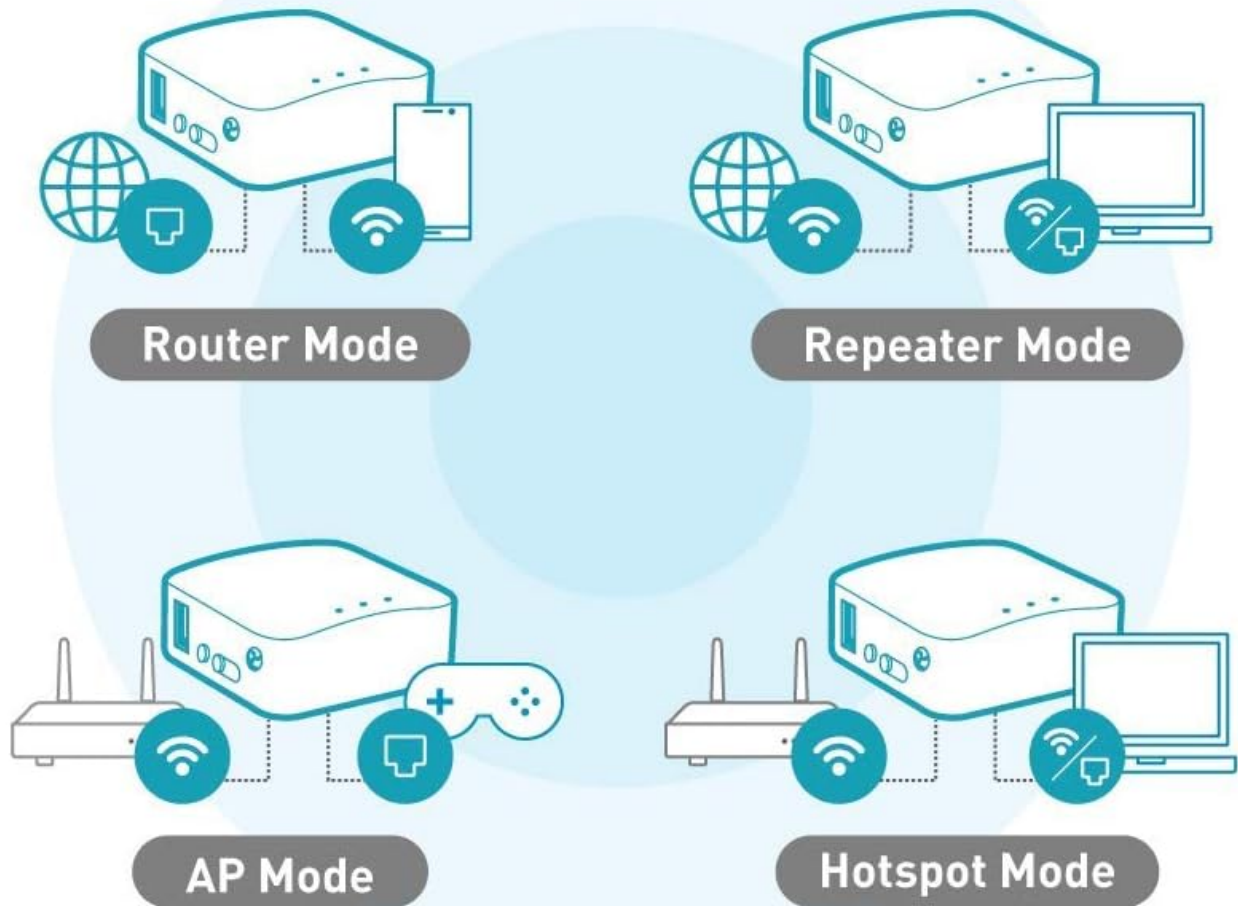

Figure 5: Internet Access Modes

- **Router Mode:** The router acts as the primary network device, connecting to an internet source (e.g., DSL/Cable modem) via its WAN port and distributing internet access to connected devices via Wi-Fi or LAN.
- **Repeater Mode:** The router extends the range of an existing Wi-Fi network by connecting to it wirelessly and rebroadcasting the signal. This is ideal for public Wi-Fi in hotels or cafes, creating a private and secure sub-network.
- **Access Point (AP) Mode:** The router converts a wired network connection into a wireless one, allowing Wi-Fi devices to connect to a network that previously only had wired access.
- **Hotspot Mode:** Similar to Repeater mode, but often used in conjunction with captive portals (login pages) found in public Wi-Fi networks.
- **Tethering:** The router can use a smartphone's cellular data connection as its internet source via a USB cable. This is useful when no Wi-Fi or Ethernet connection is available.
- **USB Modem:** The router can connect to a USB 3G/4G modem to provide internet access.

Methods to access the Internet



1 Cable



2 Repeater

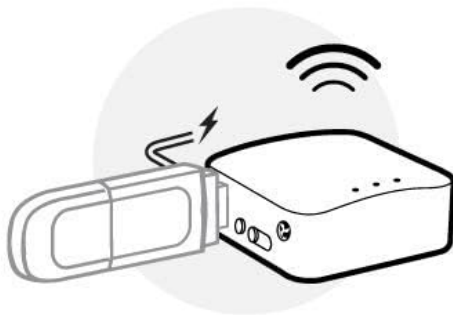

3 USB Modem

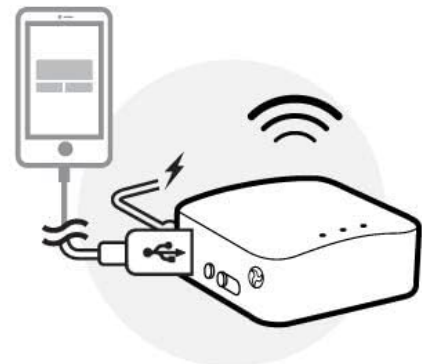

4 Tethering

Figure 6: Methods to Access the Internet

6. ADVANCED FEATURES

6.1 VPN Client

The GL-MT300N-V2 comes with OpenVPN and WireGuard clients pre-installed, allowing you to connect to over 30 VPN service providers. This feature encrypts all network traffic passing through the router, providing enhanced privacy and security, especially on public Wi-Fi networks.

Advanced Security

Keeps Your Network Safe with Advanced Security Encryption

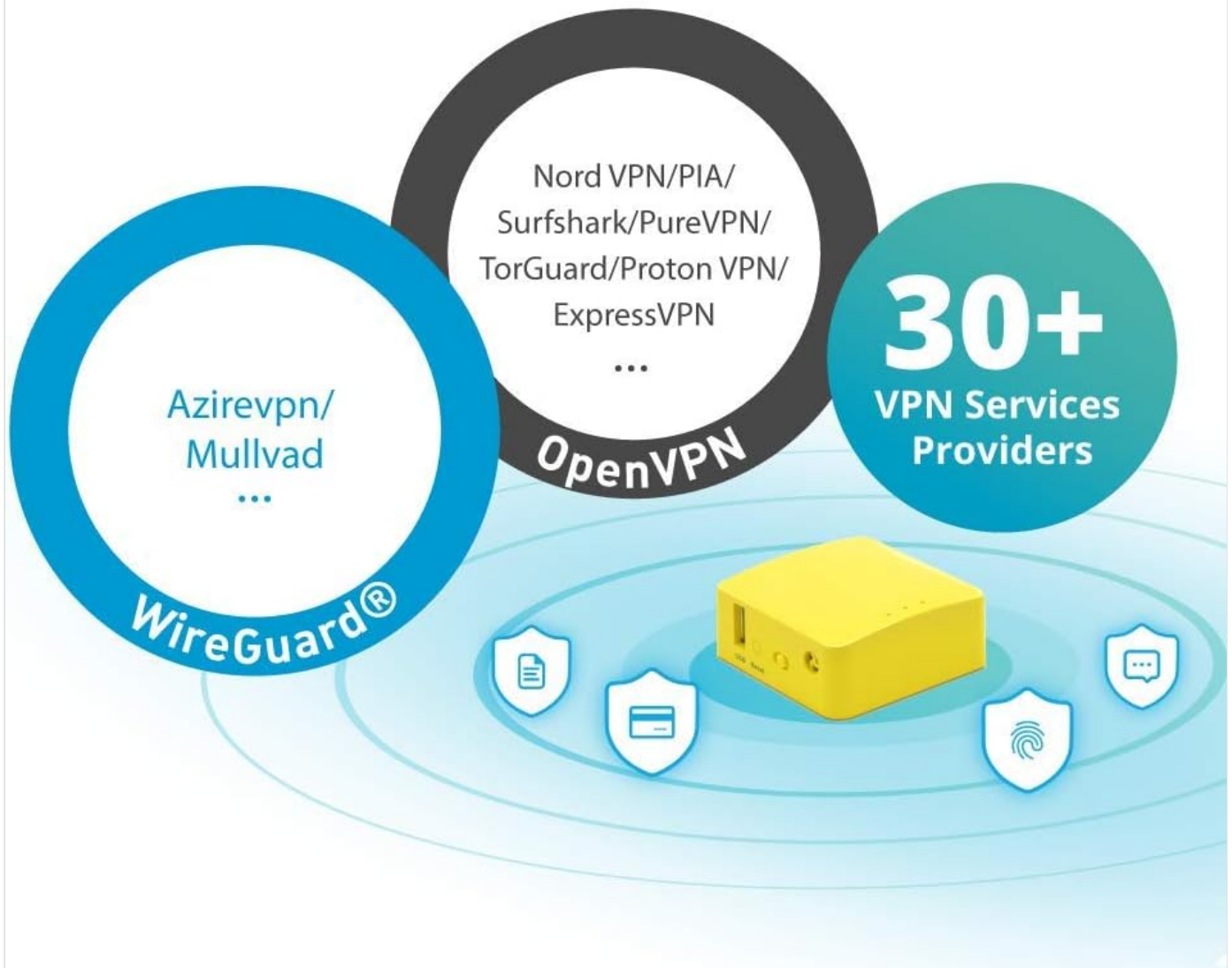

Figure 7: Advanced Security with VPN Support

6.2 Quality of Service (QoS)

The router supports Quality of Service (QoS) settings, enabling you to prioritize network traffic for specific applications or devices. This ensures smoother performance for critical activities like online gaming (Upstream QoS) or video streaming (Downstream QoS) by allocating bandwidth effectively.

Delicate Web UI

Mobile-optimized and Responsively Designed Control Panel

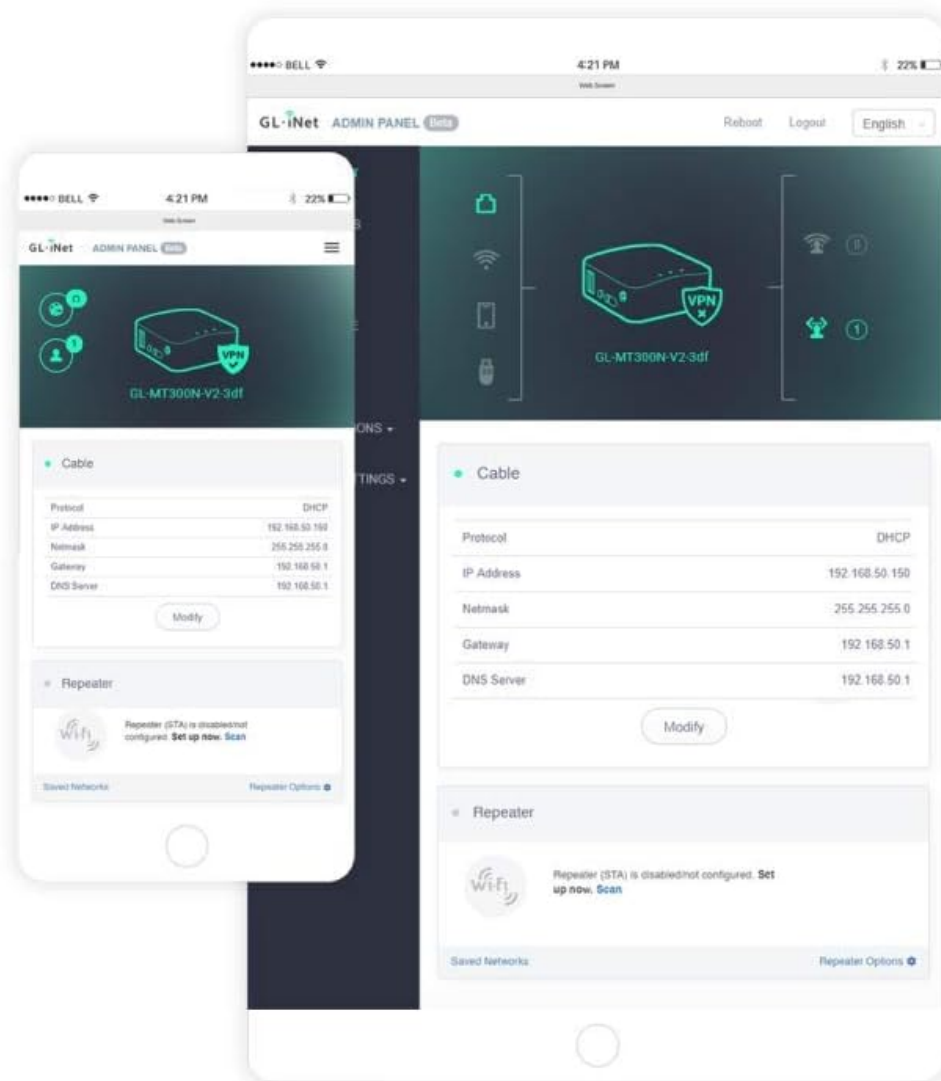

Figure 8: Quality of Service (QoS) Functionality

7. MAINTENANCE

To ensure optimal performance and security of your GL-MT300N-V2 router, regular maintenance is recommended:

- **Firmware Updates:** Periodically check for and install the latest firmware updates from the GL.iNet official website or through the router's Admin Panel. Firmware updates often include bug fixes, performance improvements, and security patches.
- **Regular Reboots:** Occasionally restarting the router can help clear its memory and resolve minor connectivity issues.
- **Secure Passwords:** Use strong, unique passwords for your Wi-Fi network and the router's Admin Panel.
- **Physical Environment:** Keep the router in a well-ventilated area, away from direct sunlight and sources of heat or moisture.

8. TROUBLESHOOTING

If you encounter issues with your GL-MT300N-V2 router, consider the following common solutions:

- **No Internet Connection:**

- Check if the WAN cable is securely connected.
- Verify that the internet source (modem, hotel network) is active and providing internet.
- If using Repeater mode, ensure the router is successfully connected to the upstream Wi-Fi network. Some public Wi-Fi networks require web page authentication; complete this step on a connected device.
- Reboot the router and your modem/internet source.

- **Slow Wi-Fi Speed:**

- Ensure the router is placed in a central location, away from obstructions and interference sources (e.g., microwaves, cordless phones).
- Check for firmware updates.
- Limit the number of connected devices or enable QoS to prioritize critical traffic.

- **Cannot Access Admin Panel:**

- Ensure your device is connected to the router's Wi-Fi or LAN port.
- Verify you are using the correct IP address (<http://192.168.8.1>).
- Try clearing your browser's cache or using a different browser.

- **VPN Connection Issues:**

- Ensure your VPN service credentials are correct.
- Verify that the VPN server is accessible and not blocked by your internet provider.
- Try switching to a different VPN server or protocol (OpenVPN/WireGuard).
- Note that the router itself does not replace a VPN service; you still need a subscription from a VPN provider.

- **Factory Reset:** If problems persist, perform a factory reset by pressing and holding the Reset button for 10 seconds while the router is powered on. This will revert all settings to their default values.

9. SPECIFICATIONS

Feature	Description
Model Name	GL-MT300N-V2
Product Dimensions	2.28 x 0.98 x 2.28 inches
Item Weight	1.41 ounces (39g)
Connectivity Technology	Wi-Fi, USB, Ethernet
Wireless Communication Standard	802.11bgn
Frequency Band Class	Single-Band (2.4 GHz)
Max Wireless Speed	300Mbps
RAM	128MB
Flash ROM	16MB
Ethernet Ports	2 (WAN, LAN)
USB Port	USB 2.0
Special Feature	OpenWrt pre-installed, OpenVPN/WireGuard Client, Access Point Mode, Internet Security
Power Input	5V/2A DC (Micro USB)
Manufacturer	GL Technologies
Country of Origin	China

10. WARRANTY AND SUPPORT

The GL-MT300N-V2 (Mango) mini router comes with a **2-year Warranty** from the manufacturer, GL Technologies. For further assistance, technical support, or to download the latest firmware and detailed documentation, please visit the official GL.iNet website or refer to the User Manual (PDF) provided with your product. You can also find additional resources and FAQs on the GL.iNet brand store: [GL.iNet Store on Amazon](#).