

## Manuals+

[Q & A](#) | [Deep Search](#) | [Upload](#)

manuals.plus /

- › [ECHOGEAR](#) /
- › [ECHOGEAR MaxMotion TV Wall Mount EGLF2 Instruction Manual](#)

## ECHOGEAR EGLF2

# ECHOGEAR MaxMotion TV Wall Mount EGLF2 Instruction Manual

Model: EGLF2

### 1. INTRODUCTION

This manual provides comprehensive instructions for the safe and proper installation, operation, and maintenance of your ECHOGEAR MaxMotion Full Motion TV Wall Mount, model EGLF2. This mount is designed to securely hold televisions ranging from 42 to 90 inches and weighing up to 125 lbs. Please read all instructions carefully before beginning installation.



Image: Front view of the ECHOGEAR MaxMotion TV Wall Mount EGLF2, showcasing its robust design and articulating arms.

## 2. SAFETY INFORMATION

**WARNING:** Failure to read and follow these instructions may result in serious personal injury, property damage, or voiding of your warranty. If you do not understand these instructions or have doubts about the safety of the installation, please contact ECHOGEAR customer support.

- Do not install this product on walls that are not structurally sound.
- Ensure the mounting surface can support the combined weight of the mount and the television.
- Always use a stud finder to locate the center of wood studs.
- Drill pilot holes to the specified depth and diameter.
- Do not overtighten screws.
- This product is intended for indoor use only.
- Keep children and pets away during installation.

## 3. PACKAGE CONTENTS

Verify that all components are present and undamaged before beginning installation. If any parts are missing or damaged, do not proceed with installation and contact ECHOGEAR customer support.

- Wall Plate Assembly
- TV Brackets (2)
- Hardware Kit (various screws, washers, spacers for TV and wall mounting)
- Drilling Template
- Instruction Manual

## 4. TOOLS REQUIRED

The following tools are recommended for a successful installation:

- Stud Finder
- Drill
- Drill Bits (specific sizes for pilot holes, refer to drilling template)
- Level
- Phillips Head Screwdriver
- Socket Wrench (for lag bolts)
- Pencil
- Measuring Tape

## 5. SETUP AND INSTALLATION

### 5.1 Determine Wall Type and Location

This mount is compatible with 16"-24" wood studs, poured concrete, and concrete block walls. **Do not install on drywall alone.**



Image: Illustration of compatible wall types for installation, including wood studs, poured concrete, and concrete block.

## 5.2 Wall Plate Installation

1. **Locate Studs:** Use a stud finder to locate the edges and center of two adjacent wood studs. Mark the center of the studs at your desired TV height. For concrete walls, mark your desired mounting points.
2. **Position Template:** Tape the included drilling template to the wall, aligning it with your marked stud centers or concrete mounting points. Use a level to ensure it is perfectly horizontal.



Image: A person drilling pilot holes into a wall using the provided ECHOGEAR drilling template for accurate placement.

3. **Drill Pilot Holes:** Drill pilot holes through the marked points on the template. Refer to the template for specific drill bit sizes and depths for your wall type.
4. **Attach Wall Plate:** Align the wall plate with the drilled holes. Secure it to the wall using the provided lag bolts and washers. Tighten the lag bolts firmly, but do not overtighten.

## 5.3 TV Bracket Attachment

1. **Identify VESA Pattern:** Locate the mounting holes on the back of your TV. Measure the horizontal and vertical distance between these holes to determine your TV's VESA pattern. The EGLF2 mount supports various VESA patterns.
2. **Select Hardware:** Choose the appropriate screws, washers, and spacers from the hardware kit that

fit your TV's VESA pattern and depth.

3. **Attach Brackets:** Secure the two TV brackets to the back of your television. Ensure the brackets are centered and level. Do not overtighten the screws.

## 5.4 Mounting the TV

1. **Lift TV:** With assistance, carefully lift the television and hook the TV brackets onto the arms of the wall plate assembly.
2. **Secure TV:** Once the TV is securely hooked, engage any safety locking mechanisms on the TV brackets to prevent accidental dislodgement.

## 6. OPERATING THE MOUNT

The ECHOGEAR MaxMotion mount offers full adjustability for optimal viewing.

### 6.1 Extension and Retraction

Gently pull the TV away from the wall to extend the mount up to 22 inches. Push the TV back towards the wall to retract it to a minimum distance of 2.4 inches from the wall.



Image: Visual representation of the mount's extension capability (up to 22 inches) and its slim profile when retracted (2.36 inches from the wall).

### 6.2 Swivel Adjustment

The mount allows for up to 130 degrees of swivel (65 degrees left or right, depending on TV size and wall position). Gently pivot the TV to achieve your desired viewing angle.



Image: A television mounted on the ECHOGEAR MaxMotion mount, demonstrating its ability to swivel up to 130 degrees for flexible viewing.

### 6.3 Tilt Adjustment

The mount features tool-free tilt adjustment, allowing you to tilt your TV up or down by up to 15 degrees to reduce glare or optimize viewing from different heights.



Image: Close-up of the mount's mechanism, highlighting the tool-free tilt function that allows for up to 15 degrees of vertical adjustment.

## 7. MAINTENANCE

Regular maintenance ensures the longevity and safe operation of your TV mount.

- **Periodic Inspection:** Periodically check all screws and bolts to ensure they remain tight. Retighten if necessary.
- **Cleaning:** Clean the mount with a soft, dry cloth. Avoid abrasive cleaners or solvents.
- **Movement:** Ensure the articulating arms move smoothly. If movement becomes stiff, check for obstructions or contact support.

## 8. TROUBLESHOOTING

If you encounter issues during or after installation, refer to the following common problems and solutions:



- **TV is not level:** The mount includes a post-installation leveling feature. Gently rotate the TV to adjust its horizontal alignment.
- **Mount feels loose:** Recheck all wall plate lag bolts and TV bracket screws. Ensure they are tightened securely according to the instructions. Do not overtighten.
- **Difficulty moving the TV:** Ensure no cables are snagged or obstructing movement. Check that the mount's arms are not binding.
- **Missing parts:** Do not proceed with installation. Contact ECHOGEAR customer support immediately for replacement parts.

## 9. SPECIFICATIONS

Feature	Specification
Model Number	EGLF2
Compatible TV Sizes	42" - 90"
Weight Capacity	Up to 125 lbs (56.7 kg)
Movement Type	Full Motion (Swivel, Tilt, Extension)
Extension from Wall	2.4" (retracted) to 22" (extended)
Swivel Angle	Up to 130° (65° left/right)
Tilt Angle	Up to 15°



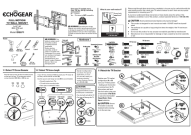
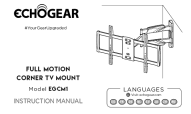
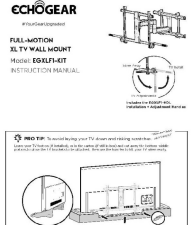

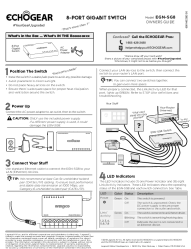
	<p><a href="#">ECHOGEAR EGLF1 Full-Motion TV Wall Mount Installation Guide</a></p> <p>Step-by-step instructions for installing the ECHOGEAR EGLF1 full-motion TV wall mount. Covers compatibility checks, required tools, hardware identification, and detailed assembly procedures for TVs ranging from 37 to 70 inches.</p>
	<p><a href="#">ECHOGEAR EGCM1 Full Motion Corner TV Mount - Instruction Manual</a></p> <p>This instruction manual provides detailed steps for installing and using the ECHOGEAR EGCM1 Full Motion Corner TV Mount. It includes safety warnings, required tools, parts list, step-by-step assembly instructions, adjustment guidance, and a placement chart for various TV sizes.</p>
	<p><a href="#">ECHOGEAR EGXLF1-KIT Full-Motion XL TV Wall Mount Installation Manual</a></p> <p>Detailed instructions for installing the ECHOGEAR EGXLF1-KIT Full-Motion XL TV Wall Mount. Covers safety, wall compatibility, parts, assembly steps, and adjustments for TVs up to 90 inches.</p>
	<p><a href="#">Echogear EGOS1 Outlet Shelf Instruction Manual</a></p> <p>This manual provides instructions for installing the Echogear EGOS1 Outlet Shelf, a device designed to hold electronics up to 10 lbs. It includes safety information, parts lists, and step-by-step assembly guides.</p>
	<p><a href="#">ECHOGEAR EGN-SG8 8-Port Gigabit Switch Owners Guide</a></p> <p>Official owners guide for the ECHOGEAR EGN-SG8 8-Port Gigabit Switch. Learn how to position, power up, connect your devices, and understand the LED indicators for optimal network performance.</p>

Documents - ECHOGEAR – EGLF2

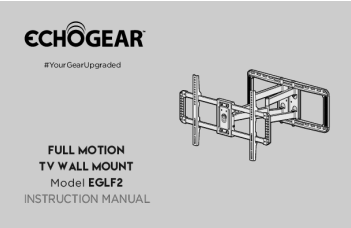

[\[pdf\]](#) User Manual Owner's Manual Installation Guide Instructions Accessories Installation Manual INSTRUCTION MANUAL TV Wall Mount Please read through these instructions completely to be sure you re comfortable with this easy install process Also check your owner s manual see if there Yea the boring stuff but it so don t jack things up! Instruction Important Safety Read are any special requirements for mounting D1dl9DUyqZS EGLF2 IM images na ssl amazon l echogear content installManuals

#YourGearUpgraded Full Motion TV Wall Mount Model**EGLF2** INSTRUCTION MANUAL IMPORTANT SAFETY INSTRUCTIONS. READ ENTIRE MANUAL PRIOR TO USE. SAVE These INSTRUCTIONS Yea, the boring stuff ... but read it, so you don t jack things up Please read through these instructions completely to be sure you ...

lang:en score:54 filesize: 14.37 M page\_count: 20 document date: 2017-04-03

[pdf] User Manual Owner's Manual Installation Guide Instructions Accessories

Full Motion TV Wall Mount Model EGLF2 INSTRUCTION MANUALIf you do not understand these instructions or have doubts about the safety of installation assembly use this product contact The Echogear Pros at 1 EGLF2 IMechogear content installManuals IM srsItid

AfmBOopgvu1EP2ee6NLNfkuEh76Nk38k FJNBqflbKsbOj OePGz MXd MANUALFull 1 This mounting system is intended for only with maximum weights indicated Use products heavier than may result in EGLF2 IMEGLF2 MXdechogear AfmBOopnW axy9FbBd jJRJfwF03EJ8SqUX01yrQ i5SUIxz7RX6mTwo in TV Page 2 125 lbs 56 6 kg If your weighs more mount NOT compatible Visit echogear to find a mountEGLF2 i5SUIxz7RX6mTwOechogear AfmBOooDrQuZ64dVpXzUI G9TVrqHrAlwriyok8M1RN GL8wtQHwIWKy mountPlease read through completely be sure re comfortable easy install process Also check owner s manual see if EGLF2 GL8wtQHwIWKyechogear AfmBOop14FfNsWrJX0PSBr QDn fr7 icG8tbuXMUFoSj6oJvdu7y7EP if REMOVE YOUR Remove screws S and bracket clips B then lift up off wall plate arm 13 01 I M FREEEEEE!! HEAVY! You may EGLF2 icG8tbuXMUFoSj6oJvdu7y7EPEchogear

AfmBOorGd4msMu5BmG9DWSJCWJPMdcqxnwvruQhLS2TQnk2VIB9AKssa may Full a EGLF2 AfmBOorGd4msMu5BmG9DWSJCWJPMdcqxnwvruQhLS2TQnk2VIB9AKssaechogear AfmBOoopxPMb9tgzGagc8EFWcEEYkMq6y8ENionH8Za2WO d1IvdgPtL a Remove ECHOGEAR logo are trademarks Milestone Made in China EGLF2 d1IvdgPtLechogear AfmBOooWLQnjTDgC pLzgU7zqnIKKvg4K 1yR9IV8HNuJgandRP5h4UQ MANUALInstallation ManualIf China Amazon MaxMotion Large TVs 42 90 Has Smooth Swivel Tilt Extension Universal Design Works Samsung Vizio More Includes Hardware Drill Template ElectronicsEGLF2 IMD1dI9DUyqZSechogear 1yR9IV8HNuJgandRP5h4UQm media amazon images D1dI9DUyqZS ref dp quick view ManualINSTRUCTION viewechogear

AfmBOopeUm1VqMJKdpQes9yTUho8DrY9LgRhuTwjo9Zeukem5WNNKqfFC MANUALINSTRUCTION AfmBOopeUm1VqMJKdpQes9yTUho8DrY9LgRhuTwjo9Zeukem5WNNKqfFCechogear AfmBOooyUgoWXu3L1HW1jHPGB gYOvA M0Niu g MpCwpU1JRgbiLPc AfmBOopWuJ7Rxbr BI3noLP xYxtEffgWDQWlx1v32tHpPA34f0yhs8Gechogear AfmBOorrBjpHqIQKxtUxwynfpPyPLdSlnI7umOHwStWqP Q44L0zyqXechogear MpCwpU1JRgbiLPcechogear AfmBOoqap9qbP7ah1t 8 vYj mjOVqpJQRdPueNgvX QlqXtSNF5BgyU AfmBOoqf8Ev3VtoPLHC1aGJOFOAiJbaVX4c gXiZ1lsXCLZh96n GOSYechogear China Do on drywall alone including accessories cannot exceed must support five times combined weightAmazon 1yR9IV8HNuJgandRP5h4UQechogear AfmBOoqD2IOOgjGcAFytepstOM2zPHQneMNSyZglkVzXwgtrWTqp9R96m QlqXtSNF5BgyUechogear AfmBOoqPu6Do WkM5jdGDccyteiKRk UjXSwZ8DggrcJjM0wmqHpWfp |||

#YourGearUpgraded Full Motion TV Wall Mount Model**EGLF2** INSTRUCTION MANUAL IMPORTANT SAFETY INSTRUCTIONS. READ ENTIRE MANUAL PRIOR TO USE. SAVE These INSTRUCTIONS Yea, the boring stuff ... but read it, so you don t jack things up Please read through these instructions completely to be sure you ...

lang:en score:38 filesize: 14.37 M page\_count: 20 document date: 2017-04-03

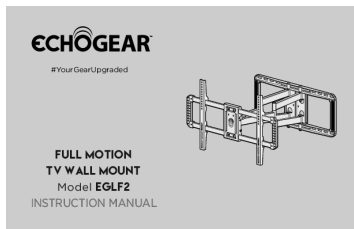





### Full Motion TV Mount for TVs up to 80"

Upgrade your viewing experience with 22" of extension, 130° of swivel, and 15° of tilt.





Size Range: 42"-80"  
Weight Capacity: 125 lbs  
Swivel: 130°  
Tilt: +/- 15 degrees  
Extension: 22"  
Min. Distance from Wall: 2.4"  
VESA Compatibility: 200x100 - 600x400  
Warranty Length: 5 Years  
Price: \$99.99

#### About the EGLF2

- We never skip leg day. Our heavy-gauge steel is strong enough to support TV screens up to 125 lbs.
- Pull your TV out 22" away from the wall for ultimate viewing. Place back 2.4" from the wall for the real slim shady look. Become the ultimate pro. We believe.
- With up to 130° of swivel, you can watch your TV from anywhere in the room. Or swivel it away from Todd, he's been annoying lately.
- Window glare bugging you? 15-degree tilt capability makes adjustments easy. No tools, no fuss, no hands. Just watching, you'll need your hands.

#### NOT GOOD WITH PUZZLES? HANG WITH US.

Simple brackets in a snap. New. No templates. No crumpled paper. No tools.



1. Attach brackets to your TV



2. Mount the wall plate



3. Connect TV to wall plate

[pdf] Warranty

Full Motion TV Mount for TVs up to 80 ECHOGEAR Our Pros are here help 7 days a week Call 1 855 428 2490 or visit Follow us @echogear Wall EGLF2 Echogear FactSheet echogear content factsheets We never skip leg day heavy gauge steel is strong enough support screens 125 lbs Pull your out 22 away from the wall ultimate

Full Motion TV Mount for TVs up to 80 Upgrade your viewing experience with 22 of extension, 130 of ... ocabulary. Now you can adjust your TV for the best view from any seat in the room. Tilt, About the **EGLF2** tend your TV out from the wall with ease, just point your TV exactly where you want from ligh...

lang:en score:36 filesize: 3.04 M page\_count: 2 document date: 2018-02-21

[\[pdf\]](#) Warranty

Full Motion TV Mount for TVs up to 80 ECHOGEAROur heavy gauge steel is strong enough support  
screens 125 lbs Pull your out 22 away from the wall ultimate viewing Place back 2 4 from Echogear  
FactSheet EGLF2echogear content factsheets Echogear EGLF2 srsltid AfrmBOorh4XAsr4f  
XjhOI8jNWLHHUPS2X8e5igAGtqQCK7cpl3xNXfVB ECHOGEARFull from Our EGLF2Echogear  
XjhOI8jNWLHHUPS2X8e5igAGtqQCK7cpl3xNXfVBechogear AfrmBOopey qZezV4ZvjyRN1Yxb W  
piLWWeH7IsfphvYc3Vyw84r8KjM piLWWeH7IsfphvYc3Vyw84r8KjMechogear AfrmBOoo3  
no7EA1UG26eYrvsdNuDGUGgubeLsHy4GTIxYKO64a23bioq  
no7EA1UG26eYrvsdNuDGUGgubeLsHy4GTIxYKO64a23bioqechogear AfrmBOoqZBD4cM6hhCw  
RrUtKzjaByBjIhR r9HV0Ghn8LgQZ2mozNy0J r9HV0Ghn8LgQZ2mozNy0Jechogear AfrmBOoo5Y  
DZD8w1Vjs6WOJ6cf3ziWAGjSWhKHLjtzvoqihzcK2CgaR AfrmBOoo2 jKfozP7UqlsaAYSzyafXuKEgEFil  
pPUBIC4JCX4RZPPsSCechogear DZD8w1Vjs6WOJ6cf3ziWAGjSWhKHLjtzvoqihzcK2CgaRechogear  
AfrmBOoqeJ1ya7ysYeYLFpTjIH6mKSWwkZsEPvPLamAAf9 VWFPOkuoxst AfrmBOoo2mh4mitayz2Wt  
r67wXGPSPVqLfmZbRbqWtvWTRCkbWBt1tzXechogear VWFPOkuoxtechogear



Full Motion TV Mount  
for TVs up to 80"

Upgrade your viewing experience with 22" of extension, 130° of swivel, and 15° of tilt.

**ECHOGEAR**  
YOUR LIFE. UPGRADED.

Size Range	42"-80"
Weight Capacity	125 lbs
Swivel	130°
Tilt	±15 degrees
Extension	22"
Min. Distance from Wall	2.4"
VESA compatibility	200x100 - 600x400
Warranty Length	5 years
Price	\$199.99

**About the EGLF2**

- We never sleep big day. Our heavy gauge steel is strong enough to support TV screens up to 125 lbs.
- Pull your TV out 22" away from the wall for ultimate viewing. Place back 2.4" from the wall for the rear slim study look. Recline the ultimate you, too, please.
- With up to 130° of swivel, you can watch your TV from anywhere in the room. Or, swivel it away from kids' messes, annoying lights.
- Window glare bugging you? 15-degree tilt capability makes adjustments easy. No tools, no fuss, no hands. Just looking, you'll need your hands.

**NOT GOOD WITH PUZZLES? HANG WITH US.**



AfrmBOorqAWh4uXPomglORX IPwkuWJCprgHxndOLOZg2 a3VQi0vIR2I a3VQi0vIR2Iechogear  
AfrmBOopyAdALtrl6LxvZCKxkd6f2nuHChm9ZbJ0qlaoR1a2xVeY1Z0L EGLF2v1echogear  
AfrmBOopyAdALtrl6LxvZCKxkd6f2nuHChm9ZbJ0qlaoR1a2xVeY1Z0Lechogear AfrmBOopr23AFN JEP  
7JHzeI6GfBeMAuGuhTdUIN37d4coyJCLndX6AG EGLF2v1Echogear  
7JHzeI6GfBeMAuGuhTdUIN37d4coyJCLndX6AGechogear AfrmBOoqUTsliDSQgF9p8tBB PBrk5d  
TW0xKiOYwL1 q9uJW OVPI7s AfrmBOooZOOfk2exJwnBn  
VRhGCQD6EMILK2en26sSXjZZWs4RgMdnHctechogear AfrmBOorDR r3W8RgpZRMjiO5  
4agz9BQq5wJZyL0VeZc3i2M1A7UwYJ2echogear OVPI7sechogear  
AfrmBOorgQiBh0AeNHhfHiqqkwJ5mGBJS43IBKB7a wymerciX9xp3Xnq AfrmBOopjlc kTRPixIX5L5dau  
3QbwC IM1x4YjEg543cCtA2Vf1KfCQechogear wymerciX9xp3Xnqechogear AfrmBOopvq wTyAwZGk8  
84fd8f4oo3BRyfhPvPjhFP4rVLU9N0X3fk23 84fd8f4oo3BRyfhPvPjhFP4rVLU9N0X3fk23echogear  
AfrmBOorXxNcQtVokLxz5Z7lv48bcRpoJUtdmMCYpq7 DmtMgVRJAtd DF DFechogear AfrmBOor  
SVp6SyizOgCcn7JY6hauvtPDho1MjsNNWGeAf 7 Vqe32tbl  
AfrmBOoqA3Qwn980My6V1TUqDmL9mVvwEyLjJNPdFbj7rxyT MWns pUCechogear  
AfrmBOoozW7Xp3Xcrr hdAwMzJxLzgQTz3yrU5jDI5vjmXehA5XuE6gN7echogear Vqe32tbllechogear  
AfrmBOorMRA ZXGkTlz mxbnrg22Z2QrdqR WbhQCiy3 aDRhccUFO7DC aDRhccUFO7DCEchogear  
AfrmBOor1jxorg6757FBq9yoDZWfmKaa1MCoxoCOjO278 MF5S9 uREci uREciechogear  
AfrmBOoqLFHharVVA0QAQDKFfNLEWYJ26KhT1AO6snxu0QWmPgHJKTsgm  
AfrmBOoqLFHharVVA0QAQDKFfNLEWYJ26KhT1AO6snxu0QWmPgHJKTsgmechogear  
AfrmBOop6W6SZMwOmG1N1hDPnZVastdHKfg9koRzFSub9Vyv3mGsjRRqL AfrmBOorpG8GNQGuJ 6u  
mssInn PbfDGfivIfiCLnne8IDK0afnOEVCechogear |||

Full Motion TV Mount for TVs up to 80 Upgrade your viewing experience with 22 of  
extension, 130 of ... ocabulary. Now you can adjust your TV for the best view from  
any seat in the room. Tilt, About the **EGLF2** tend your TV out from the wall with ease,  
just point your TV exactly where you want from ligh...

lang:en score:29 filesize: 3.04 M page\_count: 2 document date: 2018-02-21

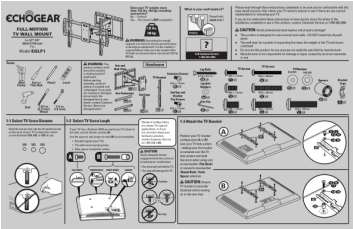

[ECHOGEAR EGLF1 Full-Motion TV Wall Mount Installation Guide](#)

Step-by-step instructions for installing the ECHOGEAR EGLF1 full-motion TV wall  
mount. Covers compatibility checks, required tools, hardware identification, and  
detailed assembly procedures for TVs ranging from 37 to 70 inches.

lang:en score:21 filesize: 3.58 M page\_count: 2 document date: 2015-06-10

[pdf] Confidentiality Request Letter

6805 002261 00 MILESTONE givenp01 MLS0205201520 3 D LARGE FULL MOTION m media amazon

7 87 200 0 23 62 600 15 75 400 94 100 33 8 5 9 228 193 209 35 16 406 4 24 609 6 93 430 10 37 263 26

61 676 29 63 752 A1lwEh7fiL images I TV INTERFACE WALL PLATE FULLY ECHOGEAR THE

INFORMATION AND DESIGNS CONTAINED IN THIS DRAWING ARE CONFIDENTIAL PROPRIETARY

PROPERTY OF AV TECHNOLOGIES NEITHER DESIGN NOR EGLF2 TechDrawing echogear content

technicalDrawings Echogear na ssl

67 786 MW 02/07/2017 - REV 00 - PENDING APPROVAL ON ECO 500015140 TV

INTERFACE 7.87 200.0 0.33 8.5 3-D 15.75 400.0 23.62 600.0 WALL PLATE 0.35 9.0

8.23 209.0 3.94 100.0 LARGE FULL MOTION 6805-002261 d,/E KZDd/KEE / E

KEd/E/Ed,/ Zt/E Z KE /Ed/ Ed,WZKWZ/dZzWZKWZdzK D/ dKEs d,EK K / E/d,Zd,...

lang:i-klinton score:10 filesize: 1.1 M page\_count: 1 document date: 2017-07-27

