



Manuals.plus /

› LAVIEVERT /

› Lavievert 1500 Piece Jigsaw Puzzle Board and Portable Case Instruction Manual

## LAVIEVERT WGPTB001

# Lavievert 1500 Piece Jigsaw Puzzle Board and Portable Case Instruction Manual

Brand: LAVIEVERT | Model: WGPTB001

## 1. INTRODUCTION

This manual provides instructions for the assembly, use, and care of your Lavievert 1500 Piece Jigsaw Puzzle Board and Portable Case. Please read this manual thoroughly before using the product to ensure proper operation and longevity.

## 2. PRODUCT FEATURES

- **Premium Quality Material:** Constructed from high-quality oxford cloth and flannelette, offering a lighter alternative to traditional wooden storage racks. The soft interior padding protects unfinished puzzles.
- **Special Interlayer Design:** Features six uniquely designed trays for sorting and organizing unfinished puzzles. Six slots on the back securely hold these trays. Velcro closures allow for space-saving storage of trays when not in use.
- **Detachable Main Compartment:** The second layer functions as an independent puzzle plateau that can be removed. A clear card slot on the back allows for labeling, aiding in distinguishing between different puzzles or users.
- **Bonus 2 Storage Straps:** Two straps with velcro closures are included to secure finished puzzles, preventing them from breaking apart during storage or transport.
- **Portable Handle Design:** Equipped with convenient handles for easy transport, making it suitable for use at home, in the car, or during outdoor activities.



*Image 1: The Lavievert puzzle board opened, showing a partially completed puzzle and two sorting trays in use.*

### 3. SETUP

1. **Unpack the Case:** Carefully remove the puzzle board and accessories from its packaging.
2. **Open the Case:** Unzip the main case completely. The case will unfold to reveal the main puzzle working surface.
3. **Detachable Board:** The central puzzle plateau can be detached from the main case for independent use. Gently lift it from its position.
4. **Prepare Sorting Trays:** The six sorting trays are stored flat. To form a tray, snap the buttons on all four corners together. These trays can be used for sorting puzzle pieces by color, shape, or section.



*Image 2: The detachable main puzzle board being removed from the case.*

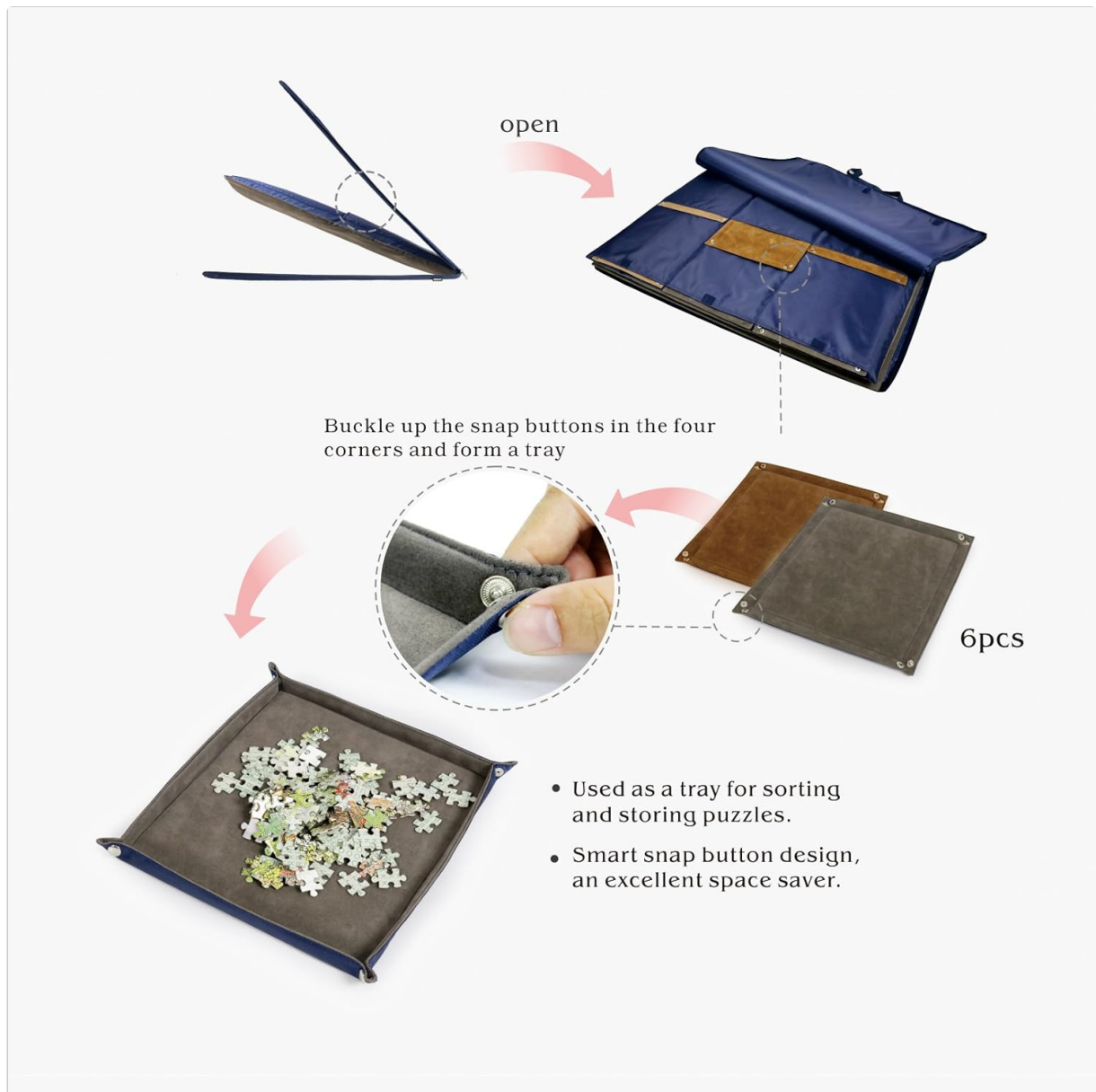

Image 3: Visual guide on how to assemble the sorting trays by snapping the corner buttons.

## 4. OPERATING INSTRUCTIONS

1. **Start Your Puzzle:** Place your puzzle pieces on the main felt-lined board. The non-slip surface helps keep pieces in place.
2. **Sorting Pieces:** Use the six sorting trays to organize your puzzle pieces. You can sort by edge pieces, colors, or specific patterns. The trays can be placed around the main board or stored in their designated slots.
3. **Storing Unfinished Puzzles:** When you need to pause your puzzle, ensure all pieces are within the boundaries of the main board. Place the padded cover over the puzzle. Zip the case securely. The padded cover and secure zipper prevent pieces from shifting or falling out.
4. **Transporting the Puzzle:** Use the integrated handles to carry the closed puzzle case. For longer-term storage or transport, utilize the two bonus velcro straps to further secure the case.



*Image 4: A user actively sorting puzzle pieces on the main board, utilizing the sorting trays.*



**Bonus velcro-closing straps help to store finished puzzles.**

*Image 5: Close-up of a hand placing puzzle pieces into a sorting tray, highlighting the zippered pocket for secure storage.*



*Image 6: The included velcro straps used to secure multiple finished puzzle boards together for compact storage.*

Your browser does not support the video tag.

*Video 1: Official Lavievert product video demonstrating the features and use of the puzzle case, including its portability and sorting trays.*

## 5. MAINTENANCE

- **Cleaning the Surface:** The felt surface of the main board and trays can be gently cleaned with a lint roller or a soft, damp cloth to remove dust or small debris. Avoid harsh chemicals.
- **Case Exterior:** Wipe the oxford cloth exterior with a damp cloth as needed.
- **Storage:** Store the puzzle case in a dry place away from direct sunlight to prevent material degradation.

## 6. TROUBLESHOOTING

Problem	Possible Cause	Solution
Puzzle pieces shifting inside the closed case.	Case not fully zipped or padded cover not properly aligned.	Ensure the case is fully zipped and the padded cover is flat against the puzzle surface before closing. Use the velcro straps for added security if transporting.
Sorting trays not holding shape.	Corner buttons not securely snapped.	Press firmly on each corner button until it clicks into place.
Difficulty zipping the case.	Material caught in zipper or overfilled case.	Ensure no fabric is caught in the zipper. Do not overfill the case with excessive puzzle pieces or other items. Zip slowly and carefully.

## 7. SPECIFICATIONS

---

- **Product Dimensions:** 26 x 26.34 x 0.04 inches
- **Item Weight:** 7.22 pounds
- **Model Number:** WGPTB001
- **Manufacturer:** Lavievert
- **Recommended Age:** 12 years and up
- **Puzzle Capacity:** Up to 1500 pieces

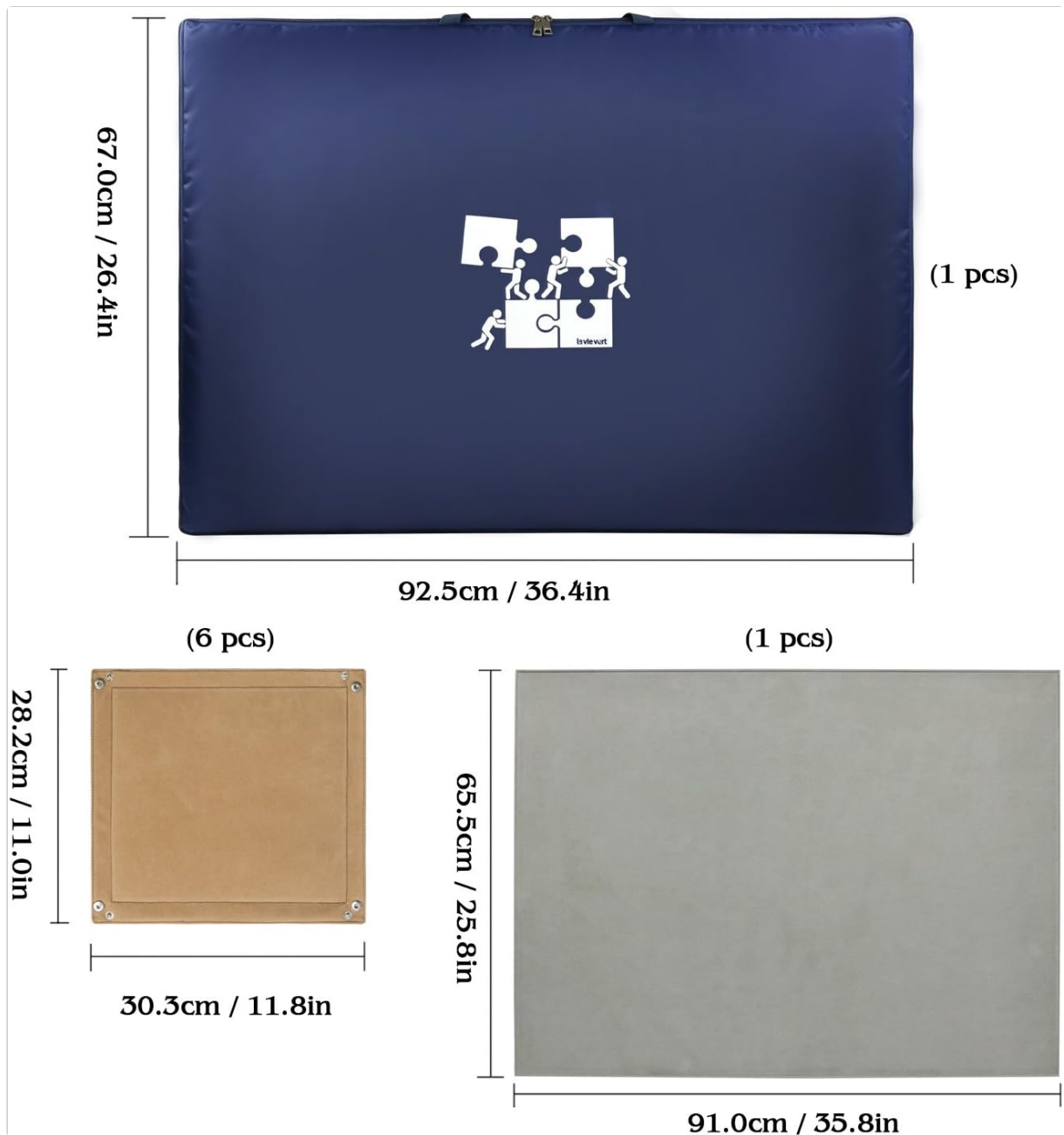

Image 7: Detailed dimensions of the puzzle board and individual sorting trays.

## 8. WARRANTY AND SUPPORT

For warranty information or product support, please refer to the contact details provided with your purchase or visit the official Lavievert website. Keep your purchase receipt for warranty claims.

For additional assistance, you may contact Lavievert customer service directly.