

SEBSON BWM_ALARM_B

SEBSON Motion Detector and Chime Instruction Manual

Model: BWM_ALARM_B

1. INTRODUCTION

This manual provides essential information for the proper installation, operation, and maintenance of your SEBSON Motion Detector and Chime. Please read these instructions carefully before using the device to ensure safe and efficient performance. This device is designed to detect movement and provide an audible alert, functioning as both a motion alarm and a passage chime.

2. SAFETY INFORMATION

- Ensure the device is installed in a dry environment, as it has an IP20 protection rating, meaning it is not protected against water.
- Do not expose the device to extreme temperatures or direct sunlight.
- Keep out of reach of children.
- Only use the specified 9V E-Block battery type.
- Dispose of batteries responsibly according to local regulations.

3. PACKAGE CONTENTS

- 1 x SEBSON Motion Detector and Chime (Model BWM_ALARM_B)
- Mounting bracket
- Mounting hardware (screws, wall plugs)
- *Note: 1x 9V E-Block battery is required and not included.*

4. PRODUCT OVERVIEW

The SEBSON Motion Detector and Chime is a compact, battery-powered device designed for versatile use. It features a passive infrared (PIR) sensor to detect movement and offers two distinct audible alert modes: a

chime for passage detection and an alarm for security purposes.



Figure 1: Front view of the SEBSON Motion Detector and Chime.



Figure 2: Front view of the device, highlighting the SEBSON brand logo.



Figure 3: Rear view of the motion detector, illustrating the integrated mounting bracket.

5. SETUP

5.1 Battery Installation

1. Gently slide open the battery compartment cover located on the back of the device.
2. Insert one 9V E-Block battery, ensuring correct polarity (+/-).
3. Close the battery compartment cover securely.

5.2 Mounting the Device

The device can be mounted on a wall using the provided bracket and hardware.

1. Choose a suitable location for installation. Consider the desired detection area and ensure the sensor has an unobstructed view.
2. Detach the mounting bracket from the main unit if it is not already separate.
3. Mark the positions for drilling holes on the wall using the bracket as a template.
4. Drill the holes and insert the wall plugs.
5. Secure the mounting bracket to the wall using the provided screws.
6. Attach the motion detector unit to the mounted bracket. The sensor housing can pivot 360 degrees within the bracket to adjust the detection angle.

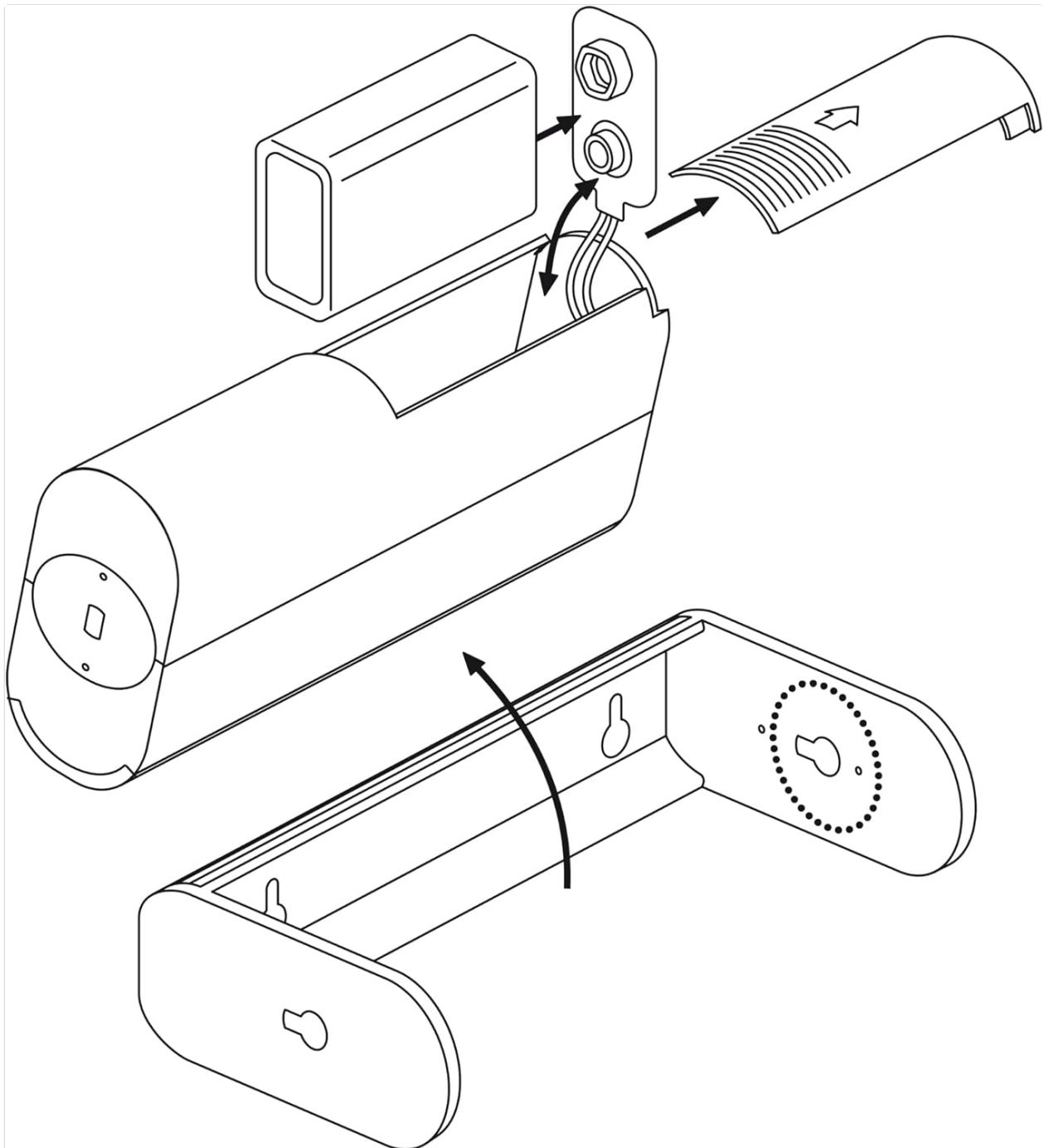

Figure 4: Illustration of battery insertion and how the device attaches to the wall-mounted bracket.

6. OPERATING INSTRUCTIONS

6.1 Mode Selection

The device features a three-position switch for selecting the operating mode:

- **CHIME:** In this mode, the device emits a short chime sound when motion is detected. This is suitable for use as a passage detector in shops or offices.
- **OFF:** The device is turned off and will not detect motion or emit any sound.
- **ALARM:** In this mode, the device emits a loud alarm sound (approximately 70dB) when motion is detected. This is suitable for security purposes.

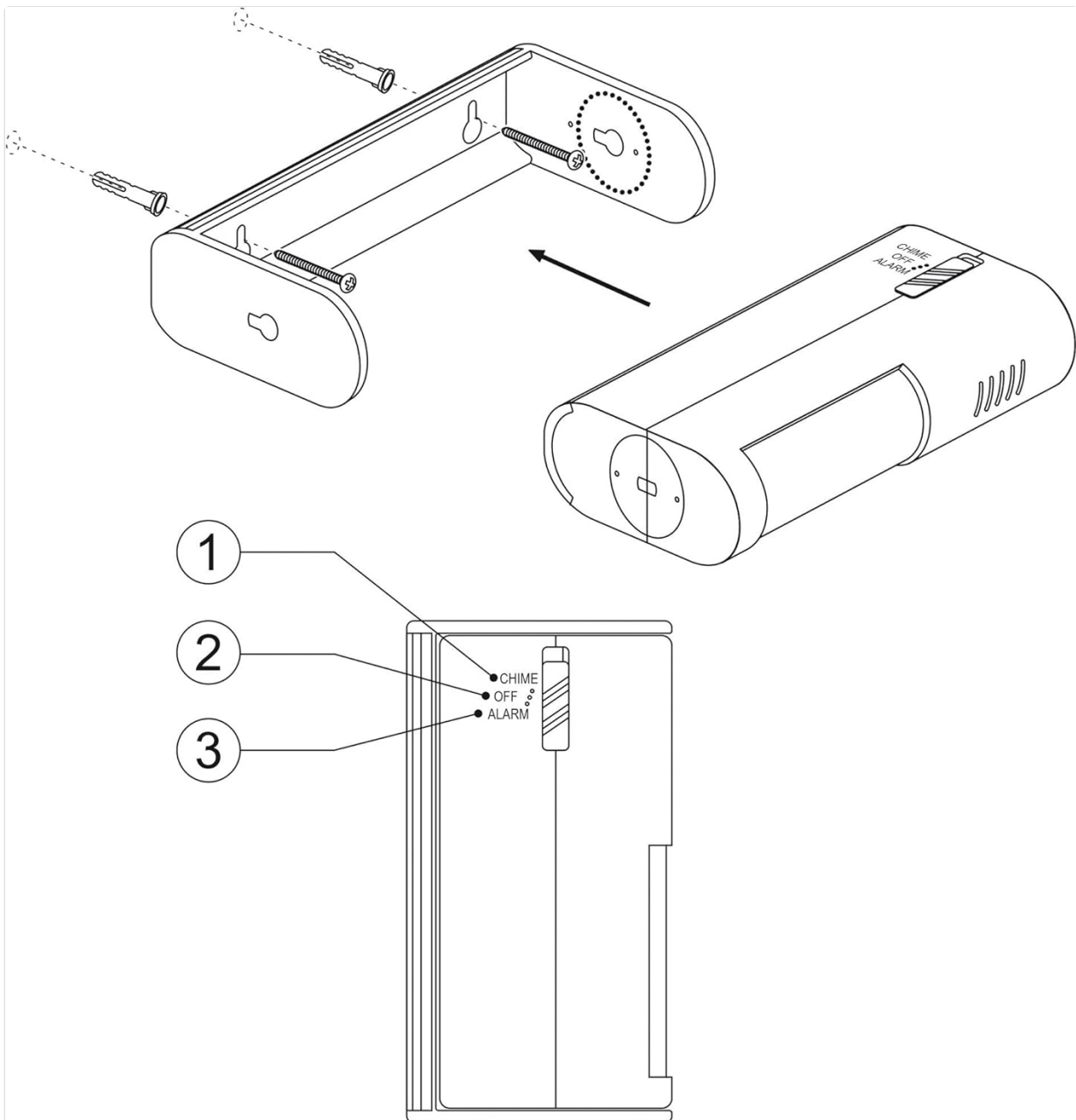

Figure 5: Detailed view of the mode selection switch (1: Chime, 2: Off, 3: Alarm).

6.2 Detection Area

The motion detector has a detection range of up to 8 meters and a detection angle of 60 degrees. For optimal performance, position the device to cover the desired area without obstructions.

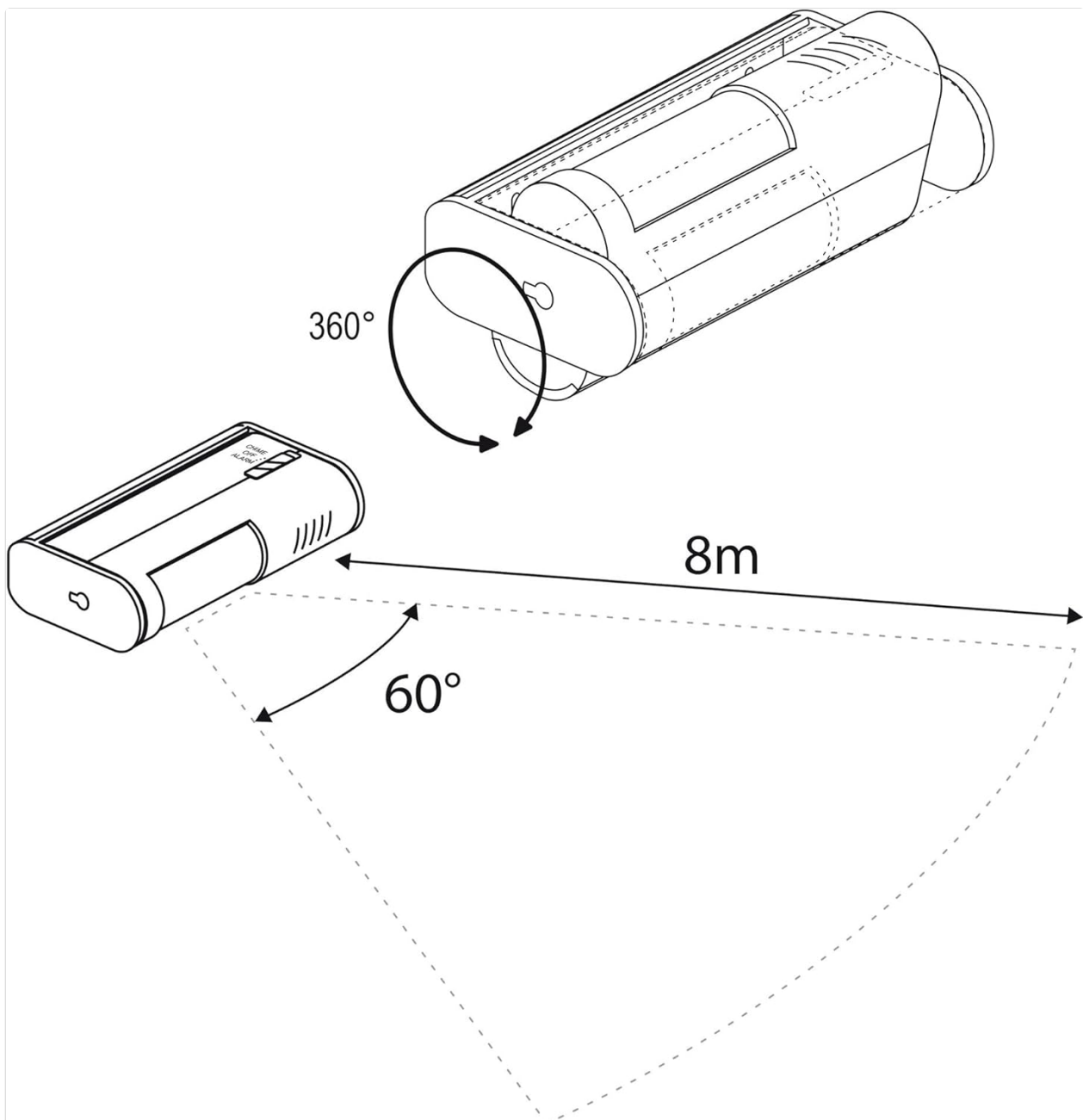

Figure 6: Diagram showing the detection range (8m) and angle (60°), along with the 360° rotational capability of the sensor head.

7. MAINTENANCE

7.1 Battery Replacement

When the sound becomes weak or the device stops responding, it is time to replace the 9V E-Block battery. Follow the battery installation steps in Section 5.1.

7.2 Cleaning

To clean the device, use a soft, dry cloth. Do not use abrasive cleaners or solvents, as these may damage the surface or internal components. Ensure no moisture enters the device.

8. TROUBLESHOOTING

- Device not detecting motion:

- Check if the battery is correctly installed and has sufficient power. Replace if necessary.
 - Ensure the device is not in the "OFF" position.
 - Verify that the detection area is clear of obstructions.
 - Adjust the angle of the sensor to cover the desired area.
- **No sound or weak sound:**
 - Replace the 9V battery.
 - Ensure the device is not in the "OFF" position.
 - **False alarms:**
 - Reposition the device to avoid areas with rapid temperature changes (e.g., near heaters, air conditioners) or moving objects (e.g., curtains near a window).
 - Ensure the detection area is free from small animals if not intended to detect them.

9. SPECIFICATIONS

Feature	Specification
Model	BWM_ALARM_B
Power Supply	1x 9V DC E-Block Battery (not included)
Detection Range	Up to 8 meters
Detection Angle	60 degrees
Sensor Rotation	360 degrees (within bracket)
Alarm Volume	Approx. 70dB
Protection Rating	IP20
Product Dimensions (L x W x H)	70 x 190 x 34 mm
Weight	160 grams
Operating Temperature	40 Degrees Celsius
Mounting Type	Wall Mount

10. WARRANTY AND SUPPORT

For warranty information and technical support, please refer to the documentation provided with your purchase or visit the official SEBSON website. Keep your proof of purchase for any warranty claims.

