

WINCHMAX WMMP2_COMPACT

WINCHMAX Winch Mounting Plate Instruction Manual

Model: WMMP2_COMPACT

1. PRODUCT OVERVIEW

The WINCHMAX Compact Winch Mounting Plate is a heavy-duty accessory designed for the quick and easy installation of WINCHMAX brand winches up to 13,500lb, or any other low-profile winch adhering to a standard 254mm x 114.3mm (10" x 4.5") bolt pattern. This versatile plate is ideal for recovery trucks, recovery trailers, flatbed applications, or as a foundation for custom 4x4 mounting solutions.

Key features include:

- Heavy-duty construction specifically for WINCHMAX winches up to 13,500lb.
- Compatible with standard 254mm x 114.3mm (10" x 4.5") winch bolt patterns.
- Dimensions: 580mm (length) x 180mm (width) x 100mm (height).
- Black powder-coated finish for excellent corrosion resistance.
- Pre-drilled holes for winch and roller fairlead mounting.
- Manufactured in the UK.



Figure 1: The WINCHMAX Compact Winch Mounting Plate, showcasing its robust black powder-coated finish and pre-drilled holes for winch and fairlead attachment.

2. SAFETY INFORMATION

Always prioritize safety when installing or working with heavy equipment. Failure to follow these guidelines may result in injury or damage to property.

- Ensure all mounting surfaces are structurally sound and capable of supporting the combined weight of the winch, mounting plate, and maximum load.
- Use appropriate personal protective equipment (PPE) such as safety glasses, gloves, and steel-toed boots during installation.
- Verify that all bolts, nuts, and washers are correctly sized, tightened to the manufacturer's specifications, and secured.
- Do not modify the mounting plate. Any alterations may compromise its structural integrity and void the warranty.
- Keep hands and clothing clear of moving parts during winch operation.
- If unsure about any step of the installation process, consult a qualified professional.

3. COMPONENTS AND PACKAGE CONTENTS

Your WINCHMAX Compact Winch Mounting Plate package should contain the following items:

- 1 x WINCHMAX Compact Winch Mounting Plate (WMMP2_COMPACT)
- 1 x Set of mounting hardware (bolts, nuts, washers)



Figure 2: Included mounting hardware, consisting of various bolts, nuts, and washers necessary for securing the winch and fairlead to the plate.

4. SETUP AND INSTALLATION

This section outlines the general steps for installing the WINCHMAX Compact Winch Mounting Plate. Specific vehicle or application requirements may vary.

4.1 Pre-Installation Checks

- Confirm the mounting location on your vehicle or trailer is flat, stable, and has sufficient clearance for the winch and fairlead.
- Ensure the mounting surface can safely bear the load of the winch and the forces exerted during recovery operations.
- Verify that your winch's bolt pattern matches the standard 254mm x 114.3mm (10" x 4.5") pattern of the plate.

4.2 Mounting the Plate

1. Position the WINCHMAX mounting plate on your desired surface. Mark and drill any necessary holes for securing the plate to your vehicle/trailer, if not already present.
2. Secure the mounting plate firmly using appropriate high-strength fasteners (not included, as these depend on your specific application).

4.3 Mounting the Winch and Fairlead

1. Place your winch onto the mounting plate, aligning its bolt holes with the pre-drilled holes on the plate.
2. Insert the appropriate bolts (typically M10 or 3/8") through the winch feet and the plate. Secure with washers and nuts from underneath. Refer to Figure 4 for an exploded view.
3. Position the roller fairlead (if applicable) onto the front of the mounting plate, aligning its bolt holes with the pre-drilled holes.
4. Secure the fairlead using the provided bolts, washers, and nuts.
5. Ensure all fasteners are tightened securely according to the winch and fairlead manufacturer's torque specifications.

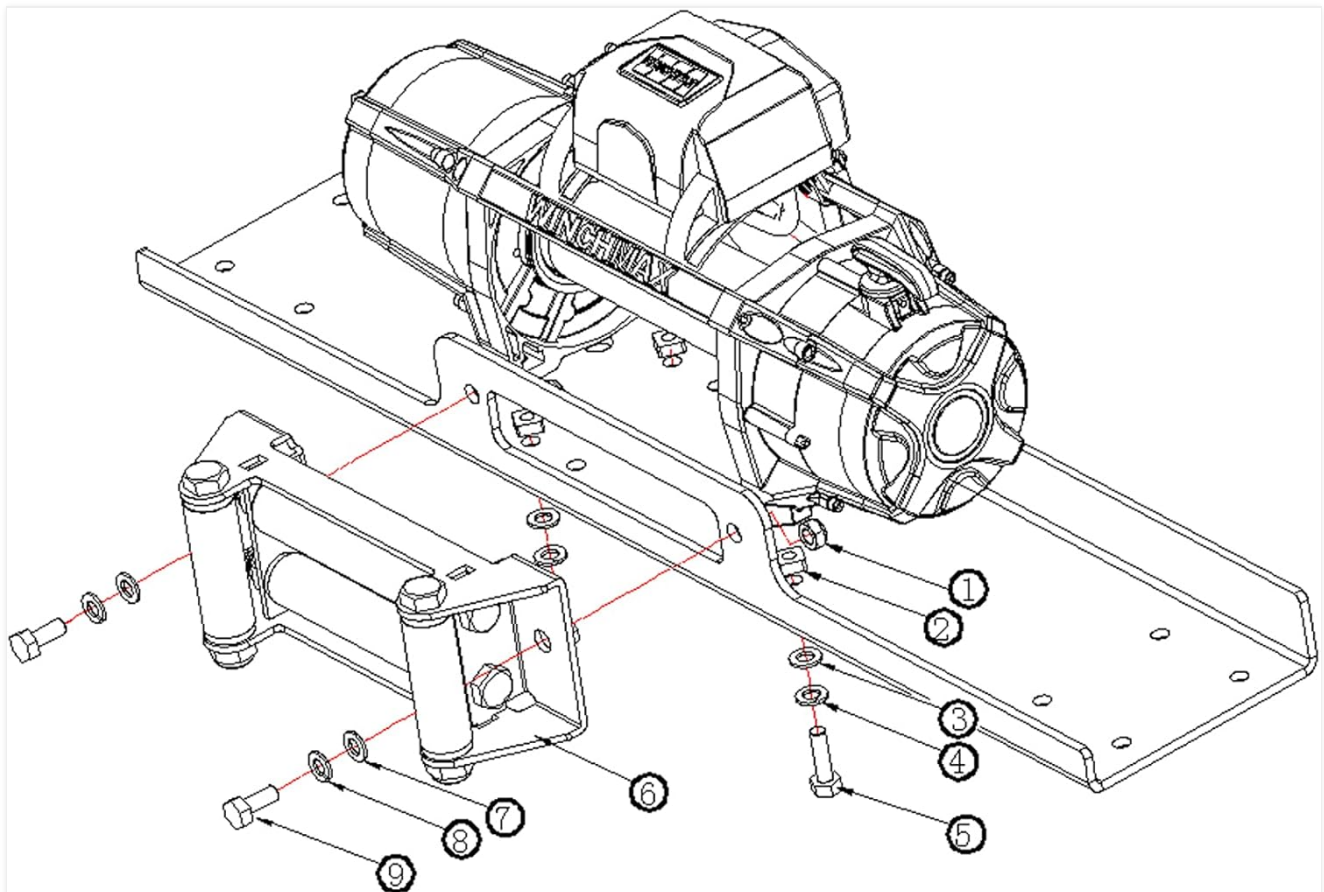

Figure 3: Exploded view illustrating the assembly of a winch and roller fairlead onto the WINCHMAX mounting plate. Numbers

indicate typical fastener locations.

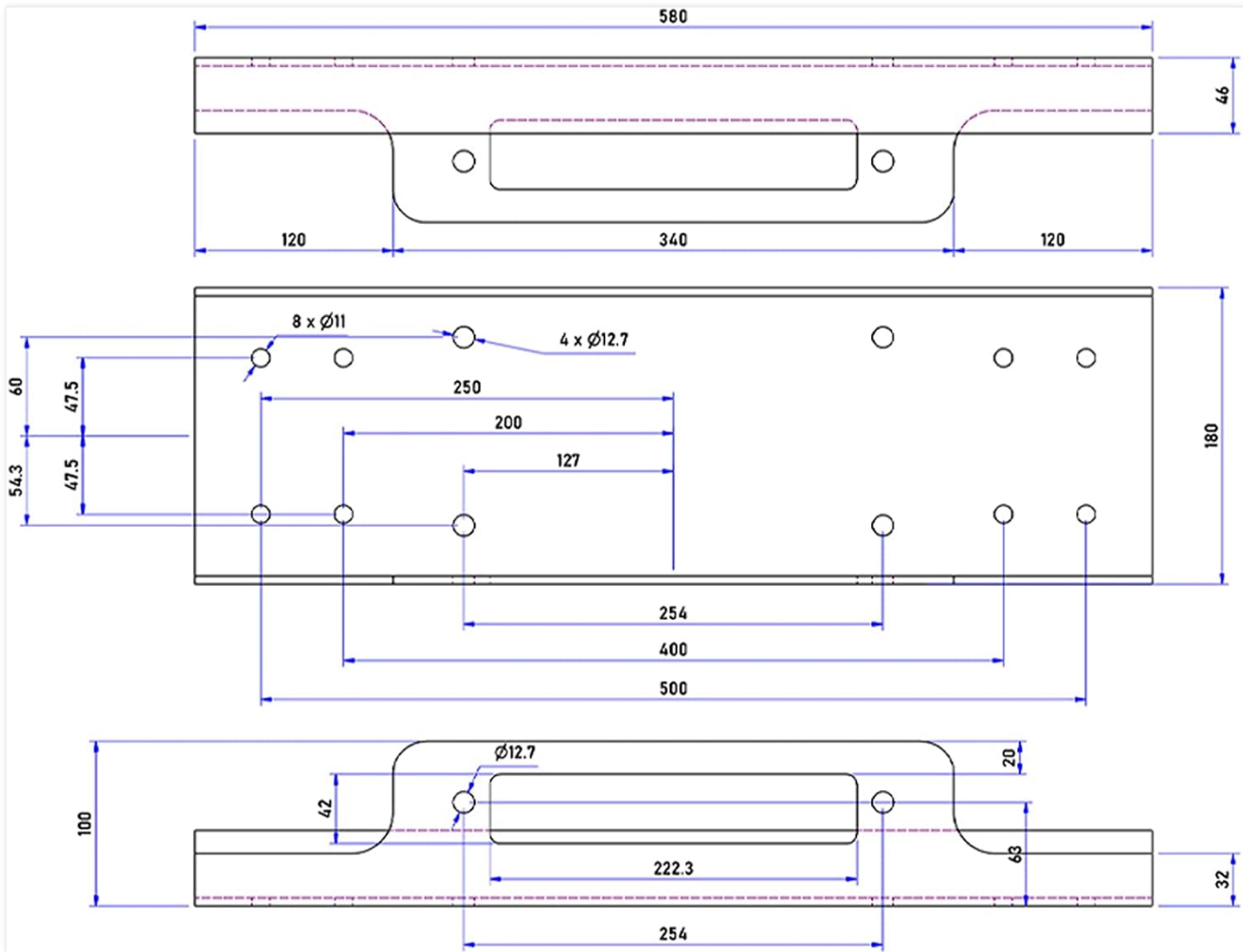

Figure 4: Technical drawing providing detailed dimensions and bolt hole patterns for the WINCHMAX Compact Winch Mounting Plate. All dimensions are in millimeters.

5. OPERATION

The WINCHMAX Compact Winch Mounting Plate serves as a secure and stable base for your winch. Once installed, the operation of the winch itself will follow the manufacturer's instructions provided with your specific winch model. This mounting plate ensures that the winch is held firmly in place during all winching operations, distributing the load effectively across the mounting surface.

Always refer to your winch's user manual for proper operating procedures, load limits, and safety precautions.

6. MAINTENANCE

Regular maintenance of your WINCHMAX Compact Winch Mounting Plate will ensure its longevity and continued performance.

- **Inspection:** Periodically inspect the mounting plate for any signs of damage, cracks, or deformation, especially after heavy use.
- **Fasteners:** Check all bolts, nuts, and washers securing the winch and the plate to its mounting surface. Retighten any loose fasteners to prevent movement and wear.
- **Corrosion:** Although the plate is powder-coated for corrosion resistance, inspect for any chips or scratches in the coating that could expose bare metal. Touch up any damaged areas with appropriate rust-inhibiting paint to prevent corrosion.
- **Cleaning:** Clean the plate regularly to remove dirt, mud, salt, or other corrosive substances. Use mild soap

and water, then rinse thoroughly and dry.

7. TROUBLESHOOTING

This section addresses common issues related to the mounting plate itself. For winch-specific issues, refer to your winch’s manual.

Problem	Possible Cause	Solution
Winch feels loose on the plate.	Loose mounting bolts.	Check and re-tighten all winch mounting bolts to specified torque.
Plate is rattling or moving.	Plate not securely fastened to vehicle/trailer.	Inspect and tighten all fasteners securing the plate to its mounting surface. Ensure the mounting surface is rigid.
Corrosion appearing on plate.	Damage to powder coating; exposure to harsh elements.	Clean affected area, sand lightly, and apply rust-inhibiting primer and paint. Regular cleaning helps prevent this.

8. SPECIFICATIONS

Attribute	Value
Model Number	WMMP2_COMPACT
Brand	WINCHMAX
Dimensions (Length x Width x Height)	580mm x 180mm x 100mm (approx. 22.8" x 7.1" x 3.9")
Winch Bolt Pattern Compatibility	254mm x 114.3mm (10" x 4.5")
Material	Heavy-duty Steel
Finish	Black Powder-Coated
Weight	12 kg (approx. 26.5 lbs)
Manufacture Location	United Kingdom

9. WARRANTY AND SUPPORT

9.1 Warranty Information

The WINCHMAX Compact Winch Mounting Plate is covered by WINCHMAX's industry-leading warranty. This includes a **lifetime warranty on mechanical components** and a **3-year warranty on electrical components** (though this plate has no electrical components, this is standard WINCHMAX warranty information for their products).

Please retain your proof of purchase for warranty claims. The warranty covers defects in materials and workmanship under normal use. It does not cover damage resulting from misuse, abuse, unauthorized modification, or improper installation.

9.2 Customer Support

For technical assistance, warranty claims, or general inquiries, please contact WINCHMAX customer support:

- **Website:** www.winchmax.co.uk (Please check the official WINCHMAX website for the most current contact information.)
- **Email:** Refer to the official website for contact email.
- **Phone:** Refer to the official website for contact phone number.

When contacting support, please have your product model number (WMMP2_COMPACT) and proof of purchase readily available.