

Manuals.plus /

› AccuMed /

› AccuMed Pregnancy Test Strips User Manual

AccuMed HCG25-PP

AccuMed Pregnancy Test Strips User Manual

Model: HCG25-PP

1. PRODUCT OVERVIEW

The AccuMed Pregnancy Test Strips are designed for early home detection of pregnancy. Each pack contains 25 individually wrapped test strips, providing highly accurate and clear results. These tests detect levels of Human Chorionic Gonadotropin (HCG) as low as 25mIU/mL in urine.



Image: AccuMed Pregnancy Test Strips, showing the box and an individual strip.

2. COMPONENTS

- 25 Individually Wrapped AccuMed Pregnancy Test Strips
- Instruction Manual (this document)

3. SAFETY INFORMATION AND PRECAUTIONS

- For in-vitro diagnostic use only. Do not ingest.
- Do not use the test strip after the expiration date printed on the foil pouch.
- Store the test strips in their sealed foil pouch at room temperature (2-30°C or 36-86°F). Do not freeze.
- Do not open the foil pouch until you are ready to perform the test.
- Discard the test strip after single use.
- Keep out of reach of children.
- Statements regarding dietary supplements have not been evaluated by the FDA and are not intended to diagnose, treat, cure, or prevent any disease or health condition.

4. PREPARATION FOR TESTING

Before performing the test, ensure you have the following:

- An AccuMed Pregnancy Test Strip (freshly opened from its foil pouch).
- A clean, dry container to collect urine.
- A timer or stopwatch.

It is recommended to use first morning urine as it typically contains the highest concentration of HCG, making early detection more likely. However, the test can be performed at any time of day.

5. OPERATING INSTRUCTIONS

Follow these simple steps to perform the AccuMed Pregnancy Test:

1. **Step 1: Immerse the strip.** Collect a urine sample in a clean, dry container. Remove the test strip from its sealed pouch. Immerse the strip vertically into the urine sample with the arrow pointing towards the urine. Do not immerse past the MAX line.

How to Use

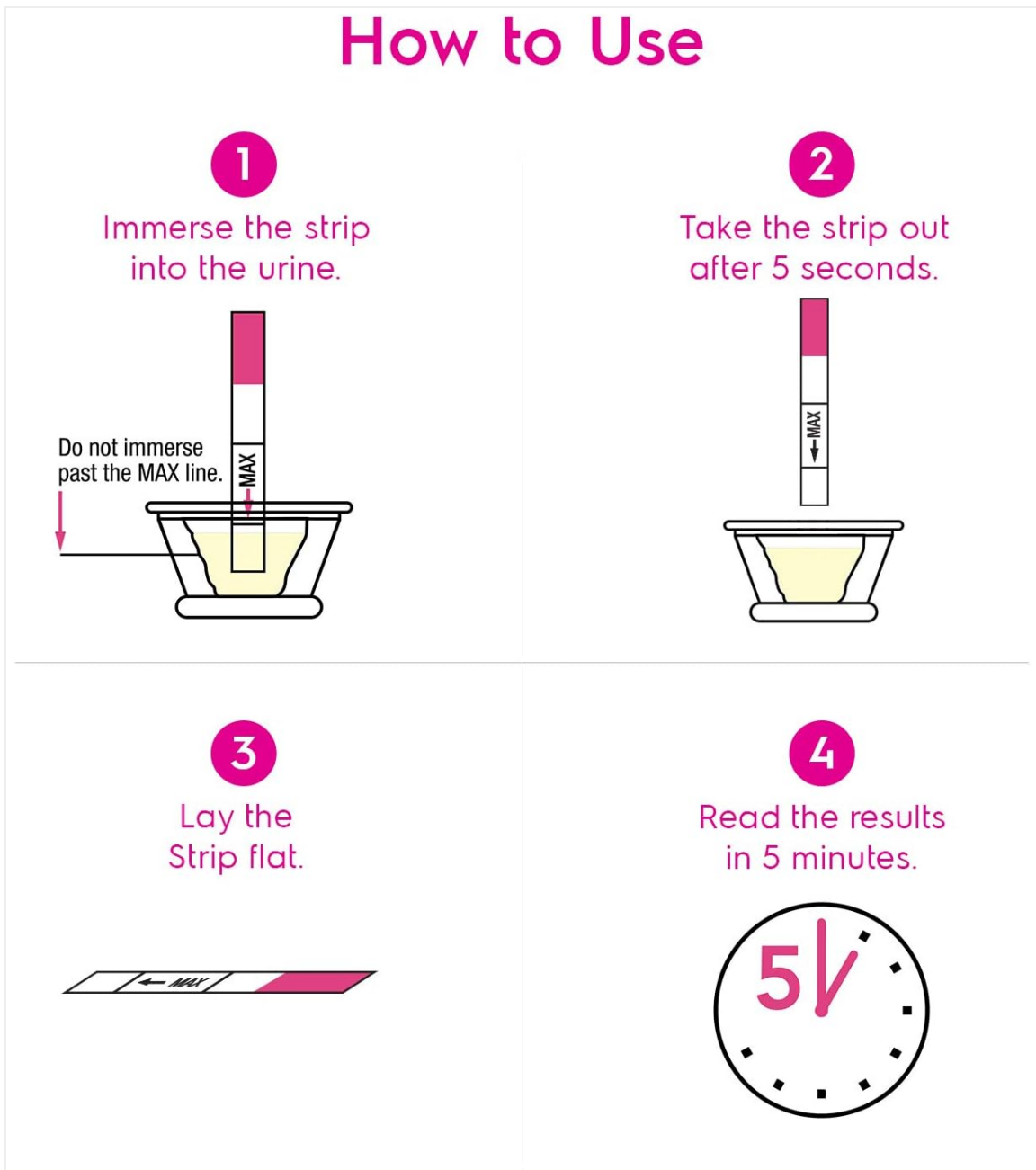

Image: Step-by-step visual guide for using the test strip.

- Step 2: Wait for reaction.** Hold the strip in the urine for at least 5 seconds. Then, remove the strip from the urine and lay it flat on a clean, non-absorbent surface. Start your timer immediately.
- Step 3: Read the results.** Read the results after 5 minutes. Do not interpret results after 10 minutes, as this may lead to inaccurate readings.

For a visual demonstration of the testing process, please watch the official AccuMed Pregnancy Test Video below:



Video: Official AccuMed Pregnancy Test Video (HCG25-PP) demonstrating the usage steps and result interpretation.

6. INTERPRETING RESULTS

The appearance of lines on the test strip indicates the result. Always look for a Control Line (C) and a Test Line (T).

Positive Result (Pregnant):

Two distinct colored lines appear: one in the Control Line (C) region and one in the Test Line (T) region. The intensity of the test line may vary depending on the concentration of HCG in the urine.

Negative Result (Not Pregnant):

Only one colored line appears in the Control Line (C) region. No line appears in the Test Line (T) region.

Invalid Result:

If no Control Line (C) appears, or if only the Test Line (T) appears, the test is invalid. This indicates insufficient sample volume or incorrect procedural techniques. Repeat the test with a new strip.

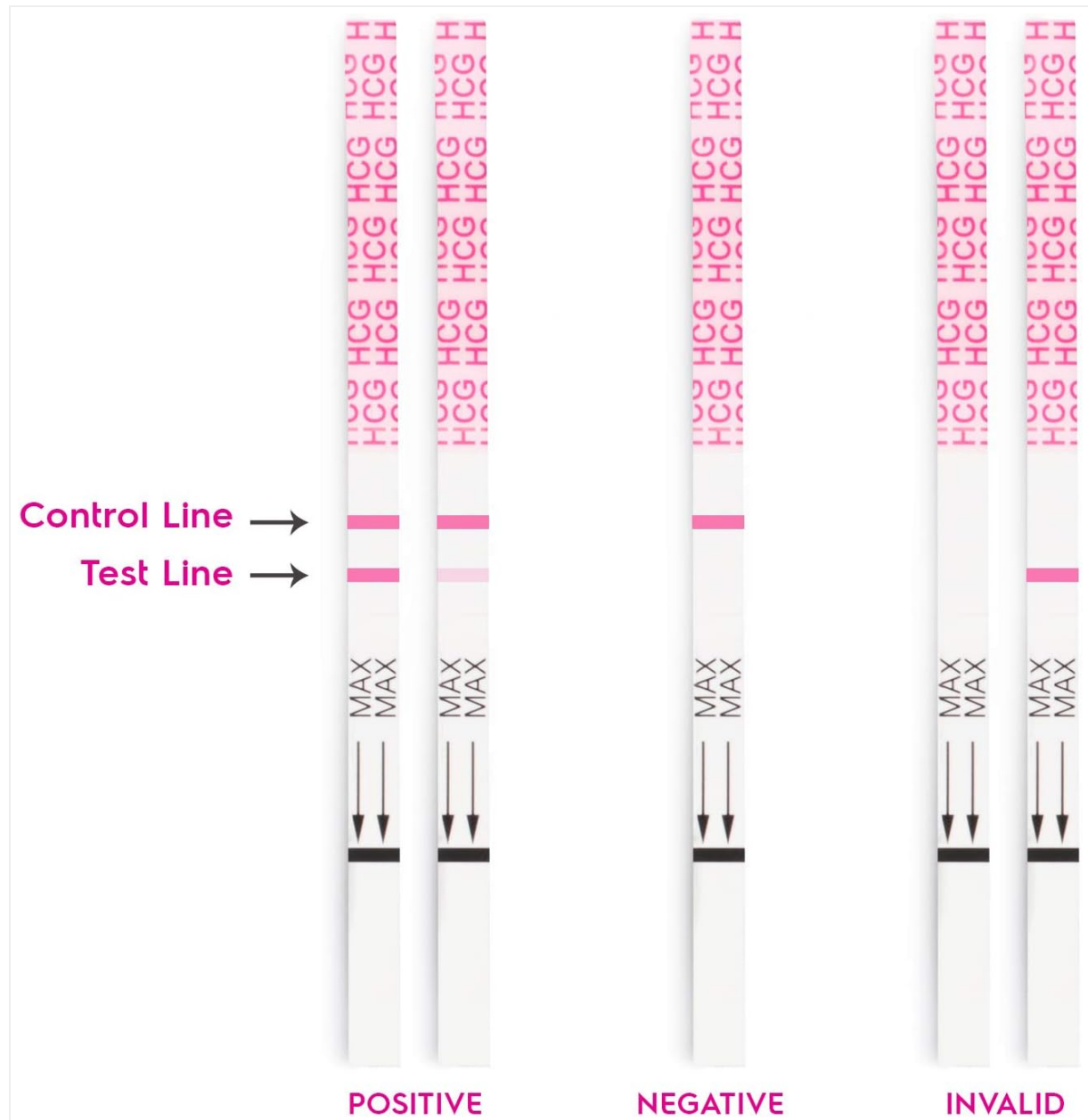

Image: Examples of positive, negative, and invalid test results.

7. UNDERSTANDING HCG LEVELS

Human Chorionic Gonadotropin (HCG) is a hormone produced by the placenta after implantation. Its levels rise rapidly during early pregnancy. The AccuMed test strips are designed to detect HCG at a sensitivity of 25mIU/mL.

Human Chorionic Gonadotrophin, (HCG)

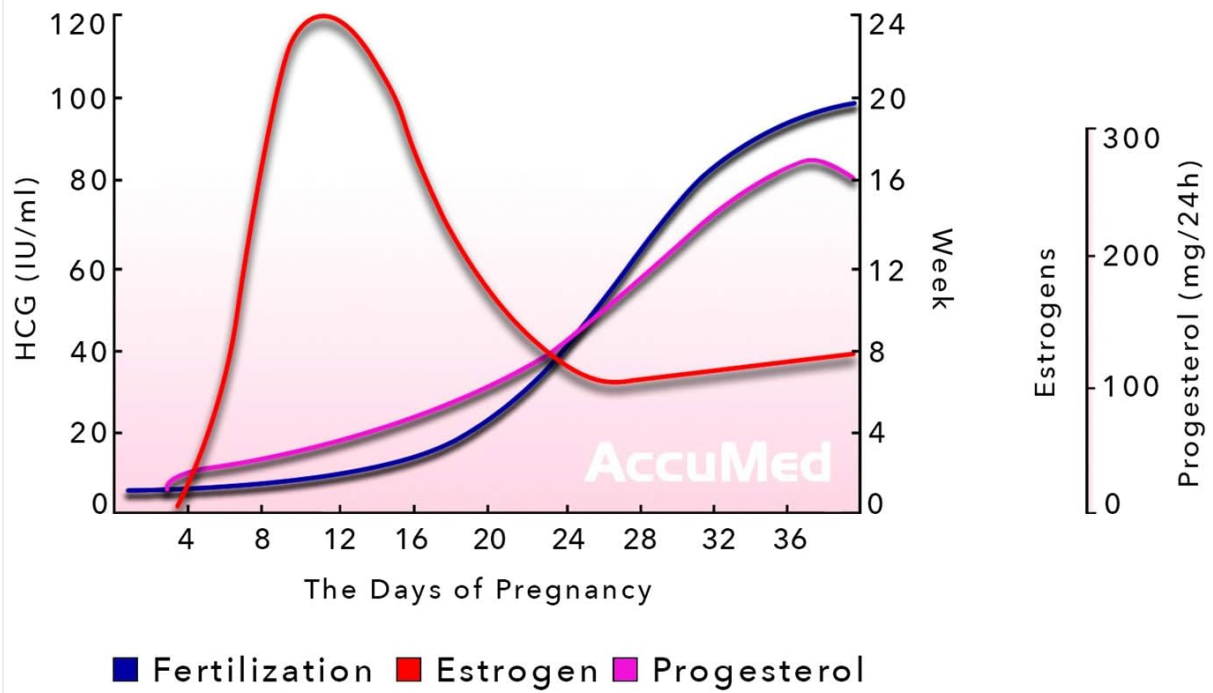

Image: Graph illustrating the typical rise of HCG, Estrogen, and Progesterone during pregnancy.

8. TROUBLESHOOTING

Invalid Test Result:

If the control line does not appear, the test is invalid. This can happen if:

- The test strip was not immersed correctly (e.g., not enough urine, immersed past the MAX line).
- The test strip was expired or improperly stored.

If you receive an invalid result, discard the used strip and repeat the test with a new strip, carefully following all instructions.

Faint Test Line:

A faint test line still indicates a positive result. The intensity of the test line can vary due to the concentration of HCG in your urine. HCG levels are typically lower in early pregnancy or if the urine is diluted. If you are unsure, you may retest in a few days using first morning urine, or consult a healthcare professional.

9. STORAGE AND MAINTENANCE

- Store unopened test strips in their original sealed foil pouches at room temperature (2-30°C or 36-86°F).
- Do not store in direct sunlight, excessive heat, or freezing conditions.
- Ensure the foil pouch is not damaged before use.

10. SPECIFICATIONS

Model Number	HCG25-PP
Manufacturer	AccuMed
Number of Pieces	25
Special Feature	Early Detection
Specific Uses	Pregnancy Test, HCG Test
Package Dimensions	7.83 x 5.71 x 0.55 inches
Item Weight	1.76 ounces
Country of Origin	China

11. WARRANTY AND SUPPORT

AccuMed Biotech US provides exclusive support and warranty for this product. For any inquiries, technical assistance, or warranty claims, please contact AccuMed Biotech US directly.

Please refer to the official AccuMed website or product packaging for the most current contact information and detailed warranty terms.

Website: www.accumed.com