

Thule 307340

Thule 307340 Bicycle Carrier Instruction Manual

Model: 307340

1. PRODUCT OVERVIEW

The Thule 307340 Bicycle Carrier is specifically designed for Fiat Ducato and identical vehicles, building upon the proven Thule Omnistor product line. It is engineered to transport up to two bicycles securely, offering a load capacity of 35 kg with a maximum load of 19 kg per rail.



Figure 1.1: The Thule 307340 Bicycle Carrier, showcasing its robust design and bicycle cradles.

1.1 Key Features

- **Vehicle Specific Fit:** Specially designed for Fiat Ducato (from 07/2006) and identical vehicles.
- **Drill-Free Installation:** Mounts to the right rear door using a glued mounting clamping rail, eliminating the need for drilling.
- **Enhanced Bicycle Spacing:** Features an increased distance of 20 cm between rails for easier and faster bicycle attachment.
- **Adjustable Platform Height:** The bike platform can be set in 3 different height positions for optimal comfort and vehicle clearance.
- **Secure Bicycle Fastening:** Equipped with rim straps and ratchet functions to firmly secure bicycles during transport.
- **Door Accessibility:** Allows the vehicle's rear door to be opened without removing the bicycles.
- **Easy Removal:** Intelligent connections enable simple removal of the carrier when not in use.

1.2 What's in the Box

- Thule 307340 Bicycle Carrier (1 unit)

2. INSTALLATION

The Thule 307340 Bicycle Carrier is designed for straightforward installation on compatible vehicles. Follow these steps carefully to ensure secure mounting.

2.1 Vehicle Compatibility

This carrier is suitable for Fiat Ducato models from July 2006 onwards, as well as other identical vehicle models. Ensure your vehicle matches this specification before proceeding with installation.

2.2 Mounting Procedure

1. **Prepare the Mounting Surface:** Clean the right rear door surface thoroughly where the clamping rail will be attached. Ensure it is free of dirt, grease, and moisture.
2. **Attach Clamping Rail:** Position the glued mounting clamping rail on the right rear door as per the detailed instructions provided in the separate installation guide (not included in this manual). Secure it firmly using the recommended adhesive. This method ensures a drill-free installation.
3. **Assemble Carrier Components:** Follow the assembly instructions for the main carrier frame and bicycle rails. Ensure all bolts and fasteners are tightened to the specified torque.
4. **Attach Carrier to Clamping Rail:** Connect the assembled bicycle carrier to the pre-installed clamping rail on the vehicle door. The intelligent connection system allows for secure attachment and easy removal when the carrier is not in use.
5. **Adjust Platform Height:** The bike platform can be adjusted to one of three height positions. Select the position that best suits your vehicle and bicycle size for optimal ground clearance and ease of loading.
6. **Final Inspection:** Before first use, double-check all connections and ensure the carrier is securely mounted and stable.



Figure 2.1: The Thule 307340 Bicycle Carrier securely mounted on the rear of a compatible van.

3. OPERATION

Operating the Thule 307340 Bicycle Carrier is designed to be intuitive and secure. Follow these guidelines for loading and transporting your bicycles.

3.1 Loading Bicycles

1. **Prepare the Carrier:** Ensure the carrier is in its open and ready position. If previously folded, unfold it according to the mechanism.
2. **Position Bicycles:** Place the first bicycle onto the inner rail. The increased distance of 20 cm between the rails facilitates easier positioning and prevents handlebars or pedals from interfering.
3. **Secure Frame:** Use the adjustable frame holders to secure the bicycle frame to the carrier's main support bar. Ensure a snug fit without overtightening.
4. **Secure Wheels:** Position the bicycle wheels in the wheel trays. Use the rim straps with ratchet functions to firmly secure the wheels. Pull the straps until the wheels are tightly held in place, preventing movement during transit.
5. **Load Second Bicycle:** Repeat steps 2-4 for the second bicycle on the outer rail.
6. **Final Check:** Before driving, gently shake each bicycle to confirm they are securely fastened and there is no excessive movement.



Figure 3.1: Users demonstrating the ease of loading bicycles onto the Thule carrier.

3.2 Accessing Vehicle Door

A key feature of this carrier is its ability to allow access to the vehicle's rear door without needing to remove the bicycles. Simply unlatch the carrier's folding mechanism (if applicable) or swing it away from the door as designed. The door can then be opened for access to the vehicle's interior.

3.3 Removing the Carrier

When not in use, the carrier can be easily removed from the vehicle. Utilize the intelligent connections to detach the carrier from the clamping rail. Store the carrier in a dry, secure location.

4. MAINTENANCE

Regular maintenance ensures the longevity and safe operation of your Thule Bicycle Carrier.

- **Cleaning:** Clean the carrier regularly with mild soap and water, especially after exposure to dirt, salt, or harsh weather conditions. Rinse thoroughly and dry.
- **Inspection:** Periodically inspect all straps, buckles, bolts, and moving parts for wear, damage, or looseness. Replace any worn or damaged components immediately.
- **Lubrication:** Apply a small amount of silicone spray or appropriate lubricant to moving joints and hinges to ensure smooth operation.
- **Storage:** When not in use, store the carrier in a clean, dry environment, away from direct sunlight and extreme temperatures.

5. TROUBLESHOOTING

If you encounter issues with your Thule Bicycle Carrier, refer to the following common problems and solutions.

- **Carrier feels loose after installation:**

Solution: Re-check all mounting points and ensure the clamping rail is securely attached to the vehicle door. Verify that all bolts and fasteners are tightened according to the installation guide.

- **Bicycles are not stable on the carrier:**

Solution: Ensure the frame holders are properly clamped to the bicycle frames. Verify that the rim straps are tightly secured around the wheels using the ratchet function. Adjust the position of the bicycles if necessary to achieve better balance.

- **Difficulty opening vehicle door with carrier attached:**

Solution: Ensure the carrier's swing-away or tilt function is fully engaged. If the carrier is not designed to allow full 270-degree door opening, be mindful of the door's range of motion to prevent damage.

- **Noise during transit:**

Solution: Check all connections for tightness. Ensure bicycles are securely fastened and not rattling against each other or the carrier. Lubricate moving parts if squeaking is present.

6. SPECIFICATIONS

Detailed technical specifications for the Thule 307340 Bicycle Carrier.

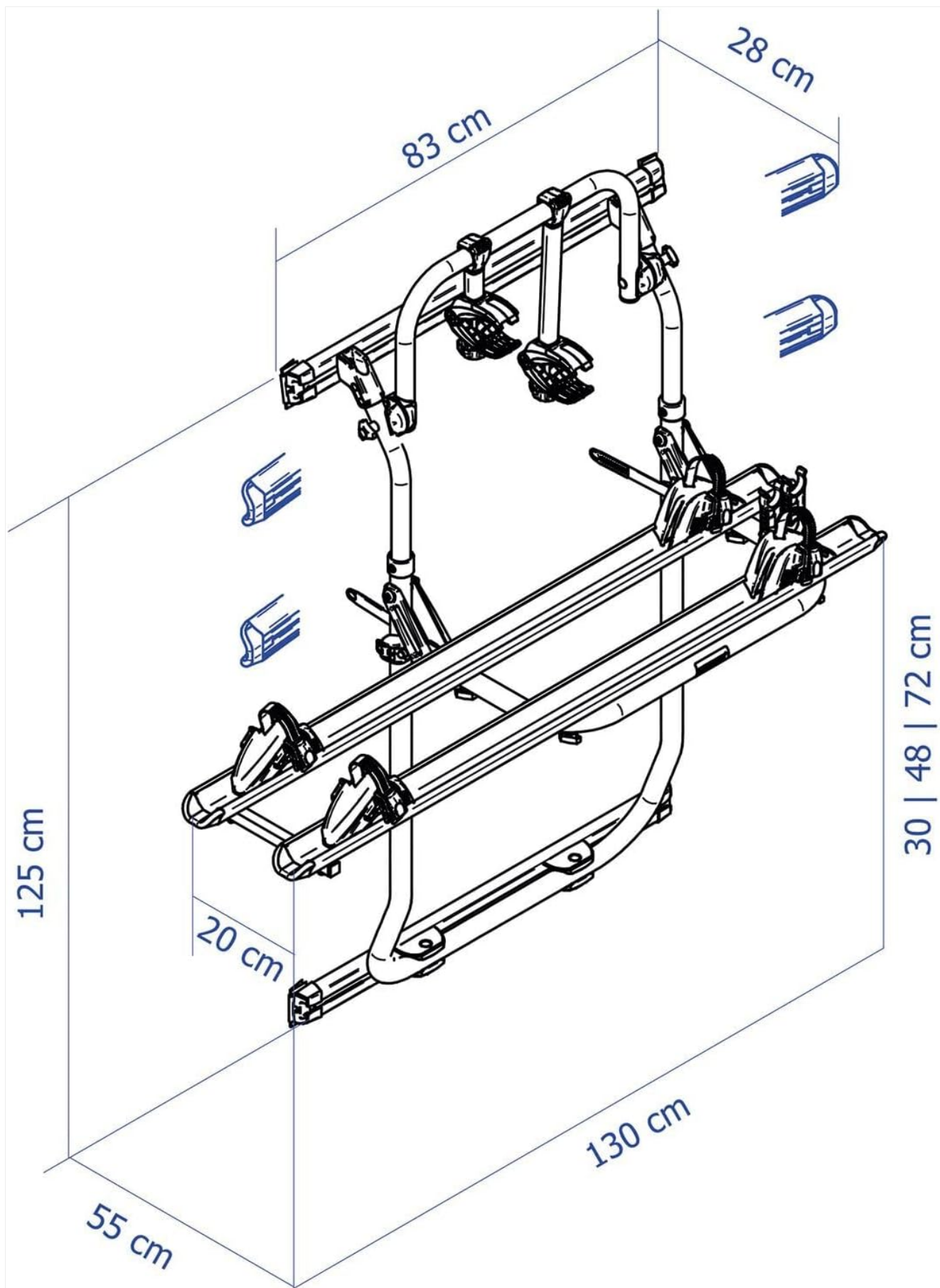

Figure 6.1: Dimensional overview of the Thule 307340 Bicycle Carrier.

Specification	Value
Brand	Thule

Specification	Value
Model Number	307340
Product Dimensions (L x W x H)	130 x 125 x 55 cm
Item Weight	10.5 kg
Load Capacity	35 kg
Max. Load per Rail	19 kg
Bicycle Capacity	2 bicycles
Mounting Type	Railing Mount, Strap Mount (via clamping rail)
Colour	Silver, Black
Vehicle Fit Type	Vehicle Specific Fit (Fiat Ducato from 07/2006 and identical vehicles)

7. WARRANTY AND SUPPORT

Thule products are known for their quality and durability. For specific warranty information regarding your Thule 307340 Bicycle Carrier, please refer to the warranty card included with your purchase or visit the official Thule website.

7.1 Customer Support

If you require further assistance, have questions about installation, operation, or need to report an issue, please contact Thule customer support through their official website or the contact details provided in your product packaging. When contacting support, please have your product model number (307340) and purchase details readily available.

For more information, visit the [Thule Store on Amazon](#).