

plustek OpticSlim 1180

Plustek OpticSlim 1180 Flatbed Scanner User Manual

Model: OpticSlim 1180 | Brand: plustek

1. INTRODUCTION

The Plustek OpticSlim 1180 is a large format flatbed scanner designed for versatile use in various environments, including libraries, schools, and small office/home office (SOHO) setups. It supports scanning documents up to A3 or Tabloid/Legal size with a resolution of up to 1200 DPI. Key features include a no-warm-up LED light source, one-touch operation, and bundled software for enhanced functionality.



Figure 1.1: Plustek OpticSlim 1180 Scanner Overview

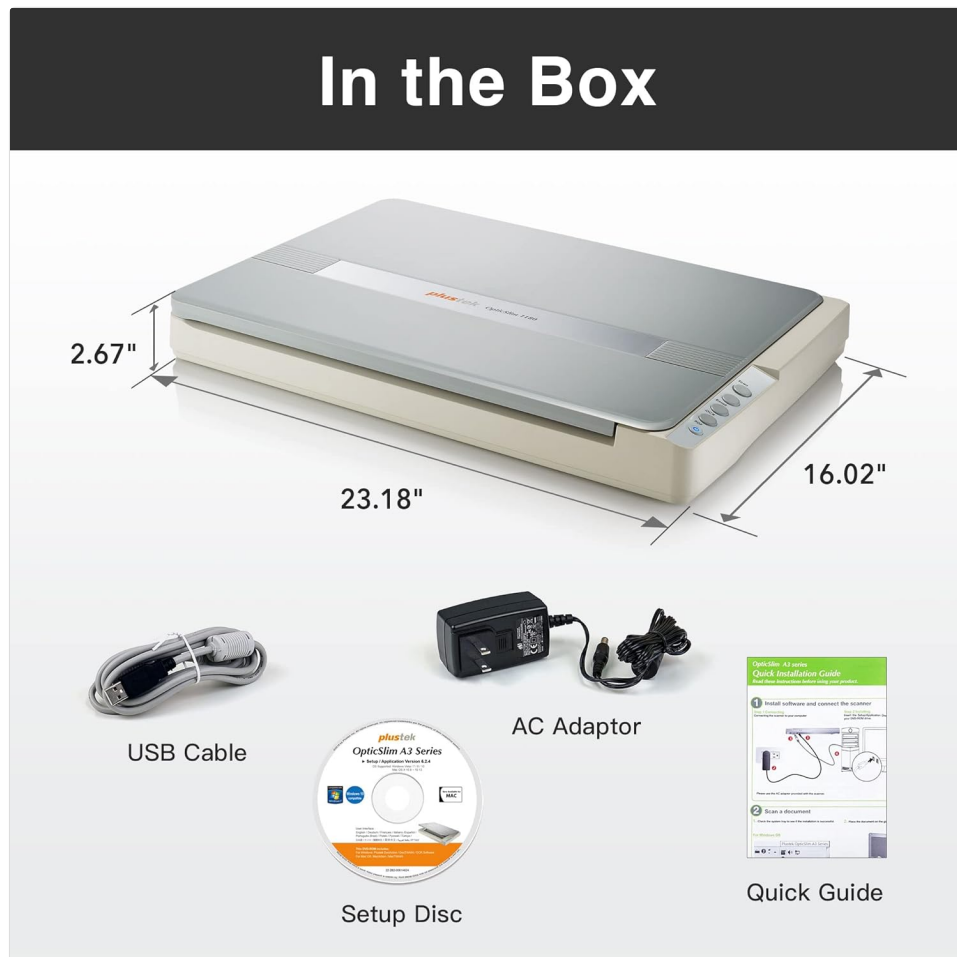

Figure 1.2: Key Features and Compatibility

2. WHAT'S IN THE BOX

Please ensure all the following items are included in your package:

- Plustek OpticSlim 1180 Scanner
- USB Cable
- AC Adaptor
- Setup Disc (for software and drivers)
- Quick Guide
- A4 Size Paper (for testing)



3. SETUP GUIDE

3.1 Connecting the Scanner

1. Connect the USB cable from the scanner to an available USB port on your PC or Mac.
2. Connect the AC adapter to the scanner's power input and then plug it into a power outlet.
3. Press the power button on the scanner. The LED light should turn on. If it does not, please ensure both the USB and power adapter are securely connected.

Video 3.1: OpticSlim 1180 - Quick Start Guide. This video demonstrates how to connect the scanner and install the necessary drivers.

3.2 Installing the Software

You can install the scanner driver and software using the included setup disc or by downloading them from the official Plustek website.

1. **Using the Setup Disc:** Insert the 'OpticSlim A3 Series' setup disc into your computer's DVD drive. Follow the on-screen instructions to complete the installation.
2. **Downloading from Website:** Visit www.plustek.com/os1180. Locate the drivers and software compatible with your operating system (Windows or Mac OS) and download the appropriate files. Run the installer and follow the prompts.

After successful installation, you will find the Plustek software icon on your desktop or in your applications folder.

4. OPERATING INSTRUCTIONS

4.1 Basic Scanning

The OpticSlim 1180 features convenient one-touch buttons for common scanning tasks:

Everything Can Be Done Intuitively at Your Fingertips.

Convenient Lifestyle and Optimized User Experience.

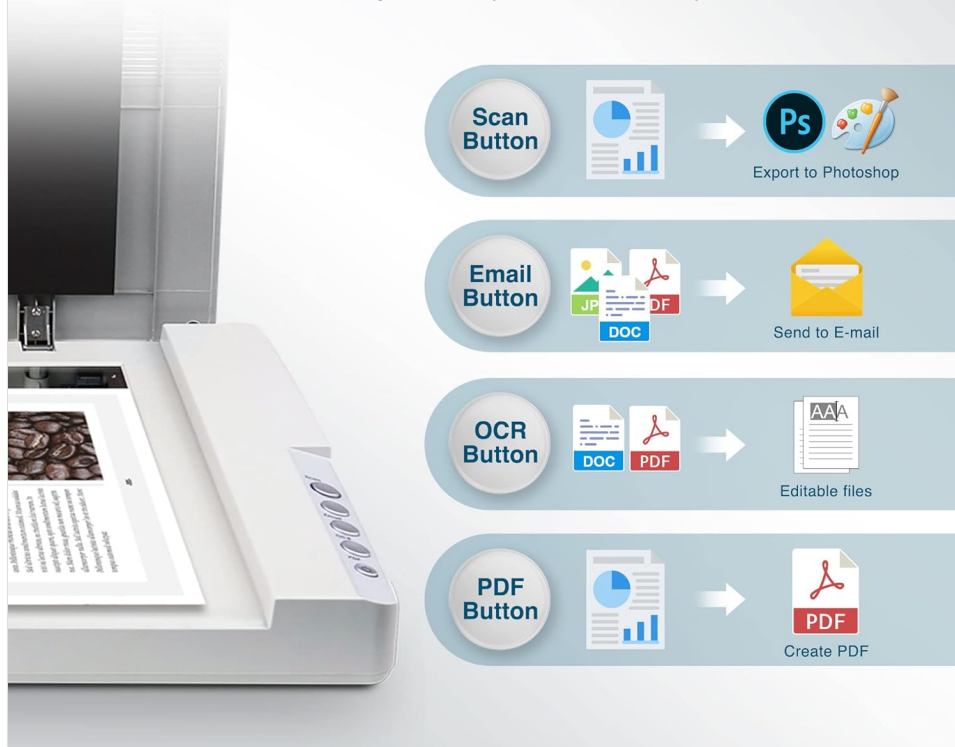

Figure 4.1: One-Touch Scan Buttons

- **Scan Button:** Initiates a scan and opens the image in the assigned application.
- **Email Button:** Scans a document and prepares it for sending via email.
- **OCR Button:** Scans a document and converts it into editable text using Optical Character Recognition (OCR).
- **PDF Button:** Scans a document and saves it directly as a PDF file.

To scan, place your document face down on the scanner glass, close the lid, and press the desired one-touch button on the scanner or initiate the scan from the software interface.



Figure 4.2: Simplified Scanning Workflow

4.2 Scanning Multiple Pages to PDF

The scanner allows you to combine multiple scanned pages into a single PDF document, which is ideal for multi-page reports or books.

Video 4.2: OpticSlim 1180 - Scan Multi Page PDF. This video demonstrates the process of scanning multiple pages and compiling them into a single PDF file.

Within the DocAction software, select the PDF function and ensure the 'Continuous Scan' option is enabled. This allows you to scan pages one by one, and the software will prompt you to place the next page until you finish the job.

Scan Multiple Pages into One PDF File

A Better Way to Store Your Documents.



Figure 4.3: Multi-Page PDF Scanning

4.3 Using the Removable Lid

For scanning bulky items such as thick books, magazines, or large drawings, the OpticSlim 1180 features a removable lid. This allows the lid to be lifted higher or completely removed to accommodate the item without damaging the scanner or the item itself.

Removable Lid Makes Scanning Bulky and Large Items Easy.



- Thick Book
- Large Drawing
- Double-Page Spread

Figure 4.4: Removable Lid for Bulky Items

4.4 Software Features (DocAction & ABBYY OCR)

The scanner comes bundled with powerful software to enhance your scanning experience:

- **ABBYY FineReader Sprint:** This software provides enhanced Optical Character Recognition (OCR) accuracy, allowing you to convert scanned images of text into editable and searchable documents (e.g., Word, Excel, searchable PDF).

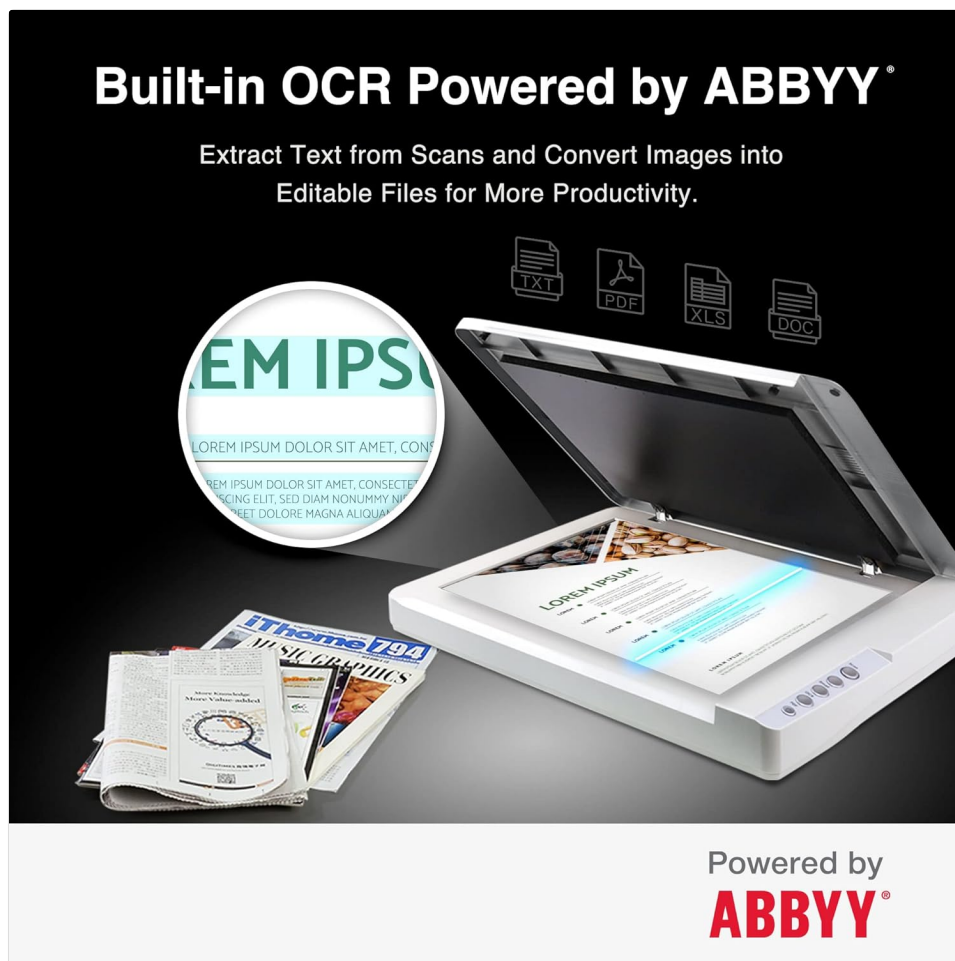

Figure 4.5: Built-in OCR Functionality

- **DocAction:** This utility helps optimize scan results and adjust images automatically with advanced image processing techniques. Features include:

- Remove Punch Hole
- Auto-Rotate
- Hardware Compression
- Split Images
- Character Enhancement
- Remove Background
- Multi-image Output (Color, Grayscale, B&W)

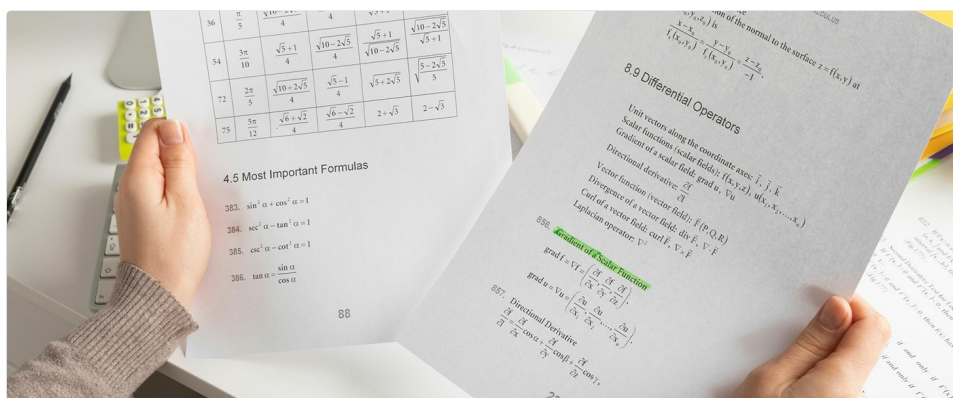

Figure 4.6: Automatic Image Enhancement with DocAction

5. MAINTENANCE

To ensure optimal performance and longevity of your Plustek OpticSlim 1180 scanner, follow these basic maintenance guidelines:

- **Cleaning the Scanner Glass:** Regularly wipe the scanner glass with a soft, lint-free cloth dampened with a non-abrasive glass cleaner. Avoid spraying cleaner directly onto the glass.
- **Exterior Cleaning:** Use a soft, dry cloth to clean the exterior of the scanner. Do not use harsh chemicals or abrasive materials.
- **LED Light Source:** The scanner uses an LED light source, which requires no warm-up time and is energy-efficient. No specific maintenance is required for the light source itself.
- **Software Updates:** Periodically check the Plustek website for software and driver updates to ensure compatibility and access to the latest features and improvements.

6. TROUBLESHOOTING

If you encounter issues with your Plustek OpticSlim 1180 scanner, consider the following common troubleshooting steps:

- **Scanner Not Turning On:** Ensure both the USB cable and the AC power adapter are securely connected to the scanner and the power outlet/computer. Try a different USB port or power outlet if necessary.
- **Scanner Not Detected by Computer:** Verify that the USB cable is properly connected. Reinstall the scanner drivers from the setup disc or the Plustek website. Restart your computer.
- **Poor Scan Quality:** Clean the scanner glass thoroughly. Adjust scan settings such as resolution (DPI), brightness, and contrast in the software. Ensure the document is placed flat on the scanner glass.
- **Software Issues:** If the software is not responding or crashing, try restarting the application or your computer. Ensure your operating system and scanner software are up to date.
- **Scanning is Slow:** Lower the scan resolution (DPI) if high quality is not required. Close other demanding applications running on your computer.

For more detailed troubleshooting or persistent issues, please refer to the official Plustek support resources listed in the Customer Support section.

7. SPECIFICATIONS

Feature	Detail
Scanner Type	Flatbed Document Scanner
Maximum Scan Size	11.7" x 17" (A3 / Tabloid / Legal)
Optical Resolution	1200 dpi
Color Depth	48-bit Color / 16-bit Grayscale

Light Source	LED (No warm-up time)
Connectivity	USB 2.0
Compatible Devices	PC (Windows), Mac
Product Dimensions	23.18 x 16.02 x 2.67 inches
Item Weight	9.52 pounds
Control Method	Touch (One-Touch Buttons)

8. WARRANTY INFORMATION

The Plustek OpticSlim 1180 Flatbed Scanner comes with **alimited warranty**. For specific details regarding the warranty period, coverage, and terms and conditions, please refer to the warranty card included in your product packaging or visit the official Plustek website. Keep your proof of purchase for warranty claims.

9. CUSTOMER SUPPORT

For technical assistance, product inquiries, or support, Plustek offers comprehensive customer service:

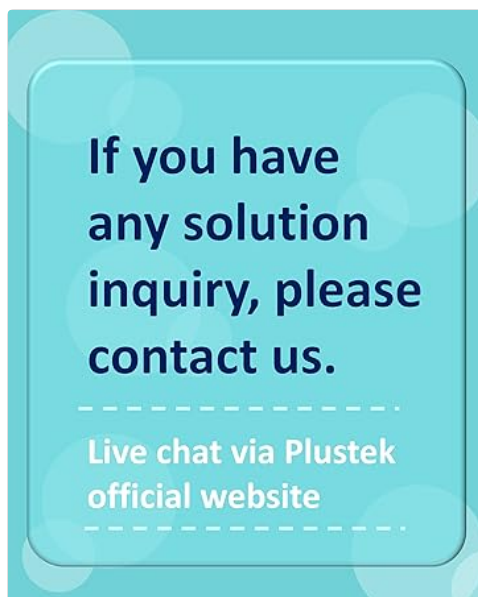

Figure 9.1: Plustek Customer Support Options

- **Realtime Online Zendesk Support:** Access live chat support through the official Plustek website for immediate assistance.
- **USA Expert Phone Support:** Contact Plustek's dedicated phone support for direct assistance from technical experts.
- **Online Form/Email Support:** Submit your inquiries via online forms or email for detailed responses.

- **Consultant Support:** Specialized support is available for solution and SDK inquiries.

Please visit the official Plustek website for the most up-to-date contact information and support resources:

www.plustek.com