

ZINGYOU BM-800

ZINGYOU BM-800 Condenser Microphone Bundle

INSTRUCTION MANUAL

Introduction

Thank you for choosing the ZINGYOU BM-800 Condenser Microphone Bundle. This kit is designed to provide high-quality audio capture for various applications, including studio recording, broadcasting, podcasting, and voiceovers. This manual will guide you through the setup, operation, and maintenance of your new microphone system to ensure optimal performance.



Image: The ZINGYOU BM-800 Condenser Microphone Bundle, featuring the microphone, pop filter, and suspension arm.

What's in the Box

Your ZINGYOU BM-800 Condenser Microphone Bundle includes the following components:

- Condenser Microphone (BM-800)
- Adjustable Suspension Scissor Arm Stand
- Table Mounting Clamp
- Shock Mount
- Pop Filter (Double-Layer)
- Foam Cap (Windscreen)
- XLR to 3.5mm Cable
- USB Sound Card Adapter
- User Manual (this document)



Image: All components included in the ZINGYOU BM-800 Condenser Microphone Bundle, neatly arranged in their packaging.

Setup Instructions

Follow these steps to assemble and connect your ZINGYOU BM-800 microphone system:

1. **Attach the Table Mounting Clamp:** Secure the table mounting clamp to the edge of your desk or any flat surface. Ensure it is tightened firmly to provide a stable base for the suspension arm.

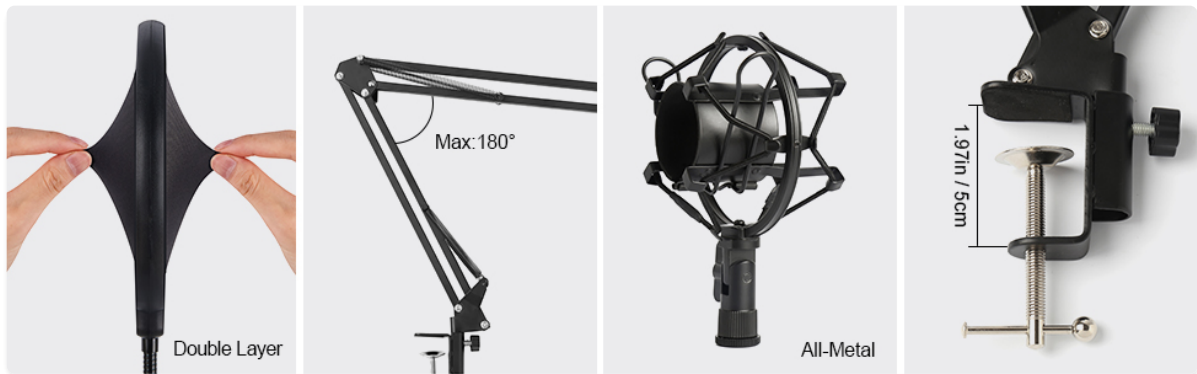

Image: A detailed view of the table mounting clamp, highlighting its robust construction and maximum clamping width.

2. **Install the Suspension Scissor Arm:** Insert the base of the adjustable suspension scissor arm into the hole on the table mounting clamp. Tighten the screw on the clamp to secure the arm. The arm can rotate 180 degrees for flexible positioning.
3. **Mount the Shock Mount:** Screw the shock mount onto the threaded end of the suspension arm. The shock mount helps isolate the microphone from vibrations and handling noise.



Image: A close-up of the microphone's all-metal shock mount, designed to reduce vibrations.

4. **Insert the Microphone:** Gently squeeze the two hoops of the shock mount together to open it, then carefully slide the ZINGYOU BM-800 microphone into the center. Release the hoops to secure the microphone.
5. **Attach the Pop Filter:** Clamp the pop filter to the suspension arm or your desk. Position the double-layer mesh screen approximately 2-3 inches (5-7 cm) in front of the microphone to reduce plosive sounds.



Image: A close-up of the double-layer pop filter, showing its flexible gooseneck and clamp for attachment.

6. **Connect the Cables:** Plug the XLR end of the provided cable into the bottom of the BM-800 microphone. Connect the 3.5mm end of the cable to the USB sound card adapter, then plug the USB adapter into an available USB port on your computer. Alternatively, if your device has a dedicated microphone input, you can connect the 3.5mm cable directly.
7. **Adjust Positioning:** Adjust the suspension arm and microphone angle for optimal recording. The microphone should be positioned directly in front of your mouth, facing the ZINGYOU logo.

Your browser does not support the video tag.

Video: An official ZINGYOU overview of the BM-800 Condenser Microphone, demonstrating its features and typical setup.

Operating Instructions

The ZINGYOU BM-800 features a cardioid pickup pattern and high sensitivity for clear audio capture.

- **Cardioid Pickup Pattern:** The BM-800 is designed to pick up sound primarily from the front, minimizing noise from the sides and rear. Ensure the microphone's ZINGYOU logo faces the sound source (e.g., your mouth) for optimal recording.

CARDIOID PICKUP PATTERN

Face to the ZINGYOU logo when recording.

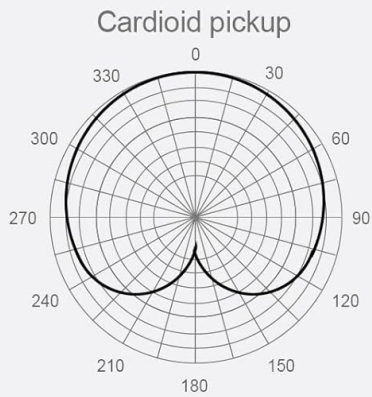

Incorrect use

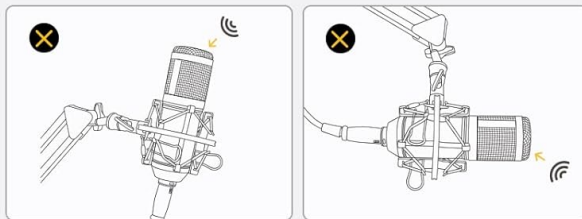

Image: A diagram showing the cardioid pickup pattern, indicating that the microphone captures sound most effectively from the front, where the ZINGYOU logo is located.

- **Highly-Sensitive Capture:** This microphone is engineered for wide nuance capture, providing ultra-clear and smooth recordings. Its large diaphragm, built-in quality chipset, and high sampling rate contribute to its excellent sonic detail.



HIGHLY-SENSITIVE CAPTURE

Pick up wide nuances, provide recorder an ultra-clear capture and smooth recording.

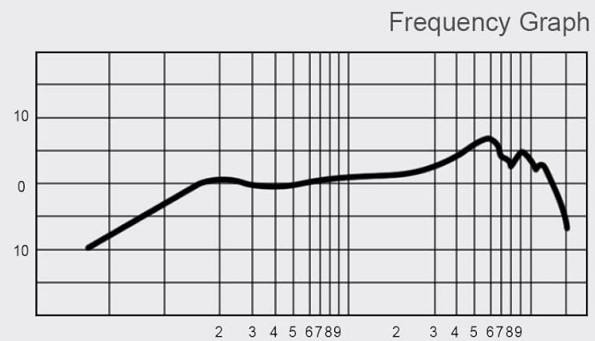

Large diaphragm



Built-in quality chipset



High Sampling Rate

Image: The ZINGYOU BM-800 microphone with an accompanying frequency graph, illustrating its highly sensitive capture capabilities.

- **Software Settings:** After connecting the microphone to your computer, ensure it is selected as the input device in your operating system's sound settings and your recording software. Adjust input gain levels to prevent clipping or distortion.

Maintenance

Proper maintenance will extend the life and performance of your microphone bundle:

- **Cleaning:** Use a soft, dry cloth to wipe down the microphone and stand. Do not use liquid cleaners or solvents.
- **Storage:** When not in use, store the microphone in a clean, dry place, ideally in its original packaging or a protective bag, to prevent dust accumulation and damage.
- **Cable Care:** Avoid sharp bends or kinks in the cables. Store them neatly to prevent tangling and damage.

Troubleshooting

If you encounter issues with your ZINGYOU BM-800, try the following solutions:

- **No Sound Output:**
 - Ensure all cables are securely connected.
 - Verify the microphone is selected as the input device in your computer's sound settings and recording software.
 - Check the input gain levels in your software; they might be set too low.
 - If using the USB sound card, ensure it is properly recognized by your computer.
- **Distorted or Unclear Sound:**
 - Adjust the microphone's position; ensure the ZINGYOU logo faces the sound source.
 - Reduce the input gain level in your software to prevent clipping.
 - Ensure the pop filter is correctly positioned to minimize plosives.
 - Check for any background noise in your recording environment.
- **Feedback or Hissing Noise:**
 - Ensure speakers are not too close to the microphone.
 - Lower the output volume of your speakers or headphones.
 - If using the USB sound card, try adjusting its settings or using a different USB port.

Specifications

Feature	Specification
Brand	ZINGYOU
Model Name	BM-800
Microphone Form Factor	Microphone System
Connectivity Technology	XLR
Connector Type	XLR
Polar Pattern	Unidirectional
Audio Sensitivity	28 Decibels
Frequency Response	20 KHz
Signal-to-Noise Ratio	78 dB
Material	Aluminum, Metal
Color	Silver Black
Item Weight	12.2 ounces (346 Grams)
Product Dimensions (L x W x H)	15.8 x 9.1 x 4.7 inches
Power Source	Electric
Recommended Uses	Singing, Studio Recording, Broadcasting
Compatible Devices	Personal Computer, Tablet

Warranty and Support

For warranty information, technical support, or any inquiries regarding your ZINGYOU BM-800 Condenser Microphone Bundle, please refer to the warranty card included in your package or visit the official ZINGYOU website. Our customer service team is available to assist you with any product-related questions.