

Westbrass 442P

Westbrass 442P PVC Straight Adapter Instruction Manual

Model: 442P | Brand: Westbrass

1. INTRODUCTION

The Westbrass 442P PVC Straight Adapter is designed to facilitate the connection of a bathtub, particularly those without an overflow, to a 1-1/2 inch Schedule 40 PVC plumbing system. This adapter ensures a secure and leak-free connection, providing a reliable solution for your plumbing needs.

2. SAFETY INFORMATION

- Always turn off the main water supply before beginning any plumbing work.
- Wear appropriate personal protective equipment (PPE), such as safety glasses and gloves, to prevent injury.
- Ensure proper ventilation when working with PVC primer and cement, as fumes can be harmful.
- Consult a qualified plumber if you are unsure about any installation steps or encounter difficulties.
- Keep all plumbing chemicals out of reach of children and pets.

3. PRODUCT OVERVIEW

3.1 Product Description

The Westbrass 442P is a 1-1/2 inch Schedule 40 PVC adapter. It features a 1-1/2 inch NPMS thread on one end and a 1-1/2 inch Schedule 40 slip inlet on the other, allowing for direct connection of a tub drain to PVC plumbing, especially useful for tubs without an integrated overflow.

3.2 Key Features

- 1-1/2 inch NPMS thread (1-7/8 inch - 11.5 UNC-2B) for secure connections.
- 1-1/2 inch Schedule 40 Slip inlet for solvent weld connection.
- Designed to attach a tub drain to PVC plumbing systems.
- Overall height of 2-1/2 inches.

3.3 Product Images



Figure 1: Front view of the Westbrass 442P PVC Straight Adapter. This image shows the threaded top opening and the smooth PVC body.



Figure 2: Side view of the Westbrass 442P PVC Straight Adapter. This view highlights the slip inlet at the bottom and the overall cylindrical shape.

4. INSTALLATION INSTRUCTIONS

Follow these steps for proper installation of the Westbrass 442P PVC Straight Adapter:

1. **Prepare the Tub Drain:** Ensure the tub drain assembly is properly installed in the bathtub and ready for connection to the plumbing system. The adapter's 1-1/2 inch NPMS thread will connect to the tub drain shoe.
2. **Prepare the PVC Pipe:** Cut the 1-1/2 inch Schedule 40 PVC pipe to the required length to connect to the adapter's slip inlet. Ensure the cut is clean and deburred.
3. **Dry Fit:** Perform a dry fit of the adapter to the tub drain and the PVC pipe to ensure proper alignment and fit before applying primer and cement.
4. **Apply Primer and Cement:** Apply PVC primer to the outside of the PVC pipe and the inside of the adapter's slip inlet. Allow the primer to dry according to the manufacturer's instructions. Then, apply PVC solvent cement to the same surfaces.

5. **Connect PVC Pipe:** Immediately insert the PVC pipe into the adapter's slip inlet with a quarter turn to ensure even distribution of cement. Hold firmly for at least 30 seconds to allow the cement to set.
6. **Connect to Tub Drain:** Thread the adapter onto the 1-1/2 inch NPSM thread of the tub drain shoe. Hand-tighten initially, then use a wrench to secure the connection, ensuring not to overtighten. Use appropriate thread sealant if recommended by the tub drain manufacturer.
7. **Test for Leaks:** Once the cement has cured (refer to cement manufacturer's instructions for curing time), turn on the water supply and fill the tub to test for any leaks at the connections.

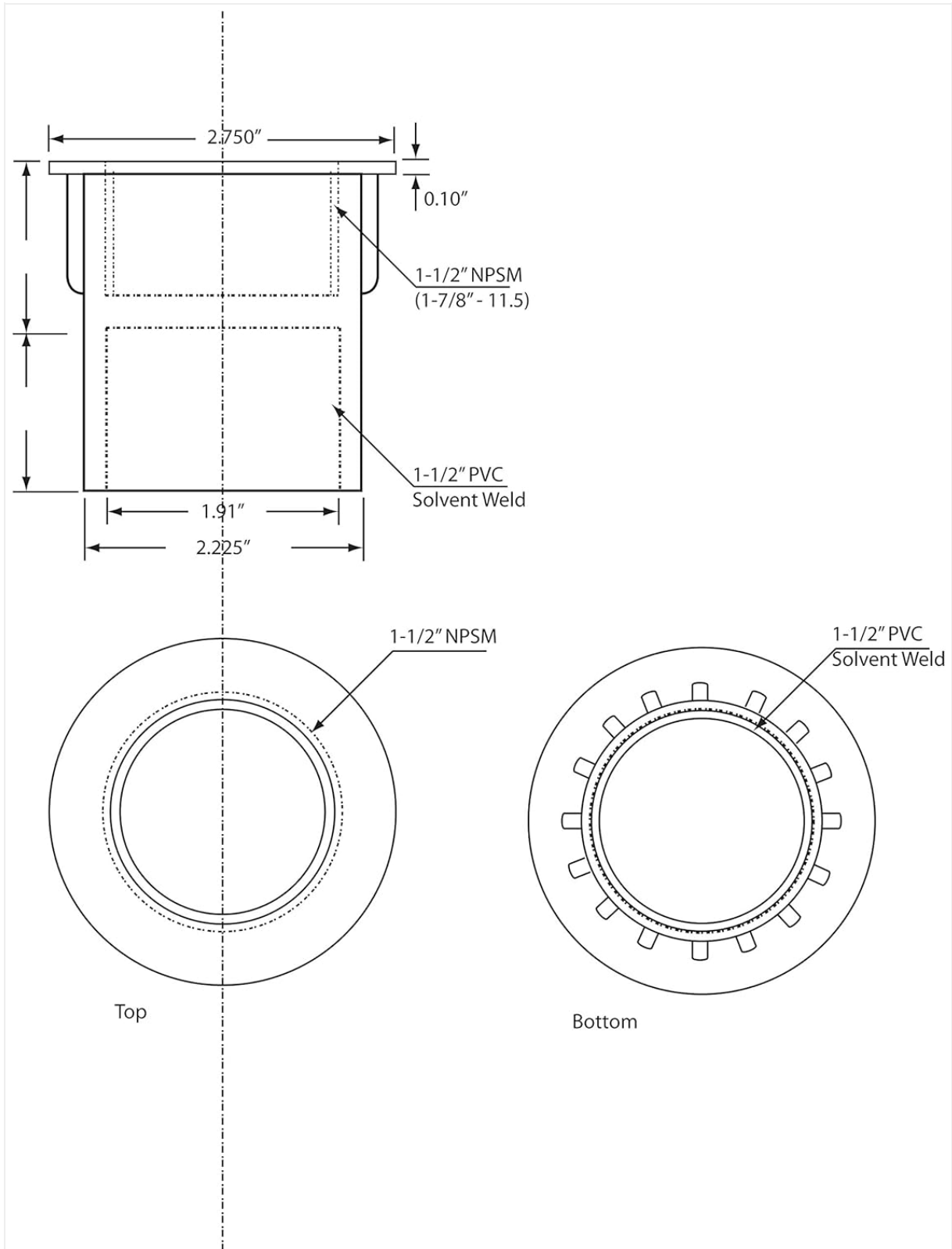

Figure 3: Technical drawing showing dimensions and connection types (1-1/2" NPSM thread and 1-1/2" PVC Solvent Weld).

5. OPERATING INSTRUCTIONS

The Westbrass 442P PVC Straight Adapter is a passive plumbing component and does not require operational steps. Its function is to provide a secure connection within the plumbing system.

6. MAINTENANCE

- Regularly inspect all plumbing connections for any signs of leaks or damage.
- Clean the exterior surfaces of the adapter with mild soap and water if necessary. Avoid abrasive cleaners that could damage the PVC material.
- Ensure that no excessive stress or weight is placed on the plumbing connections.

7. TROUBLESHOOTING

- **Leaks at Threaded Connection:** If leaks occur at the threaded connection to the tub drain, ensure the connection is adequately tightened (without overtightening) and that an appropriate thread sealant was used. Disassemble, reapply sealant, and re-tighten if necessary.
- **Leaks at Slip Inlet Connection:** If leaks occur at the solvent-welded slip inlet, this typically indicates improper application of PVC primer and cement or insufficient curing time. The connection may need to be cut out and re-done with new components and proper technique.
- **Difficulty Fitting:** If the adapter does not fit the tub drain or PVC pipe, verify that the sizes (1-1/2 inch NPMS thread and 1-1/2 inch Schedule 40 PVC) match the components you are trying to connect.

8. SPECIFICATIONS

Specification	Detail
Model Number	442P
Material	Polyvinyl Chloride (PVC)
Color	White
Thread Type	NPMS (1-7/8"-11.5 UNC-2B)
Thread Size	1-1/2 inch
Slip Inlet Size	1-1/2 inch Sch 40
Item Dimensions (L x W x H)	2.75 x 2.75 x 2.23 inches
Item Weight	0.01 Ounces
Number of Pieces	1
Installation Method	Wrench / Solvent Weld

9. WARRANTY AND SUPPORT

9.1 Warranty Information

This Westbrass product is covered by a **1 Year Limited Warranty** from the date of purchase. This

warranty covers defects in material and workmanship under normal use and service. For specific terms and conditions, please refer to the official Westbrass warranty documentation or contact customer support.

9.2 Customer Support

For technical assistance, warranty claims, or any questions regarding your Westbrass 442P PVC Straight Adapter, please visit the official Westbrass website or contact their customer service department. Contact information can typically be found on the product packaging or the manufacturer's website.

You can also visit the [Westbrass Store on Amazon](#) for more product information.

Related Documents - 442P

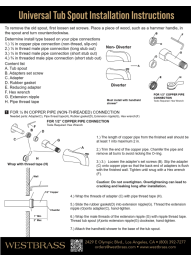
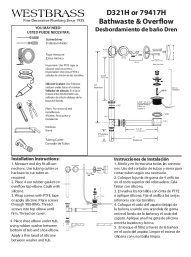
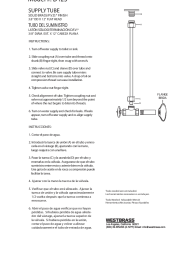
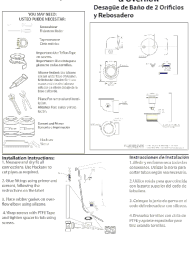
	<p>Universal Tub Spout Installation Guide WESTBRASS</p> <p>Comprehensive installation instructions for WESTBRASS Universal Tub Spouts, covering various pipe connection types including copper and threaded male connections. Learn how to properly install your new tub spout.</p>
	<p>Westbrass D321H or 79417H Bathwaste & Overflow Installation Guide</p> <p>Installation instructions and care guide for Westbrass D321H or 79417H Bathwaste & Overflow drain.</p>
	<p>Westbrass D123 Supply Tube Installation Guide</p> <p>Installation instructions and product details for the Westbrass D123 Solid Brass Supply Tube (3/8" OD x 12" Flat Head). Includes steps for connecting to toilets or sinks.</p>
	<p>Westbrass 2-Hole Bathwaste & Overflow Installation Guide</p> <p>Detailed installation instructions and parts list for the Westbrass 2-Hole Bathwaste & Overflow plumbing fixture. Includes required tools and steps for proper setup.</p>

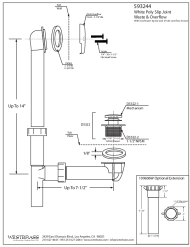

[Westbrass 593244 White Poly Slip Joint Waste & Overflow Technical Specifications](#)

Detailed technical specifications and diagram description for the Westbrass 593244 White Poly Slip Joint Waste & Overflow, including component dimensions, part numbers, and manufacturer contact information.



[Westbrass HSF6701 Filter Handheld Shower - Polished Chrome, Satin Nickel, Matte Black](#)

Discover the Westbrass HSF6701 Filter Handheld Shower. Enjoy softer hair and skin with its advanced filtration, reducing chlorine, dirt, and odor. Features a 60" hose and available in Polished Chrome, Satin Nickel, and Matte Black finishes. Rated for 3 months or 5,000 gallons.