

## Stelpro UHC2002W

# Uniwatt by Stelpro UHC2002W Convector Heater User Manual

Model: UHC2002W (2000W/240V)

## 1. PRODUCT OVERVIEW

The Uniwatt by Stelpro UHC2002W is a modern, surface-mounted convector heater designed to provide consistent and quiet warmth. This 2000W, 240V unit features a built-in electronic thermostat for precise temperature control and energy efficiency. Its sleek design and durable finish make it suitable for various indoor spaces.



Image 1.1: Front view of the Uniwatt by Stelpro UHC2002W Convective Heater.

### Key Features:

- **Heating Capacity:** 2000 Watts, 240 Volts.
- **Thermostat:** Integrated electronic thermostat for optimal energy usage.
- **Design:** Sleek, modern aesthetic with rounded sides and a 22-gauge steel cabinet.
- **Installation:** Designed for surface or wall-mounted installation with a concealed mounting bracket.
- **Operation:** Quiet operation suitable for bedrooms, offices, and living areas.

## 2. SAFETY INFORMATION

**Read all instructions before installing or using this heater. Failure to follow these instructions may result in fire, electric shock, serious injury, or death.**

### General Safety Guidelines:

- **Circuit Protection:** Protect the unit with appropriate circuit breakers or fuses as per the nameplate specifications.
- **Voltage Compatibility:** Ensure the supply voltage (volts) matches the rating indicated on the unit's nameplate.
- **Grounding:** This unit must be properly grounded.
- **Wiring:** Use copper conductors only. Power leads must be suitable for 75°C (167°F).

- **Power Disconnection:** Always switch off the power supply to the unit at the circuit breaker/fuse before any installation, repair, or cleaning procedures.
- **Intended Use:** Verify that the unit is designed for the intended application. Consult the product catalog or a representative if necessary.
- **Heating Capacity Recommendation:** Recommended heating capacity is 1.25 W/cubic foot (0.03 m<sup>3</sup>).

### 3. INSTALLATION

The UHC2002W convector heater is designed for streamlined surface or wall-mounted installation. Follow these steps for a secure and efficient setup.

#### Mounting the Heater:

1. **Location Selection:** Choose a suitable wall location, ensuring a minimum clearance of 4 inches (10 cm) from the floor to the bottom of the heater. Avoid placing it directly under electrical outlets.
2. **Bracket Installation:** Utilize the concealed mounting bracket provided. Securely attach the bracket to the wall studs or use appropriate wall anchors for stability.
3. **Heater Placement:** Carefully hang the heater onto the installed mounting bracket. Ensure it is level and securely seated.



Image 3.1: The convector heater installed on a wall, demonstrating its quick and easy installation process.

## Electrical Connection (Hardwired 240V):

This heater requires a hardwired 240V connection. All electrical work must be performed by a qualified electrician in accordance with local and national electrical codes.

1. **Power Disconnection:** Before starting any wiring, ensure the main power supply to the circuit is turned off at the breaker panel.
2. **Access Wiring Compartment:** Open the wiring compartment on the back of the heater.
3. **Connect Wires:** Connect the 240V power supply wires to the heater's terminals using appropriate wire connectors. The back entry plate includes cable clamps for a tidy and secure setup. Ensure all connections are tight and correct (Line 1, Line 2, Ground).
4. **Close Compartment:** Securely close the wiring compartment cover.
5. **Restore Power:** Once installation is complete and verified, restore power at the circuit breaker.



Image 3.2: Illustration of a 240V hardwired connection for the heater, showing proper wiring into a junction box.

## 4. OPERATING INSTRUCTIONS

The UHC2002W heater features a built-in electronic thermostat for precise temperature control.

### Using the Electronic Thermostat:

1. **Power On:** Ensure the heater is properly installed and connected to power.
2. **Adjusting Temperature:** Use the up and down buttons on the thermostat display to set your desired room temperature. The current temperature and setpoint will be visible on the digital display.
3. **Energy Efficiency:** The electronic thermostat is designed to optimize energy usage by maintaining the set temperature efficiently.
4. **Quiet Operation:** The convector design ensures quiet operation, making it suitable for noise-sensitive environments.



Image 4.1: Close-up of the heater's electronic thermostat, displaying the current temperature setting.

## 5. MAINTENANCE

Regular maintenance ensures the longevity and efficient operation of your convector heater. Always disconnect power before performing any maintenance.

### Cleaning:

- **Exterior Cleaning:** Wipe the exterior surfaces with a soft, damp cloth. Do not use abrasive cleaners, solvents, or spray directly onto the unit.
- **Dust Removal:** Periodically use a vacuum cleaner with a brush attachment to remove dust from the air intake and exhaust grilles. This helps maintain optimal airflow and heating efficiency.

### Inspection:

- **Wiring:** Annually inspect the electrical connections for any signs of wear or damage. If any issues are

found, contact a qualified electrician.

- **Mounting:** Ensure the heater remains securely mounted to the wall.

## 6. TROUBLESHOOTING

If you experience issues with your Uniwatt by Stelpro convector heater, refer to the following common troubleshooting steps.

### Common Issues and Solutions:

- **Heater Not Turning On:**
  - Check the circuit breaker: Ensure the breaker for the heater circuit is in the 'ON' position.
  - Verify power supply: Confirm that the unit is receiving 240V power.
  - Thermostat setting: Make sure the thermostat is set to a temperature higher than the current room temperature.
- **Insufficient Heat Output:**
  - Clear obstructions: Ensure air intake and exhaust grilles are not blocked by furniture, curtains, or dust.
  - Room size: Verify that the heater's wattage is appropriate for the room size. Refer to the heating capacity recommendation (1.25 W/cubic foot).
  - Thermostat calibration: If you suspect the thermostat is inaccurate, consult the full product manual or contact support.
- **Unusual Noises:**
  - Expansion/Contraction: Minor clicking or popping sounds are normal as the metal heats up and cools down.
  - Loose mounting: Ensure the heater is securely mounted to the wall.

If the problem persists after attempting these troubleshooting steps, contact Stelpro customer support.

## 7. SPECIFICATIONS

Attribute	Value
Brand	Stelpro (Uniwatt)
Model Number	UHC2002W
Power/Wattage	2000 Watts
Voltage	240 Volts
Color	White

Attribute	Value
Material	Steel
Product Dimensions	88.9 x 10 x 44.61 cm (35 x 3.9 x 17.5 inches)
Item Weight	6.03 kg (13.3 lbs)
Special Features	Electronic Thermostat
Mounting Type	Wall Mount
Heating Method	Convection
Indoor/Outdoor Usage	Indoor

# How to choose your heating device?

Comment choisir votre appareil de chauffage ?

## ? DETERMINE THE AREA TO HEAT DÉTERMINEZ LA SUPERFICIE À CHAUFFER

AREA TO HEAT (ft²) / SUPERFICIE À CHAUFFER (pi²)											
0	30	50	75	100	150	200	250	300	350	400	450
30	50	75	100	150	200	250	300	350	400	450	500
REQUIRED POWER (WATT) / PUISSANCE REQUISE (WATT)											
300	500	750	1000	1500	2000	2500	3000	3500	4000	4500	5000

Image 7.1: Dimensional drawing of the UHC2002W convector heater.

## Heating Area Recommendation:

To determine the appropriate heating device for your space, consider the area to be heated. The table below provides a general guideline for required power (wattage) based on area (in square feet).



Image 7.2: Guide for selecting heater wattage based on room area.

## 8. WARRANTY AND SUPPORT

### Warranty Information:

The Uniwatt by Stelpro UHC2002W Convector Heater comes with a **2-year warranty**. Please retain your proof of purchase for warranty claims.



Image 8.1: Key features including the 2-year warranty.

### Customer Support:

For technical assistance, warranty claims, or further information, please contact Stelpro customer service:



- **Manufacturer:** Stelpro
- **Phone:** 1-844-783-5776
- **Email:** [info@stelpro.com](mailto:info@stelpro.com)
- **Place of Business:** 1041 Rue Parent, Saint-Bruno-de-Montarville, QC J3V 6L7, Canada



Image 8.2: Proudly made in Canada.

© 2025 Stelpro. All rights reserved.

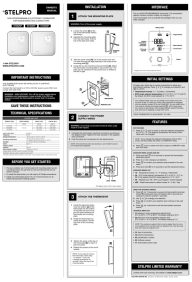
## Related Documents - UHC2002W

	<p><a href="#">STELPRO ST252NP, ST302NP, ST402NP Non-Programmable Thermostat Owner's Manual and Installation Guide</a></p> <p>Comprehensive guide for installing and operating the STELPRO ST252NP, ST302NP, and ST402NP non-programmable electronic thermostats for baseboards and convectors. Includes technical specifications, features, and warranty information.</p>
	<p><a href="#">Stelpro Non-Programmable Electronic Thermostat (ST252NP, ST302NP, ST402NP) - Owner's Manual and Installation Guide</a></p> <p>Comprehensive owner's manual and installation guide for Stelpro non-programmable electronic thermostats (models ST252NP, ST302NP, ST402NP). Covers important safety instructions, technical specifications, installation steps, interface overview, initial settings, key features, and warranty information.</p>



### [STELPRO ST252NPFF/ST402NPFF Non-Programmable Electronic Thermostat Owner's Manual and Installation Guide](#)

This owner's manual provides comprehensive instructions for installing and operating the STELPRO ST252NPFF and ST402NPFF non-programmable electronic thermostats. It covers technical specifications, initial settings, features, and troubleshooting for baseboard, convector, and fan heaters.



### [UNIWATT UHC Convector Heater: Owner's Manual and Installation Guide](#)

Official owner's manual and installation guide for the UNIWATT UHC convector heater series by STELPRO. Provides detailed instructions on safe installation, operation, temperature control, maintenance, troubleshooting common issues, and understanding the limited warranty. Includes model numbers UHC...WCW, UHC...W, UHC...PW, and UHC1501PW.



### [STELPRO ST302P/ST402P Programmable Electronic Thermostat Owner's Manual and Installation Guide](#)

Comprehensive owner's manual and installation guide for the STELPRO ST302P and ST402P programmable electronic thermostats. Covers setup, programming, features, technical specifications, and warranty information.

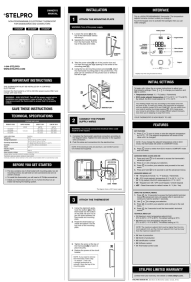

### [STELPRO ST252NP, ST302NP, ST402NP Non-Programmable Thermostat Owner's Manual and Installation Guide](#)

Comprehensive owner's manual and installation guide for STELPRO's non-programmable electronic thermostats (ST252NP, ST302NP, ST402NP) for baseboards and convectors, covering features, setup, and technical specifications.