

Teka MS 620 BIS

Teka MS 620 BIS Integrated Microwave with Grill Instruction Manual

Model: MS 620 BIS

1. INTRODUCTION AND SAFETY INFORMATION

Thank you for choosing the Teka MS 620 BIS Integrated Microwave with Grill. This manual provides essential information for the safe and efficient use of your appliance. Please read it thoroughly before installation and operation, and keep it for future reference.

1.1 General Safety Warnings

- Read all instructions before using the appliance.
- Do not attempt to operate this oven with the door open as this can result in harmful exposure to microwave energy.
- Do not heat liquids or other foods in sealed containers as they are liable to explode.
- Only allow children to use the oven without supervision when adequate instructions have been given so that the child is able to use the oven in a safe way and understands the hazards of improper use.
- Regularly clean the oven and remove any food deposits.
- Failure to maintain the oven in a clean condition could lead to deterioration of the surface that could adversely affect the life of the appliance and possibly result in a hazardous situation.
- Do not use harsh abrasive cleaners or sharp metal scrapers to clean the oven door glass since they can scratch the surface, which may result in shattering of the glass.

2. PRODUCT OVERVIEW

The Teka MS 620 BIS is an integrated microwave oven featuring both microwave and grill functions. It is designed for seamless integration into your kitchen cabinetry, offering convenience and versatility for various cooking tasks.

2.1 Key Features

- **Integrated Design:** Seamlessly fits into kitchen cabinets.
- **Microwave Function:** 700W output with five power levels for diverse cooking needs.
- **Quartz Grill:** 1000W simultaneous quartz grill for browning and crisping.
- **Touch Control Panel:** Intuitive glass panel for easy programming.
- **Easy Cleaning:** Designed for simple maintenance after each use.
- **Quiet Operation:** Engineered to operate with minimal noise.
- **Durable Construction:** High-quality stainless steel interior and exterior frame.

2.2 Appliance Diagram



Image: Front view of the Teka MS 620 BIS integrated microwave with grill, showing the control panel on the right and the oven door with a visible interior rack.

3. SETUP AND INSTALLATION

The Teka MS 620 BIS is an integrated appliance and requires professional installation into a suitable kitchen cabinet. Incorrect installation can lead to damage to the appliance or personal injury.

3.1 Installation Guidelines

- **Professional Installation:** It is highly recommended that installation be performed by a qualified technician.
- **Cabinet Requirements:** Ensure the cabinet dimensions meet the appliance specifications for proper fit and ventilation.
- **Ventilation:** Adequate ventilation space must be maintained around the appliance to prevent overheating. Do not block any ventilation openings.
- **Power Supply:** Connect the appliance to a properly grounded electrical outlet with the correct voltage (230V) and current rating. Do not use extension cords.

- **Leveling:** Ensure the appliance is level after installation to ensure proper operation of the turntable and door.

4. OPERATING INSTRUCTIONS

Familiarize yourself with the Touch Control panel and its functions before operating the microwave.

4.1 Basic Operation

1. **Placing Food:** Place food in a microwave-safe container on the turntable. Ensure the turntable is correctly seated.
2. **Closing the Door:** Close the oven door firmly. The oven will not operate if the door is not securely closed.
3. **Selecting Function:** Use the Touch Control panel to select the desired cooking function (Microwave, Grill, or Combined).
4. **Setting Time/Power:** Adjust the cooking time and power level as required.
5. **Starting:** Press the Start button to begin cooking.

4.2 Microwave Function

The microwave function uses 700W of power and offers five adjustable power levels. This is ideal for reheating, defrosting, and cooking various foods.

- Select the microwave function.
- Choose a power level (e.g., P100 for full power, P80 for 80% power, etc.).
- Set the desired cooking time.
- Press Start.

4.3 Grill Function

The 1000W quartz grill is suitable for browning, toasting, and crisping food. Use the included grill rack for best results.

- Select the grill function.
- Set the desired grilling time.
- Press Start.
- **Caution:** The grill element becomes very hot. Use oven mitts when handling items.

4.4 Combined Functions

This appliance allows for combined microwave and grill cooking, which can speed up cooking while also browning the food.

- Select the desired combined function (e.g., C1 for microwave + grill).
- Set the cooking time.
- Press Start.

4.5 Timer Function

The integrated timer can be used independently or in conjunction with cooking programs to set precise cooking durations or as a kitchen timer.

- To set a cooking timer, input the time after selecting a function.

- To use as a kitchen timer, select the timer function and set the desired duration.

5. MAINTENANCE AND CLEANING

Regular cleaning and proper care will ensure the longevity and optimal performance of your Teka microwave.

5.1 Cleaning Instructions

- **Interior:** Wipe the interior with a damp cloth and mild detergent after each use. For stubborn stains, a microwave-safe cleaner can be used. The stainless steel interior is designed for easy cleaning.
- **Exterior:** Clean the exterior surfaces, including the Touch Control panel and stainless steel frame, with a soft, damp cloth. Avoid abrasive cleaners that could scratch the finish.
- **Turntable:** The glass turntable can be removed and washed in warm soapy water or in a dishwasher.
- **Grill Rack:** Clean the grill rack with warm soapy water.
- **Important:** Always unplug the appliance before cleaning. Do not immerse the appliance in water.

6. TROUBLESHOOTING GUIDE

Before contacting customer service, please refer to the following table for common issues and their solutions.

Problem	Possible Cause	Solution
Appliance does not start	Power cord not plugged in; Door not closed properly; Fuse blown.	Check power connection; Ensure door is fully closed; Check household fuse/circuit breaker.
Food not heating	Incorrect power level or cooking time set; Microwave-safe dish not used.	Adjust power level and time; Use appropriate cookware.
Turntable not rotating	Turntable not correctly placed; Obstruction under turntable.	Re-position turntable; Remove any obstructions.
Unusual noise during operation	Food container touching oven walls; Turntable not seated correctly.	Adjust food container position; Re-seat turntable.

7. TECHNICAL SPECIFICATIONS

Feature	Specification
Brand	Teka
Model Number	8421152145579
Capacity	20 Litres
Installation Type	Integrated
Microwave Power Output	700 Watts
Grill Power Output	1000 Watts (Quartz Grill)

Feature	Specification
Power Levels	5
Voltage	230 Volts
Material	Stainless Steel
Color	Stainless Steel / Grey
Special Features	Timer, Touch Control Panel
Package Dimensions (approx.)	45 x 36 x 26 cm
Weight (approx.)	15 kg

8. WARRANTY AND SUPPORT

8.1 Warranty Information

Your Teka MS 620 BIS microwave oven is covered by a manufacturer's warranty. Please refer to the warranty card included with your purchase for specific terms, conditions, and duration. Keep your proof of purchase for any warranty claims.

8.2 Customer Support

For technical assistance, spare parts, or service requests, please contact Teka customer support. Contact details can typically be found on the Teka official website or in the documentation provided with your appliance. When contacting support, please have your model number (MS 620 BIS) and serial number (if applicable) ready.



© 2024 Teka. All rights reserved.

Related Documents - MS 620 BIS



User Manual
MS 620 BIS, ML 820 BIS, ML 8200 BIS
PL, RU, RO, TR

[Instrukcja Obsługi Teka MS 620 BIS, ML 820 BIS, ML 8200 BIS - Kuchenka Mikrofalowa](#)

Kompletna instrukcja obsługi dla kuchenek mikrofalowych Teka MS 620 BIS, ML 820 BIS i ML 8200 BIS. Zawiera informacje o bezpieczeństwie, funkcjach, obsłudze, konserwacji i rozwiązywaniu problemów.

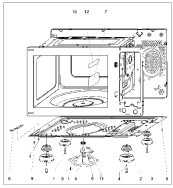

[Teka TMW.18BI Microwave Exploded Diagram and Parts List](#)

Detailed exploded view and parts identification for the Teka TMW.18BI microwave oven, providing a visual guide to its components for service and repair purposes.



User Manual
MWE FS20 G WH
ES, PT, DE, FR, SE

[Manual de Usuario Teka MWE FS20 G WH: Guía Completa y Seguridad](#)

Descubra cómo usar su horno microondas Teka MWE FS20 G WH con este manual de usuario detallado. Incluye instrucciones de seguridad, operación y mantenimiento.



User Manual
HMWE FS23 GC BK
ES, PT, DE, FR, SE

[Manual de Usuario Horno Microondas Teka HMWE FS23 GC BK](#)

Manual de usuario completo para el horno microondas Teka modelo HMWE FS23 GC BK. Incluye instrucciones de seguridad, funcionamiento, limpieza y solución de problemas en varios idiomas.



User Manual
MWE FS25G WH
ES, PT, DE, FR, SE

[Teka MWE FS25G WH Microwave Oven User Manual](#)

Comprehensive user manual for the Teka MWE FS25G WH microwave oven, covering installation, operation, safety, cleaning, and troubleshooting.



ES PT DE FR DE

[Manual de Usuario Teka MW FS20 G BK - Horno Microondas](#)

Descubra cómo operar de forma segura y eficiente su horno microondas Teka MW FS20 G BK. Este manual incluye instrucciones detalladas de uso, mantenimiento y seguridad.