

## Orbit 56481

# Orbit H2O-Six® Gear-Drive Sprinkler Head on Tripod

Model: 56481

## PRODUCT OVERVIEW

The Orbit H2O-Six® Gear-Drive Sprinkler is a highly versatile watering solution designed for various lawn and garden sizes. Its innovative gear-drive mechanism ensures quiet operation and consistent performance. Mounted on a sturdy, adjustable tripod, this sprinkler offers flexible placement and precise water distribution.

### Key Features:

- **NO TOOLS REQUIRED:** Ready to use out of the box, simple to operate, and offers versatility in spray settings.
- **LARGE-AREA COVERAGE:** Sprays up to 80 feet in diameter, covering 5,026 square feet when set to a full circle.
- **ADJUSTABLE SPRAY COVERAGE:** Use the collar tabs to adjust your spray from partial to full circle (360°) coverage.
- **6 SPRAY PATTERNS:** Choose from small, medium, large, shower, vertical, and flat.
- **4-POSITION DIFFUSER:** Customize your spray to distribute water in drops or small jets.
- **EASY-TO-USE:** Simply twist and click into place for pattern selection.
- **INNOVATIVE DESIGN:** Gear drive, designed by Orbit, offers whisper-quiet operation.
- **LONG-LASTING CONSTRUCTION:** Made from strong, durable plastic to ensure this product will last from season to season without rust or corrosion.
- **TELESCOPING TRIPOD:** Metal tripod, with three-leg adjustment, to water at the perfect height as your garden grows. Tripod adjusts from 25 to 48 inches.
- **OPERATING WATER PRESSURE:** Works from 15 to 65 psi.

## PACKAGE CONTENTS

- 1 x H2O-Six® Gear-Drive Sprinkler Head
- 1 x Adjustable Tripod Base
- Instruction Manual (this document)

## SETUP INSTRUCTIONS

---

### 1. Unpacking and Initial Assembly

Carefully remove all components from the packaging. The Orbit H2O-Six® Gear-Drive Sprinkler comes pre-assembled on its tripod base, requiring no tools for initial setup.



Image: The Orbit H2O-Six® Gear-Drive Sprinkler head mounted on its adjustable tripod base, ready for use.

### 2. Adjusting Tripod Height

The sturdy metal tripod legs are telescoping and can be adjusted from 25 to 48 inches. To adjust the height, locate the quick-release locking mechanisms on each leg. Open the locks, extend or retract the legs to your desired height, and then firmly close the locks to secure them. Ensure the tripod is stable on a level surface before operation.



Image: A close-up view of a hand operating the locking mechanism on a tripod leg to adjust its length.

### 3. Connecting to Water Source

Connect a standard garden hose to the inlet located at the base of the tripod. Hand-tighten the connection to ensure it is secure and leak-free. The sprinkler is designed to operate efficiently with water pressure between 15 and 65 PSI.

## OPERATING INSTRUCTIONS

---

### 1. Selecting Spray Pattern

The H2O-Six® sprinkler offers six distinct spray patterns to suit various watering needs: small, medium, large, shower, vertical, and flat. To select a pattern, simply rotate the green ring on the top of the sprinkler head. You will feel and hear a click as each pattern locks into place. No tools are required for this adjustment.



Image: A detailed view of the sprinkler head, highlighting the adjustable ring and the labels for the six different spray patterns.

## 2. Adjusting Spray Coverage (Arc)

To define the watering arc (from 25 to 360 degrees), locate the two adjustment collar tabs at the base of the sprinkler head, just above the tripod connection. Slide these tabs to set the desired start and end points for the sprinkler's rotation. The sprinkler will automatically reverse direction when it reaches either tab.



Image: A hand demonstrating how to adjust the black tabs on the sprinkler's collar to control the spray arc.

## 3. Utilizing the 4-Position Diffuser

The sprinkler is equipped with a four-position diffuser, providing complete control over the water spray. This feature allows you to customize the water distribution from a fine mist to larger, more concentrated jets, optimizing watering for different plant types or soil conditions.





Image: The Orbit H2O-Six® Sprinkler actively watering a lawn, showcasing its effective spray pattern.

## MAINTENANCE

The Orbit H2O-Six® Gear-Drive Sprinkler is built for durability. Regular maintenance will ensure its optimal performance and extend its lifespan:

- **Clean Regularly:** Periodically inspect the sprinkler head and nozzles for any debris, dirt, or mineral buildup. Use a soft brush or cloth to gently clean any obstructions.
- **Winterization:** Before the first frost, disconnect the sprinkler from the water source. Drain all water from the unit to prevent freezing and potential damage to internal components. Store the sprinkler in a dry, protected area during winter months.
- **Check Connections:** Routinely check all hose connections to ensure they remain tight. Loose connections can lead to water leaks and reduced water pressure, affecting sprinkler performance.

## TROUBLESHOOTING

Problem	Possible Cause	Solution
Sprinkler not rotating	Low water pressure; Obstruction in gear mechanism; Adjustment tabs set too close.	Ensure adequate water pressure (15-65 PSI); Clean sprinkler head for debris; Adjust arc tabs to allow for full rotation.
Uneven spray pattern	Clogged nozzle; Incorrect diffuser setting.	Clean any clogged nozzles; Adjust the 4-position diffuser to the desired setting.
Water leaking from connections	Loose hose connection; Worn or missing washer.	Tighten the hose connection; Check and replace the rubber washer if it is worn or missing.
Sprinkler head leaks (from the unit itself)	Internal seal issue or damage.	Ensure all parts are correctly assembled; If the issue persists, contact Orbit customer support for assistance.

## SPECIFICATIONS

- **Brand:** Orbit
- **Model Number:** 56481
- **Style:** Sprinkler on Tripod
- **Material:** Plastic, Zinc
- **Color:** Green
- **Item Dimensions (L x W x H):** 33 x 4 x 3 inches

- **Item Weight:** 4.69 pounds
- **Maximum Pressure:** 65 PSI
- **Maximum Flow Rate:** 29.41 Liters Per Minute
- **Coverage Area:** Up to 5,026 square feet (80 feet diameter at full circle)
- **Tripod Adjustment:** 25 to 48 inches
- **Spray Patterns:** 6 (Small, Medium, Large, Shower, Vertical, Flat)
- **UPC:** 046878564817



## WARRANTY AND SUPPORT

For detailed warranty information or technical support regarding your Orbit H2O-Six® Gear-Drive Sprinkler, please visit the official Orbit website or contact their customer service department directly. It is recommended to retain your purchase receipt as proof of purchase for any warranty claims.

**Official Orbit Store:** [Visit the Orbit Store on Amazon](#)

© 2024 Orbit. All rights reserved. Model 56481.

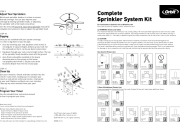
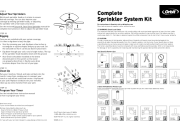
### Related Documents - 56481

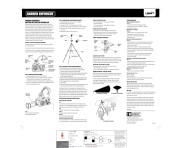
	<p><a href="#">Orbit Voyager II Gear Drive Sprinkler Installation and Adjustment Guide</a></p> <p>Comprehensive guide for installing, adjusting spray distance, and maintaining the Orbit Voyager II gear drive sprinkler. Includes step-by-step instructions and safety precautions for outdoor use.</p>
	<p><a href="#">Orbit Complete Sprinkler System Kit Installation Guide</a></p> <p>Install your Orbit Complete Sprinkler System Kit with this comprehensive guide. Learn about digging, connecting components, testing pressure, and programming your timer for optimal lawn coverage.</p>
	<p><a href="#">Orbit Complete Sprinkler System Kit Installation Guide</a></p> <p>A comprehensive guide to installing the Orbit Complete Sprinkler System Kit, including steps for adjusting sprinklers, digging trenches, connecting pipes, and programming the timer.</p>
	<p><a href="#">Orbit Voyager Gear Drive Sprinkler Installation and Operation Guide</a></p> <p>Comprehensive guide for installing, operating, and maintaining the Orbit Voyager Gear Drive Sprinkler. Includes instructions on pattern and distance adjustment, nozzle replacement, filter cleaning, and technical specifications.</p>
	<p><a href="#">Orbit Garden Enforcer Motion Activated Sprinkler User Manual</a></p> <p>Comprehensive guide to setting up, operating, and troubleshooting the Orbit Garden Enforcer motion-activated sprinkler. Learn about its features, installation, and optimal usage for pest deterrence and garden watering.</p>

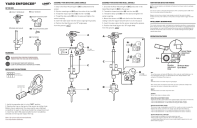

### [Orbit Yard Enforcer Motion-Activated Sprinkler: Installation and Operation Guide](#)

Learn how to install, set up, and operate your Orbit Yard Enforcer motion-activated sprinkler to effectively deter pests. This guide covers assembly, operation modes, placement, troubleshooting, and important safety warnings.