

Sena TUFFTALK-02

Sena Tufftalk Hard Hat Mount Earmuff User Manual

Model: TUFFTALK-02



INTRODUCTION

The Sena Tufftalk Hard Hat Mount Earmuff is designed for clear, long-range Bluetooth communication in noisy environments. It integrates advanced noise control and hearing protection with wireless communication capabilities, allowing users to maintain situational awareness while communicating effectively. This manual provides instructions for setup, operation, and maintenance of your Tufftalk device.

PACKAGE CONTENTS

Before proceeding, ensure all components are present:

- Tufftalk Hard Hat Mount Earmuff with Long-Range Bluetooth Communication
- Dual Battery Charger
- Rechargeable Battery 1100 (2 included)
- USB Power & Data Cable (Micro USB type)
- Microphone Sponges (5pcs)
- Tufftalk Replacement Ear Pads Kit (2 included)
- Tufftalk Battery Cover
- Tufftalk Antennas
- Tufftalk Hard Hat Mount Bracket

SETUP

1. Initial Charging

Before first use, fully charge the Tufftalk battery. Connect the USB Power & Data Cable to the Dual Battery Charger, then plug the charger into a power source. Insert the rechargeable battery into the charger. A full charge takes approximately 2.5 hours. The battery can also be charged while installed in the earmuff.

2. Hard Hat Mounting

Attach the Tufftalk earmuff to a compatible hard hat using the provided Tufftalk Hard Hat Mount Bracket. Ensure the earmuff is securely fastened and positioned for comfortable use and optimal hearing protection.



Image: Sena Tufftalk Hard Hat Mount Earmuff. This image displays the black earmuff unit with its hard hat mounting brackets and attached microphone boom.

3. Antenna Installation

Install the appropriate antenna for your communication needs. The default antenna provides a range of 800 meters, while an optional long antenna can extend the range up to 1.4 kilometers.

4. Powering On/Off

- **To Power On:** Press and hold the Power Button until the LED indicator illuminates.
- **To Power Off:** Press and hold the Power Button until the LED indicator turns off.

OPERATING INSTRUCTIONS

1. Bluetooth Pairing

To pair the Tufftalk with a Bluetooth-enabled device (e.g., smartphone, other Tufftalk units):

1. Ensure the Tufftalk is powered off.
2. Press and hold the Phone Button and the (+) Button simultaneously for 5 seconds until the LED flashes red and blue, indicating pairing mode.
3. On your Bluetooth device, search for "Sena Tufftalk" and select it to pair.
4. Once paired, the LED will flash blue.

2. Intercom Communication

The Tufftalk supports four-way intercom communication. For optimal performance, ensure all units are within range and properly paired.

- **Starting Intercom:** Briefly press the Intercom Button on your unit.
- **Ending Intercom:** Briefly press the Intercom Button again.
- **Universal Intercom:** The Tufftalk can connect with non-Sena Bluetooth headsets using Universal Intercom mode. Refer to the full user guide on the Sena website for detailed instructions.

3. Ambient Mode

The Ambient Mode feature allows you to hear important external sounds while still benefiting from hearing protection. This increases situational awareness.

- **Activating Ambient Mode:** Press the Ambient Mode Button.
- **Deactivating Ambient Mode:** Press the Ambient Mode Button again.

4. Advanced Noise Control

Sena's Advanced Noise Control technology filters out external noise, ensuring clear audio for both incoming and outgoing communication. This feature operates automatically.

5. Two-Way Radio Connection

The Tufftalk can be connected to a two-way radio for additional communication options. Specific connection methods may vary depending on the radio model. Consult the full user guide for detailed instructions.

MAINTENANCE

- **Cleaning:** Wipe the earmuff and microphone with a soft, damp cloth. Avoid using harsh chemicals or abrasive cleaners.
- **Ear Pad Replacement:** The Tufftalk Replacement Ear Pads Kit is included for periodic replacement to maintain comfort and acoustic seal. Follow the instructions provided with the kit for proper installation.
- **Microphone Sponges:** Replace microphone sponges as needed to ensure clear voice transmission and hygiene.
- **Battery Care:** Store the device in a cool, dry place. If storing for extended periods, charge the battery every

few months to prevent deep discharge.

TROUBLESHOOTING

- **No Power:** Ensure the battery is fully charged and correctly inserted. Try charging the unit for at least 30 minutes.
- **No Audio/Poor Audio Quality:**
 - Check volume levels on both the Tufftalk and the connected device.
 - Ensure the microphone is properly positioned and the sponge is intact.
 - Verify Bluetooth connection. If necessary, re-pair the devices.
 - Confirm Advanced Noise Control is functioning.
- **Intercom Disconnection:**
 - Ensure units are within the specified intercom range.
 - Re-establish the intercom connection by pressing the Intercom Button.
 - Check for obstructions or strong interference sources.
- **Bluetooth Pairing Issues:**
 - Ensure the Tufftalk is in pairing mode (LED flashing red and blue).
 - Delete previous pairings from your device's Bluetooth list and attempt to pair again.
 - Restart both the Tufftalk and the Bluetooth device.

SPECIFICATIONS

Model Name	TUFFTALK
Item Model Number	TUFFTALK-02
Wireless Communication Technology	Bluetooth 4.1
Intercom Range	Up to 1.4 km (with optional long antenna), 800m (default antenna)
Noise Attenuation	25 dB
Battery Life	15 Hours
Charging Time	2.5 Hours
Control Type	Noise Control, Voice
Item Weight	0.4 Kilograms (14.1 ounces)
Product Dimensions	4.5 x 6.5 x 8.8 inches
Included Batteries	2 Lithium Polymer batteries (rechargeable)

SUPPORT

For further assistance, detailed user manuals, firmware updates, and warranty information, please visit the official Sena website:

www.sena.com

Please note that specific warranty terms and conditions may apply and are available on the manufacturer's website.



Related Documents - TUFFTALK-02

	<p>Sena Tufftalk Industrial Bluetooth Communication System Quick Start Guide</p> <p>Concise guide to setting up and using the Sena Tufftalk industrial Bluetooth communication system, covering preparation, basic operation, pairing, intercom, radio functions, settings, and troubleshooting.</p>
	<p>Sena Tufftalk M Over-the-Head Earmuff Quick Start Guide</p> <p>Comprehensive quick start guide for the Sena Tufftalk M Over-the-Head Earmuff. Learn how to set up, pair, and operate features like Bluetooth, Mesh Intercom, Audio Multitasking, and manage calls and music. Includes detailed button operation instructions and troubleshooting tips.</p>
	

BASIC OPERATION

Operating the Buttons



Turning On/Off the Headset



Adjusting the Volume



Checking the Battery Level



Charging the Battery



PAIRING

Pairing with Mobile Devices - Phone, Music

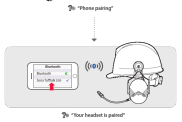
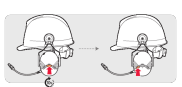

Using Phone Features

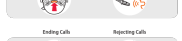

Using the Speed Dial



Listening to Music



INTERCOM

Pairing with Other Headsets

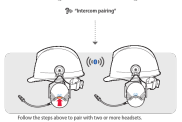
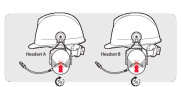

Using the Intercom

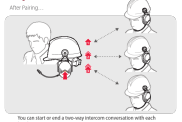

Using the Group Intercom

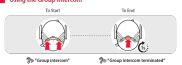

RADIO

Turning On/Off the FM Radio



Seeking Stations



Sena Tufftalk Lite Hard Hat Mount Earmuff: Quick Start Guide

Concise guide to setting up and operating the Sena Tufftalk Lite industrial Bluetooth communication system, featuring intercom, music sharing, and noise control.

■ Listening to Preset Stations



■ Setting or Deleting Stations



■ SETTING

■ Using the headset



■ TROUBLESHOOTING

■ Factory Reset

■ Fault Reset



 SENNA Technologies, Inc.
Customer Support: sennasupport@sennatalk.com

QUICK REFERENCE

Type	Operation	Action/Comment
Basic Operation	Power on	Press and hold the On/Off button and the Power Button for 3 seconds.
	Power off	Tap the On/Off button and the Center Button.
	Make an outgoing call	Tap the On/Off button or the On/Off button.
	Answer incoming phone call	Tap the Center Button.
Mobile Phone	End mobile phone call	Press and hold the Center Button for 3 seconds.
	Answer call	Press and hold the Center Button for 3 seconds.
	Answer call	Press and hold the Center Button for 3 seconds.
	Answer incoming call	Press and hold the Center Button for 3 seconds.
Music	Play/Pause Bluetooth music	Press and hold the Center Button for 3 seconds.
	Track forward/backward	Press and hold the On/Off button or the On/Off button for 3 seconds.

Type	Operation	Action/Comment
Bluetooth	Bluetooth pairing	Press and hold the Center Button for 3 seconds.
	Start Bluetooth connection	Tap the Center Button or tap the On/Off button.
	Start Bluetooth connection	Tap the Center Button.
	Bluetooth on/off	Press and hold the On/Off button for 3 seconds.
FM Radio	Select preset	Press and hold the Center Button for 3 seconds.
	Search for a station	Press and hold the Center Button for 3 seconds.
	Seek station	Press and hold the Center Button for 3 seconds.
	Power up/Power down	Press and hold the On/Off button for 3 seconds.

1-239-4890202

[Guía del Usuario del Sistema de Comunicación Bluetooth Industrial Sena Tufftalk M](#)

Guía detallada del usuario para el sistema de comunicación Bluetooth industrial Sena Tufftalk M, que cubre la instalación, configuración, funciones como Mesh Intercom, intercomunicador, teléfono móvil, música y solución de problemas.



[Manuel d'utilisation Sena Tufftalk M - Système de communication industriel Bluetooth®](#)

Ce manuel d'utilisation fournit des instructions détaillées pour le Sena Tufftalk M, un système de communication industriel Bluetooth®. Il couvre l'installation, la configuration, les fonctions d'intercom, la radio FM, la gestion des paramètres et le dépannage.



[Sena 20S EVO Motorcycle Bluetooth Communication System User's Guide](#)

Comprehensive user's guide for the Sena 20S EVO Motorcycle Bluetooth Communication System, detailing installation, features like intercom, music sharing, voice commands, and device pairing. Learn about its advanced capabilities for motorcycle riders.

Documents - Sena – TUFFTALK-02

Tufftalk Quick Guide

Over-the-Head Earmuff Type

Hard Hat Mount Earmuff Type

Over-the-Head Earmuff Type

BASIC OPERATION

■ Operating the Buttons

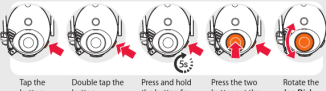

Turning On/Off the Headset

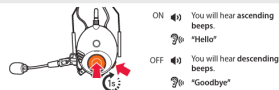

Simultaneously press and hold the Jog Dial and the Phone Button for 1 second to turn on or off the headset.

Adjusting the Volume



You will hear a beep when the volume reaches the maximum or minimum level.

Checking the Battery Level

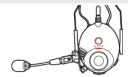

Blinking 70~100%
Blinking 30~70%
Blinking 0~30%

Turn on the headset and check the battery level via the Status LED.



"High" 70~100%
"Medium" 30~70%
"Low" 0~30%

Or, press and hold the Jog Dial and the Phone Button for 5 more seconds when the headset turns on. You will hear a triple beep and a voice prompt.

Charging the Battery

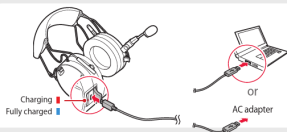

PAIRING

Pairing with Mobile Devices - Phone, Music

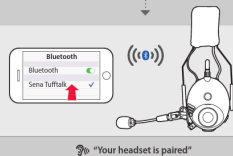
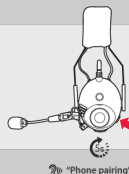

Using Phone Features

After Pairing...

Answering Calls



Ending Calls



until you hear a beep

until you hear a beep

Making Calls

Using the Phone Keypad



Using the Voice Dialer



Using the Speed Dial



You will hear a beep.

"Speed dial"

Voice Menu
- Last number redial
- Speed dial 1
- Speed dial 2
- Speed dial 3
- Cancel

Listening to Music

After Pairing...

Playing or Pausing Music



until you hear a double beep

Tracking Forward or Backward



Rotate While Pressing

INTERCOM

Pairing with Other Headsets

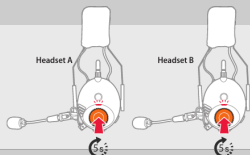

Intercom pairing

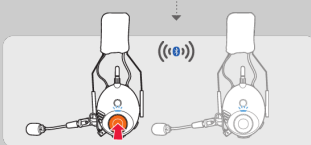

Follow the steps above to pair with two or more headsets.

Using the Intercom

After Pairing...

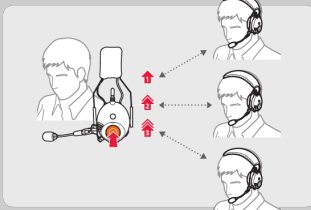

You can start or end a two-way intercom conversation with each headset.

USEFUL FUNCTIONS

Turning On/Off the Ambient Mode

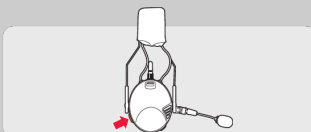

Using the Built-in Two-way Radio

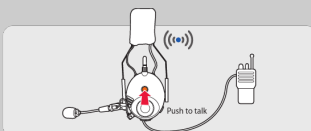

First, connect the two-way radio cable with the headset.

RADIO

Turning On/Off the FM Radio



Seeking Stations

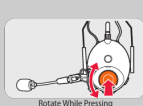

Rotate While Pressing

Listening to Preset Stations

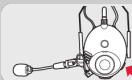

Saving or Deleting Stations

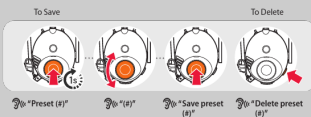

SETTING

Method1) Using the headset

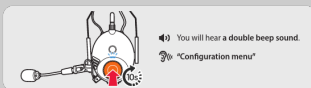

Method2) Using the Sena Device Manager

Connect the headset to your computer via a USB cable. Launch the Sena Device Manager and click DEVICE SETTING to configure the headset settings.

For details about downloading the Sena Device Manager, refer to the leaflet included in the package.

Method3) Using the Sena Industrial App

1. On your smartphone, download the Sena Industrial App for Android or iPhone from Google Play or App Store. Refer to sena-industrial.com for more details.
2. Pair your smartphone with the headset.
3. Run the Sena Industrial App. Swipe the screen to the right and tap Settings to configure the headset settings.

TROUBLESHOOTING

Factory Reset

If you want to restore the Tufftalk to factory default settings, press and hold the Phone Button for 10 seconds. Tap the Jog Dial. The headset automatically restores the default settings and turns off.

Fault Reset

If the Tufftalk is not working properly for any reason, push the pin-hole reset button located below the left ear cup.



OPTIONAL CABLE ACCESSORIES

TUFFTALK-A0110 2-way Radio Cable for Kenwood Twin-pin Connector	TUFFTALK-A0114 2-way Radio Cable for Yaesu Single-pin Connector
TUFFTALK-A0111 2-way Radio Cable for Motorola Twin-pin Connector	TUFFTALK-A0115 2-way Radio Cable for Midland Twin-pin Connector
TUFFTALK-A0112 2-way Radio Cable for Motorola Single-pin Connector	TUFFTALK-A0116 2-way Radio Cable with an Open End
TUFFTALK-A0113	TUFFTALK-A0117 2-way Radio Cable with Straight Type for

2-way Radio Cable for Icom Twin-pin Connector

Midland or Icom Twin-pin Connector

Hard Hat Mount Earmuff Type

BASIC OPERATION

Operating the Buttons

Tap the button Double tap the button Press and hold the button for 5 seconds Press the two buttons at the same time Rotate the Jog Dial

Turning On/Off the Headset

ON You will hear ascending beeps. "Hello"

OFF You will hear descending beeps. "Goodbye"

Simultaneously press and hold the Jog Dial and the Phone Button for 1 second to turn on or off the headset.

Adjusting the Volume

You will hear a beep when the volume reaches the maximum or minimum level.

Checking the Battery Level

Blinking 70~100%

Blinking 30~70%

Blinking 0~30%

Turn on the headset and check the battery level via the Status LED.

"High" 70~100%

"Medium" 30~70%

"Low" 0~30%

Or, press and hold the Jog Dial and the Phone Button for 5 more seconds when the headset turns on. You will hear a triple beep and a voice prompt.

Charging the Battery

Charging Fully charged

OT AC adapter

PAIRING

Pairing with Mobile Devices - Phone, Music

"Phone pairing"

"Your headset is paired"

Using Phone Features

After Pairing...

Answering Calls

OR OR "Hello"

Ending Calls

OR

Rejecting Calls

until you hear a beep

Making Calls

Using the Phone Keypad

Using the Voice Dialer

Using the Speed Dial

You will hear a beep. "Speed dial"

Voice Menu

- Last number redial
- Speed dial 1
- Speed dial 2
- Speed dial 3
- Cancel

Listening to Music

After Pairing...

Playing or Pausing Music

until you hear

Tracking Forward or Backward

Rotate While

[pdf] Guide

Sena Modern Black One Size TUFFTALK 02 User Guide Sena A1oF W DdJL m media amazon images I

|||

Tufftalk Quick Guide Over-the-Head Earmuff Type Hard Hat Mount Earmuff Type Over-the-Head Earmuff Type BASIC OPERATION Operating the Buttons Tap the button Double tap the button Press and hold the button for 5 seconds Press the two buttons at the same time Rotate the Jog Dial Turning On/Off th...

lang:en score:36 filesize: 1.82 M page_count: 1 document date: 2022-08-17



INTERCOM

Pairing with Other Headsets

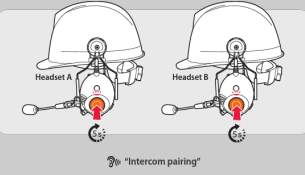

"Intercom pairing"

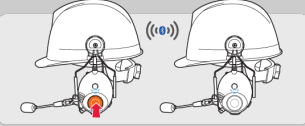

Follow the steps above to pair with two or more headsets.

Using the Intercom

After Pairing...

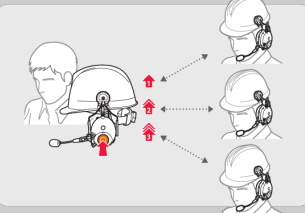

You can start or end a two-way intercom conversation with each headset.

USEFUL FUNCTIONS

Turning On/Off the Ambient Mode

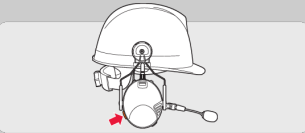

Using the Built-in Two-way Radio

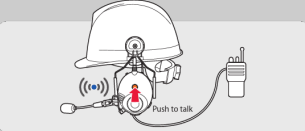

First, connect the two-way radio cable with the headset.

RADIO

Turning On/Off the FM Radio



You will hear a double beep sound.
"FM on" or "FM off"

Seeking Stations

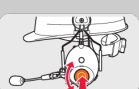

Rotate While Pressing

Listening to Preset Stations

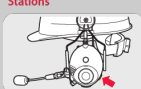

Saving or Deleting Stations

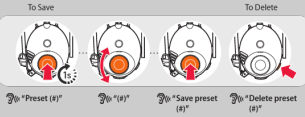

SETTING

Method1) Using the headset



You will hear a double beep sound.
"Configuration menu"

Method2) Using the Sena Device Manager

Connect the headset to your computer via a USB cable. Launch the Sena Device Manager and click DEVICE SETTING to configure the headset settings.

For details about downloading the Sena Device Manager, refer to the leaflet included in the package.

Method3) Using the Sena Industrial App

1. On your smartphone, download the Sena Industrial App for Android or iPhone from Google Play or App Store. Refer to senaindustrial.com for more details.
2. Pair your smartphone with the headset.
3. Run the Sena Industrial App. Swipe the screen to the right and tap Settings to configure the headset settings.

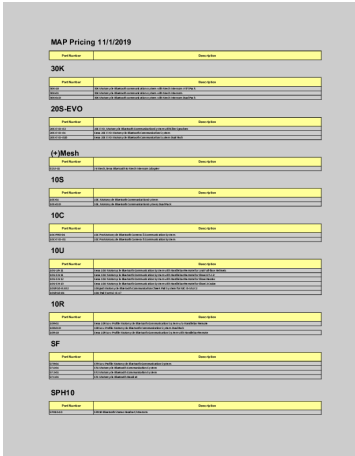

Lemos Tufftalk Overview2 Tom SAFE AND EFFECTIVE INTERCOM COMMUNICATION PROVIDING POWERFUL THE INDUSTRIAL IDEAL Sena s 24dB NRR 31dB SNR hearing protection offers safety from harmful noise while the ambient mode feature allows users to amplify external sounds generating a greater sense lemosint 2018 12 of awareness and surroundings so important alarms or calls can be heard remains

lang:en score:19 filesize: 219.88 K page_count: 2 document date: 2019-03-11

MAP Price List 2019 Luis map price list 32922ae2 3d3a 47b3 ae17 c2f08a9200bd staging sena s3
amazonaws docs default source policies |||

lang:en score:18 filesize: 51.84 K page_count: 3 document date: 2019-11-06

