

## Daewoo KOR-6LYB

# Daewoo KOR-6LYB Microwave Oven User Manual

Model: KOR-6LYB

## IMPORTANT SAFETY INSTRUCTIONS

Before operating your Daewoo KOR-6LYB microwave oven, please read all instructions thoroughly to ensure safe and efficient use. Keep this manual for future reference.

- Do not attempt to operate this oven with the door open, as this can result in harmful exposure to microwave energy.
- Do not place any object between the oven front face and the door, or allow soil or cleaner residue to accumulate on sealing surfaces.
- Do not operate the oven if it is damaged, especially the door, hinges, or seals. Contact qualified service personnel for repair.
- Ensure proper ventilation around the microwave. Do not block air vents.
- Do not heat liquids or other foods in sealed containers, as they are liable to explode.
- Always supervise children when they are using the microwave oven.
- Use only microwave-safe cookware.

## PRODUCT OVERVIEW

The Daewoo KOR-6LYB is a compact and efficient microwave oven designed for everyday cooking and reheating tasks. It features a user-friendly control panel and multiple cooking functions.

### Components

- Oven Door
- Door Latch System
- Oven Window
- Control Panel
- Turntable Ring
- Glass Turntable Tray

- Oven Light
- Waveguide Cover (inside oven)



**Figure 1:** Front view of the Daewoo KOR-6LYB Microwave Oven, showcasing the door, window, and control panel on the right side.



**Figure 2:** Close-up of the control panel, featuring a digital display, number pad, power settings, defrost options, and auto-cook menu buttons.

## SETUP AND INSTALLATION

---

Follow these steps to properly set up your microwave oven:

1. **Unpacking:** Carefully remove all packaging materials from the oven and its accessories. Check the oven for any signs of damage, such as dents or a misaligned door. Do not operate if damaged.
2. **Placement:** Place the microwave oven on a flat, stable surface that can support its weight. Ensure there is at least 10 cm (4 inches) of space at the rear, 20 cm (8 inches) on the top, and 5 cm (2 inches) on the sides for adequate ventilation. Do not place it near heat sources or in damp areas.
3. **Power Connection:** Plug the power cord into a grounded electrical outlet. Ensure the voltage matches the specifications of your microwave oven. Do not use extension cords or adapters.
4. **Turntable Installation:** Place the turntable ring in the center of the oven cavity. Then, place the glass turntable tray securely on top of the ring. Ensure it rotates freely.

## OPERATING YOUR MICROWAVE OVEN

---

### Control Panel Functions

- **Potencia:** Adjusts microwave power level.
- **Descong.:** Activates defrosting functions.
- **Reloj:** Sets the clock.
- **Number Pad (1-9, 0):** Used to enter cooking times or select auto-cook options.
- **PARAR/Borrar:** Stops cooking or clears settings.
- **INICIO/+30Seg:** Starts cooking or adds 30 seconds to cooking time.
- **COCCIÓN AUTO:** Accesses pre-programmed auto-cook menus.

### Basic Microwave Cooking

1. Place food in a microwave-safe container on the glass turntable. Close the door securely.
2. Enter the desired cooking time using the number pad.
3. Press the 'Potencia' button repeatedly to select the desired power level (e.g., P100 for full power, P80 for 80% power).
4. Press 'INICIO/+30Seg' to start cooking. The oven will beep when cooking is complete.

### Defrosting

1. Place the frozen food in a microwave-safe container on the turntable.
2. Press the 'Descong.' button.
3. Enter the weight of the food using the number pad.
4. Press 'INICIO/+30Seg' to start defrosting. The oven may prompt you to turn the food halfway through the cycle.

### Auto Cook Menu

The 'COCCIÓN AUTO' feature provides pre-programmed settings for common food items:

- 1. Palomitas (Popcorn)
- 2. Pan (Bread)

- 3. Sopa (Soup)
- 4. Papas Cocidas (Baked Potatoes)
- 5. Vegetales Frescos (Fresh Vegetables)
- 6. Vegetales Congelados (Frozen Vegetables)

1. Place the food in the oven.
2. Press the 'COCCIÓN AUTO' button.
3. Select the desired menu item by pressing the corresponding number on the number pad.
4. Press 'INICIO/+30Seg' to start.

### Setting the Clock

1. Press the 'Reloj' button once.
2. Use the number pad to enter the current time (e.g., 12:30).
3. Press the 'Reloj' button again to confirm.

## CARE AND MAINTENANCE

---

Regular cleaning and maintenance will ensure the longevity and optimal performance of your microwave oven.

### Exterior Cleaning

Wipe the exterior surfaces with a soft, damp cloth. Avoid using harsh detergents or abrasive cleaners, as they can damage the finish.

### Interior Cleaning

Clean the interior cavity, door seals, and turntable regularly. For spills, wipe immediately with a damp cloth. For stubborn food residue, place a bowl of water with a few lemon slices inside and microwave for 2-3 minutes. The steam will loosen the residue, making it easier to wipe clean. The glass turntable tray can be removed and washed with warm, soapy water.

### Odor Removal

To remove odors, place a bowl containing a mixture of water and lemon juice or baking soda in the oven and microwave for several minutes. This will help neutralize unpleasant smells.

## TROUBLESHOOTING GUIDE

---

If you encounter any issues with your microwave oven, refer to the table below for common problems and solutions.

Problem	Possible Cause	Solution
Oven not starting	Door not closed properly; Power cord unplugged; Blown fuse/tripped circuit breaker.	Ensure door is firmly closed; Check power cord connection; Check household fuse/circuit breaker.

Problem	Possible Cause	Solution
Food not cooking or heating unevenly	Incorrect cooking time/power level; Food not stirred/rotated; Waveguide cover dirty.	Adjust time/power; Stir or rotate food; Clean waveguide cover.
Oven light not working	Light bulb burned out.	Contact qualified service personnel for bulb replacement.
Unusual noise during operation	Turntable not correctly placed; Foreign object in oven cavity.	Re-position turntable; Remove any foreign objects.

## PRODUCT SPECIFICATIONS

- **Brand:** Daewoo
- **Model Number:** KOR-6LYB
- **Color:** White
- **Installation Type:** Countertop
- **Control Type:** Button
- **Dimensions (Package):** 49.8 x 35.2 x 28.8 cm
- **Weight (Package):** 9.48 kg



**Figure 3:** Diagram illustrating the dimensions of the Daewoo KOR-6LYB Microwave Oven, showing a height of 11 inches (27 cm).

## WARRANTY AND CUSTOMER SUPPORT

For warranty information, service, or technical support, please refer to the warranty card included with your product or contact Daewoo customer service directly. Keep your purchase receipt as proof of purchase.

## Related Documents - KOR-6LYB

 <p>Service Manual Microwave Oven Models KOR-631G, KOR-631H, KOR-631G9, KOR-631H9, KOR-861G, KOR-861H</p>	<p><a href="#">Daewoo Microwave Oven Service Manual</a></p> <p>Comprehensive service manual for Daewoo microwave ovens, covering models KOR-631G, KOR-631H, KOR-631G9, KOR-631H9, KOR-861G, and KOR-861H. Includes safety precautions, specifications, external views, feature diagrams, control panel layouts, installation guides, operations, disassembly and assembly procedures, troubleshooting, measurement and test procedures, component testing, wiring diagrams, and PCB information.</p>
 <p>Service Manual Microwave Oven Models KOR-630A, KOR-860A, KOR-630A9A, KOR-860A9A</p>	<p><a href="#">Daewoo Microwave Oven Service Manual - Models KOR-630A, KOR-860A Series</a></p> <p>Comprehensive service manual for Daewoo microwave ovens, covering models KOR-630A1A, KOR-630A0A, KOR-860A1A, KOR-860A0A, and KOR-630A9A. Includes safety precautions, specifications, installation, operation, disassembly, troubleshooting, testing procedures, and parts lists.</p>
 <p>Service Manual Microwave Oven Models KOR-63D79S, KOR-63D70S, KOR-63F79S, KOR-63F70S</p>	<p><a href="#">DAEWOO Microwave Oven Service Manual: KOR-63D79S, KOR-63D70S, KOR-63F79S, KOR-63F70S</a></p> <p>Comprehensive service manual for DAEWOO microwave ovens, models KOR-63D79S, KOR-63D70S, KOR-63F79S, and KOR-63F70S. Covers specifications, installation, operation, disassembly, troubleshooting, and component testing.</p>
 <p>Service Manual Microwave Oven Models KOR-6115, KOR-61151</p>	<p><a href="#">DAEWOO KOR-6115 &amp; KOR-61151 Microwave Oven Service Manual</a></p> <p>Detailed service manual for DAEWOO KOR-6115 and KOR-61151 microwave ovens, covering specifications, installation, operation, troubleshooting, and parts lists for qualified service personnel.</p>
 <p>DAEWOO Cuptor cu microunde MANUAL DE INSTRUCȚIUNI Model: KOR-91RBK-2 / KOR-91RBS-2 INSTRUCȚIUNI IMPORTANTE DE SIGURANȚĂ CITI CU ATENȚIE ÎN PRIMUL DOCUMENT PENTRU A ÎNȚELES LA UTILIZARE</p>	<p><a href="#">Daewoo Microwave Oven KOR-91RBK-2 / KOR-91RBS-2 User Manual</a></p> <p>This manual provides important safety instructions, installation guidelines, operating procedures, cleaning and maintenance tips, and troubleshooting advice for the Daewoo Microwave Oven models KOR-91RBK-2 and KOR-91RBS-2.</p>

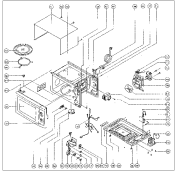

[Daewoo KOR.6C275S Microwave Oven Exploded View and Parts List](#)

Detailed exploded view diagram and parts list for the Daewoo KOR.6C275S microwave oven, identifying key components for repair and maintenance.