



Manuals.plus /

› LAVIEVERT /

› Lavievert Children's Canvas Teepee Play House Instruction Manual (Model 6788604)

## LAVIEVERT 6788604

# Lavievert Children's Canvas Teepee Play House Instruction Manual (Model 6788604)

*Comprehensive guide for assembly, use, and care of your Lavievert Teepee.*

## 1. PRODUCT OVERVIEW

The Lavievert Children's Canvas Teepee Play House provides a private and imaginative space for children. Constructed with durable canvas and pine poles, it features a five-sided design, a window, and internal slip pockets for storage. This manual provides instructions for proper assembly, usage, and maintenance.



Image 1.1: The Lavievert Teepee Play House, showcasing its outdoor setup with decorative flags and toys inside.

## 1.1 Package Contents

Ensure all components are present before beginning assembly:

- 1 x Cotton Canvas Cover
- 1 x Canvas Carry Bag
- 5 x Perforated Pine Poles (91 x 2 cm / 35.82 x 0.78 inch)
- 5 x Imperforated Pine Poles (91 x 2 cm / 35.82 x 0.78 inch)
- 5 x Durable Plastic Connectors
- 1 x Sturdy Cotton Rope
- 1 x Cushion Cover (requires polyfill or 18x18 cushion, not included)
- 1 x Decorative Flag (banner)
- 1 x Specification (Instruction Manual)



Image 1.2: All components included with the Lavievert Teepee Play House, neatly arranged for inspection.

## 2. ASSEMBLY INSTRUCTIONS

Follow these steps to assemble your Lavievert Teepee Play House:

1. **Unpack Components:** Remove all items from the canvas carry bag and lay them out on a clean, flat surface.
2. **Connect Pine Poles:** Connect each pair of pine poles (one perforated and one imperforated) using a durable plastic connector. Ensure they are securely joined. You will have 5 long poles.
3. **Insert Poles into Canvas:** Lay the cotton canvas cover flat. Slide the connected poles through the side seams of the canvas cover. The perforated end of each pole should be at the top of the teepee.
4. **Thread Cotton Rope:** Take the sturdy cotton rope. Thread it through the pre-drilled holes at the top of the 5 pine poles, one by one.
5. **Secure Poles:** Once the rope is threaded through all 5 poles, pull the rope tightly to bring the poles together at the top. Tie the rope securely to fix the poles in place, forming the teepee structure.
6. **Position and Adjust:** Gently spread the base of the teepee to create a stable, five-sided structure. Adjust the canvas cover to ensure it is taut and evenly distributed around the poles.
7. **Attach Decorative Flag:** Tie the decorative flag (banner) to the top of the teepee poles for added decoration.

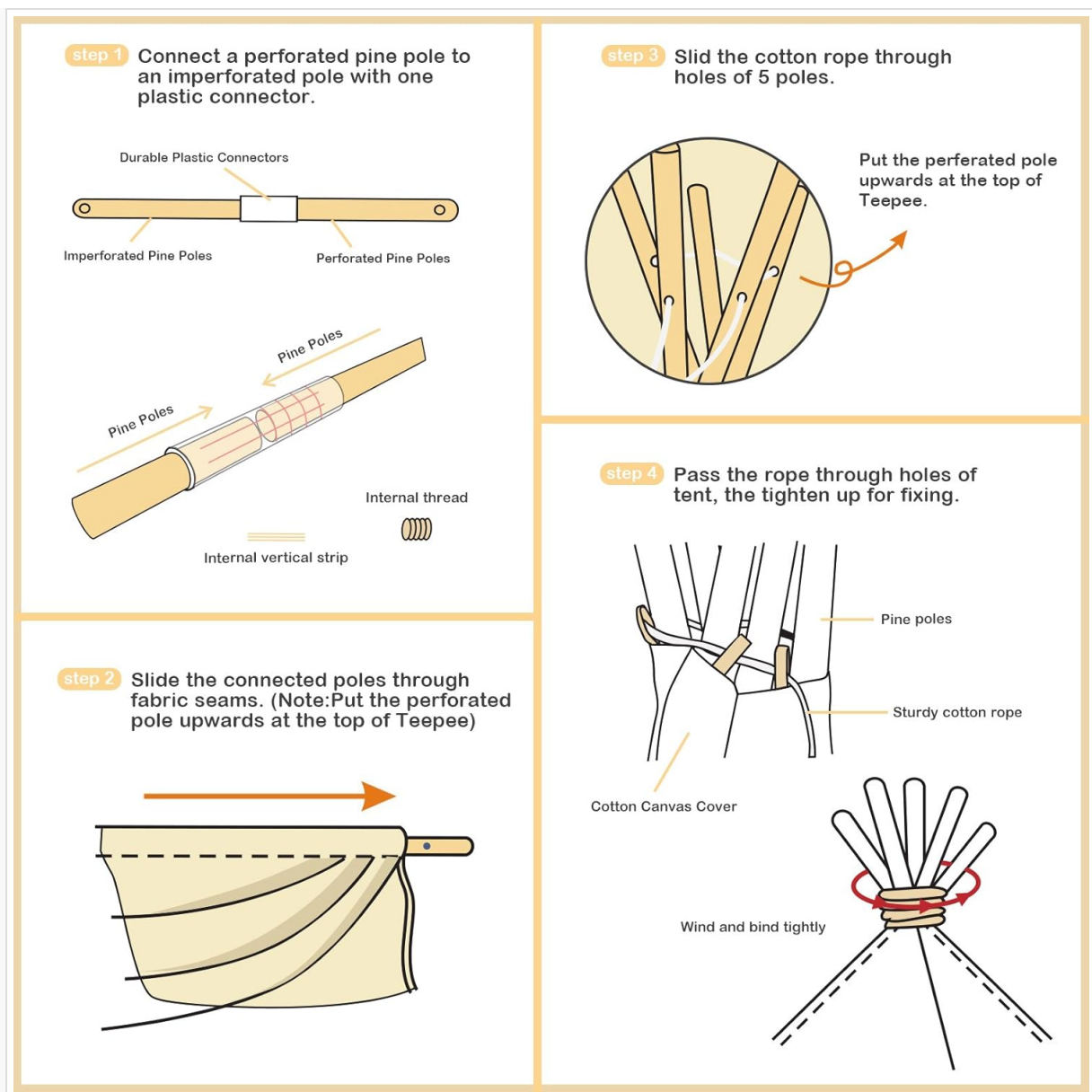

Image 2.1: Visual guide for the four main assembly steps of the Lavievert Teepee.

## 2.1 Assembly Video Guide

For a visual demonstration of the assembly process, please watch the official Lavievert video below:

Your browser does not support the video tag.

Video 2.1: Official Lavievert assembly guide for the Children's Canvas Teepee Play House, demonstrating each step from unpacking to final setup.

## 3. OPERATING INSTRUCTIONS

The Lavievert Teepee is designed for imaginative play and relaxation. Here are some features and tips for use:

- **Door and Window:** The special door and garden window can be opened or closed, allowing children to customize their private space. The window provides ventilation and a view outside.
- **Storage Pockets:** Two slip pockets are located underneath the window, ideal for storing small items like storybooks, soft toys, or snacks.
- **Indoor/Outdoor Use:** The teepee is suitable for both indoor and outdoor environments. When used outdoors, ensure it is placed on a flat, stable surface and secured if windy.

- **Portability:** For travel or storage, the teepee can be easily disassembled and packed into the included canvas carry bag.



Image 3.1: Detailed view of the teepee's features, including the window, storage pockets, and pole assembly.



Image 3.2: The teepee provides a comfortable space for children to read and play indoors.

## 4. MAINTENANCE AND CARE

To ensure the longevity and cleanliness of your teepee, follow these maintenance guidelines:

- **Cleaning the Canvas:** The cotton canvas cover can be spot cleaned with a damp cloth and mild soap. For deeper cleaning, it may be hand washed in cold water with a gentle detergent. Avoid harsh chemicals or bleach. Air dry thoroughly; do not machine dry.
- **Pole Care:** Inspect the pine poles periodically for any signs of wear or damage. Keep them dry to prevent warping or mold.
- **Storage:** When not in use, disassemble the teepee and store all components in the canvas carry bag in a dry, cool place away from direct sunlight to prevent fading or material degradation.
- **Ironing:** The canvas may become wrinkled. It can be ironed on a low setting if necessary, avoiding direct contact with any plastic components.

## 5. TROUBLESHOOTING

If you encounter any issues with your Lavievert Teepee, refer to the following common solutions:

- **Teepee is Unstable or Leaning:**
  - Ensure the plastic connectors are fully inserted into the pine poles.
  - Verify that the cotton rope at the top is tightly secured and properly tied.
  - Adjust the spread of the teepee's base to create an even, stable five-sided footprint.
  - Check that the poles are evenly distributed within the canvas sleeves.
- **Poles Appear Loose or Disconnected:**
  - Re-check the connection points of the pine poles with the plastic connectors. Apply firm pressure to ensure a snug fit.
  - Tighten the cotton rope at the top of the poles.

- **Canvas is Wrinkled:**

- The canvas can be ironed on a low heat setting. Place a cloth between the iron and the canvas if concerned about direct heat.

- **Difficulty Packing into Carry Bag:**

- Ensure the teepee is fully disassembled and the canvas is neatly folded or rolled before attempting to place it in the carry bag.

## 6. SPECIFICATIONS

Feature	Detail
Product Dimensions	37 x 7 x 4.5 inches (packaged)
Item Weight	7.93 pounds
Model Number	6788604
Manufacturer Recommended Age	36 months - 6 years
Material	Cotton Canvas, Pine Wood Poles, Plastic Connectors
Design	Five-sided with door, window, and internal slip pockets

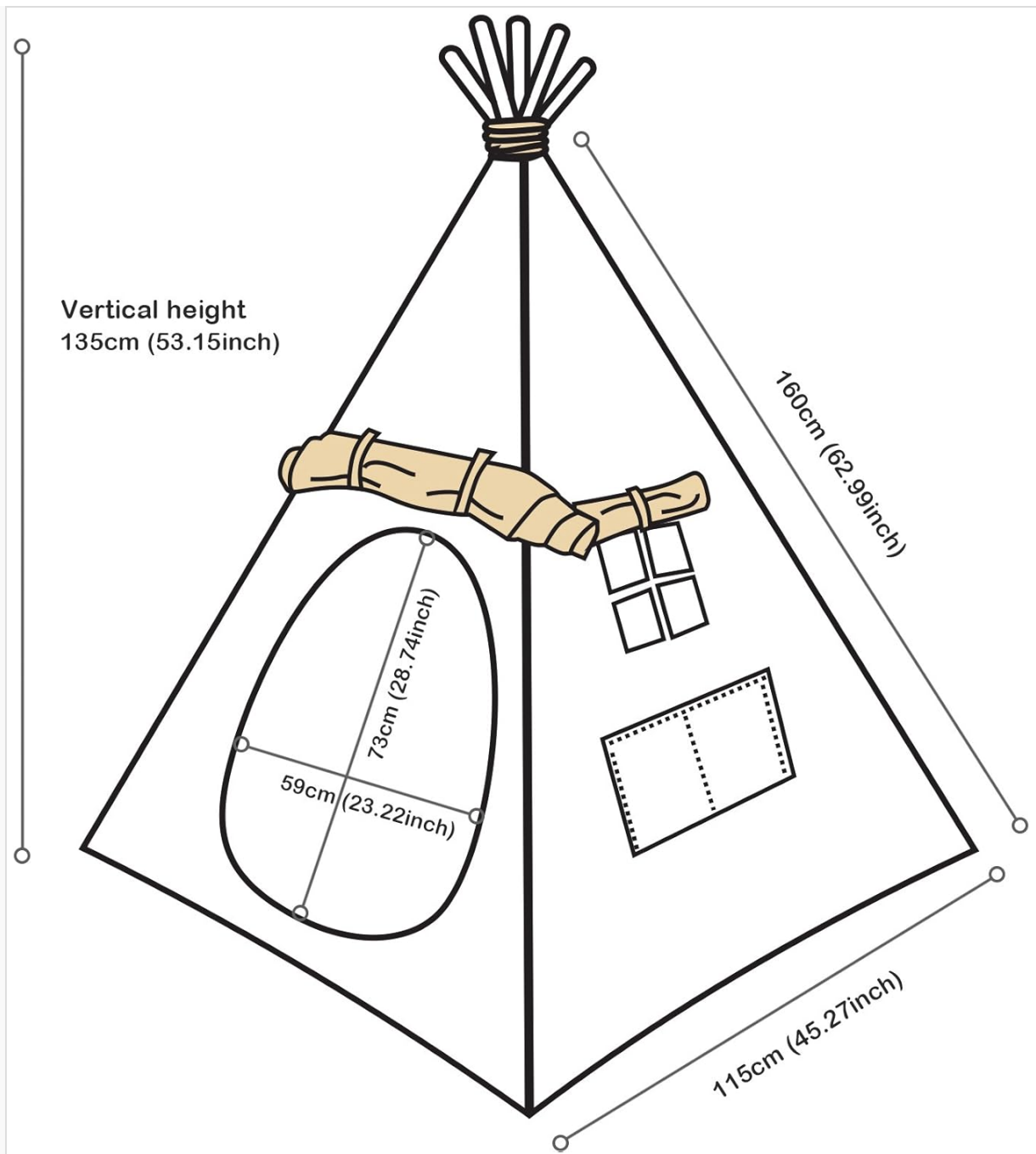

Image 6.1: Dimensional overview of the Lavievert Teepee Play House.

## 7. WARRANTY AND SUPPORT

Information regarding specific warranty details or direct customer support contacts for the Lavievert Children's Canvas Teepee Play House is not available in the provided product data. Please refer to the retailer's return policy or contact the seller directly for assistance with product issues or warranty claims.