

PDP

PDP Gaming Universal Media Remote User Manual

Model: 051-038-D1

1. INTRODUCTION

The PDP Gaming Universal Media Remote for PlayStation 4 provides a convenient way to navigate and control your PS4 system and up to three additional devices. This remote utilizes Bluetooth for PS4 control and Infrared (IR) for other devices such as your TV, cable box, and audio receiver. This manual will guide you through the setup, operation, and maintenance of your new universal media remote.

2. SETUP

2.1 Battery Installation

The remote requires two AAA batteries (not included). Follow these steps to install them:

1. Locate the battery compartment cover on the back of the remote.
2. Press down on the tab and slide the cover off.
3. Insert two AAA batteries, ensuring the positive (+) and negative (-) terminals align correctly with the indicators inside the compartment.
4. Slide the battery cover back into place until it clicks securely.



Image: Visual guide for battery installation, showing opening the cover, inserting batteries, and closing the cover.

2.2 Pairing with PlayStation 4 (Bluetooth)

To control your PlayStation 4 system, the remote must be paired via Bluetooth:

1. Ensure your PS4 system is powered on.
2. On the PS4 system, navigate to **Settings > Devices > Bluetooth Devices**.
3. On the Universal Media Remote, press the **PS4** button (located at the top left of the device buttons section). The remote's indicator light will begin to flash.
4. The PS4 system should detect the "PDP Universal Media Remote". Select it from the list of Bluetooth devices.
5. Follow any on-screen prompts to complete the pairing process. Once paired, the remote's indicator light will stop flashing and remain solid for a few seconds, then turn off.

2.3 Programming for Other Devices (IR)

The remote can control up to three additional devices (TV, AV Amplifier, Cable/Satellite Set-Top Box) using Infrared (IR) signals. Programming typically involves entering a code specific to your device's brand. Refer to the original manual of

your TV, amplifier, or cable box for compatible IR codes, or use the remote's learning function if available. The device buttons at the top of the remote (TV, AMP, CBL) are used to switch control to the respective device. The PWR button is a universal power button.

How to use the Universal Remote DEVICE buttons Switch between devices.

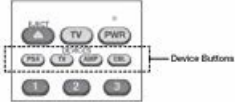

PS4™ system button	Switch the remote to operate the PS4™ system.
TV button	Switch the remote to operate a TV.
AMP button	Switch the remote to operate an AV amplifier.
CBL button	Switch the remote to operate a cable/satellite set-top box.

Buttons for operating a PS4™ system, TV, AV amplifier, or cable/satellite set-top box

The meaning of the icons shown in the table below is as follows:

(PS4) used to operate the PS4™ system
(TV) used to operate the TV
(AMP) used to operate the AV amplifier
(CBL) used to operate a cable/satellite set-top box

Operating a TV, A/V amplifier, or cable/satellite set-top box

NOTE: Some functions of your original remote may not be controlled by this remote. Use the original remote, if available, to control such functions. Sometimes buttons other than described in these instructions may actually perform the function. For example, the channel and volume buttons might be used to navigate through menu choices. We recommend you experiment with the remote to identify if such situations apply to your equipment.

Image: A diagram illustrating the device buttons (PS4, TV, AMP, CBL, PWR) and their corresponding functions for operating the PS4 system, TV, AV amplifier, or cable/satellite set-top box.

Note: Some functions of your original remote may not be controlled by this universal remote. Use the original remote, if available, to control such functions. Sometimes buttons other than described in these instructions may actually perform the function. Experiment with the remote to identify if such situations apply to your equipment.

3. OPERATION

The PDP Gaming Universal Media Remote is designed for intuitive control of your entertainment system. Below is an overview of its key features and button functions.

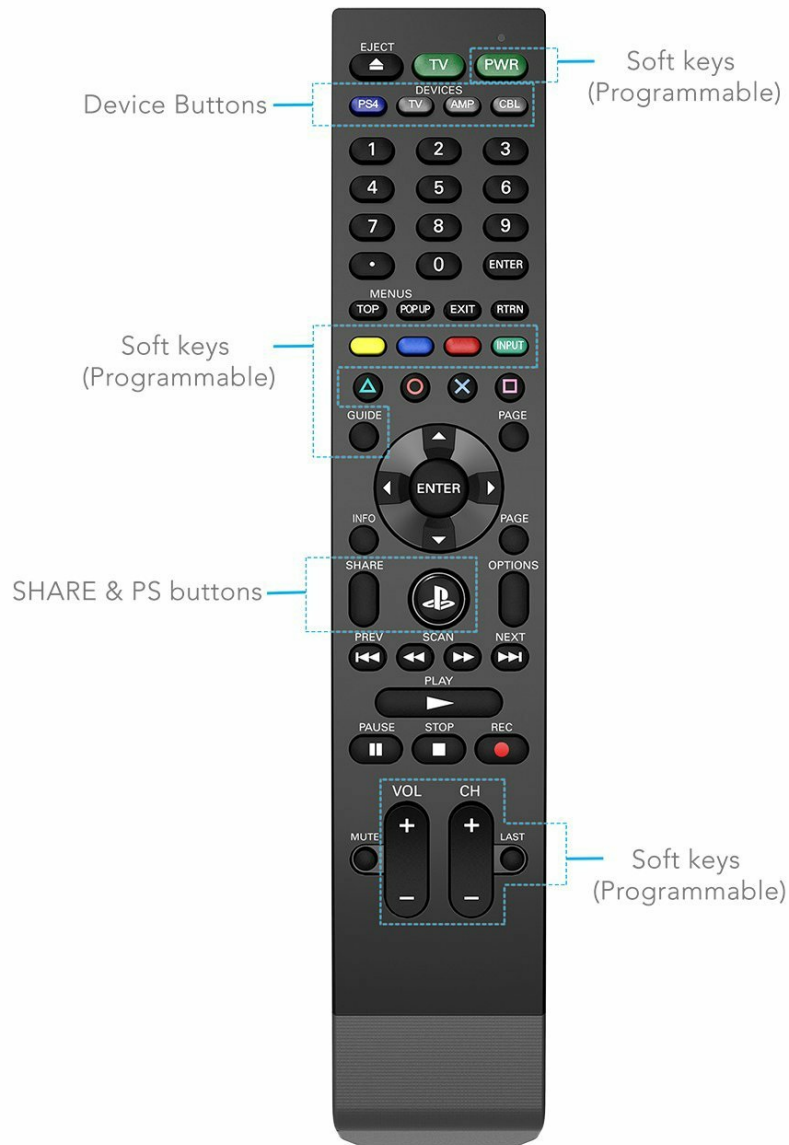



Image: The full layout of the PDP Gaming Universal Media Remote, showing all buttons and their positions.

3.1 Button Functions Overview

The remote features dedicated buttons for PlayStation 4 navigation and media control, as well as universal controls for other devices.



Control your Playstation 4 system via Bluetooth and up to three additional devices via IR- including a TV, cable box and audio receiver

Image: A detailed diagram highlighting the Device Buttons (PS4, TV, AMP, CBL, PWR), Soft Keys (Programmable), and SHARE & PS buttons on the remote.

- **Device Buttons (PS4, TV, AMP, CBL):** Select the device you wish to control. The remote will send commands to the selected device.
- **PWR:** Universal power button to turn devices on or off.
- **Number Pad (0-9):** For direct channel entry or other numerical inputs.
- **Menus (TOP, POPUP, EXIT, RTRN):** Navigation buttons for various menus.
- **Colored Buttons (Yellow, Blue, Red, Green):** Often used for specific functions within applications or menus, similar to a PS4 controller's face buttons (Triangle, Circle, X, Square).
- **Directional Pad & ENTER:** For navigating menus and confirming selections.
- **PS Button:** Wakes up the PS4 system and brings up the PS4 home screen.
- **SHARE & OPTIONS:** Replicate the SHARE and OPTIONS buttons on a PS4 controller.
- **Media Playback Controls (PREV, SCAN, NEXT, PLAY, PAUSE, STOP, REC):** Standard media control buttons for playback of movies, music, etc.
- **VOL +/- & MUTE:** Control volume and mute functions.

- **CH +/- & LAST:** Control channel selection and return to the last channel.
- **Soft Keys (Programmable):** Certain buttons on the remote are programmable, allowing you to assign custom functions. Refer to the remote's full manual for detailed instructions on programming these keys.

3.2 Switching Between Devices

To control a specific device, press the corresponding device button (PS4, TV, AMP, CBL) at the top of the remote. The remote will then send commands to that device until another device button is pressed.

3.3 Power Saving Feature

The remote features a power-saving mode. The PS4 Bluetooth functionality will enter a sleep state after 30 minutes of inactivity to conserve battery life. To wake the remote and re-establish connection with the PS4, simply press the **PS** button. The IR functionality for other devices remains active.

4. MAINTENANCE

4.1 Battery Replacement

When the remote's performance degrades or it stops responding, it's likely time to replace the batteries. Follow the battery installation steps outlined in Section 2.1. Always use fresh AAA alkaline batteries for optimal performance.

4.2 Cleaning

To clean the remote, use a soft, dry cloth. Do not use abrasive cleaners, solvents, or wet cloths, as these can damage the remote's surface or internal components.

5. TROUBLESHOOTING

Problem	Possible Cause / Solution
Remote not responding to PS4.	<ul style="list-style-type: none">• Batteries are low or dead. Replace with fresh AAA batteries.• Remote is in power-saving mode. Press the PS button to wake it up.• Remote is not paired with PS4. Re-pair the remote following steps in Section 2.2.• Ensure no obstructions are between the remote and the PS4.
Remote not controlling TV/AMP/CBL.	<ul style="list-style-type: none">• Ensure the correct device button (TV, AMP, CBL) is selected.• Remote is not programmed for the device. Re-program using the correct IR code.• Ensure no obstructions are between the remote and the device's IR receiver.• Some functions may not be compatible. Use the original remote for those specific functions.
Buttons not working as expected in certain apps.	<ul style="list-style-type: none">• Some applications may map functions to different buttons. Experiment with various buttons on the remote to find the correct function.• Consider using the remote's learning function for specific commands if supported.

6. SPECIFICATIONS

Model Number: 051-038-D1

Dimensions: 2.01 x 3.54 x 10.79 inches (5.1 x 9.0 x 27.4 cm)

Weight: 7.5 ounces (212.6 grams)

Power Source: 2 x AAA batteries (not included)

Connectivity: Bluetooth (for PS4), Infrared (IR) for other devices

Compatibility: PlayStation 4, TV, AV Amplifier, Cable/Satellite Set-Top Box

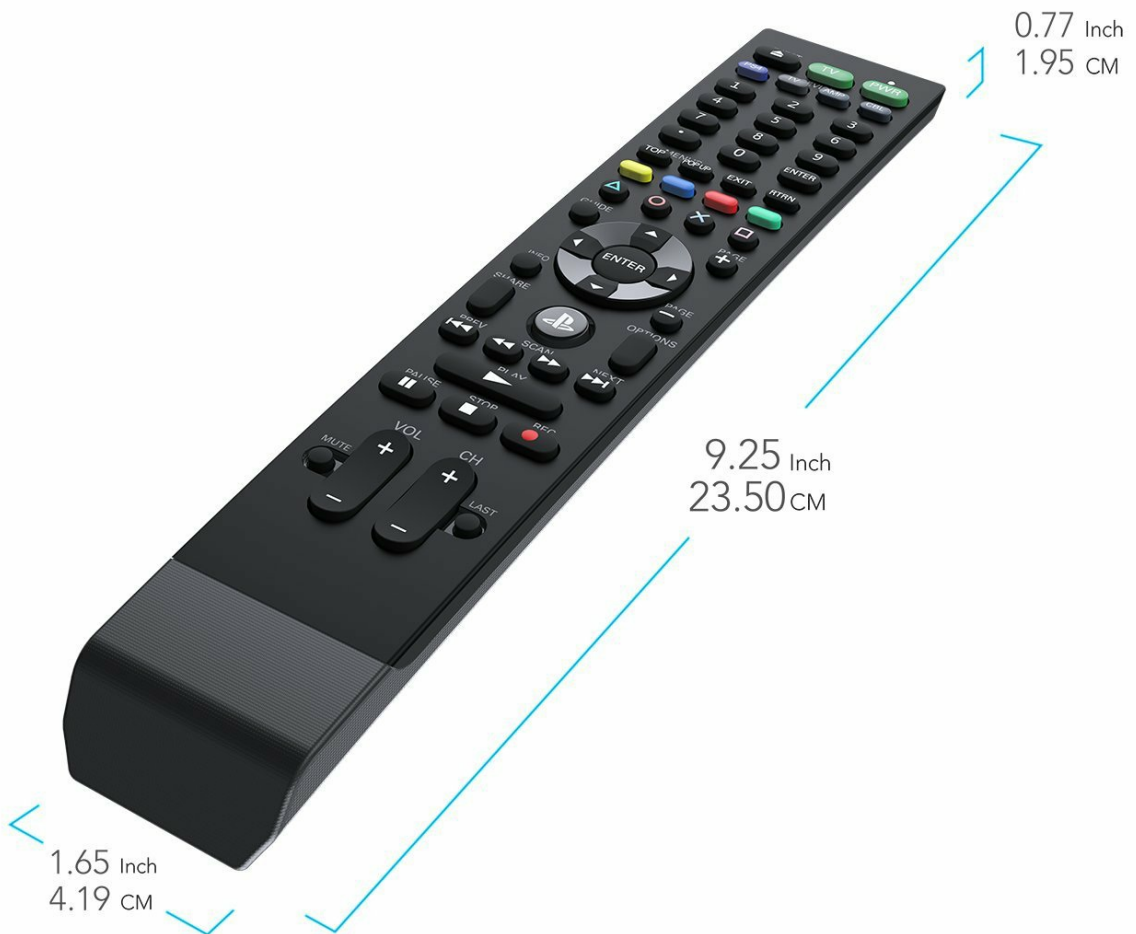







Image: The remote shown with its approximate dimensions in inches and centimeters.

7. WARRANTY AND SUPPORT

For warranty information or technical support regarding your PDP Gaming Universal Media Remote, please visit the official PDP website or contact their customer support directly. Keep your proof of purchase for any warranty claims. Official PDP Website: www.pdp.com

Related Documents -

	<p>PDP LVL50 Wireless Stereo Gaming Headset for PlayStation 5 & 4 - Quick Start Guide</p> <p>Official quick start guide for the PDP LVL50 Wireless Stereo Gaming Headset. Learn how to set up, pair, charge, and use audio and microphone settings for PlayStation 5 and PlayStation 4. Includes warranty and compliance information.</p>
	<p>PDP LVL40 Wired Stereo Gaming Headset for PlayStation Quick Start Guide</p> <p>Quick start guide and limited warranty information for the PDP LVL40 Wired Stereo Gaming Headset, compatible with PlayStation 5 and PlayStation 4.</p>
	<p>PDP Afterglow Wave Dual Charger Quick Start Guide for PlayStation 5 & 4</p> <p>This quick start guide provides instructions for setting up and using the PDP Afterglow Wave Dual Charger for PlayStation 5 and PlayStation 4 consoles, covering assembly, charging, lighting features, and troubleshooting.</p>
	<p>RIFFMASTER Wireless Guitar Controller Quick Start Guide for PlayStation 5 & 4</p> <p>Get started quickly with the PDP RIFFMASTER Wireless Guitar Controller for PlayStation 5 and PlayStation 4. This guide covers assembly, connection, features, and charging.</p>
	<p>PDP LVL50 Wired Stereo Gaming Headset Quick Start Guide</p> <p>Get started with your PDP LVL50 Wired Stereo Gaming Headset for PlayStation 4 & 5. This guide covers setup, audio controls, microphone mute, and warranty information.</p>

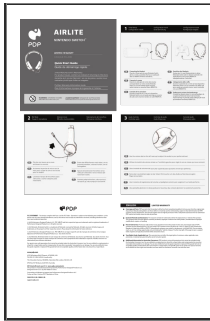

[PDP AIRLITE Wired Headset for Nintendo Switch: Quick Start Guide](#)

Get started quickly with the PDP AIRLITE Wired Headset for Nintendo Switch. This guide covers initial setup, connecting the headset, mic mute, audio controls, and warranty information.