

Amazon Basics PBH-994

Amazon Basics Heavy-Duty Tilting TV Wall Mount (PBH-994) User Manual

For 37" to 80" TVs up to 120 lbs

1. INTRODUCTION

This manual provides detailed instructions for the safe and proper installation, operation, and maintenance of your Amazon Basics Heavy-Duty Tilting TV Wall Mount, model PBH-994. Please read all instructions carefully before installation to ensure correct setup and to prevent damage or injury. Keep this manual for future reference.

2. SAFETY INFORMATION

- **Weight Capacity:** Do not exceed the maximum weight capacity of 120 lbs (54.4 kg). Exceeding this limit may result in serious injury or property damage.
- **TV Size:** This mount is designed for TVs between 37 inches and 80 inches.
- **Wall Type:** This mount is designed for installation on concrete, brick, and wood stud walls (16 & 24 inch studs). Do not install on drywall alone.
- **VESA Compatibility:** Ensure your TV's VESA mounting pattern is compatible (200x100 MM through 600x400 MM).
- **Professional Installation:** If you are unsure about the installation process or wall type, consult a qualified professional.
- **Tools:** Use appropriate tools for installation. Always wear safety glasses.
- **Children:** Keep children away from the work area during installation.

3. PACKAGE CONTENTS

Verify that all components are present and undamaged before beginning installation. If any parts are missing or damaged, do not proceed with installation and contact customer support.

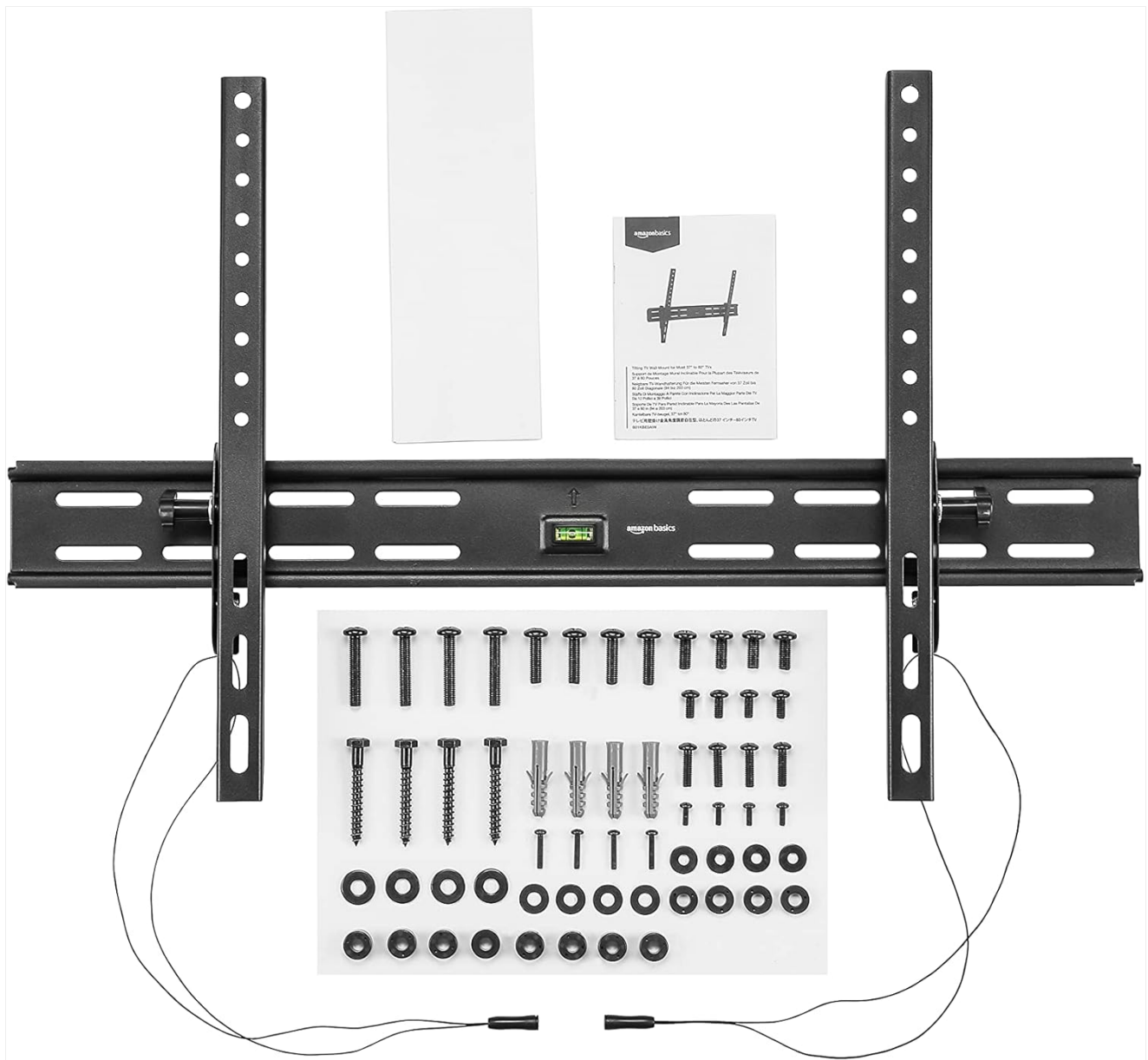

Image: All components included in the package: the wall mount assembly, various screws, washers, wall anchors, a mounting template, and the user manual.

- Wall Plate Assembly (with integrated bubble level)
- TV Brackets (2 pieces)
- Mounting Hardware Kit (various screws, washers, spacers, wall anchors)
- Mounting Template
- User Manual

4. SPECIFICATIONS

Model Number	PBH-994
TV Size Compatibility	37" - 80" (94 CM - 203 CM)
Weight Capacity	Up to 120 lbs (54.4 KG)
VESA Compatibility	200x100 MM through 600x400 MM
Mounting Type	Wall Mount

Movement Type	Tilt
Tilt Range	+15° to -3°
Wall Distance	Extends 1.8 inches from the wall
Material	Alloy Steel
Color	Black
Product Dimensions	27.95 x 1.79 x 17.71 inches
Item Weight	3.9 pounds

5. SETUP AND INSTALLATION

Before installation, ensure you have identified your wall type and the correct VESA mounting pattern for your television. A second person is highly recommended for safe installation.



Image: Front view of the Amazon Basics Tilting TV Wall Mount, featuring the horizontal wall plate with an integrated bubble level and

two vertical TV brackets attached. The brackets have multiple holes for VESA compatibility and release strings hanging below.

5.1. Prepare the TV

1. Carefully place your TV face-down on a soft, clean surface to prevent screen damage.
2. Identify the VESA mounting holes on the back of your TV.
3. Select the appropriate screws, washers, and spacers from the hardware kit that fit your TV's mounting holes.
4. Attach the two vertical TV brackets to the back of your TV using the selected hardware. Ensure the brackets are centered and securely fastened. Do not overtighten.

5.2. Prepare the Wall

1. Determine the desired height for your TV. Use the mounting template to mark the drill holes on the wall.
2. **For Wood Stud Walls:** Use a stud finder to locate the center of two adjacent wood studs (16 or 24 inches apart). Mark the drill points. Drill pilot holes using an appropriate drill bit (refer to manual for size).
3. **For Concrete/Brick Walls:** Mark the drill points. Drill holes using a masonry drill bit (refer to manual for size). Insert the provided wall anchors into the drilled holes.
4. Position the wall plate against the wall, aligning the holes. Use the integrated bubble level to ensure it is perfectly horizontal.
5. Secure the wall plate to the wall using the lag bolts and washers. Tighten firmly, but do not overtighten.



Image: The Amazon Basics Tilting TV Wall Mount is shown installed on a white wall, without a television attached. This view highlights the mount's structure and how it appears before the TV is hung.

5.3. Mount the TV

1. With assistance, carefully lift the TV and hook the TV brackets onto the top edge of the wall plate.
2. Gently lower the TV until the brackets engage with the wall plate. You should hear a click as the automatic safety lock engages.
3. Pull the release strings downwards to ensure the safety lock is engaged and the TV is securely attached.



Image: This image shows a living room corner with a TV mounted on the wall using the Amazon Basics Tilting TV Wall Mount. The TV is positioned above a media console, demonstrating the mount's low profile and clean aesthetic.

5.4. Installation Video Guide

Your browser does not support the video tag.

Video: This video provides an overview of the Amazon Basics Heavy-Duty Tilting TV Wall Mount, demonstrating its features, installation process, and tilting capabilities for televisions ranging from 37 to 80 inches.

6. OPERATING THE TILTING FUNCTION

The Amazon Basics Tilting TV Wall Mount allows for easy adjustment of your TV's vertical viewing angle.

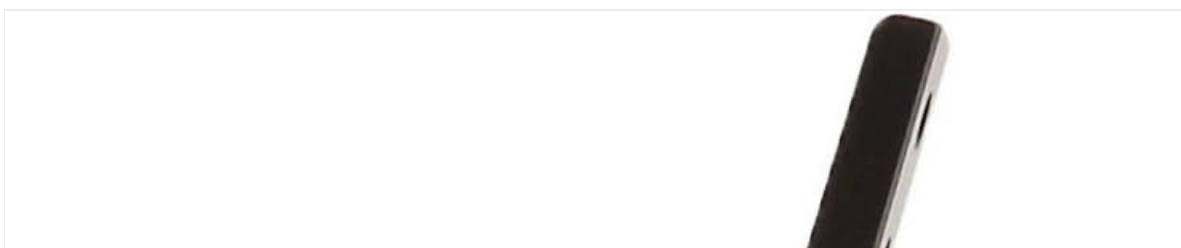



Image: A side profile of the Amazon Basics Tilting TV Wall Mount, illustrating how the TV brackets can be angled relative to the wall plate, allowing for vertical tilt adjustment.

1. To adjust the tilt, gently push or pull the top or bottom edge of your TV to achieve the desired angle. The mount offers a tilt range from $+15^{\circ}$ (upwards) to -3° (downwards).
2. The friction-based mechanism will hold the TV in place once the desired angle is set.



Image: A television is shown mounted on a wall, viewed from the side. The Amazon Basics Tilting TV Wall Mount holds the TV close to the wall, with a slight downward tilt visible.

7. MAINTENANCE

- **Cleaning:** Clean the mount with a soft, dry cloth. Avoid abrasive cleaners or solvents.
- **Periodic Inspection:** Periodically check all screws and bolts to ensure they remain tight and secure. Retighten if necessary.
- **Damage:** If any part of the mount becomes damaged, discontinue use and contact customer support.

8. TROUBLESHOOTING

- **TV Not Level:** Ensure the wall plate was installed level using the integrated bubble level. If not, minor adjustments can sometimes be made by slightly loosening and re-tightening the wall plate screws, or by adjusting the TV brackets if your TV allows.
- **Difficulty Tilting:** Check that no cables are obstructing the tilting mechanism. Ensure the TV is within the specified weight and size limits.
- **TV Not Secure:** Verify that the TV brackets are properly hooked onto the wall plate and the automatic safety locks are engaged. The release strings should hang freely.
- **Missing Parts:** If any parts were missing from the package, do not proceed with installation. Contact Amazon Basics customer support for assistance.

9. WARRANTY AND SUPPORT

For warranty information and customer support, please refer to the documentation included with your product or visit the official Amazon Basics website. You can also contact Amazon customer service for assistance with your Amazon Basics product.

Related Documents - PBH-994

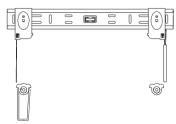
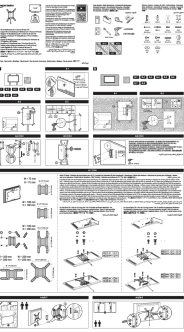
 <p>amazon basics</p> <p>Amazon Basics 32-70" Flat to Wall Low Profile TV Wall Mount</p> <p>Get detailed instructions for the Amazon Basics 32-70 inch flat to wall low profile TV wall mount. Includes safety warnings, specifications, parts list, and step-by-step installation guidance.</p>	<p>Amazon Basics 32-70" Flat to Wall Low Profile TV Wall Mount Installation & Safety Guide</p> <p>Get detailed instructions for the Amazon Basics 32-70 inch flat to wall low profile TV wall mount. Includes safety warnings, specifications, parts list, and step-by-step installation guidance.</p>
 <p>Amazon Basics 12-40" Tilt TV Wall Mount</p> <p>Comprehensive installation guide for the Amazon Basics 12-40 inch tilt TV wall mount, supporting up to 40 lbs. Includes parts list, tools required, wall type compatibility, and step-by-step assembly instructions.</p>	<p>Amazon Basics 12-40 Inch Tilt TV Wall Mount Installation Guide</p> <p>Comprehensive installation guide for the Amazon Basics 12-40 inch tilt TV wall mount, supporting up to 40 lbs. Includes parts list, tools required, wall type compatibility, and step-by-step assembly instructions.</p>

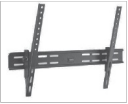

Tilting TV Wall Mount for Most 37" to 60" TVs
Support de Montage Mural Inclinaire Pour la Plupart des Téléviseurs de 37 à 60 Pouces
Neigebogen TV-Wandhalterung Für die Meisten Fernseher von 37 Zoll bis 60 Zoll Diagonale (A bis 203 cm)
Staffa Di Montaggio A Pivote Con Inclinatorio Per La Maggior Parte Dei Tv Da 37 Pollici a 60 Pollici
Telescopio de TV Para Pared Inclinaable Para La Mayoría de Las Pantallas de 37 a 60 Pulgadas (A 203 cm)
Kantelbare TV-beugel, 37" tot 60"

テレビ用傾斜壁金具取付可能型対応、ほとんどの37インチ～60インチ
Odkłonytelný uchytyvací držák do výložnatého televizoru od 37 palců do 60 palců
Ladesteg ughjettbar fôr tveiv som passar de fleste apparatør med størrelse 37 tom 60 tom

321K18 80 50m

Comprehensive guide for the Amazon Basics Tilting TV Wall Mount, covering installation, safety precautions, technical specifications, and warranty information for TVs ranging from 37 to 80 inches.

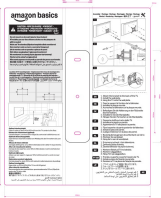

Step-by-step assembly guide for the Amazon Basics TV Wall Mount, including safety precautions, mounting hole information, and optimal viewing height recommendations.

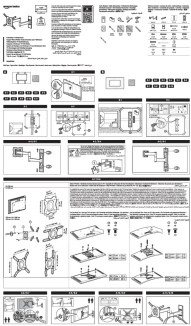

Comprehensive installation guide for the Amazon Basics fixed TV wall mount. Learn how to safely and securely mount your 12-40 inch television using this easy-to-follow manual. Includes parts list, step-by-step instructions, and safety precautions.

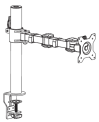

Single Member Display Mounting Art	Page	2
Box De Montage Pour Exon Single	Page	3
Einzelner Member Display Aufhängesystem	Seite	4
Boende De Montage Pour Exon Single	Page	5
Boxen De Montage Pour Exon Member	Page	6
Ambassadeur voor Einzel Beeldscherm	Page	7
Framing Montablen von Jedem Member	Seite	8
Einzel Montablen	Seite	9
シングルメンバー型展示システム	ページ	10
MEMBER TYPE DISPLAY MOUNTING ART	Page	12

Amazon Basics Single Monitor Display Mounting Arm provides a flexible and ergonomic solution for desk setups. This manual details safety, importer information, and step-by-step assembly instructions for mounting your monitor.