

Altec Lansing MZX657

Altec Lansing True Wireless Earbuds

User Manual

PRODUCT OVERVIEW

The Altec Lansing True Wireless Bluetooth Earbuds offer a cable-free listening experience with rechargeable lithium-ion batteries integrated directly into the earbuds. Designed for comfort and discretion, these earbuds are also built to withstand the elements with an IPX7 waterproof rating, making them suitable for active use. Key features include a long battery life and Bluetooth-based GPS tracking for easy recovery of misplaced earbuds.

- Model: MZX657
- Battery Life: Up to 6 hours for earbuds, with an additional 3 hours from the charging case.
- Waterproof Rating: IPX7 (submersible up to 1 meter for 30 minutes).
- Compatibility: Works with Apple, Android, Blackberry devices, tablets, and laptops.
- GPS Tracking: Locate misplaced earbuds using the dedicated app.



Image: Altec Lansing True Wireless Earbuds, black, resting inside their compact zippered charging case. The earbuds are visible in the foreground, with the case behind them.

WHAT'S IN THE BOX

Upon unboxing your Altec Lansing True Wireless Earbuds, you should find the following components:

- Altec Lansing True Wireless Earbuds (Left and Right)
- Charging Case
- Power Bank Dock
- AC Adapter
- Power Cable
- Ear Tips (Sizes S, M, L)



Image: A flat lay showing all included accessories: the zippered earbud case, the earbuds themselves on a charging dock, an AC adapter, a power cable, and multiple sets of silicone ear tips in various sizes.

SETUP

Charging the Earbuds and Case

1. Connect the provided power cable to the charging case and a suitable power source using the AC adapter.
2. Ensure the earbuds are properly seated in their respective slots within the charging case.
3. Allow the case and earbuds to charge fully before first use. A full charge provides up to 6 hours of listening time for the earbuds and an additional 3 hours from the charging case.

Bluetooth Pairing

1. Ensure the earbuds are charged and removed from the charging case. They should automatically enter pairing mode.
2. On your device (smartphone, tablet, laptop), navigate to the Bluetooth settings.
3. Search for available devices and select "Altec Lansing MZX657" (or similar name) from the list.
4. Once connected, a confirmation sound or indicator light will signify successful pairing.

Fitting the Earbuds

Select the ear tips that provide the most comfortable and secure fit. A proper seal is crucial for optimal sound quality and bass response. Experiment with the different sizes (S, M, L) included in the package.

OPERATING INSTRUCTIONS

Power On/Off

- The earbuds typically power on automatically when removed from the charging case.
- To power off, place the earbuds back into the charging case.

Audio Playback and Calls

Specific controls for playback (play/pause, skip track) and call management (answer/end call) are typically managed via the connected device or through the Altec Lansing app, as the earbuds are designed for app control.

Waterproof Functionality (IPX7)

The earbuds are IPX7 rated, meaning they are protected against immersion in water up to 1 meter for up to 30 minutes. This makes them suitable for workouts and use in light rain. Ensure the charging port is dry before charging.

GPS Tracking

To utilize the GPS tracking feature for locating misplaced earbuds, download the "Find My Earphone" app from your device's app store (Apple App Store or Google Play Store). Follow the in-app instructions to connect and track your earbuds.

MAINTENANCE

Cleaning

- Regularly clean the ear tips with a soft, damp cloth.
- Gently wipe the earbuds and charging case with a dry, lint-free cloth to remove dust and debris.
- Avoid using harsh chemicals or abrasive materials.

Storage

When not in use, store the earbuds in their charging case to protect them from damage and to keep them charged. Store in a cool, dry place away from extreme temperatures.

TROUBLESHOOTING

Problem	Possible Cause	Solution
Earbuds not powering on	Low battery; not properly seated in case.	Ensure earbuds are charged. Place them firmly in the charging case.
Cannot pair with device	Earbuds not in pairing mode; device Bluetooth off; interference.	Ensure earbuds are out of case and in pairing mode. Turn device Bluetooth off and on. Move closer to device.
No sound	Volume too low; not connected; incorrect audio output selected.	Increase volume on device. Re-pair earbuds. Check device audio settings.
Lost an earbud	Earbud misplaced.	Use the "Find My Earphone" app to track the last known location of the earbud.

SPECIFICATIONS

Feature	Detail
Model Number	MZX657
Connectivity Technology	Wireless (Bluetooth)
Wireless Communication Technology	Bluetooth
Battery Life	6 Hours (earbuds), 3 Hours (charging case additional)
Charging Time	6 Hours (for full charge of case and earbuds)
Water Resistance Level	IPX7 Waterproof
Control Method	App
Material	Plastic, Silicone
Product Dimensions	2.25 x 7.25 x 5.3 inches
Item Weight	8 ounces
Manufacturer	Altec Lansing Technologies
UPC	021331912282



WARRANTY AND SUPPORT

For warranty information, technical support, or service inquiries, please refer to the official Altec Lansing website or contact their customer support directly. Keep your proof of purchase for warranty claims.
Official Altec Lansing Website: www.alteclansing.com

© 2023 Altec Lansing. All rights reserved.

Related Documents - MZX657

	<p>Altec Lansing NanoPods MZX559 Troubleshooting Guide: Fix Bluetooth, Charging, and Pairing Issues</p> <p>Comprehensive troubleshooting guide for Altec Lansing NanoPods (MZX559) true wireless earbuds. Covers Bluetooth pairing, connection issues, charging problems, resets, and general usage FAQs.</p>
-------------------------------------------------------------------------------------	-------------------------------------------------------------------------------------------------------------------------------------------------------------------------------------------------------------------------------------------------------------------------------------------------------------------------------

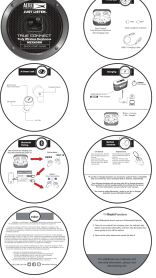
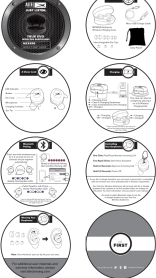
	<p>Altec Lansing AL Nanobuds 2.0 (MZ5000) Quick Start Guide</p> <p>Quick start guide for Altec Lansing AL Nanobuds 2.0 (MZ5000) wireless earbuds. Learn about Bluetooth pairing, touch controls, charging, power management, and troubleshooting.</p>
	<p>Altec Lansing MZX559 NanoPods Quick Start Guide</p> <p>A concise guide to setting up and using your Altec Lansing MZX559 NanoPods, covering Bluetooth pairing, touch controls, charging, and troubleshooting.</p>
	<p>Altec Lansing MZX635N True Connect Truly Wireless Earphones Quick Start Guide</p> <p>A quick start guide for the Altec Lansing MZX635N True Connect Truly Wireless Earphones, covering what's in the box, a closer look at the earbuds, charging, Bluetooth pairing, earbud controls, and reset functions.</p>
	<p>Altec Lansing True Evo Wireless Earphones MZX658 Quick Start Guide</p> <p>Quick start guide for Altec Lansing True Evo Wireless Earphones (MZX658), covering setup, charging, pairing, wearing, and controls.</p>



A Quick Look

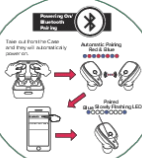

For additional user materials and warranty information, please visit altec Lansing.com

[Altec Lansing MZX635 True Connect Truly Wireless Earphones Quick Start Guide](#)

Quick start guide for Altec Lansing MZX635 True Connect Truly Wireless Earphones, covering setup, pairing, calls, charging, and music control.