

Manuals+

[Q & A](#) | [Deep Search](#) | [Upload](#)

manuals.plus /

> [Jasonwell](#) /

> [Jasonwell Foldable Pet Bath Pool L-48 Instruction Manual](#)

Jasonwell JX-US-DPBIUE120

Jasonwell Foldable Pet Bath Pool Instruction Manual

Model: L-48" (JX-US-DPBIUE120)

1. INTRODUCTION

This manual provides instructions for the safe and effective use of your Jasonwell Foldable Pet Bath Pool, Model L-48". This versatile pool is designed for various uses, including pet bathing, a cooling spot for animals, or a play area for children. Its foldable design ensures easy setup, storage, and portability.



2. SAFETY INFORMATION

Please read and understand all safety instructions before using the product. Failure to follow these instructions may result in injury or damage to the product.

- **Supervision:** Always supervise children and pets when the pool is in use. Never leave them unattended.
- **Pet Nails:** Trim your pet's nails before allowing them into the pool to prevent punctures to the liner.
- **Surface:** Place the pool on a flat, level surface free of sharp objects, rocks, or debris.
- **Water Level:** Do not overfill the pool. Ensure the water level is appropriate for the size and age of the user (pet or child).
- **Chemicals:** Avoid using harsh chemicals or abrasive cleaners on the pool material.
- **Temperature:** Do not expose the pool to extreme temperatures for prolonged periods.
- **Material Integrity:** Regularly inspect the pool for any signs of wear, tears, or damage before each use. Discontinue use if damage is found.

3. PRODUCT FEATURES

The Jasonwell Foldable Pet Bath Pool is designed with convenience and durability in mind:

- **Foldable Design:** Allows for easy storage and portability without the need for inflation.
- **Durable Construction:** Made from extra-tough PVC material with a thicker, slip-resistant bottom.
- **Enhanced Stability:** Features thick high-density wood boards within the walls for structural integrity, preventing collapse.
- **Dual Drain System:** Equipped with two drain caps for efficient water removal, including one with a hose connector for controlled drainage.
- **Puncture Resistant:** Constructed with a super durable 3-layer laminated material (Heavy Gauge PVC, Polyester Mesh, Heavy Gauge PVC) to resist punctures and scratches.
- **Safe Materials:** Manufactured with environmentally friendly materials, meeting EN71 and ASTM standards.

Easy Drain

30%+
Thicker Vinyl
0.6mm thickened Vinyl



Foldable Pool
Paws Friendly



Wrapped edges to prevent
against punctures



Slip resistant, durable heavy
duty bottom

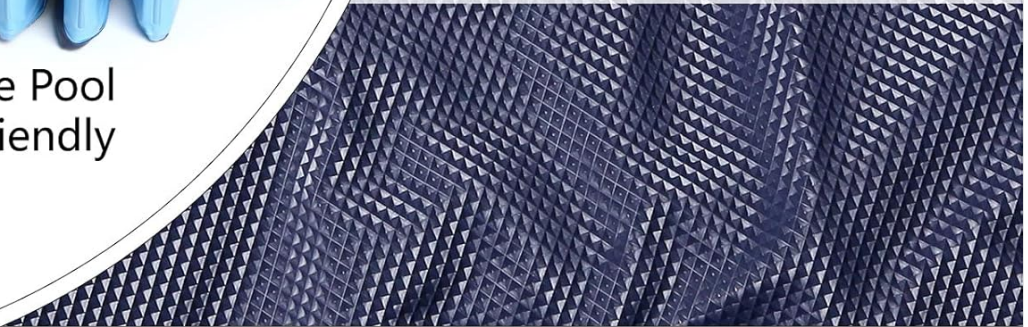

Image 3.1: Detail of the pool's durable construction, including thickened vinyl and slip-resistant bottom.

2023 Upgraded Heavy Duty Vinyl



Puncture Resistant. Anti Scratch



Heavy Duty. Prevent collapse outward

VS

Others



1 layer of PVC



Holes and tears along the edges



Tip and do not hold shape

Image 3.2: Illustration of the pool's three-layer laminated material for enhanced durability.



Jasonwell® VS **Other brands**

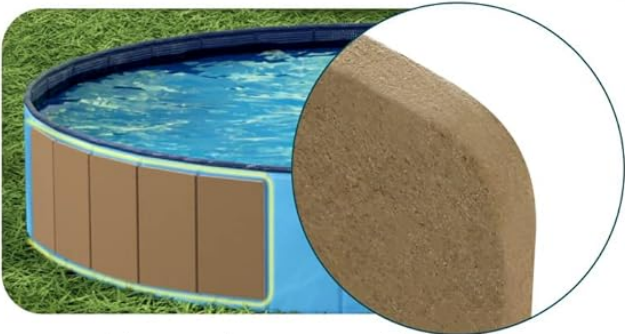

Heavy-duty wood board
Stronger resistance to water pressure



Durable and hold its shape

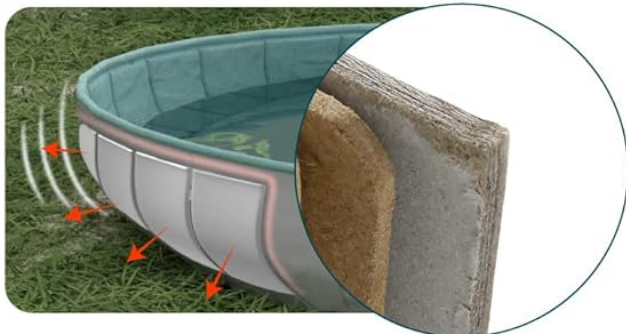

Thin fiberboard/cardboard
Easy to bend out or break



Less ability to withstand the water pressure

Image 3.3: Comparison highlighting the robust wood board construction of the Jasonwell pool.

4. SETUP INSTRUCTIONS

Setting up your Jasonwell Foldable Pet Bath Pool is quick and easy:

- 1. Choose a Location:** Select a flat, level, and clear area for the pool. Ensure there are no sharp objects, stones, or debris that could damage the pool's bottom.

2. **Unfold the Pool:** Carefully remove the pool from its packaging. Unfold the pool walls until it forms a circular shape. The rigid panels will stand upright on their own.
3. **Inspect Drains:** Ensure both drain caps are securely closed before filling the pool.
4. **Fill with Water:** Begin filling the pool with water. As the water level rises, the walls will become more stable. Do not fill beyond approximately 80% capacity to prevent overflow during use.

5. OPERATING INSTRUCTIONS

Using the pool for bathing or play:

- **For Pets:** Ensure your pet's nails are trimmed to prevent damage to the pool liner. Introduce your pet to the pool gradually.
- **For Children:** Always provide constant supervision. The pool is not a flotation device.
- **Draining the Pool:**
 - a. Locate the drain caps on the side/bottom of the pool.
 - b. For quick draining, simply unscrew the main drain cap.
 - c. For controlled drainage (e.g., watering plants or directing water to a specific drain), attach a garden hose to the designated hose connector drain cap before opening.

Two Drain Caps



Cap 1:
Drain the pool fast



Cap 2:
With hose
connector
(Patented Design)



Yard / grass
gets flooded?



Dogs play
in the mud?



Instructions on two drain caps only. The hose is not included.

Image 5.1: Explanation of the dual drain cap system and hose connection for efficient water removal.

6. MAINTENANCE AND STORAGE

Proper maintenance and storage will extend the life of your Jasonwell pool:

- **Cleaning:** After each use, drain the water completely. Rinse the interior and exterior of the pool with clean water. Use a soft cloth or sponge with mild soap if necessary. Avoid abrasive brushes or cleaners.
- **Drying:** Ensure the pool is completely dry before folding and storing. This prevents mold, mildew, and material degradation.
- **Folding for Storage:** The pool can be folded in two ways for compact storage.
 - a. **Method 1 (Flat Fold):** Fold the pool in half, then fold it again into smaller sections until it forms a flat, compact square or rectangle.
 - b. **Method 2 (Accordion Fold):** Fold the individual panels inward, creating an accordion-like stack.
- **Storage Location:** Store the dry, folded pool in a cool, dry place away from direct sunlight and extreme temperatures.

Storage

(Make sure it is fully dry before storage)

Method 1

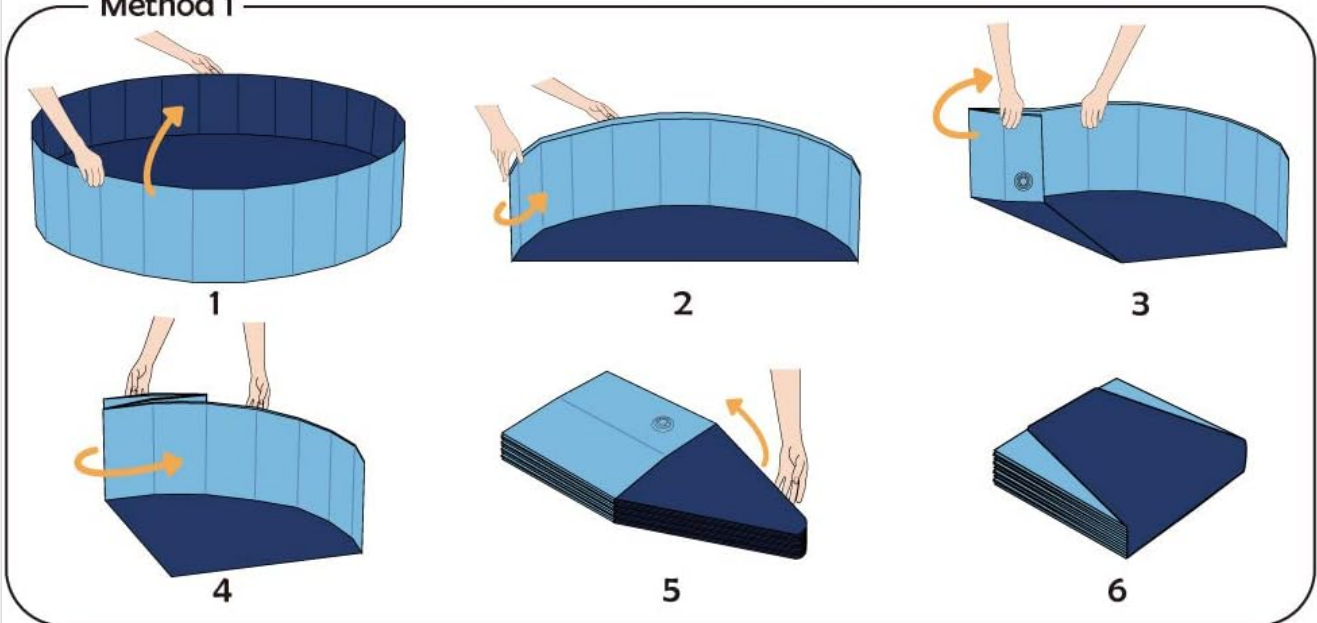

Method 2

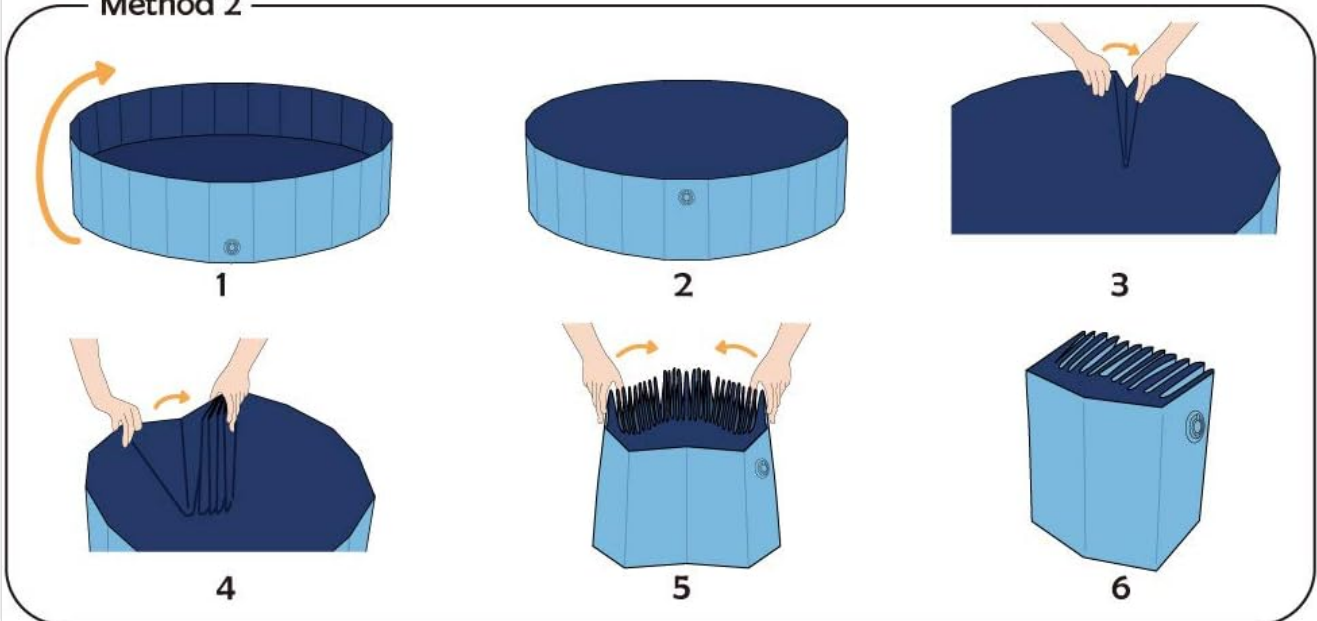

Image 6.1: Visual guide for two different methods of folding the pool for compact storage.

7. TROUBLESHOOTING

Here are solutions to common issues you might encounter:

• Pool does not hold water:

- Ensure both drain caps are securely tightened.
- Inspect the pool liner for any punctures or tears. A repair kit is typically included for minor punctures.
- Verify the pool is on a level surface to prevent uneven pressure on the walls.

• Pool walls collapse:

- Ensure the pool is placed on a completely flat surface.
- Do not overfill the pool; maintain an appropriate water level.
- Check if any internal support boards are damaged.

- **Water drains slowly:**

- Ensure the drain cap is fully open.
- Check for any debris obstructing the drain opening.
- If using a hose, ensure the hose is not kinked and has a clear path for water flow.

8. PRODUCT SPECIFICATIONS

Feature	Detail
Brand	Jasonwell
Model Number	JX-US-DPBIUE120
UPC	190203848049
Size (Current Model)	L - 48" Diameter x 12" Height
Product Dimensions	48"L x 48"W x 12"H
Color	Mdf Wood Blue
Shape	Round
Material	Polyvinyl Chloride (PVC)
Frame Material	Polyvinyl Chloride (PVC) with internal high-density wood boards
Item Weight	10.85 pounds
Age Range (Recommended)	Kid (also suitable for pets)
Assembly Required	No
Standards Met	EN71, ASTM

Size

Please measure your dog before purchase to choose the size

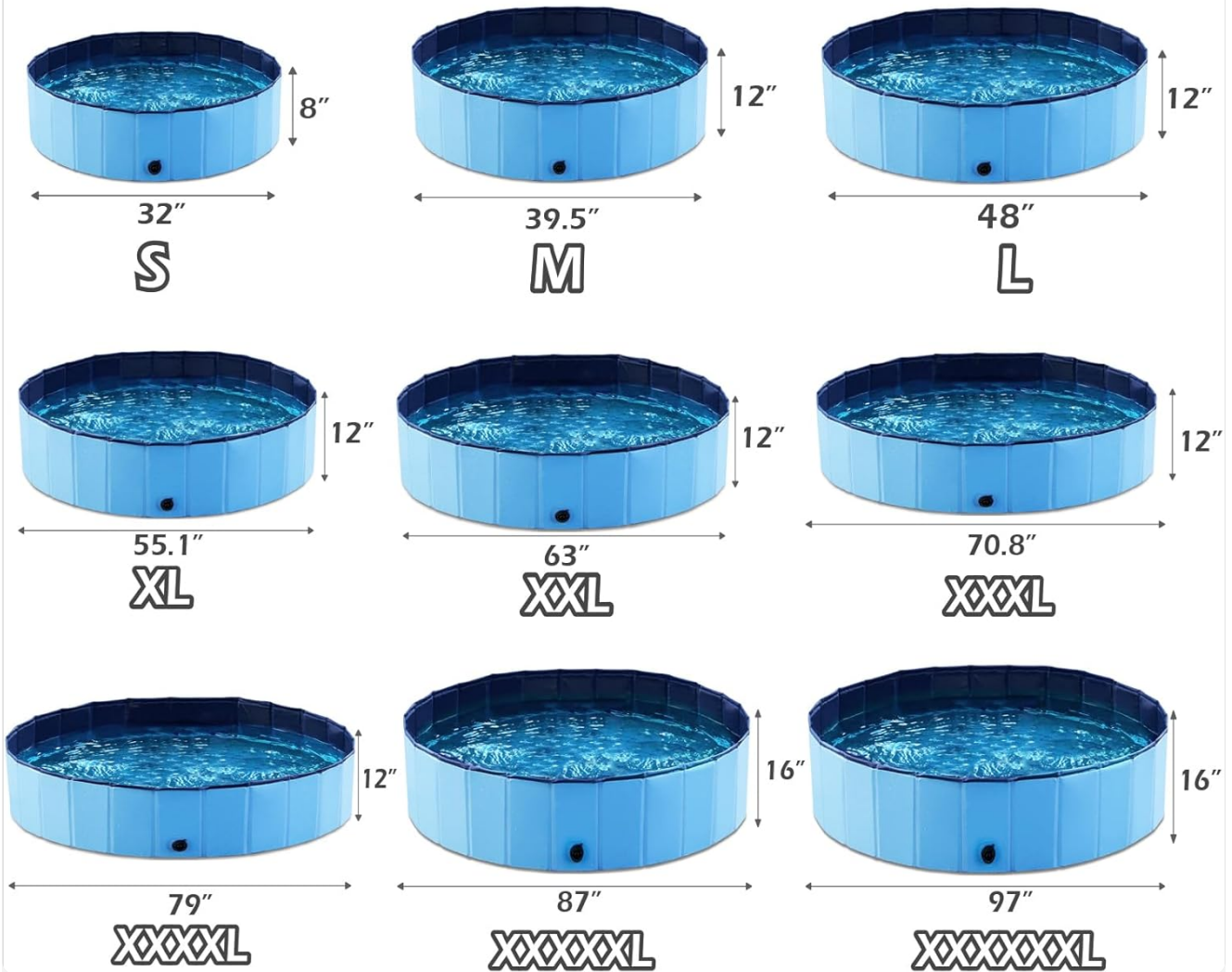

Image 8.1: Comprehensive size chart for Jasonwell Foldable Pet Pools.

9. WARRANTY AND SUPPORT

For warranty information or product support, please refer to the manufacturer's official website or contact Jasonwell customer service directly. Contact details are typically provided with the product packaging or on the brand's official online store.

You can visit the Jasonwell Store for more information: [Jasonwell Official Store](#)