

Manuals.plus /

› Relaxdays /

› Relaxdays Garden Gazebo Instruction Manual - Model 10020077\_49

## Relaxdays 10020077\_49



# Relaxdays Garden Gazebo Instruction Manual

Model: 10020077\_49

## INTRODUCTION

This manual provides essential instructions for the safe and effective assembly, operation, and maintenance of your Relaxdays Garden Gazebo. Please read all instructions carefully before use and retain this manual for future reference.

## SAFETY WARNINGS

- **Anchoring:** Always ensure the gazebo is properly anchored using the included ropes and pegs, especially in windy conditions. Failure to do so may result in damage to the gazebo or personal injury.
- **Weather Conditions:** Do not use the gazebo in difficult weather conditions, such as strong winds, heavy rain, or snow. Disassemble and store the gazebo during adverse weather to prevent damage.
- **Assembly:** Assembly should ideally be performed by two or more adults to ensure stability and safety.
- **Fire Hazard:** Keep all heat sources and open flames away from the gazebo fabric.

## PACKAGE CONTENTS

Before assembly, verify that all components are present:

- Frame (Alloy Steel poles and connectors)

- Polyethylene Tarp (Roof and optional side panels)
- 8 Pegs
- Ropes/Straps
- Plastic Feet
- Instruction Manual (with images)

## SETUP INSTRUCTIONS

The steel structure features an easy click assembly system. Follow these steps for quick setup:

1. **Unpack Components:** Lay out all frame poles, connectors, and the tarp on a clean, flat surface.
2. **Assemble the Roof Frame:** Connect the shorter poles to form the top square frame using the central and corner connectors.
3. **Attach the Tarp:** Drape the polyethylene tarp over the assembled roof frame. Ensure it is centered and the corners align with the frame.
4. **Attach Legs:** Insert the longer leg poles into the corner connectors. Secure the tarp to the frame using the integrated straps or ties.
5. **Raise the Gazebo:** With assistance, carefully lift the gazebo into an upright position.
6. **Secure the Base:** Attach the plastic feet to the bottom of each leg.
7. **Anchor the Gazebo:** Use the provided ropes/straps and 8 pegs to firmly anchor the gazebo to the ground. This is crucial for stability, especially in light winds.
8. **Optional Side Panels:** If included, attach side panels as desired for additional protection.



Figure 1: Gazebo dimensions (300 cm x 300 cm base, 250 cm peak height, 185 cm side height).



Figure 2: Detailed view of the gazebo's internal frame structure, showing the crossbar support, velcro strap for securing the tarp to the frame, a corner joint, and a leg base with an anchoring pin.

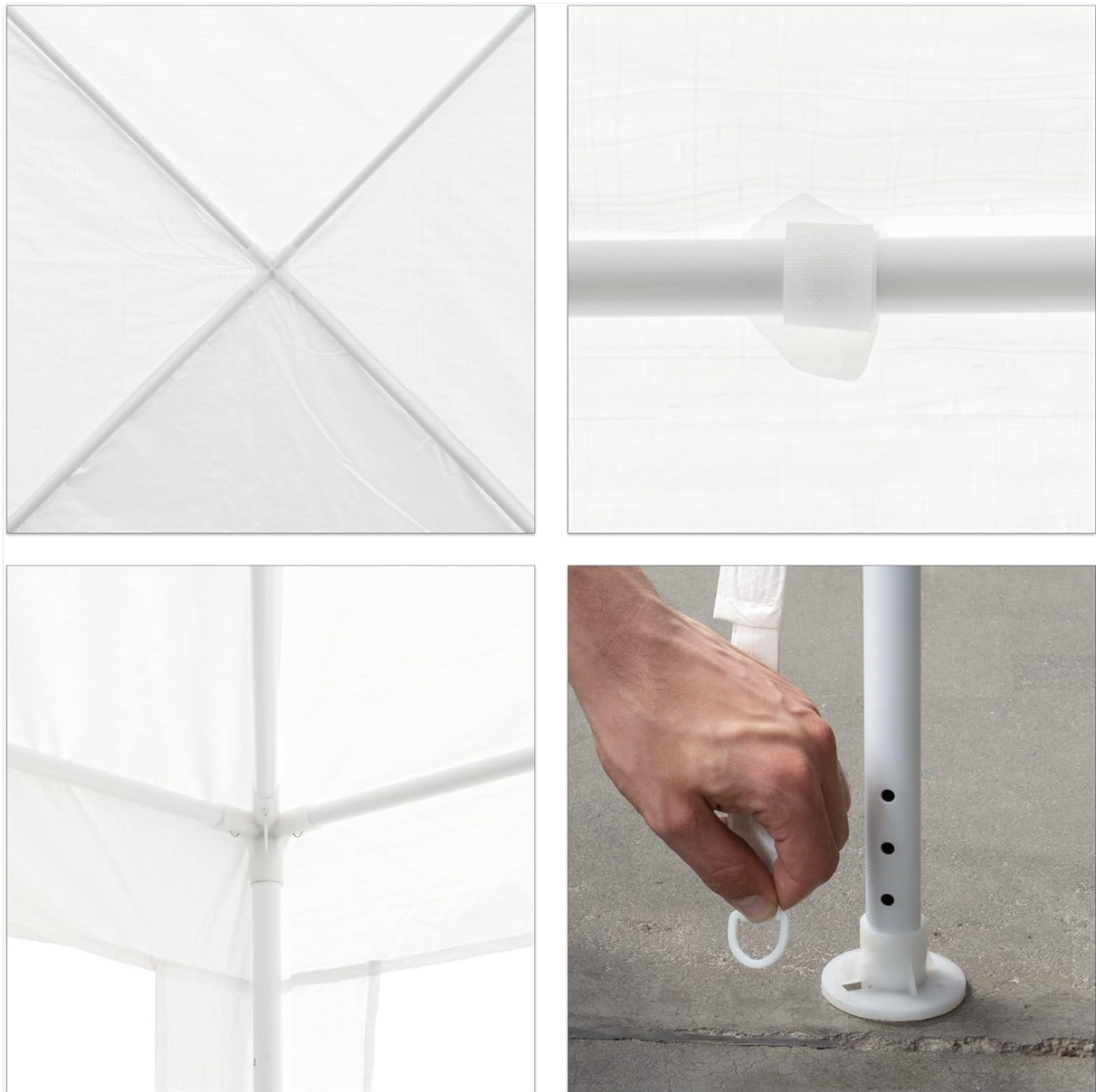

Figure 3: The gazebo fully assembled with side panels, providing additional enclosure and protection.

## Assembly Video

Watch this short video for a visual guide on setting up the gazebo and its features:

Your browser does not support the video tag.

Video 1: A brief demonstration of the gazebo assembly process and its various color options (green, white, blue) with and without side panels.

## OPERATING INSTRUCTIONS

Your Relaxdays Garden Gazebo is designed to provide temporary shelter and comfort for various outdoor activities.

- **Sun Protection:** The gazebo offers protection against direct sunlight, making it ideal for outdoor gatherings, parties, or simply relaxing in your garden.
- **Wind Protection:** When properly anchored, the gazebo provides a degree of protection from light winds.
- **Water Repellency:** The polyethylene tarp is water-repellent, offering shelter from light rain. However, it is not designed for heavy downpours.

- **Portability:** The gazebo is suitable for various events such as festivals, weddings, parties, and meetings due to its relatively easy assembly and disassembly.

## MAINTENANCE

- **Cleaning:** Clean the tarp and frame with a damp cloth and mild soap. Avoid harsh chemicals or abrasive cleaners that could damage the materials.
- **Drying:** Ensure the tarp is completely dry before folding and storing to prevent mold and mildew.
- **Storage:** Store the gazebo in a cool, dry place, away from direct sunlight and extreme temperatures, when not in use.
- **Inspection:** Periodically inspect the frame, connectors, and tarp for any signs of wear or damage. Replace damaged parts as needed.

## TROUBLESHOOTING

- **Gazebo Instability:** Ensure all poles are fully connected and locked into place. Verify that the gazebo is properly anchored with all pegs and ropes.
- **Water Accumulation on Roof:** In heavy rain, water may pool on the roof. Gently push up from underneath to release accumulated water. Consider adjusting the tension of the tarp during assembly to prevent excessive sagging.
- **Difficulty Assembling Poles:** Check for any debris inside the pole connections. Ensure you are using the correct poles for each section as per the visual instructions.

## SPECIFICATIONS

<b>Brand</b>	Relaxdays
<b>Model Number</b>	10020077_49
<b>Dimensions (H x L x W)</b>	2.5 x 3 x 3 meters (approx. 98.4 x 118.1 x 118.1 inches)
<b>Weight</b>	5.6 kg (approx. 12.3 lbs)
<b>Material</b>	Alloy Steel (frame), Polyethylene (PE) (tarp)
<b>Color</b>	White
<b>Water Resistance Level</b>	Water-repellent
<b>UV Protection</b>	Yes
<b>Floor Area</b>	7.5 square meters
<b>Assembly Required</b>	Yes

## WARRANTY AND SUPPORT

For warranty information, technical support, or to inquire about replacement parts, please contact Relaxdays customer service. You can find more information and contact details on the official Relaxdays website or through your retailer.

Visit the official Relaxdays store: [Relaxdays Store](#)