

[Manuals.plus](#) /

> [Locinox](#) /

> Locinox KIDLOC 3006WS Safety Knob Instruction Manual

## Locinox KIDLOC 3006WS



# Locinox KIDLOC 3006WS Safety Knob Instruction Manual

Model: KIDLOC 3006WS

## 1. INTRODUCTION

The Locinox KIDLOC 3006WS Safety Knob is designed to provide enhanced security for gates and doors, particularly in environments where child safety is a priority. This manual provides detailed instructions for the proper installation, operation, and maintenance of your KIDLOC 3006WS safety knob. Please read all instructions carefully before installation and use to ensure correct function and safety.

## 2. PRODUCT OVERVIEW

The KIDLOC 3006WS is a robust, ambidextrous safety knob featuring a push-button locking mechanism. It is constructed from durable stainless steel and polyamide, making it rust-proof and suitable for both indoor and outdoor applications. The knob is designed for use with an 8mm square spindle.



**Image Description:** A clear, close-up photograph of the Locinox KIDLOC 3006WS safety knob. The knob is silver-colored with a textured black grip around its base, indicating a push-button mechanism. A keyhole is visible at the bottom of the knob, suggesting additional locking capability. The overall design is sleek and functional.

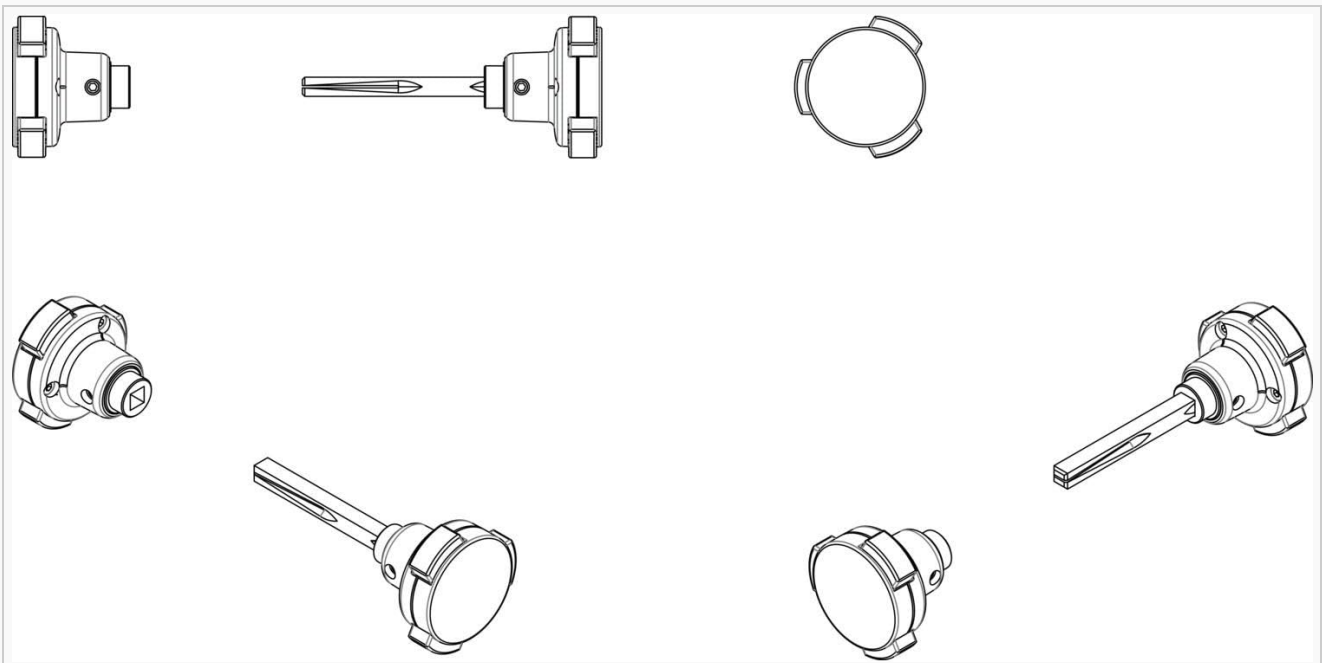
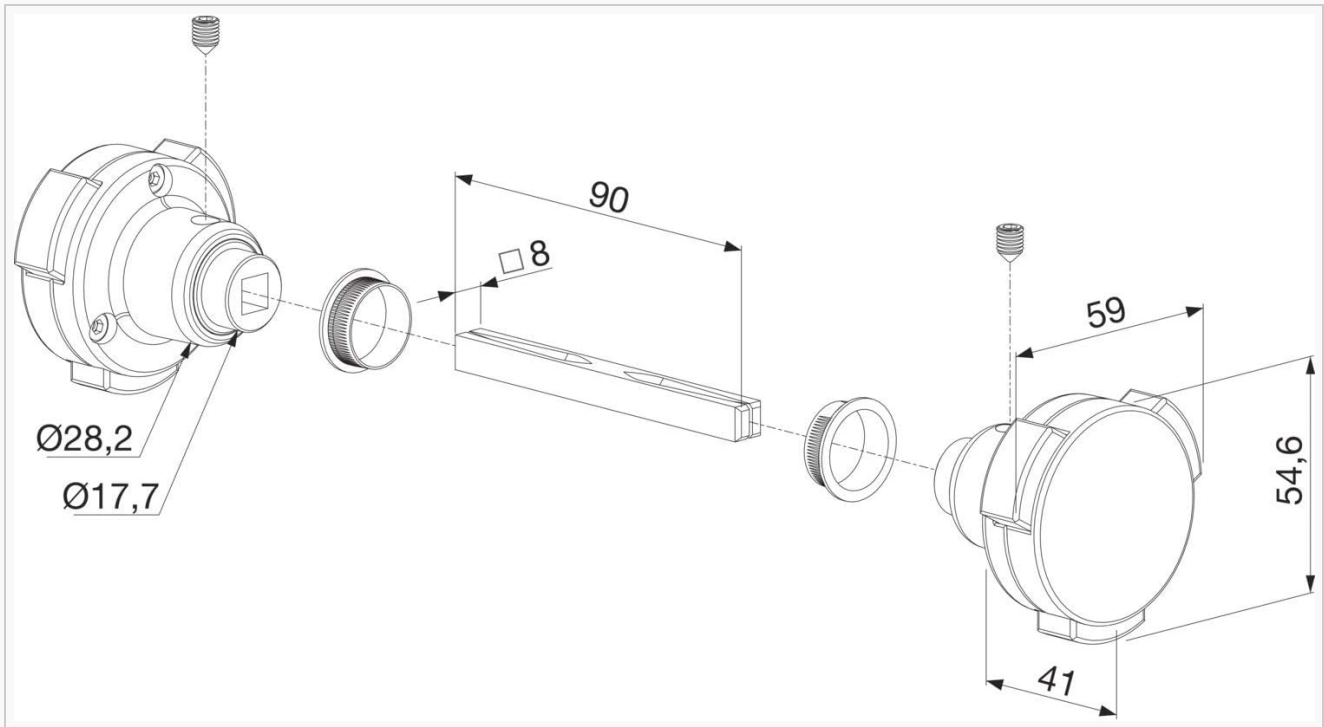

**Image Description:** A technical drawing displaying multiple perspectives of the Locinox KIDLOC 3006WS safety knob and its associated spindle. Views include top, side, and isometric projections of the knob assemblies and the square spindle, illustrating their shapes and how they connect. This image provides a comprehensive visual understanding of the product's form.

### 3. SETUP AND INSTALLATION

Proper installation is crucial for the optimal performance and safety of the KIDLOC 3006WS safety knob. Ensure you

have all included installation hardware before beginning.



**Image Description:** An exploded diagram showing the individual components of the Locinox KIDLOC 3006WS safety knob. Key components include two knob assemblies, an 8mm square spindle (90mm long), and mounting hardware. Dimensions are indicated, such as a spindle length of 90mm, a square cross-section of 8mm, and knob dimensions including a diameter of 28.2mm and 17.7mm for different parts, and an overall depth of 59mm for the assembled knob.

1. **Prepare the Door/Gate:** Ensure the door or gate has a suitable opening for an 8mm square spindle and mounting points for the knob assemblies.
2. **Insert Spindle:** Insert the 8mm square spindle through the prepared opening in the door or gate. The spindle length is 90mm.
3. **Attach Knob Assemblies:** Place one knob assembly onto each end of the spindle, ensuring they are correctly oriented.
4. **Secure Knobs:** Use the provided installation hardware (screws) to firmly attach both knob assemblies to the door or gate. Ensure the screws are tightened securely but do not overtighten.
5. **Test Operation:** After installation, test the knob's rotation and the push-button locking mechanism to ensure smooth and correct operation.

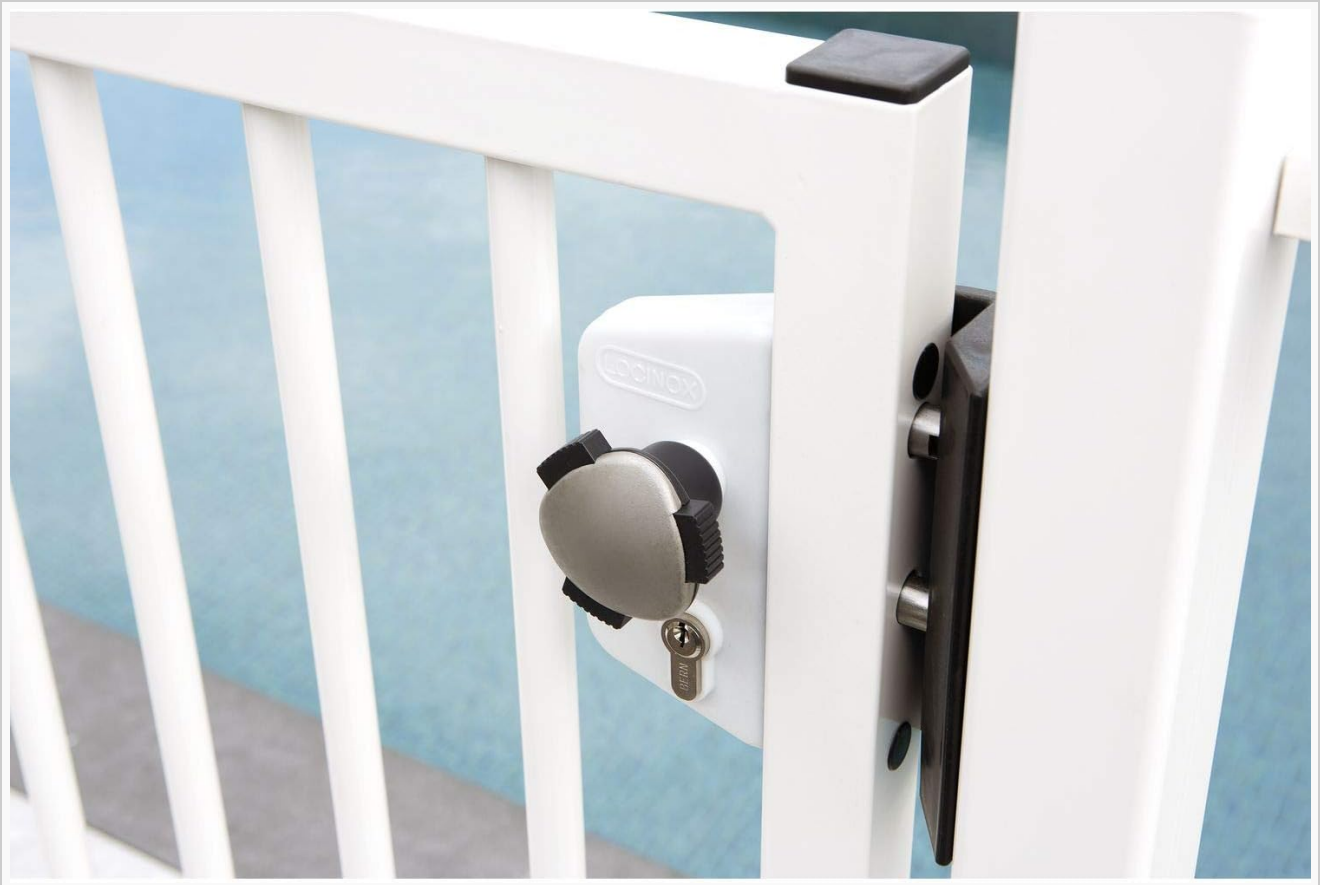

**Image Description:** A close-up view of the Locinox KIDLOC 3006WS safety knob, silver in color, installed on a white metal gate. The gate appears to be part of a pool enclosure, highlighting the product's application in child safety. The knob features a textured grip and a keyhole for additional security.

#### 4. OPERATING INSTRUCTIONS

The KIDLOC 3006WS safety knob is designed for simple yet secure operation, providing a barrier against unauthorized access, especially by children.

- **To Open:** To open the gate or door, turn the knob while simultaneously pressing the integrated push-button. This action disengages the latch, allowing the gate/door to open.
- **To Close/Lock:** Simply close the gate or door. The latch will automatically engage. To secure it, ensure the push-button mechanism is engaged. The design prevents easy opening by small children due to the required simultaneous action.



**Image Description:** A young child, seen from behind, standing next to a white metal gate that leads to a swimming pool. The child is reaching up towards the Locinox KIDLOC 3006WS safety knob, which is installed on the gate, demonstrating the product's intended use for child safety around hazardous areas.

## 5. MAINTENANCE

Regular maintenance ensures the longevity and reliable operation of your safety knob.

- **Cleaning:** Clean the knob and surrounding areas periodically with a soft, damp cloth. Avoid abrasive cleaners or

solvents that could damage the finish or material.

- **Inspection:** Regularly inspect the knob, spindle, and mounting hardware for any signs of wear, damage, or loosening.
- **Lubrication:** If the knob rotation or push-button mechanism becomes stiff, apply a small amount of silicone-based lubricant to the moving parts. Do not use oil-based lubricants as they can attract dirt.

## 6. TROUBLESHOOTING

### Common Issues and Solutions

Issue	Possible Cause	Solution
Knob is stiff or difficult to turn.	Accumulation of dirt or lack of lubrication.	Clean the knob and spindle area. Apply silicone-based lubricant to moving parts.
Push-button lock does not engage/disengage properly.	Debris in the mechanism or misalignment.	Clean the push-button mechanism. Check if the knob assemblies are securely and correctly installed.
Knob feels loose.	Mounting screws have loosened.	Carefully tighten the mounting screws. Do not overtighten.

## 7. SPECIFICATIONS

- **Model:** KIDLOC 3006WS
- **Material:** Stainless steel / Polyamide
- **Color:** Silver (as per product image and specifications)
- **Product Dimensions (L x W x H):** Approximately 12 x 8 x 5 cm (packaging dimensions)
- **Product Weight:** 260 grams
- **Spindle Type:** Square 8 mm
- **Spindle Length:** 90 mm (as per diagram)
- **Knob Diameter:** Approximately 28.2 mm
- **Type of Handle:** Push-button knob
- **Special Feature:** Rust-proof
- **Usage:** Outdoor/Indoor, Door/Gate
- **Hand Orientation:** Ambidextrous
- **Components Included:** Installation hardware

## 8. WARRANTY INFORMATION

Locinox products are manufactured to high standards. For specific warranty terms and conditions, please refer to the documentation provided with your purchase or visit the official Locinox website. Warranty coverage typically addresses manufacturing defects.

## 9. SUPPORT

If you encounter any issues not covered in this manual or require further assistance, please contact Locinox

customer service or your authorized retailer. When contacting support, please have your product model (KIDLOC 3006WS) and purchase details available.

